

CITY OF SACRAMENTO
1231 I Street, Sacramento, CA 95814

Permit No: 0014823
Insp Area: 4

Site Address: 1741 MONTARA AV SAC
Parcel No: 225-1110-042 NORTHPT PK 12 LOT 42

Sub-Type: NSFR
Housing (Y/N): N

CONTRACTOR
LENNAR RENAISSANCE INC.
2240 DOUGLAS BL
ROSEVILLE CA. 95661

OWNER

ARCHITECT

Nature of Work: NSFR MP654B 11 RMS 2 STORY

CONSTRUCTION LENDING AGENCY: I hereby affirm under penalty of perjury that there is a construction lending agency for the performance of the work for which this permit is issued (Sec. 3097, Civ. C.)

Lender's Name _____ Lender's Address _____

LICENSED CONTRACTORS DECLARATION: I hereby affirm under penalty of perjury that I am licensed under provisions of Chapter 9 (commencing with section 7000) of Division 3 of the Business and Professions Code and my license is in full force and effect.

License Class B License Number 732348 Date 1/30/01 Contractor Signature Jennifer Price

OWNER-BUILDER DECLARATION: I hereby affirm under penalty of perjury that I am exempt from the contractors License Law for the following reason (Sec. 7031.5, Business and Professions Code): any city or county which requires a permit to construct, alter, improve, demolish, or repair any structure, prior to its issuance, also requires the applicant for such permit to file a signed statement that he or she is licensed pursuant to the provisions of the Contractors License Law (Chapter 9 (commencing with Section 7000) of Division 3 of the Business and Professions Code) or that he or she is exempt therefrom and the basis for the alleged exemption. Any violation of Section 7031.5 by any applicant for a permit subjects the applicant to a civil penalty of not more than five hundred dollars (\$500.00).

I, as a owner of the property, or my employees with wages as their sole compensation, will do the work, and the structure is not intended or offered for sale (Sec. 7044, Business and Professional Code: The Contractors License Law does not apply to an owner of property who builds or improves thereon, and who does such work himself or herself or through his/her own employees, provided that such improvements are not intended or offered for sale. If, however, the building or improvement is sold within one year of completion, the owner-builder will have the burden of proving that he/she did not build or improve for the purpose of sale.)

I, as owner of the property, am exclusively contracting with licensed contractors to construct the project (Sec. 7044, Business and Professions Code. The Contractors License Law does not apply to an owner of property who builds or improves thereon, and who contracts for such projects with a contractor(s) licensed pursuant to the Contractors License Law.)

I am exempt under Sec. _____ B & PC for this reason: _____

Date _____ Owner Signature _____

IN ISSUING THIS BUILDING PERMIT, the applicant represents, and the city relies on the representation of the applicant, that the applicant verified all measurements and locations shown on the application or accompanying drawings and that the improvement to be constructed does not violate any law or private agreement relating to permissible or prohibited locations for such improvements. This building permit does not authorize any illegal location of any improvement or the violation of any private agreement relating to location of improvements.

I certify that I have read this application and state that all information is correct. I agree to comply with all city and county ordinances and state laws relating to building construction and hereby authorize representative(s) of this city to enter upon the abovementioned property for inspection purposes.

Date 1/30/01 Applicant/Agent Signature J. Price

WORKER'S COMPENSATION DECLARATION: I hereby affirm under penalty of perjury one of the following declarations:

I have and will maintain a certificate of consent to self-insure for workers' compensation as provided for by Section 3700 of the Labor Code, for the performance of work for which the permit is issued

I have and will maintain workers' compensation insurance, as required by Section 3700 of the Labor Code, for the performance of the work for which this permit is issued. My workers' compensation insurance carrier and policy number are:

Carrier TRANSCONTINENTAL INSURANCE CO Policy Number WC166792277 Exp Date 06/01/2001

(This section need not be completed if the permit is issued for the performance of the work for which this permit is issued. I shall not employ any person in any manner so as to become subject to the workers' compensation laws of California and agree that if I should become subject to the workers' compensation provisions of Section 3700 of the Labor Code, I shall forthwith comply with those provisions.

Date 1/30/01 Applicant Signature Jennifer Price

WARNING: FAILURE TO SECURE WORKER'S COMPENSATION COVERAGE IS UNLAWFUL AND SHALL SUBJECT AN EMPLOYER TO CRIMINAL PENALTIES AND CIVIL FINES UP TO ONE HUNDRED THOUSAND DOLLARS (\$100,000) IN ADDITION TO THE COST OF COMPENSATION, DAMAGES AS PROVIDED FOR IN SECTION 3706 OF THE LABOR CODE, INTEREST AND ATTORNEY'S FEE.

THIS PERMIT SHALL EXPIRE BY LIMITATION IF WORK IS NOT COMMENCED WITHIN 180 DAYS.

ENGEL INSULATION, INC.

CALIFORNIA CONTRACTOR'S LICENSE #745646

460 Roseville Road • Roseville, CA 95678

(916) 786-2088 / (916) 969-6191

THIS IS TO CERTIFY THAT INSULATION HAS BEEN INSTALLED IN CONFORMANCE WITH CURRENT ENERGY REGULATIONS, CALIFORNIA ADMINISTRATIVE CODE, TITLE 24, STATE OF CALIFORNIA, IN THE BUILDING LOCATED AT:

TRACT SCUMERSET LOT 42/654X3
STREET _____ CITY SACRAMENTO

EXTERIOR WALLS: _____ CT 2x4 3 1/2 _____ 13
MANUFACTURER _____ CT 2x6 6 1/4 R-VALUE _____ 19
THICKNESS _____

CEILING AREA: BATS _____ CT _____ 12 R-VALUE _____ 38
MANUFACTURER _____ THICKNESS _____

CEILINGS: BLOWN IN _____ INSULATION THICKNESS _____ 14 3/4 R-VALUE _____ 38
MANUFACTURER _____ NUMBER OF BAGS USED _____ 47

SQUARE FOOTAGE 2072 FLOOR AREA 2nd of CHANGE
FLOOR AREA _____

MANUFACTURER CAULT _____ CT _____ 6 1/4 R-VALUE _____ 19
EXTERIOR KNEEWALL: _____ THICKNESS _____

MANUFACTURER _____ CT _____ 6 1/4 R-VALUE _____ 19
THICKNESS _____

INTERIOR KNEEWALL: ATLANTA _____ CT _____ 6 1/4 R-VALUE _____ 19
MANUFACTURER _____ THICKNESS _____

APPLIED CAULK & SEALANT TO ALL EXTERIOR OPENINGS & PENETRATIONS

YES NO _____

GENERAL CONTRACTOR _____
CALIFORNIA CONTRACTORS
LICENSE # _____ DATE _____

SIGNATURE _____ TITLE _____
David Sklaric At Home/Rec Bldg/Deerport 10/8/01
INSULATION CONT. SIGNATURE / _____ TITLE _____ DATE _____

42

RESIDENTIAL BUILDING PERMIT APPLICATION

- New Construction
- Addition
- Remodels
- Other

Project Address: 1741 Montara Ave Assessor Parcel # 225-111-048-000

OWNER INFORMATION:

Legal Property Owner: LENNAR RENAISSANCE, INC. Phone # (916) 773-4083
 Owner Address: 2240 DOUGLAS BLVD. # 250 City ROSEVILLE State CA Zip 95661

CONTRACTOR INFORMATION:

Contractor: SAME AS ABOVE Lic. # 732348 B Phone # 773-4083 Fax# 773-4086

PROJECT INFORMATION:

Land Use Zone R/A Occupancy Group R3 Construction Type VN Fed Code 1A
 No. of stories: 2 No. of rooms: 11 Street width: 40
 1st Floor Area 2030 2nd Floor Area 1681 Basement _____ Roof Material _____

AREA IN SQUARE FOOT OF:	EXISTING	NEW
Dwelling/Living	_____	<u>3711</u>
Garage/Storage	_____	<u>446</u>
Decks/Balconies	_____	<u>189</u>
Carports	_____	_____

SCOPE OF WORK: MP 3711/ 654X3

FOR OFFICE USE ONLY

- Information above complete
- Violation files checked
- Standard setbacks
- County Sewer
- AR Flood Waiver required
- Flood Elevation Certificate Required
- Water Development Infill Area
- Planning Approval
- Design Review Approval
- Special Fee Districts Apply : _____

NEW STRUCTURES & ADDITIONS

❖ THE FOLLOWING MUST BE PROVIDED IN ORDER TO SUBMIT FOR PLAN REVIEW

- 2 COMPLETE PLANS, LEGIBLE & DRAWN TO SCALE
 - 3 SETS IF PROJECT IS IN A DESIGN REVIEW AREA
 - Title 24 Energy Compliance documentation
 - Grading and Erosion Control Questionnaire
 - 11" x 17" copy of floor plan for County Assessor
 - Plan Review Fees
- ❖ Plans to include: site plan, floor plan, elevations, roof/ceiling plan, foundation and structural framing details, and structural calculations for non-conforming structures.

Date: _____ Received by: (staff) _____

ACTIVITY/PERMIT #

INSTALLATION CARD

Job Address:
1741 Montara Ave.
Sacramento, Ca
Lot # 42

Stucco System Trademark: SMK NOTE
Name of Stucco Manufacturer: SMK NOTE CORP.

SMK Evaluation Service, Inc.
Evaluation Report # SA-3007
Date of Job Completion: 10-22-01

Stucco Contractor:

Name: Kenyon Plastering
Address: Sacramento, Ca 95835
Telephone Number: _____

Approved Contractor Number as issued by the Stucco Manufacturer:

This is to certify that the stucco system on the building exterior of the above address has been installed in accordance with the evaluation report specified above and the manufacturer's instructions.

Nester Perez 10-30-01
Signature of authorized representative of stucco contractor Date

FIGURE 1

DECLARATION

Project Address: _____ Date: _____

The field batching and mixing of all components and of the stucco was verified at the address noted above has been continuously inspected before, during and after installation of the continuous setting. The field batching and mixing have been found to comply with current evaluation report SA-3007 and approved plans.

Authorized Inspector Signature _____
Authorized Inspector Name (Print) _____
Employer Name _____
Employer Address _____
Telephone Number () _____

This is to certify that the above noted inspector, approved by SMK NOTE CORP. was authorized to inspect the project as noted and was trained to properly discharge his duties.

Signature of Employee of Office of Report Holder _____

Signer's Name (Print): _____ Date: _____

* Signature required only if inspector is not an employee of evaluation report holder.

FIGURE 4

41
PAD=13.3

43
PAD=14.0

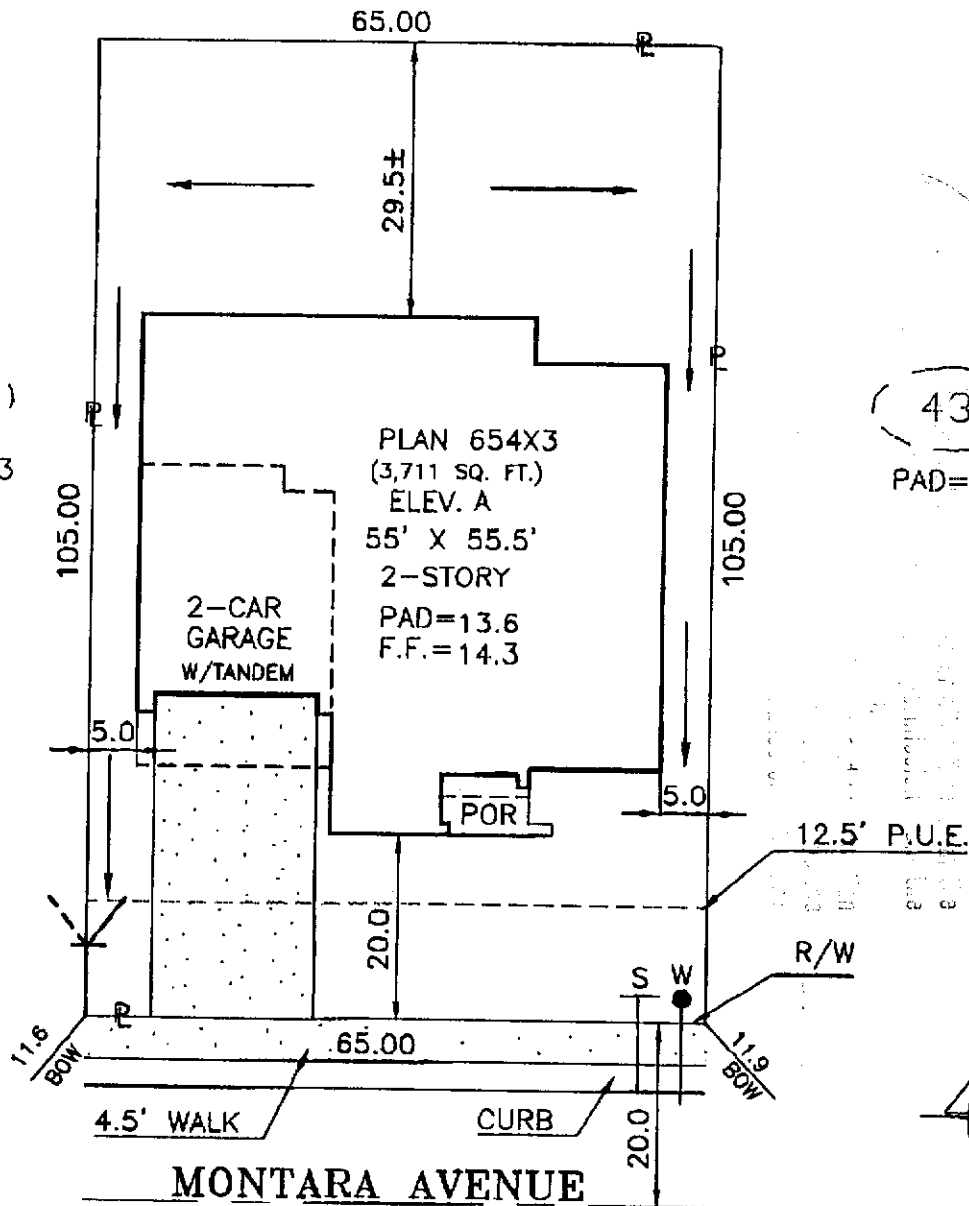

DIMENSIONS SHOWN ARE APPROXIMATE EXCEPT FOR MINIMUMS REQUIRED BY ORDINANCE.
THIS PLOT DOES NOT REFLECT AS BUILT CONDITIONS AND MAY VARY FROM THIS PLAN.

RENAISSANCE
H O M E S

2240 DOUGLAS BLVD. SUITE 250, ROSEVILLE, CALIFORNIA 95661
PHONE (916) 773-4089 FAX (916) 773-4088

SOMERSET

NORTHPOINTE PARK UNIT 12
CITY OF SACRAMENTO
SACTO. COUNTY CALIFORNIA

PLOT PLAN

NOTES:

ADDRESS: 1741 MONTARA AVENUE

LOT COV: 36.2 % APN:

PLAN NO.: 654X3-A LOT SQ. FT.: 6,825

REAR YARD COVERAGE: %

DRAWN BY: R.P. APPROVED BY:

DATE: 12/5/00 SCALE: 1"=20'

LOT 42