

CITY OF SACRAMENTO  
1231 I Street, Sacramento, CA 95814

Permit No: 0402629  
Insp Area: 4  
Thos Bros: 257-C4

Site Address: 2209 BAY HORSE LN SAC

Sub-Type: NSFR

Parcel No: 201-0960-101  
N

HERITAGE @ NATOMAS PARK 19 LOT 111 Housing (Y/N):

CONTRACTOR  
US HOME  
2366 GOLD MEADOW DR STE 100  
GOLD RIVER, CA 95670 77041

OWNER

ARCHITECT

Nature of Work: MP1538 1 STORY 6 ROOM SFR

**CONSTRUCTION LENDING AGENCY :** I hereby affirm under penalty of perjury that there is a construction lending agency for the performance of the work for which this permit is issued (Sec. 3097, Civ. C).

Lender's Name \_\_\_\_\_ Lender's Address \_\_\_\_\_

**LICENSED CONTRACTORS DECLARATION:** I hereby affirm under penalty of perjury that I am licensed under provisions of Chapter 9 (commencing with section 7000) of Division 3 of the Business and Professions Code and my license is in full force and effect.

License Class B License Number 451839 Date 3/2/4 Contractor Signature Don McCloskey

**OWNER-BUILDER DECLARATION:** I hereby affirm under penalty of perjury that I am exempt from the contractors License Law for the following reason (Sec. 7031.5, Business and Professions Code; any city or county which requires a permit to construct, alter, improve, demolish, or repair any structure, prior to its issuance, also requires the applicant for such permit to file a signed statement that he or she is licensed pursuant to the provisions of the Contractors License Law (Chapter 9 (commencing with Section 7000) of Division 8 of the Business and Professions Code) or that he or she is exempt therefrom and the basis for the alleged exemption. Any violation of Section 7031.5 by any applicant for a permit subjects the applicant to a civil penalty of not more than five hundred dollars (\$500.00);

\_\_\_\_ I, as a owner of the property, or my employees with wages as their sole compensation, will do the work, and the structure is not intended or offered for sale (Sec. 7044, Business and Professional Code: The Contractors License Law does not apply to an owner of property who builds or improves thereon, and who does such work himself or herself or through his/her own employees, provided that such improvements are not intended or offered for sale. If, however, the building or improvement is sold within one year of completion, the owner-builder will have the burden of proving that he/she did not build or improve for the purpose of sale.)

\_\_\_\_ I, as owner of the property, am exclusively contracting with licensed contractors to construct the project (Sec. 7044, Business and Professions Code: The Contractors License Law does not apply to an owner of property who builds or improves thereon, and who contracts for such projects with a contractor(s) licensed pursuant to the Contractors License Law).

\_\_\_\_ I am exempt under Sec. \_\_\_\_\_ B & PC for this reason: \_\_\_\_\_  
Date \_\_\_\_\_ Owner Signature \_\_\_\_\_

PAID  
CITY OF SACRAMENTO  
MAR 02 2004  
BUILDING PERMIT

**IN ISSUING THIS BUILDING PERMIT,** the applicant represents, and the city relies on the representation of the applicant that the applicant verified all measurements and locations shown on the application or accompanying drawings and that the improvement to be constructed does not violate any law or private agreement relating to permissible or prohibited locations for such improvements. This building permit does not authorize any illegal location of any improvement or the violation of any private agreement relating to location of improvements.

I certify that I have read this application and state that all information is correct. I agree to comply with all city and county ordinances and state laws relating to building construction and hereby authorize representative(s) of this city to enter upon the above mentioned property for inspection purposes.

Date 3/2/4 Applicant/Agent Signature Don McCloskey

**WORKER'S COMPENSATION DECLARATION:** I hereby affirm under penalty of perjury one of the following declarations:

\_\_\_\_ I have and will maintain a certificate of consent to self-insure for workers' compensation as provided for by Section 3700 of the Labor Code, for the performance of work for which the permit is issued.

I have and will maintain workers' compensation insurance, as required by Section 3700 of the Labor Code, for the performance of the work for which this permit is issued. My workers' compensation insurance carrier and policy number are:

Carrier OLD REPUBLIC INS. CO. Policy Number MWC10815000 Exp Date 11/01/2004

\_\_\_\_ (This section need not be completed if the permit is for \$100 or less) I certify that in the performance of the work for which this permit is issued, I shall not employ any person in any manner so as to become subject to the workers' compensation laws of California and agree that if I should become subject to the workers' compensation provisions of Section 3700 of the Labor Code, I shall forthwith comply with those provisions.

Date 3/2/4 Applicant Signature Don McCloskey

**WARNING: FAILURE TO SECURE WORKER'S COMPENSATION COVERAGE IS UNLAWFUL AND SHALL SUBJECT AN EMPLOYER TO CRIMINAL PENALTIES AND CIVIL FINES UP TO ONE HUNDRED THOUSAND DOLLARS (\$100,000) IN ADDITION TO THE COST OF COMPENSATION, DAMAGES AS PROVIDED FOR IN SECTION 3706 OF THE LABOR CODE, INTEREST AND ATTORNEY'S FEE.**

**THIS PERMIT SHALL EXPIRE BY LIMITATION IF WORK IS NOT COMMENCED WITHIN 180 DAYS.**

THIS PLAN IS PREPARED TO SHOW THE DIMENSIONAL RELATIONSHIP FROM BUILDING FOUNDATION TO PROPERTY LINES, DRAINAGE CONTROL ELEVATIONS AND DIRECTION OF DRAINAGE FLOW. THIS IS DONE TO CONFORM TO LOCAL ORDINANCES FOR THE PURPOSE OF BUILDING PERMIT ISSUANCE. INFORMATION SHOWN ON THIS PLAN IS APPROXIMATE EXCEPT FOR MINIMUM SETBACKS WHICH ARE REQUIRED BY LOCAL ORDINANCE. THIS PLAN DOES NOT REFLECT AS BUILT CONDITIONS WHICH WILL LIKELY VARY FROM THIS PLAN.

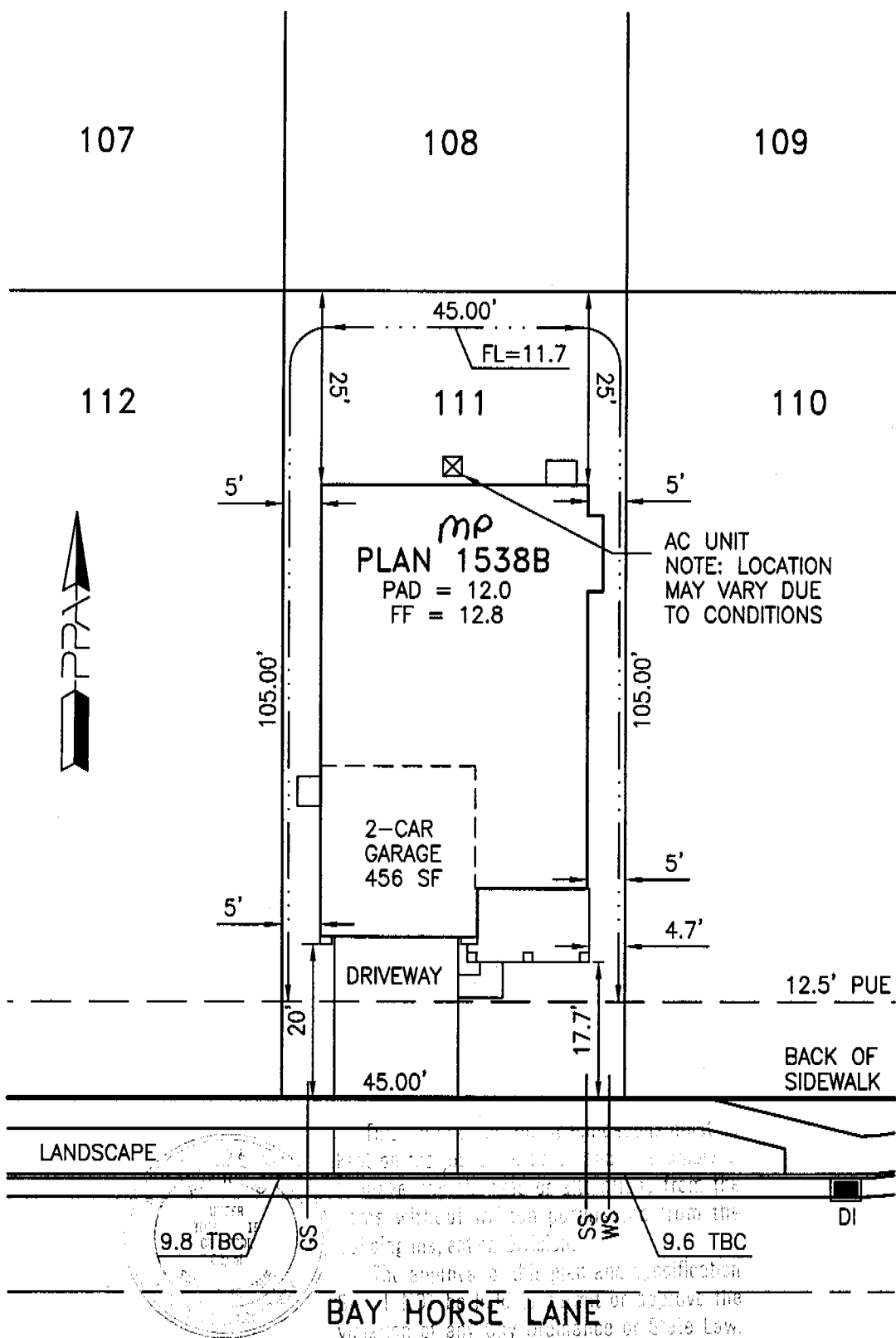

**BAY HORSE LANE**  
Violation of any City Ordinance or State Law.

Approved By:	US Home Corp. Rep.	Date
Revision	Approved By	Date
▲		
▲		

LOT AREA: 4725 SF  
 ALLOWED LOT COVERAGE: 2126 SF = 45.0%  
 ACTUAL LOT COVERAGE: 1994 SF = 42.2%  
 REAR YARD AREA: 1125 SF  
 NUMBER OF BEDROOMS:

It is understood that the drainage areas, slopes and grades shall not be altered, changed, blocked, modified or in any way be reconstructed by Owner contrary to what is depicted on this Plot Plan. THESE CONDITIONS RUN WITH THE LAND AND ARE BINDING ON ALL SUBSEQUENT OWNERS. All setback dimensions and elevations as shown may be adjusted to fit field conditions.

Plot Plan for Heritage at Natomas Park Village 19  
**Heritage Park - Caribbean**  
 2209 Bay Horse Lane, Sacramento, CA 95835

PPA Job #005010  
**Lot 111**  
 APN 201-0960-101

**US Home Corporation - Sacramento Division**  
 2366 Gold Meadow Way, Suite 200, Gold River, CA 95670 Phone (916) 858-3900 Fax (916) 858-3925

**Plot Plan Associates** www.plotplans.org  
 PO Box 435 Citrus Heights CA 95611-0435 (916) 769-9063

Date Drawn: 02/13/04 Scale: 1"=20'  
 Date Revised: - Drawn By: KLM

D:\005010\Plotplans\Village19\510190111.dwg

# CERTIFICATION OF INSULATION

PART I GENERAL  
PART II AREAS INSULATED  
PART III CERTIFICATION

ADDRESS OR TRACT

*U.S. Home Caribbean*

LOT # *511*

SACRAMENTO BUILDING PRODUCTS

- P.O. BOX 854, WEST SACRAMENTO, CA 95691 LIC. #202026
- 1309 MELODY ROAD, MARYSVILLE, CA 95901 LIC. #202026
- P.O. BOX 9651, FRESNO, CA 93793-9651 LIC. #202026
- P.O. BOX 1631, RENO, NV 89505 LIC. #10675
- 3326 A PONDEROSA WAY, LAS VEGAS, NV 89118 LIC. #10675

*9-13*

DATE INSULATION COMPLETED

WALLS

CEILING

FLOORS

( SQUARE FEET) ( SQUARE FEET) ( SQUARE FEET)

TYPE OF INSULATION

TYPE OF INSULATION

TYPE OF INSULATION

MATERIAL

**FIBERGLASS**

MATERIAL

**FIBERGLASS**

MATERIAL

**FIBERGLASS**

FORM

**BATTS**

FORM

**BATTS & BLOW**

FORM

**BATTS**

MANUFACTURER'S PRODUCT I.D.

MANUFACTURER'S PRODUCT I.D.

MANUFACTURER'S PRODUCT I.D.

MANUFACTURER

MANUFACTURER

MANUFACTURER

CT

OC

JM

CT

OC

JM

BAGS

CT

OC

JM

R - VALUE  
INSTALLED

APPLIED  
THICKNESS

R - VALUE  
INSTALLED

APPLIED  
THICKNESS

MIN. INSTALLED  
WEIGHT PER  
SQUARE FOOT

R - VALUE  
INSTALLED

APPLIED  
THICKNESS

*13*

*3 1/2*

*38*

*12  
14 3/4*

KNEE WALLS IF R-VALUE IS OTHER THAN WALLS ABOVE

MATERIAL

**FIBERGLASS**

FORM

**BATTS**

R VALUE

MANUFACTURER

CT

OC

JM

AIR INFILTRATION SEALANT

MATERIAL

*FOAM*

MANUFACTURER

**HILTI**

**HANDY FOAM**

THIS IS TO CERTIFY THAT INSULATION AND/OR SEALANT HAS BEEN INSTALLED IN CONFORMANCE WITH APPLICABLE CODES, MATERIAL STANDARDS AND REGULATIONS.

SIGNATURE -- INSULATION CONTRACTOR

*JL*

TITLE

**MANAGER**

DATE

*9-13-04*

SIGNATURE -- GENERAL CONTRACTOR

TITLE

DATE

REMARKS

INSTALLATION CERTIFICATE

CR-6R

US Home Corporation - Heritage Park Product Line 1 - Sacramento - Plan 1538

Site Address: 2209 Bay Horse Ln

Permit Number: 0402629

An installation certificate is required to be posted at the building site or made available for all appropriate inspections...

HVAC SYSTEMS:

Heating Equipment

Table with columns: Equip. Type (pkg. Heat pump), CEC Certified Mfg Name and Model #, # of Identical Systems, (1) Efficiency (AFUE, etc.) > CF-1(R) value, Duct Location (attic, etc.), Duct or Piping R-value, Heating Load (Btu/hr), Heating Capacity (Btu/hr). Row: Furnace, York SP414JA12L048, 1, 96.0, Attic, R-6, 26,452, 80,000.

Cooling Equipment

Table with columns: Equip. Type (pkg. Heat pump), CEC Certified Compressor Link MS Name and Model #, # of Identical Systems, (1) Efficiency (SEER, etc.) > CF-1(R) value, Duct Location (attic, etc.), Duct R-value, Cooling Load (Btu/hr), Cooling Capacity (Btu/hr). Row: AC, York 4M\*RC030, 1, 12.0, Attic, R-6, 24,894, 29,400.

(1) > means greater than or equal to. I, the undersigned, verify that equipment listed above is: 1) the actual equipment installed, 2) equivalent to or more efficient than that specified in the certificate of compliance...

Signature: Chris Cervico

Boulder Corporation
Installing Subcontractor (Co. Name)
OR General Contractor (Co. Name) OR Owner

WATER HEATING SYSTEMS:

Table with columns: Heater Type, CEC Certified Mfg Name & Model #, Distribution Type (gas, pilot, etc.), # of Recirculation Control Type, # of Identical Systems, (1) Rated Input (kW or Btu/hr), Tank Volume (gallons), (2) Efficiency (EF, EUE), (3) Standby Loss (%), External Insulation R-value. Row: GAS, 41-V40N, STD, N/A, 0, 49,000, 40, .56, 26.7.

(1) For front gas storage (rated input of less than or equal to 75,000 Btu/hr), electric resistance and heat pump water heaters, list Energy Factor... (2) R-12 external insulation is mandatory for storage water heaters with an energy factor of less than 0.58.

Faucets & Shower Heads:

All faucets and showerheads installed are certified to the Commission, pursuant to Title 24, Part 6, Section 111.

I, the undersigned, verify that equipment listed above by signature is: 1) the actual equipment installed, 2) equivalent to or more efficient than that specified in the certificate of compliance...

Signature: Dave O'Leary 04-04-03

Monarch Plumbing CO., INC.
Installing Subcontractor (Co. Name)
OR General Contractor (Co. Name) OR Owner

COPY TO: Building Department
HERA Provider (if applicable)
Building Owner at Occupancy

NO. 1312 P. 3/19

APR. 9. 2003 9:33PM MAIL U.S. HOME HERITAGE PARK