

CITY OF SACRAMENTO

Permit No: 9716280

1231 I Street, Sacramento, CA 95814

Insp Area: 1

Site Address: 1771 STOCKTON BL SAC

Sub-Type: REM

Parcel No: 0070362016

Housing (Y/N): N

CONTRACTOR

OWNER

ARCHITECT

DIALYSIS CLINIC INC
1600 HAYES ST STE 300
NASHVILLE TN 37203

GRESHAM, SMITH AND PARTNERS
511 UNION ST
SUITE #1400 37219

Nature of Work: REMODEL, FROM OFFICE TO DIALYSIS CLINIC,

CONSTRUCTION LENDING AGENCY: I hereby affirm under penalty of perjury that there is a construction lending agency for the performance of the work for which this permit is issued (Sec. 3097, Civ. C).

Lender's Name Lender's Address

LICENSED CONTRACTORS DECLARATION: I hereby affirm under penalty of perjury that I am licensed under provisions of Chapter 9 (commencing with section 7000) of Division 3 of the Business and Professions Code and my license is in full force and effect.

License Class License Number Date Contractor Signature

OWNER-BUILDER DECLARATION: I hereby affirm under penalty of perjury that I am exempt from the contractors License Law for the following reason (Sec. 7031.5, Business and Professions Code; any city or county which requires a permit to construct, alter, improve, demolish, or repair any structure, prior to its issuance, also requires the applicant for such permit to file a signed statement that he or she is licensed pursuant to the provisions of the Contractors License Law (Chapter 9 (commencing with Section 7000) of Division 8 of the Business and Professions Code) or that he or she is exempt therefrom and the basis for the alleged exemption. Any violation of Section 7031.5 by any applicant for a permit subjects the applicant to a civil penalty of not more than five hundred dollars (\$500.00);

I, as a owner of the property, or my employees with wages as their sole compensation, will do the work, and the structure is not intended or offered for sale (Sec. 7044, Business and Professional Code: The Contractors License Law does not apply to an owner of property who builds or improves thereon, and who does such work himself or herself or through his/her own employees, provided that such improvements are not intended or offered for sale. If, however, the building or improvement is sold within one year of completion, the owner-builder will have the burden of proving that he/she did not build or improve for the purpose of sale.)

X I, as owner of the property, am exclusively contracting with licensed contractors to construct the project (Sec. 7044, Business and Professions Code: The Contractors License Law does not apply to an owner of property who builds or improves thereon, and who contracts for such projects with a contractor(s) licensed pursuant to the Contractors License Law).

I am exempt under Sec. B & PC for this reason:

Date 5/21/98 Owner Signature Russell Wickhelt

IN ISSUING THIS BUILDING PERMIT, the applicant represents, and the city relies on the representation of the applicant, that the applicant verified all measurements and locations shown on the application or accompanying drawings and that the improvement to be constructed does not violate any law or private agreement relating to permissible or prohibited locations for such improvements. This building permit does not authorize any illegal location of any improvement or the violation of any private agreement relating to location of improvements.

I certify that I have read this application and state that all information is correct. I agree to comply with all city and county ordinances and state laws relating to building construction and hereby authorize representative(s) of this city to enter upon the abovementioned property for inspection purposes.

Date 5/21/98 Applicant/Agent Signature Russell Wickhelt

WORKER'S COMPENSATION DECLARATION: I hereby affirm under penalty of perjury one of the following declarations:

I have and will maintain a certificate of consent to self-insure for workers' compensation as provided for by Section 3700 of the Labor Code, for the performance of work for which the permit is issued.

I have and will maintain workers' compensation insurance, as required by Section 3700 of the Labor Code, for the performance of the work for which this permit is issued. My workers' compensation insurance carrier and policy number are:

Carrier Policy Number

(This section need not be completed if the permit is for \$100 or less) I certify that in the performance of the work for which this permit is issued, I shall not employ any person in any manner so as to become subject to the workers' compensation laws of California and agree that if I should become subject to the workers' compensation provisions of Section 3700 of the Labor Code, I shall forthwith comply with those provisions.

Date 5/21/98 Applicant Signature Russell Wickhelt

WARNING: FAILURE TO SECURE WORKER'S COMPENSATION COVERAGE IS UNLAWFUL AND SHALL SUBJECT AN EMPLOYER TO CRIMINAL PENALTIES AND CIVIL FINES UP TO ONE HUNDRED THOUSAND DOLLARS (\$100,000) IN ADDITION TO THE COST OF COMPENSATION, DAMAGES AS PROVIDED FOR IN SECTION 3706 OF THE LABOR CODE, INTEREST AND ATTORNEY'S FEE.

THIS PERMIT SHALL EXPIRE BY LIMITATION IF WORK IS NOT COMMENCED WITHIN 180 DAYS.

COUNTY SANITATION DISTRICT NO. 1  
 SACRAMENTO REGIONAL COUNTY SANITATION DISTRICT  
**SEWER IMPACT FEE** *gpb*  
 PERMIT AND CALCULATION SHEET *5/20/98*

APPLICATION NO. \_\_\_\_\_ BLDG. PERMIT NO. *CITY*

GENERAL INFORMATION

THIS PERMIT GOOD ONLY WHEN  
 VALIDATED BY THE CASHIER

**243034 MAY 20 98**

DEPT 26 SEWERWATER *\$2,570.00*  
 TR# 365478 05/20/98  
 RECEIPT 645897 014 *\$2,570.00*

THIS PERMIT TO CONNECT EXPIRES  
 ONE YEAR FROM DATE OF ISSUANCE

FEE CALCULATION

BUILDING USE

INSPECTION	RESIDENTIAL	SF	MF	UNITS
CSD-1	<input checked="" type="checkbox"/>		<input checked="" type="checkbox"/>	
SRCSO	<input checked="" type="checkbox"/>			
CONSTRUCTION				
IN-LIEU				

**TOTAL FEE** *\$ 2570 -*

APN: *007 - 0362 - 016*

DESCRIPTION / SUBDIVISION *N/A* LOT: *N/A*

PROPERTY ADDRESS *1791 Stockton Blvd*

OWNER *LVI Sacramento*

MAILING ADDRESS *161 Stockton Blvd Suite 100*

CITY-STATE-ZIP *Sacramento, CA 95816* PHONE *455-0803*

ADDITIONAL FEES MAY BE DUE IF CHANGES IN USE INCREASE SEWER IMPACT. *Fax 455-7323*

APPLICANT SIGNATURE *[Signature]*

CONSOLIDATED UTILITY BILLING USE ONLY

ACCT \_\_\_\_\_ INPUT \_\_\_\_\_ START \_\_\_\_\_  
 SEE REVERSE SIDE INSPECTOR'S COPY

**CITY OF SACRAMENTO**  
 BUILDING INSPECTION DIVISION  
 APPLICATION FOR BUILDING PERMIT - HAZARDOUS MATERIAL SURVEY

As Required by Assembly Bill #3205 - A Building Permit Cannot be Approved Without This Completed Form

1. Business Name: University Dialysis Clinic Inc. Phone: 916 453-0803  
 Site Address: 1771 Stockton Blvd. Suite: \_\_\_\_\_  
(Street) (Zip)  
 Business Owner/Representative: RUSSELL WEICHEL Phone: 916 453-0803

Nature of Business: \_\_\_\_\_

Property Owner: Dialysis Clinic Inc Phone: \_\_\_\_\_  
 Address: 1600 Hayes St STE 300 Suite: \_\_\_\_\_  
Nashville TN 3703  
(City) (State) (Zip)

2. Are you developing an undetermined tenant space? Yes \_\_\_ No L Is this permit for a shell building? Yes \_\_\_ No ✓

Notify lessee of the responsibility to coordinate with the Fire Department regarding the use and handling of hazardous materials.

3. Does/Will your business generate hazardous waste? Yes ✓ No 1

4. Does/Will your business handle, store or transport any solid, liquid, or gaseous chemicals? Yes \_\_\_ No ✓

**CONSULT THE EPA CHEMICAL LIST LOCATED AT THE BUILDING DIVISION COUNTER FOR HAZARDOUS OR ACUTELY HAZARDOUS MATERIALS TO COMPLETE THE FOLLOWING QUESTIONS.**

If you answered "YES" to questions #3 and/or #4 above, continue on to questions 5 - 8.

5. Do you handle, store, or transport 55 gallons, 500 pounds, or 200 cubic feet (at Standard Temperature or Pressure) of a product or formulation containing hazardous materials at any one time? Yes \_\_\_ No ✓

6. Do you handle, store or transport any amount of acutely hazardous materials? Yes \_\_\_ No ✓

7. Is/Will your business be located within 1,000 feet of a school? Yes \_\_\_ No ✓

If you answered "yes" to questions #6 and/or #7, complete the RMPP informational sheet.

8. Is/Will your business be located within 1,000 feet of a hospital, and/or long-term healthcare facility? Yes \_\_\_ No ✓

IF YOU ANSWERED "YES" TO QUESTION #3 AND/OR #4, PLEASE CONTACT THE CITY OF SACRAMENTO FIRE DEPARTMENT LOCATED AT 1231 I STREET, SUITE 401, SACRAMENTO, CA OR CALL 449-5416.

Prior to issuance of a certificate of occupancy, each business owner(s) shall contact the City of Sacramento Fire Department and comply with the Health and Safety Code regarding the use and handling of hazardous materials.

**PENALTY:** Any business that violates Section 25531-25541 of the Health and Safety Code shall be civilly liable to the administering agency in an amount of not more than two thousand dollars (\$2,000) for each day in which the violation occurs. If the violation results in, or significantly contributes to, an emergency, including a fire, the business shall also be assessed the full cost of the city emergency response, as well as the cost of cleaning up and disposing of the hazardous materials. Additional liability and punishment may be assessed for knowing a violation after reasonable notice of the violation.

Applicant's Name: RUSSELL WEICHEL  
(Print)  
Russell Weichel 5/21/98  
(Signature) (Date)

BID Use Only: Plan Ck# <u>5647</u> Permit # <u>97-16280</u>
OK to issue prmt <u>5-21-98</u> F.D. Appr Req'd? Yes <u>(No)</u>
init date _____
Hold on Certificate of Occupancy? Yes <u>(No)</u>
Fire Dept. Use Only:
OK to issue permit? init _____ date _____
OK to issue Certificate of Occupancy? init _____ date _____

CITY OF SACRAMENTO  
 APPLICATION FOR BUILDING PERMIT  
 DEPARTMENT OF PLANNING AND DEVELOPMENT  
 BUILDING INSPECTION DIVISION  
 1231 I Street, Room 200  
 Sacramento, CA 95814  
 (916) 264-7619 FAX 264-7046

99-16272-C  
 WATINC  
 9716280-C

ADDRESS 1771 STOCKTON BLVD.  
 PARCEL # 007-0362-016

P.C. # 5647  
 SUITE #  
 AREA # 1C

CONTACT  
 NAME James PERRY  
 ADDRESS 1600 HAYES ST. SUITE 300  
 NASHVILLE, TN ZIP 37203  
 PHONE 615-327-3066 FAX: ( )

LICENSED CONTRACTOR  
 NAME PHILIP DANIEL  
 ADDRESS  
 PHONE 510-829-7611  
 ZIP

ARCH./ENG. BILL ADAIR  
 NAME CRESHAM SMITH & PARTNERS  
 ADDRESS 1400 NASHVILLE CITY CT. 5TH FLOOR  
 NASHVILLE, TN ZIP 37219  
 PHONE 615-770-8270

OWNER  
 NAME DIALYSIS CLINIC, INC.  
 ADDRESS 1600 HAYES ST. SUITE 300  
 NASHVILLE, TN ZIP 37203  
 PHONE

WILL THE PERMITEE HAVE ANY EMPLOYEE'S ON THE JOBSITE?  YES  NO  
 NATURE OF WORK IN DETAIL: RENOVATION OF EXISTING BUILDING

FROM OFFICE BUILDING TO DIALYSIS CLINIC.  
 STAIRS, LANDSCAPING, MOVE ENTRANCE - DENNISON  
 CLINICAL CERTIFICATION REQUIRED  
 D.B.A. DCI

BELOW THIS LINE FOR BLDG. DEPT. USE ONLY  
 FLOOD STATUS A99  
 JOB DESCR. BLDG SHEL APT TI( ) REM(L) SW FIRE ADD OTH  
 BLDG  MECH  PLUMB  ELEC  SITE  FIRE  
 VALUATION  
 S.C.A.T. XI  
 Special insp stamp

# OF STORIES	AREA 1ST FL.	TOTAL AREA	USE ZONE	OCCUP. GROUP	CONST. TYPE	FIRE SPRINK.	FED CODE	VIO. FILE
2	8187	15,595		B-X	TBA	Y	M	1512
	L	P	M	E	F	S	D	
	JT	BD	DD	YM	JF	CRS	B	

COMMENTS:  
 REFLECTIVE CEILING PLAN SHOWING (EX) + relocate SPARK.  
 LETTER MED GASES SIZE TYPE & LOCATION  
 FIRE ALARM PLANS - SEPARATE PERMIT  
 Construction Type of Bldg.  
 3# sets of plans.  
 Valuation check for OSHPPD

Planning Division COMMERCIAL PRELIMINARY Information Request

BUILDING CHECK ONE:

Over the counter review and issue permit \_\_\_\_\_  
Will be taken in and reviewed for site conditions \_\_\_\_\_  
Will be taken in but not reviewed for site conditions \_\_\_\_\_  
Information only, pre-submittal information \_\_\_\_\_

Customer Name: \_\_\_\_\_ Phone Number: \_\_\_\_\_

Project address: 1771 Stockton Blvd.

APN: 007-0362-0116 Current site use: \_\_\_\_\_

INITIAL

Need to verify APN Proposed Site use: \_\_\_\_\_

Describe what is being requested: APPROVAL & COMMENTS

Remodel: Dialysis Inc

General Office to med clinic

Requested by: WT Date: 12/16/97

Zone C-4 Overlay / SPD / PUD / R-review \_\_\_\_\_

- Planning staff Review required \_\_\_\_\_
- Planning Hearing required \_\_\_\_\_
- Design Review required \_\_\_\_\_
- No Planning Issues \_\_\_\_\_
- Counter ok review by site cond. \_\_\_\_\_

Prior Applications on site P# 97-018 Z# \_\_\_\_\_

DR# \_\_\_\_\_ PB# \_\_\_\_\_ IR# \_\_\_\_\_

Comments: Special Permit to waive  
32 spaces (parking). Please  
check CPC file for conditions.

Planning review by: M. Weitzma Date: 12-16-97

MUST BE REVIEWED BY PLANNING

- |                 |                      |               |
|-----------------|----------------------|---------------|
| Care Facilities | Anything Residential | Restaurants   |
| Churches        | Day care             | Sidewalk Cafe |
| Drive-through   | Lot Line adjustments |               |
| Medical Offices | Bars                 |               |

Security gates  
CELLULAR COMMUNICATION FACILITIES

OWNER-BUILDER VERIFICATION

ATTENTION PROPERTY OWNER

An owner-builder building permit has been applied for in your name and bearing your signature.

Please complete and return this information in the envelope provided at your earliest opportunity to avoid unnecessary delay in processing and issuing your building permit. No building permit will be issued until this verification is received.

1. I personally plan to provide the major labor and materials for construction of the proposed improvement (yes or no) Yes

2. I (have/have not) have signed an application for a building permit for the proposed work.

3. I have contracted with the following person (firm) to provide the proposed construction:

Name Ph. Lips DAVIAL Group Address 6575 Trinity CT  
City Dublin, CA. Telephone 925-829-7611  
Contractors License No. Yes

4. I plan to provide portions of the work, but I have hired the following person to coordinate, supervise, and provide the major work.

Name \_\_\_\_\_ Address \_\_\_\_\_  
City \_\_\_\_\_ Telephone \_\_\_\_\_  
Contractors License No. \_\_\_\_\_

5. I will provide some of the work but I have contracted (hired) the following to provide the work indicated:

Name	Address	Phone	Type of Work

Signed Russell Wickelt

Job Address 1771 Stockton Blvd SAC Date  

Permit No.: \_\_\_\_\_



**EXHIBIT 1**

I have read and am familiar with the contents of City's standard Owner-Builder Notification and Owner-Builder Verification, as required by California Health and Safety Code Section 19830 and 19831. I authorize my agent(s) RUSS WEICHERT to sign the Owner-Builder Verification on my behalf.

Signature	<u>MEMURPHY (PDG BUILDERS)</u>
Print Name	<u>MIKE MURPHY</u>
Address	<u>6575 TRINITY CT.</u> <u>DUBLIN, CA.</u>
Telephone	<u>925-829-7611</u>

(SUBSTANTIAL IMPROVEMENTS)  
AGREEMENT REGARDING  
THE RISK OF FLOODING

RECITALS

A. The undersigned have contracted for construction of the improvements located at 1771 Adcock Lane Bl and described in the attached building permit (the "Improvements").

B. The undersigned expressly acknowledge that the Improvements may be subject to flooding hazards due to their location in a 100-year floodplain, as described in the Flood Insurance Rate Map dated November 15, 1989, ("FIRM"), prepared by the Federal Emergency Management Agency ("FEMA").

C. The undersigned acknowledge that they have read the Notice to Building Permit Applicants Regarding the Risk of Flooding attached as Exhibit "B."

D. Despite the potential for flood damage, the undersigned intend that the Improvements be constructed even though they will not be at least one foot above the 100-year floodplain elevation levels identified in the Preliminary Work Map dated January, 1989, prepared by the U.S. Army Corps of Engineers.

E. The undersigned acknowledge that the City of Sacramento (the "City") recommends obtaining flood insurance for the Improvements.

AGREEMENT

In consideration of the issuance of a building permit for construction of the Improvements, the undersigned agree as follows:

1. Flood-Related Property Damage. For purposes of this Agreement, the term "flood-related property damage" shall mean any property damage due to flooding resulting from an overtopping out of the channels of the Sacramento River, American River, Dry Creek, Arcade Creek or Morrison Creek levee systems or a break in those levee systems.

2. Assumption of Risk. The undersigned expressly assume the risk that the Improvements may be subject to flood-related property damage.

3. Waiver of Property Damage Claims. The undersigned unconditionally waive any flood-related property damage claim asserting liability on the part of the City, or its officers, agents or employees premised on the issuance of a permit for the Improvements,



9. Succession. The undersigned expressly intend that the obligations contained herein shall run with the Improvements and shall bind their respective heirs, assignees and successors in interest.

10. Termination. All of the obligations set forth in this Agreement shall terminate at such time as FEMA determines that the area in which the Improvements are located has attained at least 100-year flood protection.

DATED: 5/21/98

Russell Weichelt  
SIGNATURE

Administrator  
Title of Signatory if Signing for an Entity

RUSSELL WEICHEL  
Name

1771 Stockton Bl  
Address

SACRAMENTO, CA.

\_\_\_\_\_  
SIGNATURE

\_\_\_\_\_  
Title of Signatory if Signing for an Entity

\_\_\_\_\_  
Name

\_\_\_\_\_  
Address

**(SUBSTANTIAL IMPROVEMENTS)  
AGREEMENT REGARDING  
THE RISK OF FLOODING**

**RECITALS**

A. The undersigned have contracted for construction of the improvements located at 1771 Stockton Blvd and described in the attached building permit (the "Improvements").

B. The undersigned expressly acknowledge that the Improvements may be subject to flooding hazards due to their location in a 100-year floodplain, as described in the Flood Insurance Rate Map dated November 15, 1989, ("FIRM"), prepared by the Federal Emergency Management Agency ("FEMA").

C. The undersigned acknowledge that they have read the Notice to Building Permit Applicants Regarding the Risk of Flooding attached as Exhibit "B."

D. Despite the potential for flood damage, the undersigned intend that the Improvements be constructed even though they will not be at least one foot above the 100-year floodplain elevation levels identified in the Preliminary Work Map dated January, 1989, prepared by the U.S. Army Corps of Engineers.

E. The undersigned acknowledge that the City of Sacramento (the "City") recommends obtaining flood insurance for the Improvements.

**AGREEMENT**

In consideration of the issuance of a building permit for construction of the Improvements, the undersigned agree as follows:

1. **Flood-Related Property Damage.** For purposes of this Agreement, the term "flood-related property damage" shall mean any property damage due to flooding resulting from an overtopping out of the channels of the Sacramento River, American River, Dry Creek, Arcade Creek or Morrison Creek levee systems or a break in those levee systems.

2. **Assumption of Risk.** The undersigned expressly assume the risk that the Improvements may be subject to flood-related property damage.

3. **Waiver of Property Damage Claims.** The undersigned unconditionally waive any flood-related property damage claim asserting liability on the part of the City, or its officers, agents or employees premised on the issuance of a permit for the Improvements,

5/21/98

TYPE OF MED. GAS Oxygen

QUANTITY 2 Tank not to exceed 500 cu. ft  
@ NIP 504

LOCATION OF STORAGE Work room 124

PORTABLE OR PIPED circle one

<sup>owner</sup>  
Signature Russell Weichelt

RUSSELL WEICHELT - Administrator  
University Dialysis Clinic  
1771 Stockton Blvd.  
Sacramento, CA.

# COMBINATION FIRE/SMOKE DAMPER

1-1/2 Hour Rating

# SERIES - FSD120

Typical Installation

## COMBINATION FIRE/SMOKE DAMPER

### SERIES FSD120 COMBINATION FIRE/SMOKE DAMPER MOUNTED IN A SLEEVE WITH ELECTRIC ACTUATOR

#### Side View

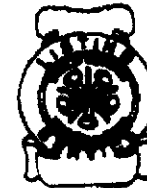
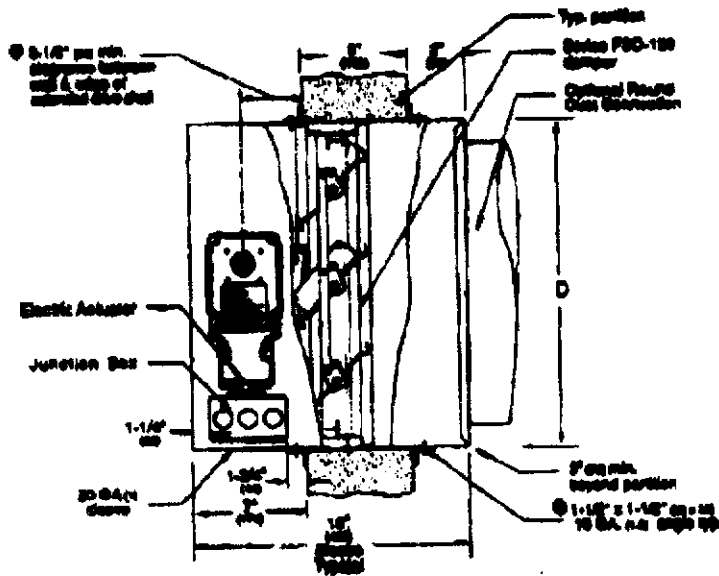

CSFM 83885-1404:105 &  
83830-1404:105

- Sleeve OD is approx. 1/8" (3) under nominal size.
- D dimension equals A & B dimensions for square sizes.
- D dimension equals A or B dimensions (whichever is smaller) for rectangular sizes.
- D dimension equals A & B dimensions for flat oval.

\* NOTE: Motor shown is for Power-Open application.

#### Isometric View

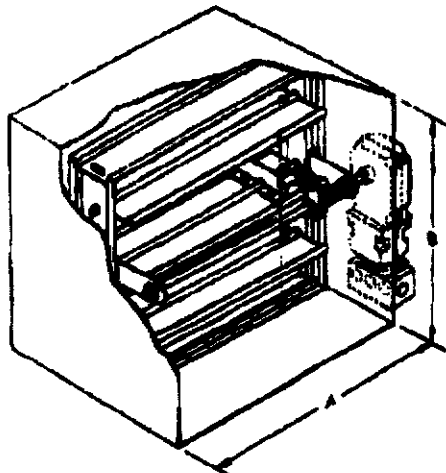

- Series FSD120 with melting fusible link.
- Series FSD120 with DS-30
- Series FSD120 with DS-10
- Series FSD120 with HS-10
- Series SD120 smoke only.

A = Nominal Size - 1/8" (3)  
B = Nominal Size - 1/8" (3)

Information is correct at time of printing. However, we reserve the right to make changes without notice.

NOTE: Dimensions in parentheses ( ) are minimums.

C & S Air Products • Mantebello, California • Fax (213) 889-8931

spec: FSD120 Typical installation 4/98

# COMBINATION FIRE/SMOKE DAMPER

1-1/2 Hour Rating

# SERIES - FSD120

Typical Installation with Smoke Detector

## COMBINATION FIRE/SMOKE DAMPER

### SERIES FSD120 COMBINATION FIRE/SMOKE DAMPER MOUNTED\*\* IN A SLEEVE WITH ELECTRIC ACTUATOR AND DH-400 AC/DC DUCT SMOKE DETECTOR

#### Side View

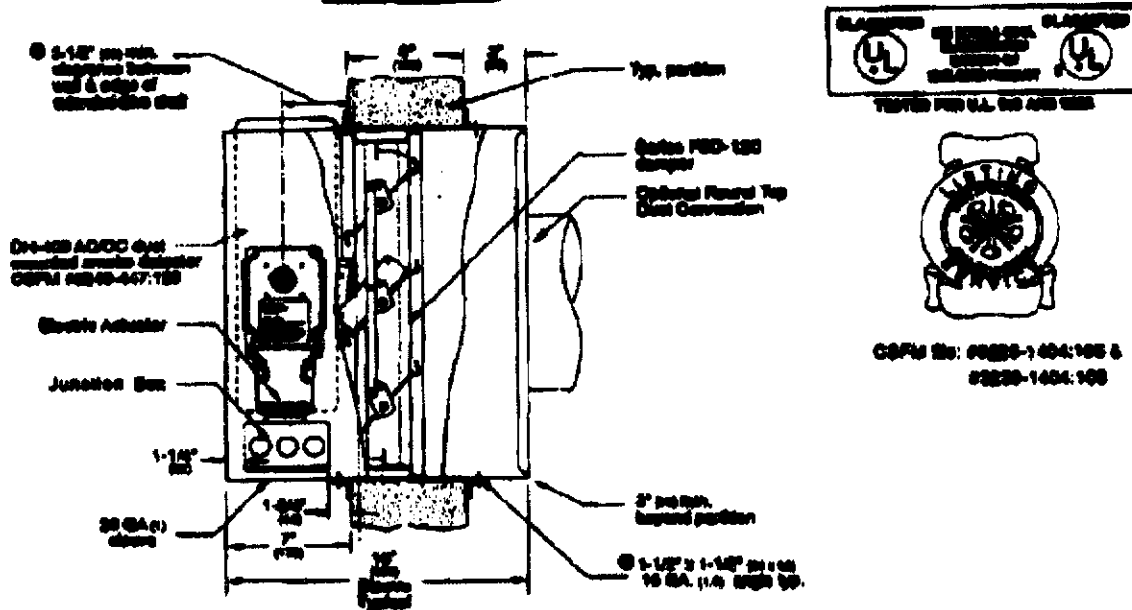

\* NOTE: Motor shown is for Power-Open application.

#### Isometric View

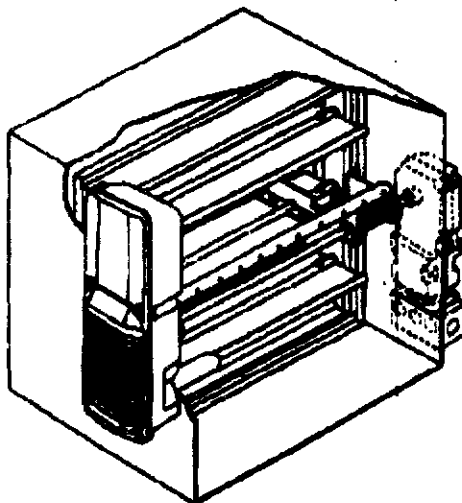

- Series FSD120 with melting fusible link.
- Series SD120 smoke only.

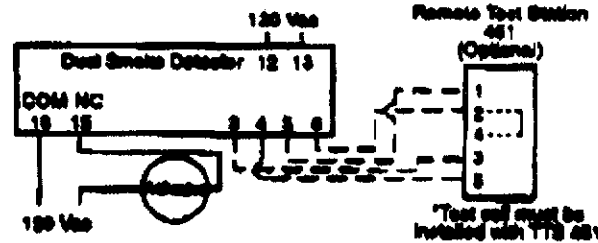

\*\* Motor and detector mechanically mounted and electrically interconnected by factory to provide single source power connection. Information is correct at time of printing. However, we reserve the right to make changes without notice. NOTE: Dimensions in parentheses ( ) are millimeters.

C & S Air Products • Montebello, California • Fax (213) 889-4931

# COMBINATION FIRE/SMOKE DAMPER

1-1/2 Hour Rating

# INSTALLATION INSTRUCTIONS

Models - FSD121, FSD122, & FSD123

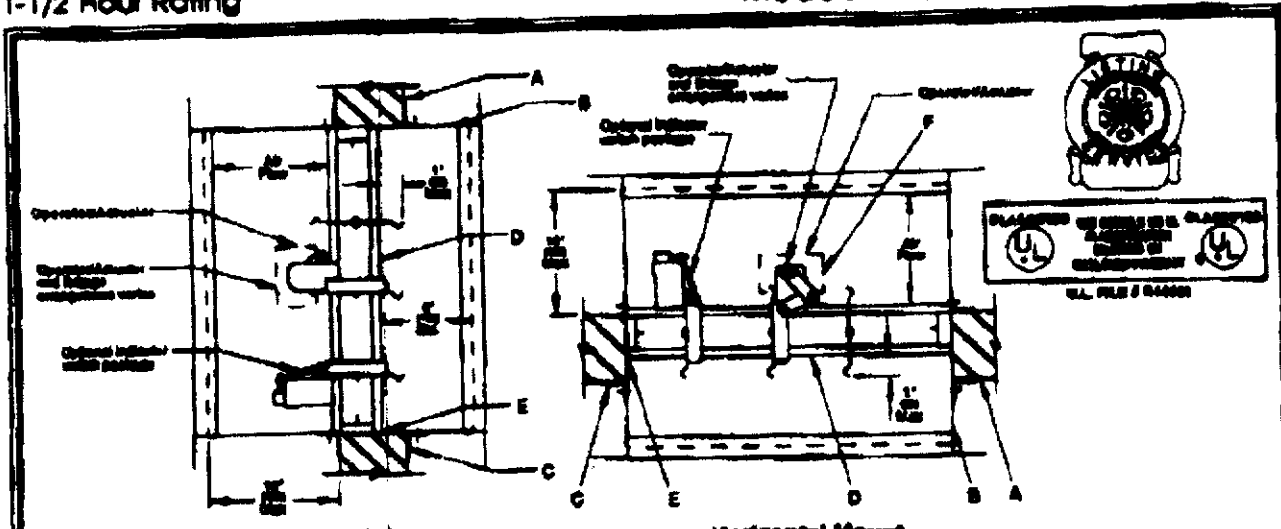

**Note:** - All dimensions shown in ( ) are in millimeters.  
 - Illustration depicts damper installed vertical right side up. Damper may also be installed up side down.

**Note:** - Illustration depicts damper installed from the top down with the actuator above the ceiling line. Damper may also be installed from the bottom up with the actuator below the ceiling line.

- A. Concrete or masonry fire partition shown. See Wood Stud and/or Steel Stud Framing for Fire Dampers in Drywall and/or Cavity Sheathed Partitions Supplemental Installation Instructions for further vertical mount installation details. Opening shall be a minimum 1/8" per foot (3000) larger than the overall damper and sleeve assembly size. Maximum opening size shall not exceed 1/8" per foot (3000) plus 1" (25), nor shall the opening be less than 1/4" (6) larger than the overall damper and sleeve assembly size. Damper must be installed with leading edge of closed blade within the partition.
- B. For rigid type duct connections, the sleeve shall be a minimum of 16 gage (1.6) for dampers up to 36" wide by 26" high (914 x 610) and 14 gage (1.9) for larger units. When lighter gage sleeves are used, one or more of commonly used break away duct connections are required. Refer to Sleeve Termination Supplemental Installation Instructions for further details. In no case will the sleeve gage be less than the duct gage to which it is connected. Damper sleeve shall not extend more than 1/8" (3mm) beyond the rated portion on the actuator side. The opposite end extension shall be a maximum of 0" (0mm) unless an access door is installed in the sleeve which then permits the extension to be a maximum of 1/8" (3mm).
- C. Mounting angles shall be a minimum of 1-1/2" x 3/4" x 20 gage (38 x 19 x 1) for dampers up to 36" wide x 48" high (914 x 1219) and 1-1/2" x 1-1/2" x 16 gage (38 x 38 x 1.4) on larger units. Fastening or welding angles together at the corners is not required. The angles shall be attached to the sleeve, not the partition, with 3/16" (4.8) diameter steel rivets, Quick-Link Joints, welds, or No. 10 (240) bolts or sheet metal screws at 8" (203) o.c. maximum. A minimum of two connections per side, top, bottom. Mounting angles shall overlap the wall a minimum of 1" (25). A minimum 3/4" x 20 gage (19x 1) flange termination may be used in lieu of mounting angles on one side. Refer to Sleeve Termination Supplemental Installation Instructions for further details. Ensure that attachment device does not interfere with the operation of the damper and the free movement of the damper blades.
- D. When joining multiple sections or fastening the damper to the sleeve, the damper shall be fastened with 3/16" (4.8) diameter steel rivets, Quick-Link Joints, welds, or No. 10 (240) bolts or sheet metal screws at 8" (203) o.c. maximum. A minimum of two connections per side, top, bottom.
- E. A continuous bead of Dow-Corning 995, Dow-Corning 722, Fibretek, or GE RTV silicone rubber sealant shall be applied between the damper and the sleeve and between sections of a multiple damper assembly. Sealant is only required on one side of the damper.
- F. Fire-Resistant rated dampers and qualified operators are tested together by Underwriters Laboratories and are factory installed to qualify for standard damper-together warranties. Field installed qualified operators must bear the C&S Air Products UL Label and shall be installed according to the specific operator installation instructions for mounting arrangements, duct velocity, and damper size. Damper operator actuator must be tested prior to system start-up to ensure proper operation. Before applying power to the operator-actuator, the power must be verified.

Model: FSD121, FSD122, FSD123, For use in Dynamic or Static Systems  
 1-1/2 Hour Rating

SECTION SIZES	SALVAGED STEEL		STAINLESS STEEL	
	VERTICAL	HORIZONTAL	VERTICAL	HORIZONTAL
MAXIMUM SINGLE SECTION	36" x 48" (914 x 1219)	36" x 48" (914 x 1219)	36" x 48" (914 x 1219)	36" x 48" (914 x 1219)
MAXIMUM MULTIPLE SECTION	102" x 84" or 72" x 144" (2590 x 2133) or (1829 x 3658)	102" x 84" or 72" x 144" (2590 x 2133) or (1829 x 3658)	72" x 48" or 36" x 84" (1829 x 2133) or (914 x 2133)	72" x 48" or 36" x 84" (1829 x 2133) or (914 x 2133)
MINIMUM	18" x 6" (457 x 152)	18" x 6" (457 x 152)	18" x 6" (457 x 152)	18" x 6" (457 x 152)

PROVIDE CLEARANCE MINIMUM 6mm TO 8" (25) X 8" (203)

The product is also listed by CGFM No. 20225-1404:106 & 20225-1404:105 and conforms to NFPA 99-A and NFPA 99-B.

Information is correct at time of printing. However, we reserve the right to make changes without notice.

NOTE: Dimensions in parentheses ( ) are millimeters.

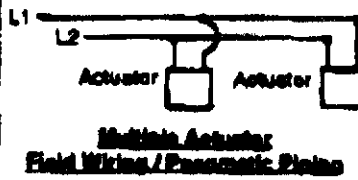

**SLEEVE TERMINATIONS**

**INSTALLATION INSTRUCTIONS SUPPLEMENT**  
For Fire Dampers

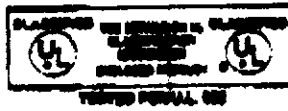

Note: All dimensions shown in ( ) are in millimeters.

1) Dust-sleeve connections listed in UL 656, 657 Edition, "Standard For Fire Dampers".



2) Additional dust-sleeve connections which were tested and witnessed by UL. The connections performed within the requirements of the UL test criteria.

(a) Sheet Metal Screws-Rectangular Dust Connections  
Joints using connections shown in 1), above with a maximum of two No. 10 (MS) sheet metal screws on each side and on the bottom located in the center of the slip pocket and penetrating both sides of the slip pocket. Note: UL tested dust sealant may be used.

(b) Sheet Metal Screws-Round Dust Connections  
Joints where round or oval spiral ducts attach to round or oval collars which are part of the damper sleeve as shown below. No. 10 (MS) sheet metal screws are spaced equally around the circumference of the duct per the following:

- Duct diameters 22" (560) and smaller—3 screws.
- Duct diameters over 22" (560) to and including 28" (715)—4 screws.

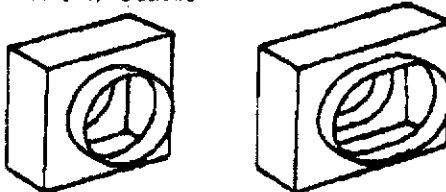

DAMPERSLEEVE ASSEMBLIES WITH COLLARS FOR ROUND AND FLAT OVAL DUCTS

**Notes:**

- (1) For flat oval ducts, the diameter shall be considered the largest (major) dimension of the duct.
- (2) UL tested dust sealant may be used.

(c) Flat Drive Slips



Joints using connectors of the types shown in 1), above on the top and the bottom and using flat drive slips not exceeding 20" (508) duct height on the sides (see sketch above). Note: UL tested dust sealant may be used.

Information is correct at time of printing. However, we reserve the right to make changes without notice.

**FLANGED DUCT CONNECTIONS**

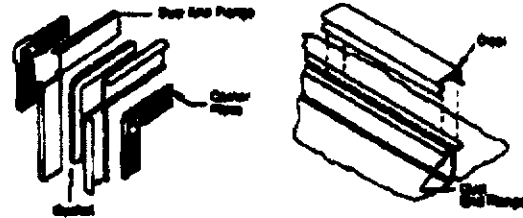

(d) TDC and YDF roll-formed 4-bolt flanged connections assembled per the manufacturer's instructions using gaskets and metal cleats. Do not bolt corners together.

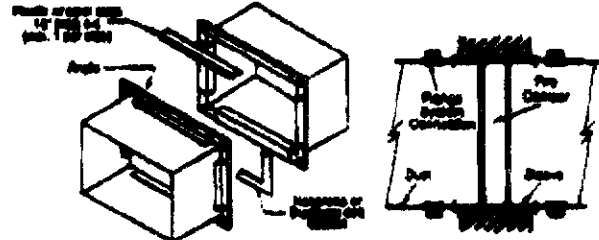

(e) Ductmate, Ward and Nazam slip on 4-bolt flanged connections assembled per the manufacturer's instructions using gaskets and cleats as shown above. Do not bolt corners together.

**General Installation for Flanged Dust Connections**

Flange corner pieces insert into the hollow web of the angles and slip over the duct and sleeve. Closed cell neoprene gasket or Ductmate 440 gasket tape is then applied to one face of the flange. To complete installation, bolt the flange faces together, aligning edges, and install cleats over the flange. Cleats shall be 8" (203) long, plastic or steel. Install minimum one per side, spaced 12" (305) center to center.

**FLAME TERMINATION AT A COLLAR**

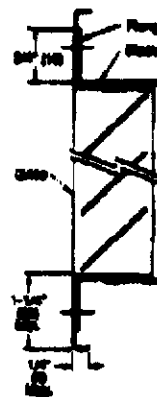

Grille (by others) must be minimum 28 gauge (0.4) steel.

Grille is to be screwed to minimum 24" x 30 gauge (16 x 1) flange. Do not secure grille to the wall.

Grille flange must be minimum 1-1/4" (32) and overlap the opening a minimum of 1/2" (13).

Seal the damper with sleeve of sufficient length to permit attachment, with partner mating angles, to duct work on one side of the wall, floor or ceiling opening. Detail shown is for vertical application.

**Application**

All of these connections may be used to terminate the damper sleeve in place of slip joints, for Puller's multiple blade or single blade fire dampers, curtain type fire dampers, and combination fire-smoke dampers.

NOTE: Dimensions in parentheses ( ) are millimeters.

**METAL STUD FRAMING FOR  
FIRE DAMPERS DRYWALL PARTITIONS**

**INSTALLATION INSTRUCTIONS SUPPLEMENT**

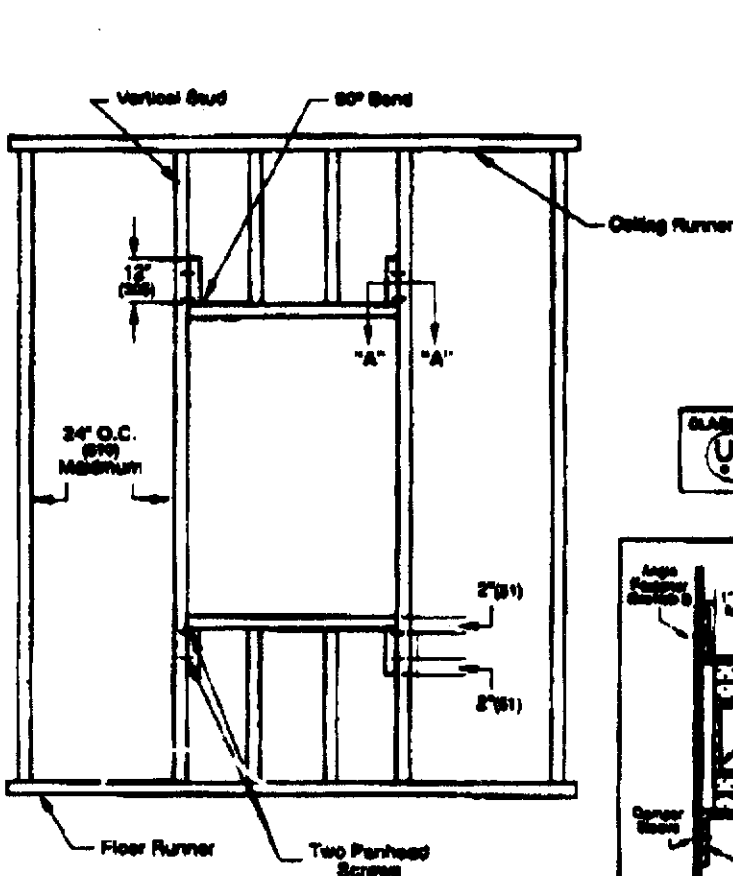

**Opening Preparation Detail**

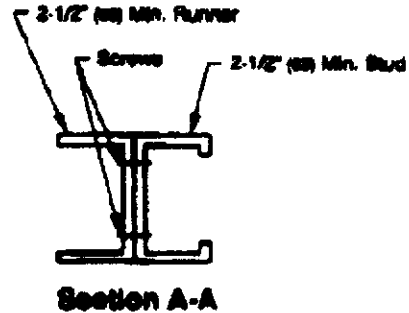

**Section A-A**

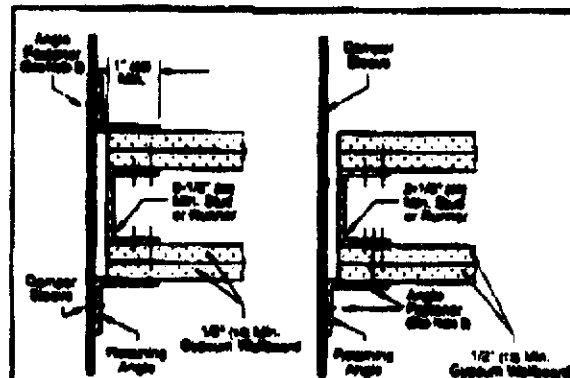
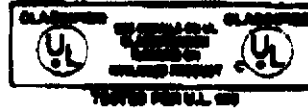

**2 Hr. Wall Rating**

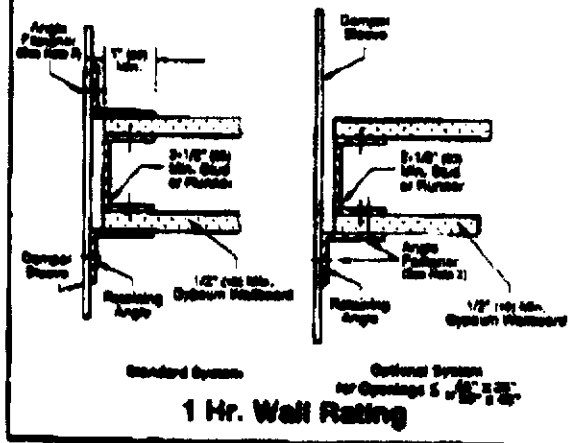

**1 Hr. Wall Rating**

**NOTES**

- Gypsum panels must be screwed 12" (305) O.C. maximum to all stud and runner flanges surrounding opening.
- Mounting angles shall be a minimum of 1-1/2" x 1-1/2" x 16ga. (38 x 38 x 1.6). For opening sizes ≤ 48" x 36" (1234 x 918) or 36" x 48" (918 x 1234) retaining angles are only required on one side of the partition and must be attached to the sleeve and the partition. The mounting angles may be located on the exterior surface of the wallboard (as shown) or may also be placed behind the drywall and in direct contact with the stud or runner. For larger openings (or optional on smaller openings as well), retaining angles are required on both sides of the partition and must be attached to the sleeve. Attachment to the sleeve and/or the partition shall be with No. 10 (M2) sheet metal screws, or welds, or 1/4" (6) x 20 bolts at 12" (305) e.s. maximum. A minimum of two connections per side, top, bottom. Mounting angles shall overlap the wall a minimum of 1" (25). A minimum 3/4" x 20 gage (19 x 1) flange termination may be used in lieu of mounting angles. Refer to Sleeve Termination Supplemental Installation Instructions for further details.
- See standard installation instruction sheets for additional details.
- For dampers larger than 120" x 80" (3048 x 2032) double vertical studs are required.

Information is correct at time of printing. However, we reserve the right to make changes without notice.

Note: All dimensions shown in ( ) are in millimeters.

NOTE: Dimensions in parentheses ( ) are millimeters.

C & S Air Products • Montebello, California • Fax (213) 689-6931



# METALSTUD FRAMING FOR FIRE DAMPERS IN CAVITY SHAFT WALL PARTITIONS

# INSTALLATION INSTRUCTIONS SUPPLEMENT

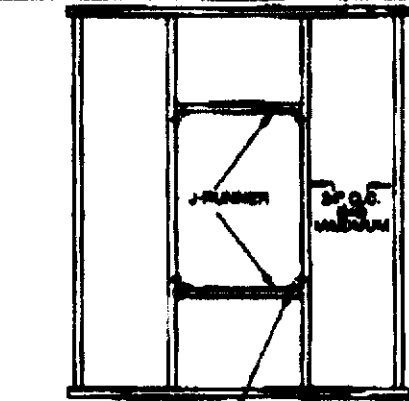

Opening Preparation Detail

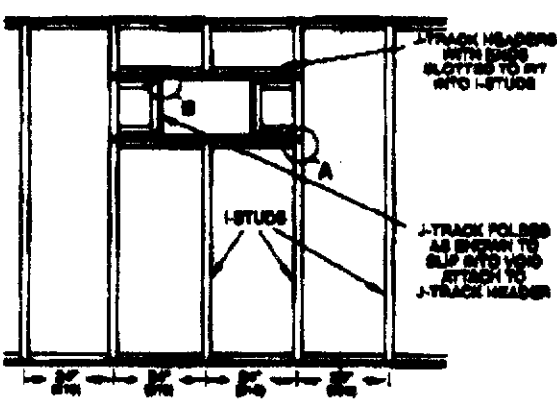
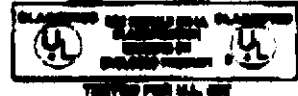
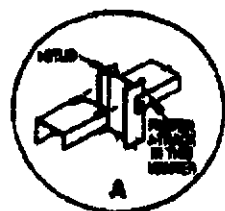

Optional Opening Preparation Detail for I-Stub Assembly

### NOTES

- Gypsum panels must be screwed 12" (305 mm) O.C. maximum to all stud and runner flanges surrounding opening.
- Mounting angles shall be a minimum of 1-1/2" x 1-1/2" x 16ga. (38 x 38 x 1.5). For opening sizes ≤ 48" x 36" (1224 x 914) retaining angles are only required on one side of the partition (see adjacent drawings) and must be attached to the studs and the ceiling. The mounting angles may be located on the exterior surface of the wallboard (as shown) or may also be placed behind the drywall and in direct contact with the stud or runner. For larger openings (for optional smaller openings as well), retaining angles are required on both sides of the partition and must be attached to the sleeve. Attachment to the sleeve and/or the partition shall be with No. 10 (20) sheet metal screws, or welds, or 1/4" (6.3) x 30 bolts at 12" (305 mm) O.C. maximum. A minimum of two connections per side, top, bottom. Mounting angles shall overlap the wall a minimum of 1" (25). A minimum 3/4" x 30 gage (10 x 1) flange termination may be used in lieu of mounting angles. Refer to Sleeve Termination Supplemental Installation Instructions for further details.
- See standard installation instruction sheets for additional details.

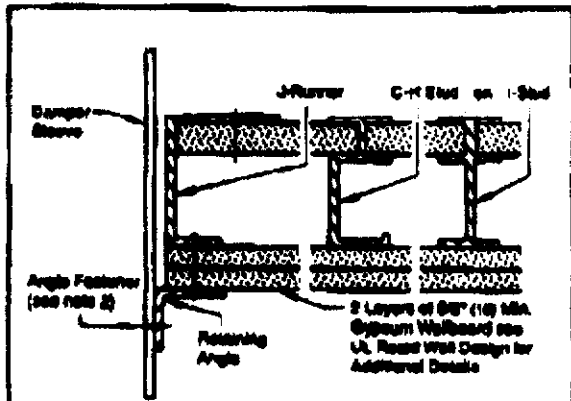

2 Hr. Wall Rating

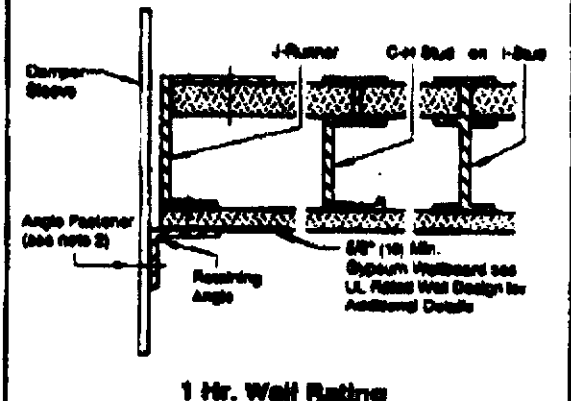

1 Hr. Wall Rating

Information is correct at time of printing. However, we reserve the right to make changes without notice.

NOTE: Dimensions in parentheses ( ) are millimeters.

C & S Air Products • Montebello, California • Fax (213) 889-4931

FIRE DAMPERS I.I. Supplement - 07 01/98

**WOOD STUD FRAMING FOR FIRE DAMPERS IN DRYWALL PARTITIONS**

**INSTALLATION INSTRUCTIONS SUPPLEMENT**

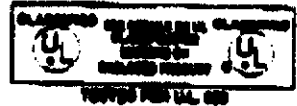
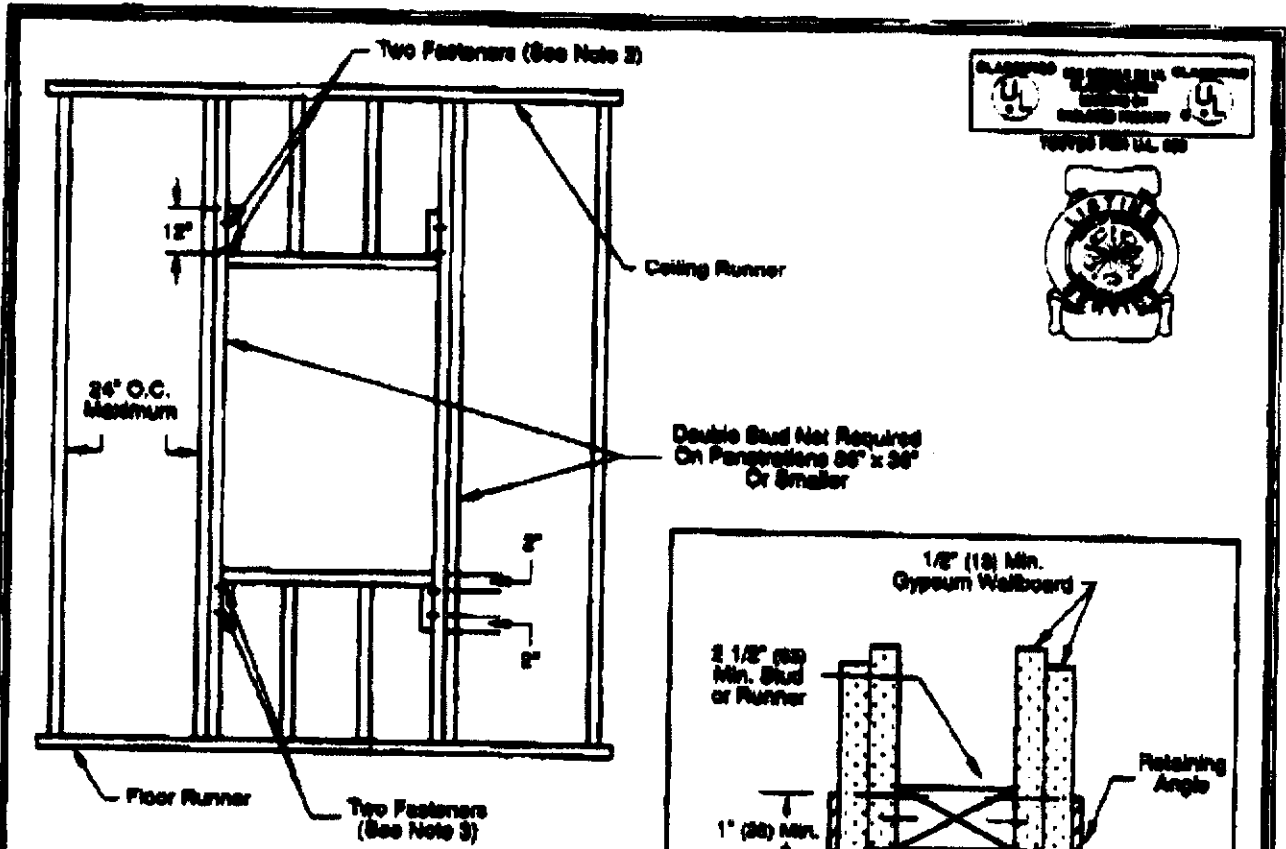

Double Stud Not Required On Partitions 24" x 24" Or Smaller

Opening Preparation Detail

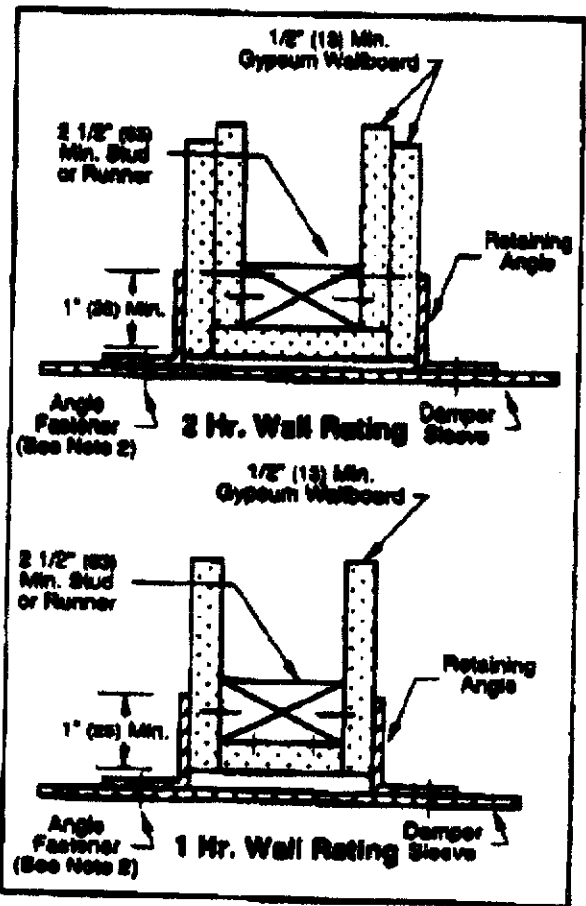

**NOTES**

1. Gypsum panels must be laced 12" (305) O.C. maximum to all stud and runner flanges surrounding opening.
2. Mounting angles shall be a minimum of 1-1/2" x 1-1/2" x 16ga (as x 36 x 1.6). The angles should be attached to the sleeve, not the partition, with No. 10 (Mn) sheet metal screws, or welds, or 1/4" (6.4) x 20 bolts at 12" (305) o.c. maximum. A minimum of two connections per side, top, bottom. Mounting angles shall overlap the wall a minimum of 1" (25). A minimum 3/4" x 20 gage (16 x 1) flange termination units sleeve flange may be used in lieu of mounting angles. Refer to Sleeve Termination Supplemental Installation Instructions for further details.
3. All fasteners to be per U.L. Classified wall design.
4. See standard installation instruction sheets for additional details.

Information is correct at time of printing. However, we reserve the right to make changes without notice.

NOTE: Dimensions in parentheses ( ) are millimeters.

C & S Air Products • Montebello, California • Fax (213) 869-6931

