

APPLICATION FOR COMMERCIAL BUILDING PERMIT

CITY OF SACRAMENTO
 DEVELOPMENT SERVICES DIVISION
 PERMIT SERVICES SECTION

1000 Capitol Mall, Sacramento, CA 95834 (916) 264-7619 FAX (916) 264-7046

ACTIVITY # <u>0005651</u>	Insp. Area <u>2</u>
------------------------------	------------------------

Applicant **MUST** complete ALL Unshaded areas

ADDRESS 2301 SUTTER BLVD DRIVE Suite 1
 PARCEL # _____

<p align="center">CONTACT</p> <p>Name _____ Street address _____ City/State/Zip _____ Phone _____ FAX _____ E-mail _____</p>		<p align="center">LICENSED CONTRACTOR Lic No. # <u>356222</u></p> <p>Name <u>Herbert J. Wiest</u> Address <u>5312 Sandburg Drive</u> City/State/Zip <u>Sacramento, Ca</u> Phone <u>(916) 451-0579</u> FAX _____ E-mail: _____</p>	
<p align="center">ARCHITECT/ENGINEER</p> <p>Name <u>J. H.</u> Address _____ City/State/Zip _____ Phone _____ FAX _____ E-mail _____</p>		<p align="center">OWNER'S Rep.</p> <p>Name <u>Dave Edwards</u> Address <u>8415 Elder Creek Road</u> City/State/Zip <u>Sacramento, Ca, 95828</u> Phone <u>381-0609</u> FAX <u>381-8671</u> E-mail: _____</p>	

→ Will permittee have any employees on the jobsite? No Yes → INSURANCE CO: _____
 → WORKER'S COMPENSATION POLICY # _____ EXPIRATION DATE: _____

NATURE OF WORK IN DETAIL: Extend Gas Line to warehouse below roof
Add 200 Amp panel - Electrical - 3 phase above roof x 10 feet to utility panel (SMUD)

OCCUPANT/TENANT: _____ VALUATION: \$ 4500.00

FLOOD STATUS				S.C.A.T.						
JOB DESCRIPTION		BLDG	SHELL	APT	TI()	REM()	SW	FIRE	ADD	OTH
INSPECTION DISCIPLINES			BLDG	MECH	<u>PLUMB</u>	<u>ELEC</u>	SITE		FIRE	
# Stories	1st Flr Area	Total Area	Use Zone	Occp Group	Const type	Fire Req. Y/N		Fed Code		Vio. File
				<u>5-31-00</u>		SPR	ALARM			[H] [Quad]
B	L	P	M	E	F	S		D	PW	UTIL
		<u>MS-Gen</u>		<u>T.L.M. 13</u>						

COMMENTS: Plan on microfilm

REGIONAL SANITATION FEES? Yes No HEALTH DEPARTMENT? Yes No
 WATER FLOW TEST FOR NEW BUILDINGS OR ADDITIONS? Provided Faxed

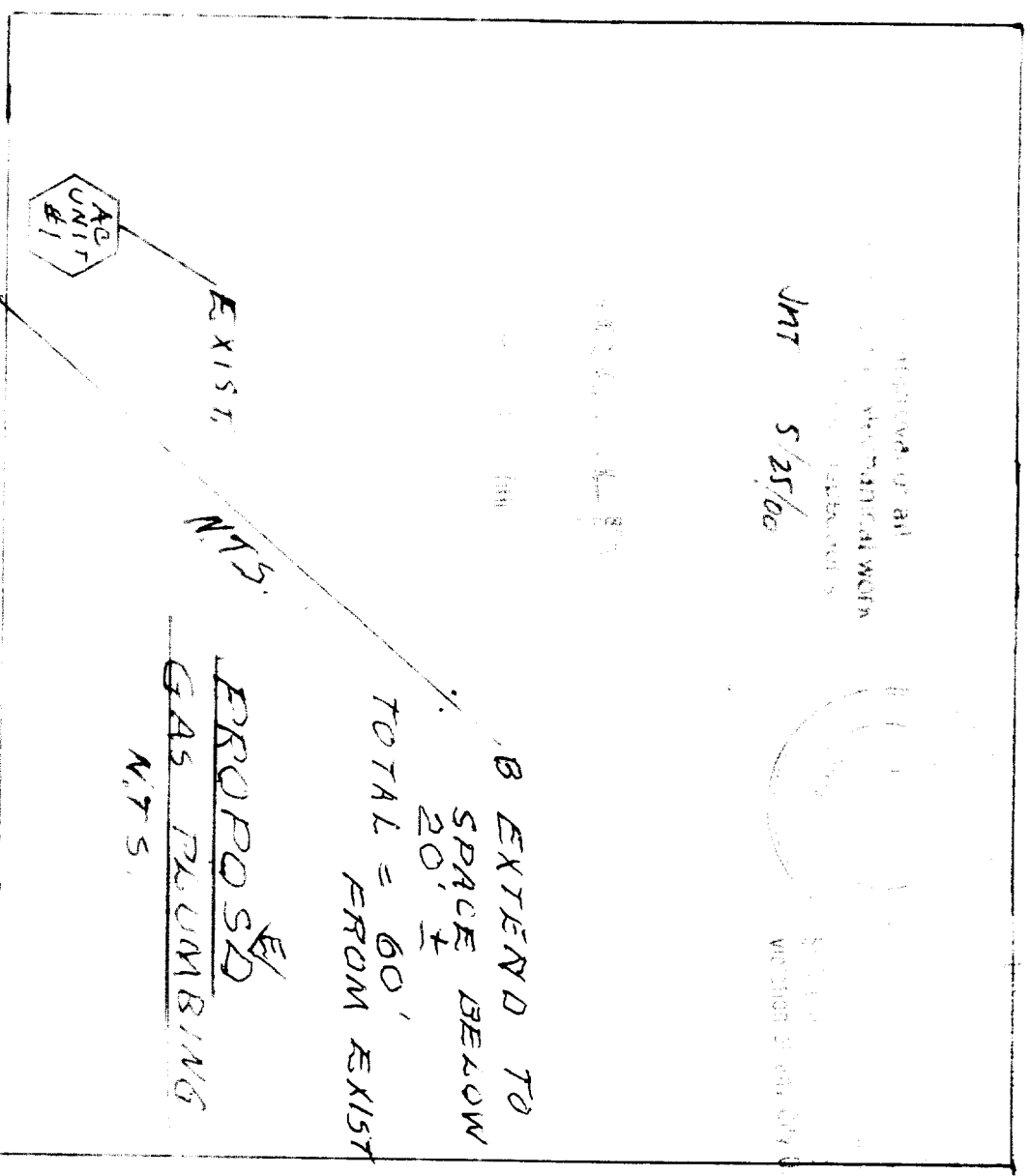

B EXTEND TO
SPACE BELOW
20' ±
TOTAL = 60'
FROM EXIST

PROPOSED
GAS PLUMBING
N.T.S.

NOTE:
1. ADD 40' RIMCH
GAS PIPE, AB
(Verify)

EXIST
2"
FROM EXIST/
GAS METER

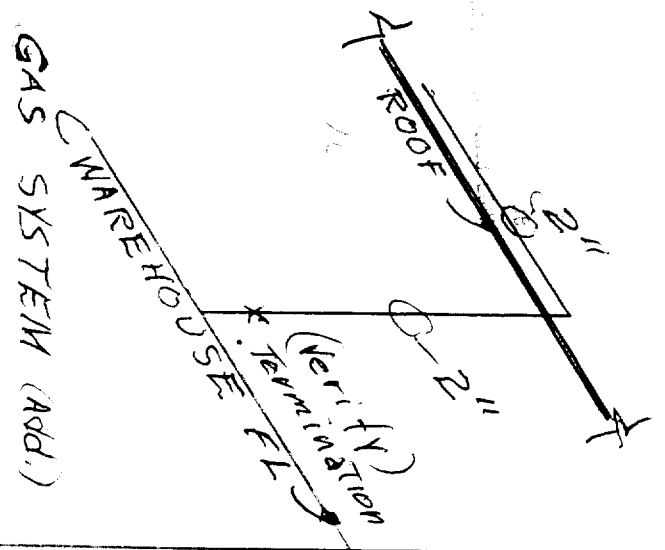

WAREHOUSE USE
GAS SYSTEM (ADD.)

DATE: 5-25-00
6301 SKY CREEK DR
SUITE 1
TENANT SPLASH
PHONE: 488 0180

0119

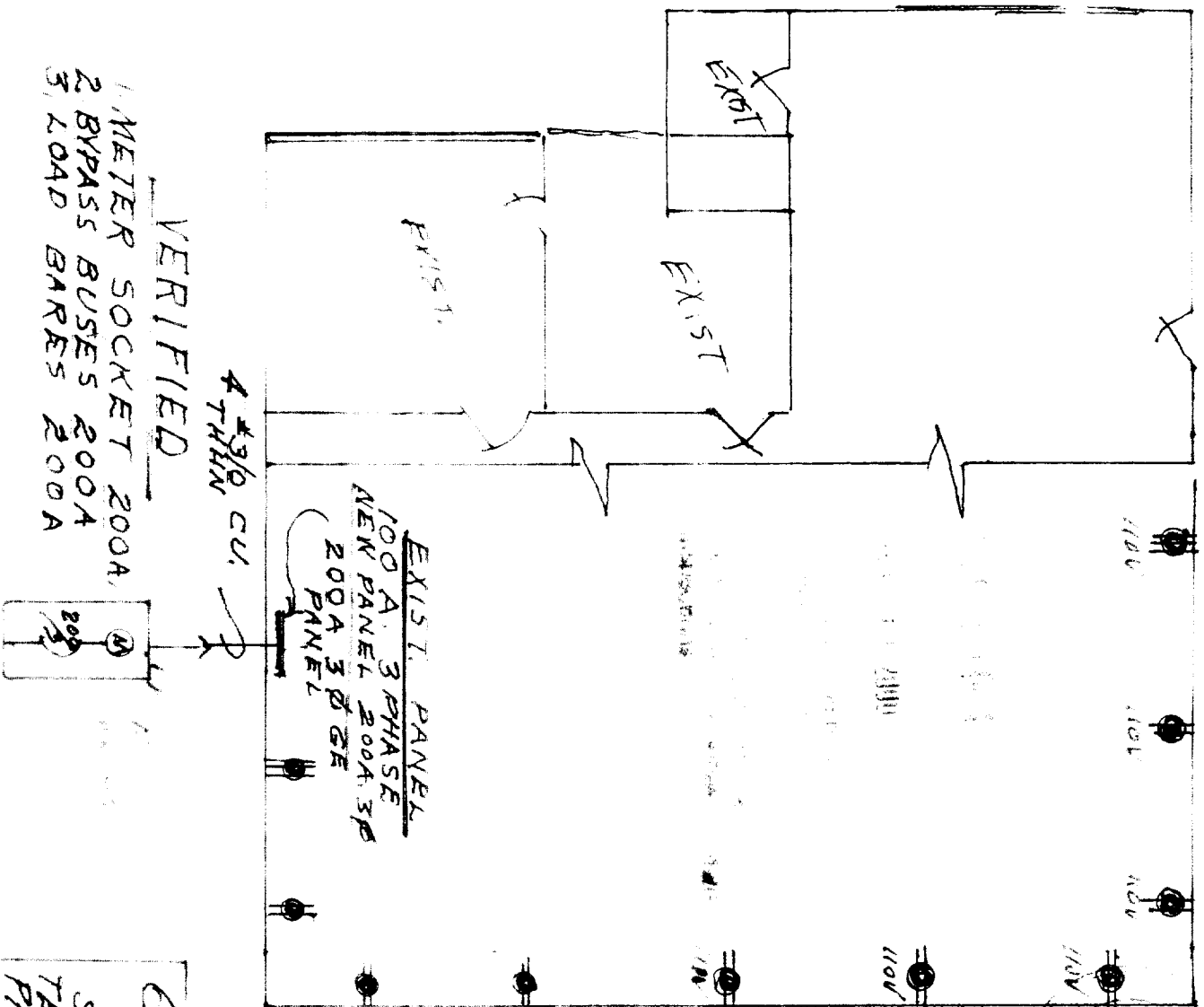

NOTES:

1. EXIST. LOAD. 214 ^{7.5 KW}
2. ADDED LOAD 80A
- * 110V. 2.2 KW 20A
- * 220V 12.2 KW 60A
- TOTALS 21.9 KW 107A

* ADDITIONAL

There will be no final
until a permit for the installation
of the equipment is issued
separate permit required

T.L.M. 5-31-2000

VERIFIED

1. METER SOCKET 200A
2. BYPASS BUSES 200A
3. LOAD BARS 200A

6301 SKY CREEK DR
SUITE #1
SACRAMENTO, CA.
TENANT. SPLASH PROMOTIONS
PHONE: 488-0184