

CITY OF SACRAMENTO
1231 I Street, Sacramento, CA 95814

Permit No: 0011878
Insp Area: 4

Site Address: 1132 ASCOT AV SAC
Parcel No: 226-0080-007 BLDG B

Sub-Type: RES
Housing (Y/N): N

CONTRACTOR
G W EXCAVATING
2236 Q ST
RIO LINDA, CA 95673

OWNER
SAFCA
1007 7TH ST FIFTH FLOOR
SAC CA

ARCHITECT

Nature of Work: DEMO BLDG/SEPTIC ABANDONMENT AFTER BLDG DEMO

CONSTRUCTION LENDING AGENCY : I hereby affirm under penalty of perjury that there is a construction lending agency for the performance of the work for which this permit is issued (Sec. 3097, Civ. C).

Lender's Name _____ Lender's Address _____

LICENSED CONTRACTORS DECLARATION: I hereby affirm under penalty of perjury that I am licensed under provisions of Chapter 9 (commencing with section 7000) of Division 3 of the Business and Professions Code and my license is in full force and effect.

X License Class AC21 License Number 576368 Date 10/6/00 Contractor Signature Crystal

OWNER-BUILDER DECLARATION: I hereby affirm under penalty of perjury that I am exempt from the contractors License Law for the following reason (Sec. 7031.5, Business and Professions Code; any city or county which requires a permit to construct, alter, improve, demolish, or repair any structure, prior to its issuance, also requires the applicant for such permit to file a signed statement that he or she is licensed pursuant to the provisions of the Contractors License Law (Chapter 9 (commencing with Section 7000) of Division 8 of the Business and Professions Code) or that he or she is exempt therefrom and the basis for the alleged exemption. Any violation of Section 7031.5 by any applicant for a permit subjects the applicant to a civil penalty of not more than five hundred dollars (\$500.00);

____ I, as a owner of the property, or my employees with wages as their sole compensation, will do the work, and the structure is not intended or offered for sale (Sec. 7044, Business and Professional Code: The Contractors License Law does not apply to an owner of property who builds or improves thereon, and who does such work himself or herself or through his/her own employees, provided that such improvements are not intended or offered for sale. If, however, the building or improvement is sold within one year of completion, the owner-builder will have the burden of proving that he/she did not build or improve for the purpose of sale.)

____ I, as owner of the property, am exclusively contracting with licensed contractors to construct the project (Sec. 7044, Business and Professions Code: The Contractors License Law does not apply to an owner of property who builds or improves thereon, and who contracts for such projects with a contractor(s) licensed pursuant to the Contractors License Law).

____ I am exempt under Sec. _____ B & PC for this reason: _____

Date _____ Owner Signature _____

IN ISSUING THIS BUILDING PERMIT, the applicant represents, and the city relies on the representation of the applicant, that the applicant verified all measurements and locations shown on the application or accompanying drawings and that the improvement to be constructed does not violate any law or private agreement relating to permissible or prohibited locations for such improvements. This building permit does not authorize any illegal location of any improvement or the violation of any private agreement relating to location of improvements.

I certify that I have read this application and state that all information is correct. I agree to comply with all city and county ordinances and state laws relating to building construction and hereby authorize representative(s) of this city to enter upon the abovementioned property for inspection purposes.

X Date 10/6/00 Applicant/Agent Signature Crystal

WORKER'S COMPENSATION DECLARATION: I hereby affirm under penalty of perjury one of the following declarations:

____ I have and will maintain a certificate of consent to self-insure for workers' compensation as provided for by Section 3700 of the Labor Code, for the performance of work for which the permit is issued.

cu I have and will maintain workers' compensation insurance, as required by Section 3700 of the Labor Code, for the performance of the work for which this permit is issued. My workers' compensation insurance carrier and policy number are:

Carrier STATE FUND Policy Number 0773941-99 Exp Date 10/31/2000

____ (This section need not be completed if the permit is for \$100 or less) I certify that in the performance of the work for which this permit is issued, I shall not employ any person in any manner so as to become subject to the workers' compensation laws of California and agree that if I should become subject to the workers' compensation provisions of Section 3700 of the Labor Code, I shall forthwith comply with those provisions.

X Date 10/6/00 Applicant Signature Crystal

WARNING. FAILURE TO SECURE WORKER'S COMPENSATION COVERAGE IS UNLAWFUL AND SHALL SUBJECT AN EMPLOYER TO CRIMINAL PENALTIES AND CIVIL FINES UP TO ONE HUNDRED THOUSAND DOLLARS (\$100,000) IN ADDITION TO THE COST OF COMPENSATION, DAMAGES AS PROVIDED FOR IN SECTION 3706 OF THE LABOR CODE, INTEREST AND ATTORNEY'S FEE.

THIS PERMIT SHALL EXPIRE BY LIMITATION IF WORK IS NOT COMMENCED WITHIN 180 DAYS.

2 INSPECTION PERMIT

ADDRESS: 1132 B Ascot Avenue

OWNER: _____

Approval by the following City Departments must be obtained prior to the issuance of a wrecking permit by the Building Inspection Division. Design Review approval required on all wrecking permits in Central City/Alhambra Blvd. corridor prior to sewer disconnect permit being issued.

DESIGN REVIEW 1231 I Street, Room 200 (916)264-5604	EX. NORTH AREA DC PHOTO VERIFICATION OK K.K. BAKER 10-1-2000
PLUMBING DIVISION (All) 1231 I Street, Room 200 (916)264-7619 (or) Housing (916)264-5404	
WATER DEPARTMENT (All) 1391 35 TH Avenue (916)264-5371	
FIRE DEPARTMENT (All) 1231 I Street, Room 401 (916)264-5416	Diana Yarb
TRAFFIC ENGINEER (Commercial) 1000 I Street (916)264-5307	
ARBORIST/TREE SERVICE (Downtown and Commercial Buildings) 5730 24 th Street (916)433-6345	

- 1.) Route to Planning and Fire
- 2.) Sewer Disconnect after we call 264-5371 Kill Tap
Bring Permit (signed off by plumbing inspector) back to the building department to add Wrecking.
* Unless City Awarded Contract.
- 3.) Commercial Buildings Required to have Asbestos Form and not to be issued Before Air Quality Date on Asbestos Form (bottom right corner)



DEPARTMENT OF
PLANNING AND DEVELOPMENT

CITY OF SACRAMENTO
CALIFORNIA

1231 I STREET
ROOM 200
SACRAMENTO, CA
95814-2998

WRECKING PERMIT # 0011878

BUILDING INSPECTIONS
916-264-5716
Permit Services
916-264-7619
FAX 916-264-7046

DEMOLITION PERMIT NOTIFICATION

A Demolition Permit for a 1 story building at:

1132 B, Ascot Ave

(Address)

Parcel number: _____

has been issued on _____

(date)

The structure is scheduled for demolition within 30 days.

Please update your service and billing records accordingly.

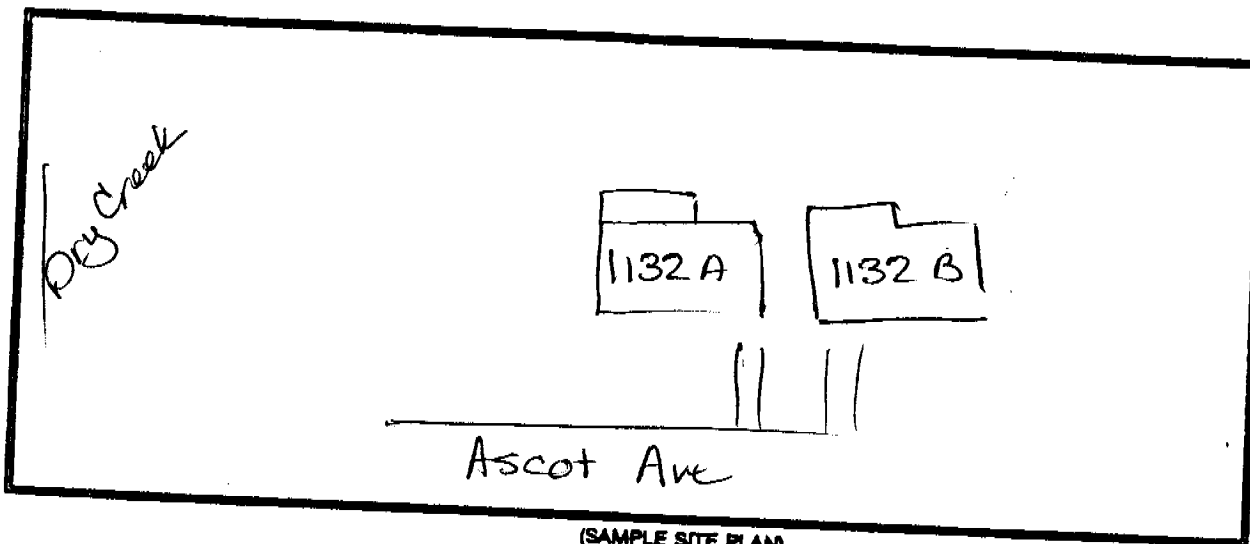

(SAMPLE SITE PLAN)

cc: P.G. & E (Terry Clark)
SMUD
SOLIDWASTE (3141)
UTILITIES (3350)
UTILBILLING (1125)
FIREDEPT. (2510)

INITIAL: CW

DATE: 10/4/00

DEVELOPMENT SERVICES
DIVISION

APPLICATION FOR WRECKING PERMIT

916-264-7619
FAX 916-264-7046

LOCATION

ADDRESS: 1132 B Ascot Avenue
LOT: _____ TRACT: _____
LOT DEPTH: _____ LOT WIDTH: _____ CORNER LOT: _____ INTERIOR LOT _____
OWNER: _____
ADDRESS: _____

BUILDING DATA

LENGTH: _____ WIDTH _____ FIRST FLOOR AREA _____ (SQ.FT.) NO. STORIES 1
USE OF BUILDING: _____ CONSTRUCTION TYPE _____ HEIGHT _____
OF UNITS _____ REAR YARD _____ SIDE YARD _____ SET BACK _____
CITY SEWER _____ WATER _____ SEPTIC _____ WELL _____

CONTRACTOR

NAME: G W Demolition & Excavating STATE LICENSE NO. 576368
ADDRESS: 2236 Q Street, Rio Linda, CA 95673
PHONE: (916) 991-0741 FAX: (916) 991-9246
LIABILITY INSURANCE P.L. Zurich P.D. SPC30408950 POLICY ON FILE Yes
WORKERS COMPENSATION INSURANCE State Fund 0773941-99 Yes

CODE REQUIREMENTS

NOTIFICATION OF ADJACENT PROPERTY OWNERS _____ DATE: _____
COPY OF NOTIFICATION ON FILE: _____ USE OF PROPERTY REQUIRED: _____
PEDESTRIAN PROTECTION REQUIRED: _____ REQUIREMENTS ATTACHED _____
BASEMENTS OR OTHER EXCAVATIONS ON LOT: _____ TO BE FILLED _____ FENCED _____

PREPARE PLOT PLAN SHOWING LOCATION OF BUILDING ON LOT AND TYPE AND LOCATION OF BUILDING BARRICADE.

SPECIAL CONDITIONS:

I have read the above application and know the contents thereof; the same is true and correct. I further state that I am familiar with the laws governing the demolition of buildings within the City of Sacramento and the State of California and that the above structure will be razed in conformity therewith. I further state that I understand that this permit may be revoked for any violation of the provisions of the Code of the City of Sacramento pertaining to or affected by the demolition procedure to be used on the above building.

No. W _____
DATE: _____
FEE: _____

APPLICANT: *Crystal*
TITLE: *Office Manager*
(APPLICANT/OWNER)

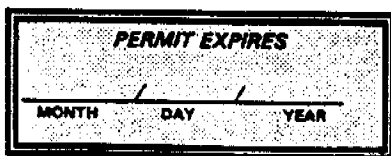

THIS IS A REVOCABLE PERMIT

PERMIT SUMMARY DOCUMENT

Bldg Demo/Sewer Cap

ISSUED

Address: **1132 ASCOT AV SAC** Date Issued: 10/04/2000 Area: 4

Permit #: **0011878**

Thomas Bros: 258F1 25

Location: BLDG B

APN: 226-0080-007

Owner: SAFCA
1007 7TH ST FIFTH FLOOR
SAC CA

Contractor: G W EXCAVATING
2236 Q ST
RIO LINDA, CA.
95673

Phone:

Phone: 916-991-0741

JOB DESCRIPTION: DEMO BLDG/SEPTIC ABANDONMENT AFTER BLDG DEMO

DBA:

Occupancy: R3

Change of Use:

Zoning:

Const Type:

Sub-Type: RES

DR:

Fire Sprinkler?:

Activity Code: W1

Fed Code: 1A

Flood Zone:

Cert Req'd: ??

Balance: \$0.00

VALUATION: \$3,000.00 Sq. Ft: 0

Reg San:

School Fees Req'd: Y or N

BLDG N

MECH

PLBG Y

ELEC

SITE ??

FIRE ??

CONDITIONS: