

CITY OF SACRAMENTO
1231 I Street, Sacramento, CA 95814

Permit No: 0108630

Insp Area: 4

Site Address: 10 WHITE LILY CT SAC
Parcel No: 274-0570-035 NATOMAS W 2 LOT 55

Sub-Type: N1/2PLEX
Housing (Y/N): N

CONTRACTOR
KAUFMAN & BROAD
151 NORTH SUNRISE AV #1012
ROSEVILLE CA 95661

OWNER

ARCHITECT

Nature of Work: NSFR HALF-PLEX, MP1114, 4 RMS

CONSTRUCTION LENDING AGENCY: I hereby affirm under penalty of perjury that there is a construction lending agency for the performance of the work for which this permit is issued (Sec. 3097, Civ. C.).

Lender's Name _____ Lender's Address _____

LICENSED CONTRACTORS DECLARATION: I hereby affirm under penalty of perjury that I am licensed under provisions of Chapter 9 commencing with section 7000 of Division 3 of the Business and Professions Code and my license is in full force and effect.

License Class B License Number 21542 Date 7-18-01 Contractor Signature [Signature]

OWNER-BUILDER DECLARATION: I hereby affirm under penalty of perjury that I am exempt from the contractors License Law for the following reason (Sec. 7031.5, Business and Professions Code: any city or county which requires a permit to construct, alter, improve, demolish, or repair any structure, prior to its issuance, also requires the applicant for such permit to file a signed statement that he or she is licensed pursuant to the provisions of the Contractors License Law (Chapter 9 commencing with Section 7000) of Division 8 of the Business and Professions Code) or that he or she is exempt therefrom and the basis for the alleged exemption: Any violation of Section 7031.5 by any applicant for a permit subjects the applicant to a civil penalty of not more than five hundred dollars (\$500.00).

I, as a owner of the property, or my employees with wages as their sole compensation, will do the work, and the structure is not intended or offered for sale (Sec. 7044, Business and Professional Code). The Contractors License Law does not apply to an owner of property who builds or improves thereon, and who does such work himself or herself or through his/her own employees, provided that such improvements are not intended or offered for sale. If, however, the building or improvement is sold within one year of completion, the owner-builder will have the burden of proving that he/she did not build or improve for the purpose of sale.

I, as owner of the property, am exclusively contracting with licensed contractors to construct the project (Sec. 7044, Business and Professions Code). The Contractors License Law does not apply to an owner of property who builds or improves thereon, and who contracts for such projects with a contractor(s) licensed pursuant to the Contractors License Law.

I am exempt under Sec. _____ B & PC for this reason: 2001
Date _____ Owner Signature _____

IN ISSUING THIS BUILDING PERMIT, the applicant represents and warrants on the representation of the applicant, that the applicant verified all measurements and locations shown on the application or accompanying drawings and that the improvement to be constructed does not violate any law or private agreement relating to permissible or prohibited locations for such improvements. This building permit does not authorize any illegal location of any improvement or the violation of any private agreement relating to location of improvements.

I certify that I have read this application and state that all information is correct. I agree to comply with all city and county ordinances and state laws relating to building construction and hereby authorize representative(s) of this city to enter upon the abovementioned property for inspection purposes.

Date _____ Applicant/Agent Signature _____

WORKER'S COMPENSATION DECLARATION: I hereby affirm under penalty of perjury one of the following declarations:

I have and will maintain a certificate of consent to self-insure for workers' compensation as provided for by Section 3700 of the Labor Code, for the performance of work for which the permit is issued.

I have and will maintain workers' compensation insurance, as required by Section 3700 of the Labor Code, for the performance of the work for which this permit is issued. My workers' compensation insurance carrier and policy number are:

Carrier American International Policy Number 247837616 Exp Date 5-1-02

(This section need not be completed if the permit is for \$100 or less) I certify that in the performance of the work for which this permit is issued, I shall not employ any person in any manner so as to become subject to the workers' compensation laws of California and agree that if I should become subject to the workers' compensation provisions of Section 3700 of the Labor Code, I shall forthwith comply with those provisions.

Date 7-18-01 Applicant Signature [Signature]

WARNING: FAILURE TO SECURE WORKER'S COMPENSATION COVERAGE IS UNLAWFUL AND SHALL SUBJECT AN EMPLOYER TO CRIMINAL PENALTIES AND CIVIL FINES UP TO ONE HUNDRED THOUSAND DOLLARS (\$100,000) IN ADDITION TO THE COST OF COMPENSATION DAMAGES AS PROVIDED FOR IN SECTION 3706 OF THE LABOR CODE, INTEREST AND ATTORNEY'S FEE.

THIS PERMIT SHALL EXPIRE BY LIMITATION IF WORK IS NOT COMMENCED WITHIN 180 DAYS.

RESIDENTIAL SUBDIVISION BUILDING PERMIT APPLICATION

Project Address: 10 White Lily Ct
Lot Number: 55

Assessor Parcel # 274-0570-035
Subdivision Natomas West Village

OWNER INFORMATION:

Legal Property Owner: KB Home Phone# 707-469-2464
Owner Address: 611 Orange dr City Vacaville State CA Zip 95687

CONTRACTOR INFORMATION:

Contractor: KB Home Lic. # 761970 Phone # 707-469-2464 469-2405

PROJECT INFORMATION:

Land Use Zone RIA Occupancy Group R3 Construction Type VN Fed Code IA
No. of Stories: 1 No. of Rooms: _____ Street Width: _____
1st Floor Area 1114 2nd Floor Area _____ Basement _____ Roof Material _____
AREA IN SQUARE FOOT OF:
Dwelling/Living 1114
Garage/Storage 226
Decks/Balconies 56
Carports _____
SCOPE OF WORK: New Single Family Dwelling

FOR OFFICE USE ONLY

Information Above Complete AR Flood Waiver Required Planning Approval
 Violation Files Checked Flood Elevation Certificate Required Design Review Approval
 Standard Setbacks Water Development Infill Area Special Fee Districts Apply:
 County Sewer
-----THE FOLLOWING MUST BE PROVIDED IN ORDER TO SUBMIT FOR PERMIT-----
 2 COMPLETE PLOT PLANS, LEGIBLE & DRAWN TO SCALE
 11 X 17 COPY OF FLOOR PLAN WITH FOLLOWING INFORMATION
a) Assessor's Parcel Number c) Owners Name
b) New Floor Area d) Project Address

CERTIFICATION OF INSULATION

PART I GENERAL

ADDRESS OR TRACT KB HOMES LOT # 54 CALIFORNIA GARDENS	SACRAMENTO INSULATION CONTRACTORS <input checked="" type="checkbox"/> P.O. BOX 854, WEST SACRAMENTO, CA 95691 LIC. #202026 <input type="checkbox"/> 1309 MELODY ROAD, MARYSVILLE, CA 95901 LIC. #202026 <input type="checkbox"/> P.O. BOX 9651, FRESNO, CA 93793-9651 LIC. #202026 <input type="checkbox"/> P.O. BOX 1631, RENO, NV 89505 LIC. #10675 <input type="checkbox"/> 3326 A PONDEROSA WAY, LAS VEGAS, NV 89118 LIC. #10675 DATE INSULATION COMPLETED
---	--

PART II AREAS INSULATED

WALLS		CEILING			FLOORS	
(SQUARE FEET)		(SQUARE FEET)			(SQUARE FEET)	
TYPE OF INSULATION		TYPE OF INSULATION			TYPE OF INSULATION	
MATERIAL FIBERGLASS		MATERIAL FIBERGLASS			MATERIAL FIBERGLASS	
FORM BATTS		FORM BATTS & BLOW			FORM BATTS	
MANUFACTURER'S PRODUCT I.D.		MANUFACTURER'S PRODUCT I.D.			MANUFACTURER'S PRODUCT I.D.	
MANUFACTURER		MANUFACTURER			MANUFACTURER	
OCF		OCF			OCF	
BAGS						
R-VALUE INSTALLED	APPLIED THICKNESS	R-VALUE INSTALLED	APPLIED THICKNESS	MIN. INSTALLED WEIGHT PER SQUARE FOOT	R-VALUE INSTALLED	APPLIED THICKNESS
13	3 5/8"	38 38	12 1/4" 14 3/4"			
KNEE WALLS IF R-VALUE IS OTHER THAN WALLS ABOVE						
MATERIAL	FORM	R VALUE		MANUFACTURER		
FIBERGLASS	BATTS			OCF		
AIR INFILTRATION SEALANT						
MATERIAL				MANUFACTURER		
FOAM				W R GRACE		
THIS IS TO CERTIFY THAT INSULATION AND/OR SEALANT HAS BEEN INSTALLED IN CONFORMANCE WITH APPLICABLE CODES, MATERIAL STANDARDS AND REGULATIONS.						
SIGNATURE - INSULATION CONTRACTOR				TITLE		DATE
<i>Jeff Cobb</i>				MANAGER		2/14/02
SIGNATURE - GENERAL CONTRACTOR				TITLE		DATE
REMARKS:						

SIC-303

BUILDER COPY

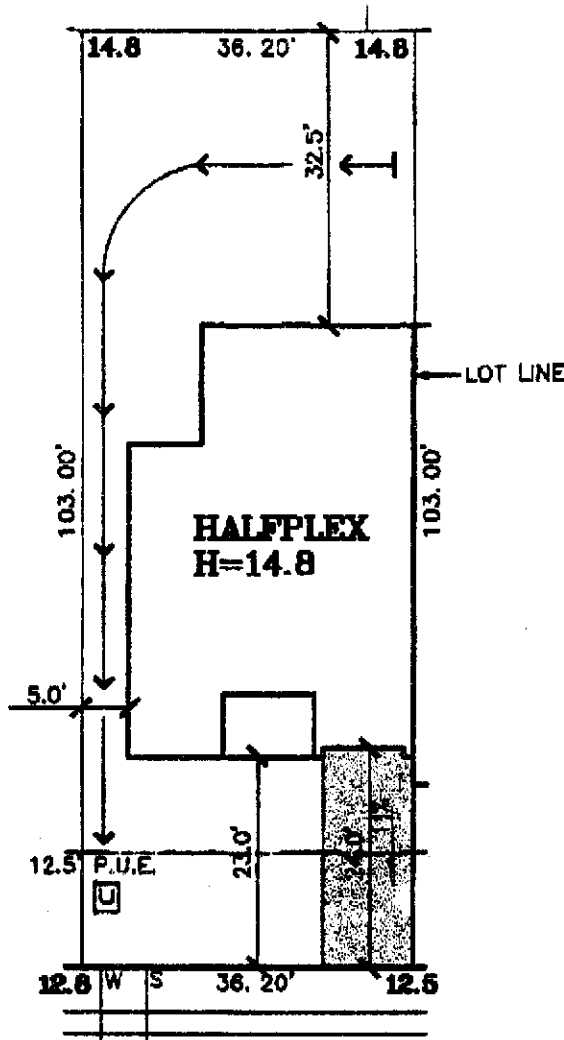

The use of above and specifications must be in accordance with all laws and it is intended to be used as a guide or reference from the official records and can permission from the official records division.

The use of this plan and specification shall not be held to permit or approve the violation of any City Ordinance or State Law.

WHITE LILY COURT

DATE: 5-10-01
 A.P.N.: 274-0570-035
 ADDRESS: 10 WHITE LILY COURT

LOT AREA: 3,729 SF
 LOT COVERAGE: 37%

The Spink Corporation
 2590 VENTURE OAKS WAY
 SACRAMENTO, CA. 95833
 PH (916)925-5550 FAX (916)921-9274

**NATOMAS WEST
 VILLAGE 2
 LOT 55
 PLAN HP**

CALIFORNIA GARDENS
 CITY OF SACRAMENTO, CA
 CLIENT: KAUFMAN & BROAD