

CITY OF SACRAMENTO
1231 I Street, Sacramento, CA 95814

Permit No: 0104457
Insp Area: 4

Site Address: 5211 ALDERBERRY WY SAC
Parcel No: 201-0410-056 NORTHBR 1-2 LOT 57

Sub-Type: NSFR
Housing (Y/N): N

CONTRACTOR
MORRISON HOMES
1130 IRON POINT RD STE 120
FOLSOM CA, 95630

OWNER

ARCHITECT

Nature of Work: NSFR MP1428 6 RMS

CONSTRUCTION LENDING AGENCY: I hereby affirm under penalty of perjury that there is a construction lending agency for the performance of the work for which this permit is issued (Sec. 3097, C.A.C.)

Lender's Name _____ Lender's Address _____

LICENSED CONTRACTORS DECLARATION: I hereby affirm under penalty of perjury that I am licensed under provisions of Chapter 9 (commencing with section 7000) of Division 3 of the Business and Professions Code and my license is in full force and effect.

License Class B License Number 5716 Date 4-20-01 Contractor Signature [Signature]

OWNER-BUILDER DECLARATION: I hereby affirm under penalty of perjury that I am exempt from the contractors License Law for the following reason (Sec. 7031.5, Business and Professions Code): any city or county which requires a permit to construct, alter, improve, demolish, or repair any structure, prior to its issuance, also requires the applicant for such permit to file a signed statement that he or she is licensed pursuant to the provisions of the Contractors License Law (Chapter 9 (commencing with Section 7000) of Division 8 of the Business and Professions Code) or that he or she is exempt therefrom and the basis for the alleged exemption: Any violation of Section 7031.5 by any applicant for a permit subjects the applicant to a civil penalty of not more than five hundred dollars (\$500.00)

I, as a owner of the property, or my employees with wages as their sole compensation, will do the work, and the structure is not intended or offered for sale (Sec. 7044, Business and Professional Code). The Contractors License Law does not apply to an owner of property who builds or improves thereon, and who does such work himself or herself or through his/her own employees, provided that such improvements are not intended or offered for sale. If, however, the building or improvement is sold within one year of completion, the owner-builder will have the burden of proving that he/she did not build or improve for the purpose of sale.

I, as owner of the property, am exclusively contracting with licensed contractors to construct the project (Sec. 7044, Business and Professions Code). The Contractors License Law does not apply to an owner of property who builds or improves thereon, and who contracts for such projects with a contractor(s) licensed pursuant to the Contractors License Law.

I am exempt under Sec. _____ B & PC for this reason: _____

Date _____ Owner Signature _____

IN ISSUING THIS BUILDING PERMIT, the applicant represents, and the city relies on the representation of the applicant, that the applicant verified all measurements and locations shown on the application or accompanying drawings and that the improvement to be constructed does not violate any law or private agreement relating to permissible or prohibited locations for such improvements. This building permit does not authorize any illegal location of any improvement or the violation of any private agreement relating to location of improvements.

I certify that I have read this application and state that all information is correct. I agree to comply with all city and county ordinances and state laws relating to building construction and hereby authorize representative(s) of this city to enter upon the above mentioned property for inspection purposes.

Date 4-20-01 Applicant/Agent Signature [Signature]

WORKER'S COMPENSATION DECLARATION: I hereby affirm under penalty of perjury one of the following declarations:
I have and will maintain a certificate of consent to self-insure for workers' compensation as provided for by Section 3700 of the Labor Code, for the performance of work for which the permit is issued.

1 I have and will maintain workers' compensation insurance, as required by Section 3700 of the Labor Code, for the performance of the work for which this permit is issued. My workers' compensation insurance carrier and policy number are: ZURICH-AMERICAN INS. CO. WC 2090701-03

Carrier ZURICH-AMERICAN INS. CO. Policy Number WC 2090701-03 Exp Date 11/01/2001

(This section need not be completed if the permit is for \$100 or less) I certify that in the performance of the work for which this permit is issued, I shall not employ any person in any manner so as to become subject to the workers' compensation laws of California and agree that if I should become subject to the workers' compensation provisions of Section 3700 of the Labor Code, I shall forthwith comply with those provisions.

Date 4-20-01 Applicant Signature [Signature]

WARNING: FAILURE TO SECURE WORKER'S COMPENSATION COVERAGE IS UNLAWFUL AND SHALL SUBJECT AN EMPLOYER TO CRIMINAL PENALTIES AND CIVIL FINES UP TO ONE HUNDRED THOUSAND DOLLARS (\$100,000) IN ADDITION TO THE COST OF COMPENSATION, DAMAGES AS PROVIDED FOR IN SECTION 3706 OF THE LABOR CODE, INTEREST AND ATTORNEY'S FEE.

THIS PERMIT SHALL EXPIRE BY LIMITATION IF WORK IS NOT COMMENCED WITHIN 180 DAYS.

RESIDENTIAL SUBDIVISION BUILDING PERMIT APPLICATION

Project Address: 5211 Alderberry way Assessor Parcel # 201-041-056
Lot Number: 57 Subdivision Northborough Village 2

OWNER INFORMATION:

Legal Property Owner: Morrison Homes Phone# (916) 355-8900
Owner Address: 1130 Iron Point Rd #120 City Folsom State CA Zip 95630

CONTRACTOR INFORMATION:

Contractor: Morrison Homes Lic. # 519465 Phone # 355-8900 Fax 355-0100

PROJECT INFORMATION:

Land Use Zone R1A Occupancy Group R3 Construction Type VN Fed Code 1A
No. of Stories: 1 No. of Rooms: 6 Street Width: _____
1st Floor Area 1428 2nd Floor Area _____ Basement _____ Roof Material _____
AREA IN SQUARE FOOT OF:
Dwelling/Living 1428
Garage/Storage 425
~~Decks/Balconies~~ Porch 30
Carports _____
SCOPE OF WORK: New Single Family Dwelling

FOR OFFICE USE ONLY

- Information Above Complete
- Violation Files Checked
- Standard Setbacks
- County Sewer
- AR Flood Waiver Required
- Flood Elevation Certificate Required
- Water Development Infill Area
- Planning Approval
- Design Review Approval
- Special Fee Districts Apply: _____

THE FOLLOWING MUST BE PROVIDED IN ORDER TO SUBMIT FOR PERMIT

- 2 COMPLETE PLOT PLANS, LEGIBLE & DRAWN TO SCALE
- 11 X 17 COPY OF FLOOR PLAN WITH FOLLOWING INFORMATION
 - a) Assessor's Parcel Number
 - b) New Floor Area
 - c) Owners Name
 - d) Project Address

COUNTY SANITATION DISTRICT NO. 1
 SACRAMENTO REGIONAL COUNTY SANITATION DISTRICT

SEWER IMPACT FEE
 PERMIT AND CALCULATION SHEET *CH*

APPLICATION NO:
 GENERAL INFORMATION

BLDG PERMIT NO: *270050*
 THIS PERMIT GOOD ONLY WHEN
 VALIDATED BY THE CASHIER *2/19/05*

SUD2001-00105
268820

270050

THIS PERMIT TO CONNECT EXPIRES
 ONE YEAR FROM DATE OF ISSUANCE

FEE CALCULATION

BUILDING USE

INSPECTION	RESIDENTIAL	SF	MF	UNITS
GSD-1		<i>1473</i>	<input checked="" type="checkbox"/>	
SROSD		<i>2401</i>	<input checked="" type="checkbox"/>	
CONSTRUCTION				
IN-LIEU				
TOTAL FEE		<i>0</i>		

APN: *201-041-056*

DESCRIPTION/
 SUBDIVISION *Northborough Village 2 LOT: 57*

PROPERTY ADDRESS *5211 Alderberry Way*
 OWNER *Morrison Homes*

MAILING ADDRESS *1130 Iron Point Rd #120*

CITY-STATE-ZIP *Folsom Ca 95630* PHONE *355-8900*

ADDITIONAL FEES MAY BE DUE IF CHANGES IN USE INCREASE SEWER IMPACT.

APPLICANT SIGNATURE

[Signature]

CONSOLIDATED UTILITY BILLING USE ONLY

ACCT _____ INPUT _____ START _____

INSPECTOR'S COPY

Natomas Unified School District
 1515 Sports Drive, #1 • Sacramento, CA 95834-1905
 Phone 916/641-3300 • Fax 916/928-1629

CERTIFICATION OF COMPLIANCE

SCHOOL DISTRICT DEVELOPMENT FEES

PART I: TO BE COMPLETED BY APPLICANT			
Property Owner's Name _____			
Owner's Address _____			
Project Address <u>5211 Alderberry</u>			
Parcel Number _____			
Subdivision Name _____			
Number of Units _____			
Print Applicant's Name _____		Applicant's Signature _____	
Title of Applicant _____		Date _____	
Date _____		Telephone Number <u>723-9774</u>	
PART II: TO BE COMPLETED BY BUILDING DEPARTMENT			
Plan Identification Number _____			
Building Type (Check One)			
<input checked="" type="checkbox"/> Residential <input type="checkbox"/> Apartment/Condominium <input type="checkbox"/> Commercial/Industrial			
Square Feet of Chargeable Building Area _____			
Signature _____			
Title _____		Date _____	
PART III: TO BE COMPLETED BY NATOMAS UNIFIED SCHOOL DISTRICT			
District Certification Number _____			
Fees Collected:			
Residential:	Sq. Ft. X \$	= \$	<u>4691.00</u>
Apartment/Condominium:	Sq. Ft. X \$	= \$	
Commercial/Industrial:	Sq. Ft. X \$	= \$	
NOTICE TO APPLICANT: Pursuant to government code section 66020 (d), this will serve to notify you that the 90-day approval period in which you may protest the fees, or other payment identified above, will begin to run on the date in which the building or installation permit for this project is issued, or on which they are paid to the District, or to another public entity authorized to collect them on behalf of the District, whichever is earlier.			
Applicant Signature: _____		Date: _____	

This certification covers only the amount of square footage indicated above. Any additions or corrections to the square footage for this project will require an amendment to the Certificate of Compliance.

As the authorize Natomas Unified School District official, I hereby certify that the requirements of Government Code Section 95995 have been complied with by the above signed applicant.

SIGNATURE: Michael Morman DATE: 4/5/01
 TITLE: Michael Morman
Facilities Planning Director



WesPac

insulation

a MASCO Company

809 North Market Blvd., Ste. 11 • Sacramento, CA 95834
(916) 927-7149 • Fax (916) 927-4257
Lic. #487478



Installed Insulation Certificate

We certify that the building insulation listed herein is installed in conformance with current energy conservation regulations, California Administrative Code, Title 24, State of California

R FACTOR	AREA	TYPE	INCHES/BAGS (BLOWN)
R30	ATTIC	FIBERGLASS BLOW	12.75" /
R30	CEILING	FIBERGLASS BATTS	10.25"
R13	EXTERIOR WALLS	FIBERGLASS BATTS	3.5"

MORRISON HOMES

Certified by *Johnny Hines*

VILLAS @ MATOMAS PARK
MORR VILLAS/357
Address or Lot Number

Title Secretary

Date Installed 08/01/01 Phase #

KwikKote

No. 200-002956

Stucco System Installation Card

Job Name: VILLA COLLECTION
Address: 57 ALDERBERRY WAY
 , CA
Lot #: 00057-2

Stucco System Trade Name: KWIK KOTE
Stucco System Manufacturer: KWIK KOTE CORP.

ICBO Evaluation Service, Inc.
Report No. 3607
Date of Job Completion: August 14, 2001

Home Builder: MORRISON HOMES
Address: 1130 IRON POINTE RD #120
 FOLSOM, CA

Stucco Contractor: KENYON PLASTERING, INC.
Address: PO BOX 2077
 North Highlands, CA

Telephone Number: 916/349-8191

Approved Contractor Number as
issued by the Stucco Manufacturer: 1001

Card Print Date: 08/22/2001

This is to certify that the stucco system on the building exterior at the above address had been installed in accordance with the evaluation report specified above and the manufacturer's instructions.

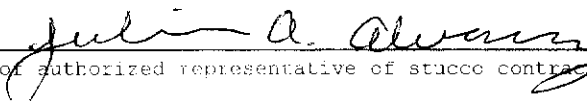

Signature of authorized representative of stucco contractor

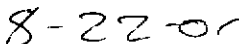

Date

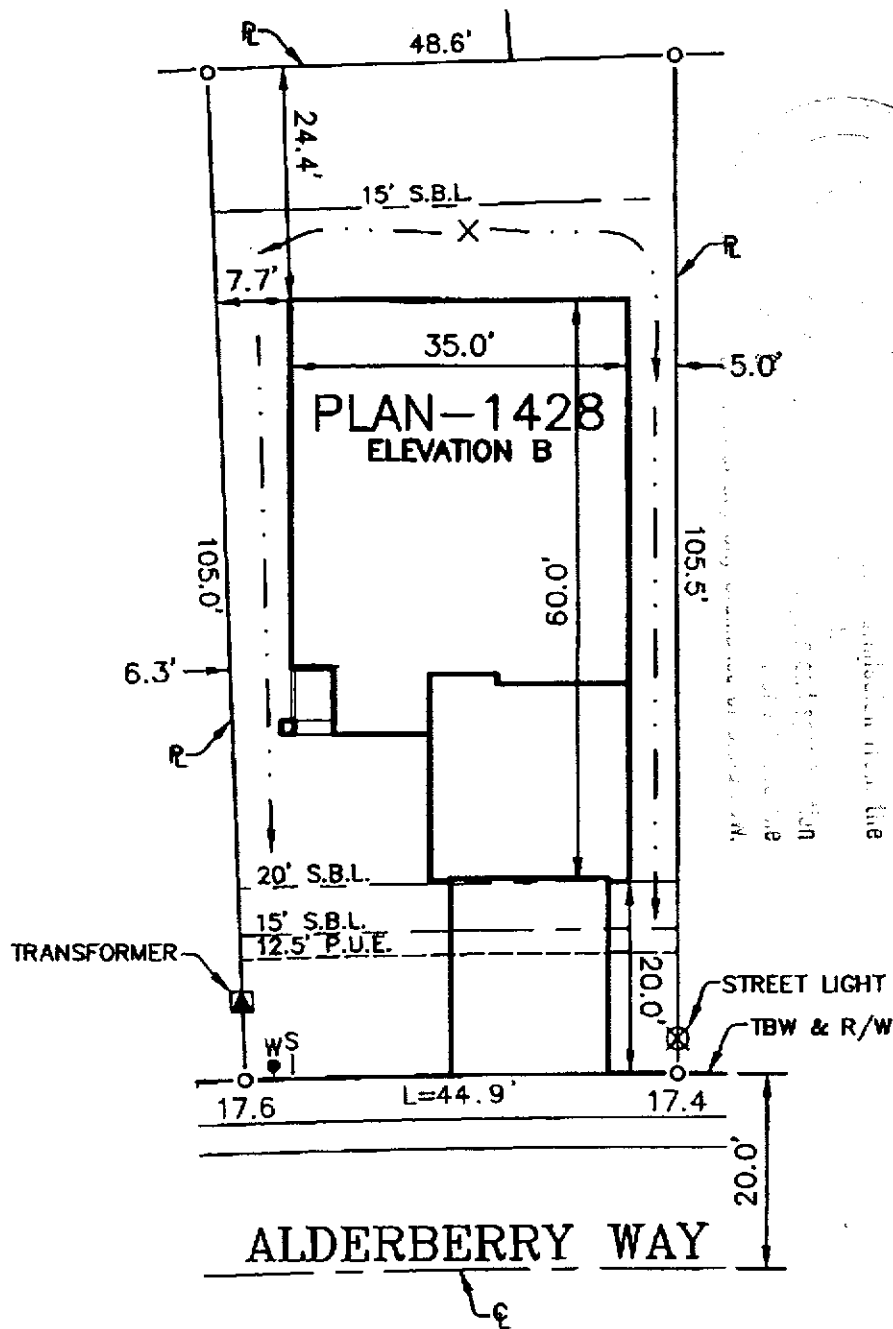

This plan and specifications must be read in conjunction with the subdivision map on file with the County of Sacramento.

NOTE:
 It is understood that the drainage areas, slopes and grades shall not be altered, changed, blocked, modified or in any way be reconstructed by Owner contrary to what is depicted on this Plot Plan. THESE CONDITIONS RUN WITH THE LAND AND ARE BINDING ON ALL SUBSEQUENT OWNERS.

Morrison Homes Rep. 3/20/01 Date
 _____ Date

NOTE:
 All setback dimensions and elevations as shown may be adjusted to fit field conditions.

ELECTRICAL SERVICE ON RIGHT SIDE OF LOT.
 A.P.N. = 201-041-056
 PAD ELEV = 19.2
 LOT AREA = 4,907 SF
 ALLOWED LOT COVERAGE = 45% = 2,208 SF
 ACTUAL LOT COVERAGE = 38% = 1,853 SF

LOT 57
5211 ALDERBERRY WAY

NORTHBOROUGH VILLAGE 2
COUNTY OF SACRAMENTO

APPROVAL:
 MORRISON HOMES Rep. 3-22-01 Date

3222 Ramon Circle Sacramento CA 95827
 (916) 366-3040 Fax (916) 366-3028
R.E.Y. ENGINEERS, Inc.
 Civil Engineers / Land Surveyors



JOB NO.	602208
DRAWN	CS
CHECKED	NJM
DATE	02-27-01
SCALE	1"=20'