

CITY OF SACRAMENTO

1231 I Street, Sacramento, CA 95814

Permit No: 9903292

Insp Area: 4

Site Address: 29 HEATHMERE CT SAC

Parcel No: 274-0470-038

HERITAGE PLACE LOT 61

Sub-Type: NSFR

Housing (Y/N): N

CONTRACTOR

EPICK INC.
1263 THE ESPLANADE
CHICO, CA 95926

OWNER

ARCHITECT

Nature of Work: NEW HOME, MP1314, 5 ROOMS

CONSTRUCTION LENDING AGENCY : I hereby affirm under penalty of perjury that there is a construction lending agency for the performance of the work for which this permit is issued (Sec. 3097, Civ. C).

Lender's Name 1st Bank Lender's Address 1525 Douglas Blvd, Roseville

LICENSED CONTRACTORS DECLARATION: I hereby affirm under penalty of perjury that I am licensed under provisions of Chapter 9 (commencing with section 7000) of Division 3 of the Business and Professions Code and my license is in full force and effect.

License Class B License Number 663708 Date 4/13/99 Contractor Signature [Signature]

OWNER-BUILDER DECLARATION: I hereby affirm under penalty of perjury that I am exempt from the contractors License Law for the following reason (Sec. 7031.5, Business and Professions Code; any city or county which requires a permit to construct, alter, improve, demolish, or repair any structure, prior to its issuance, also requires the applicant for such permit to file a signed statement that he or she is licensed pursuant to the provisions of the Contractors License Law (Chapter 9 (commencing with Section 7000) of Division 8 of the Business and Professions Code) or that he or she is exempt therefrom and the basis for the alleged exemption. Any violation of Section 7031.5 by any applicant for a permit subjects the applicant to a civil penalty of not more than five hundred dollars (\$500.00);

I, as a owner of the property, or my employees with wages as their sole compensation, will do the work, and the structure is not intended or offered for sale (Sec. 7044, Business and Professional Code: The Contractors License Law does not apply to an owner of property who builds or improves thereon, and who does such work himself or herself or through his/her own employees, provided that such improvements are not intended or offered for sale. If, however, the building or improvement is sold within one year of completion, the owner-builder will have the burden of proving that he/she did not build or improve for the purpose of sale.)

I, as owner of the property, am exclusively contracting with licensed contractors to construct the project (Sec. 7044, Business and Professions Code: The Contractors License Law does not apply to an owner of property who builds or improves thereon, and who contracts for such projects with a contractor(s) licensed pursuant to the Contractors License Law).

I am exempt under Sec. _____ B & PC for this reason: _____
Date 4/13/99 Owner Signature [Signature]

IN ISSUING THIS BUILDING PERMIT, the applicant represents, and the city relies on the representation of the applicant, that the applicant verified all measurements and locations shown on the application or accompanying drawings and that the improvement to be constructed does not violate any law or private agreement relating to permissible or prohibited locations for such improvements. This building permit does not authorize any illegal location of any improvement or the violation of any private agreement relating to location of improvements.

I certify that I have read this application and state that all information is correct. I agree to comply with all city and county ordinances and state laws relating to building construction and hereby authorize representative(s) of this city to enter upon the above mentioned property for inspection purposes.
Date 4/13/99 Applicant/Agent Signature [Signature]

WORKER'S COMPENSATION DECLARATION: I hereby affirm under penalty of perjury one of the following declarations:
I have and will maintain a certificate of consent to self-insure for workers' compensation as provided for by Section 3700 of the Labor Code, for the performance of work for which the permit is issued.

I have and will maintain workers' compensation insurance, as required by Section 3700 of the Labor Code, for the performance of the work for which this permit is issued. My workers' compensation insurance carrier and policy number are:

Carrier STATE FUND Policy Number, 1442812-98 Exp Date 10/01/1999

(This section need not be completed if the permit is for \$100 or less) I certify that in the performance of the work for which this permit is issued, I shall not employ any person in any manner so as to become subject to the workers' compensation laws of California and agree that if I should become subject to the workers' compensation provisions of Section 3700 of the Labor Code, I shall forthwith comply with those provisions.

Date 4/13/99 Applicant Signature [Signature]

WARNING: FAILURE TO SECURE WORKER'S COMPENSATION COVERAGE IS UNLAWFUL AND SHALL SUBJECT AN EMPLOYER TO CRIMINAL PENALTIES AND CIVIL FINES UP TO ONE HUNDRED THOUSAND DOLLARS (\$100,000) IN ADDITION TO THE COST OF COMPENSATION, DAMAGES AS PROVIDED FOR IN SECTION 3706 OF THE LABOR CODE, INTEREST AND ATTORNEY'S FEE.

THIS PERMIT SHALL EXPIRE BY LIMITATION IF WORK IS NOT COMMENCED WITHIN 180 DAYS.

NATOMAS UNIFIED SCHOOL DISTRICT

1515 Sports Drive, #1 • Sacramento, CA 95834
Phone 916/641-3300 • Fax 916/928-1629

CERTIFICATION OF COMPLIANCE

SCHOOL DISTRICT DEVELOPMENT FEES

PART I: TO BE COMPLETED BY APPLICANT

PROPERTY OWNER'S NAME	Epick Homes # 1 LLC		
OWNER'S ADDRESS	1263 The Esplanade Apt. C Chico Ca 95926		
PROJECT ADDRESS	29 Heathmore Ct. / Lot 63		
PARCEL NUMBER	2741-0470-038		
SUBDIVISION NAME	Heritage Place / RiversGate		
NUMBER OF UNITS	173		
PRINT APPLICANT'S NAME	Burt W. Gelberger	APPLICANT'S SIGNATURE:	
TITLE OF APPLICANT	Job Supt.		
DATE	4/6/99	TELEPHONE NUMBER	(530) 891-6757

PART II: TO BE COMPLETED BY BUILDING DEPARTMENT

PLAN IDENTIFICATION NUMBER	M.D. 1314		
BUILDING TYPE (CHECK ONE)	<input checked="" type="checkbox"/> RESIDENTIAL <input type="checkbox"/> APARTMENT/CONDOMINIUM <input type="checkbox"/> COMMERCIAL/INDUSTRIAL		
SQUARE FEET OF CHARGEABLE BUILDING AREA	1314		
SIGNATURE			
TITLE	BI III	DATE	4-3-99

PART III: TO BE COMPLETED BY NATOMAS UNIFIED SCHOOL DISTRICT

DISTRICT CERTIFICATION NUMBER	226		
FEES COLLECTED			
RESIDENTIAL	1314	Sq. Ft. X \$ 1.93	= \$ 2536.02
APARTMENT/CONDOMINIUM		Sq. Ft. X \$	= \$
COMMERCIAL/INDUSTRIAL		Sq. Ft. X \$	= \$

This certification covers only the amount of square footage indicated above. Any additions or corrections to the square footage for this project will require an amendment to the Certificate of Compliance.

As the authorized school district official, I hereby certify that the requirements of Government Code Section 65995 have been complied with by the above signed applicant.

AUTHORIZED SCHOOL DISTRICT OFFICIAL:

SIGNATURE:

TITLE: Facilities Planner DATE: 4-7-99

COUNTY SANITATION DISTRICT NO. 1
 SACRAMENTO REGIONAL COUNTY SANITATION DISTRICT
SEWER IMPACT FEE
 PERMIT AND CALCULATION SHEET

APPLICATION NO: <u>CITY</u>	BLDG PERMIT NO:
GENERAL INFORMATION <u>W 4-7-99</u>	THIS PERMIT GOOD ONLY WHEN VALIDATED BY THE CASHIER <u>250852 4/7/99</u> - DEPT 26 \$2,855.00 - TRAN 386916 04/07/99 - RECEIPT 592809 C#1 \$2,855.00
	THIS PERMIT TO CONNECT EXPIRES ONE YEAR FROM DATE OF ISSUANCE

FEE CALCULATION		BUILDING USE	
INSPECTION		RESIDENTIAL SF <input type="checkbox"/>	MF <input type="checkbox"/>
CSD-1	<u>470-</u>	COMMERCIAL USE	UNITS
SRCS	<u>2385-</u>		
CONSTRUCTION			
IN-LIEU			
TOTAL FEE	<u>2855</u>		

APN: 274-0470-038

DESCRIPTION/SUBDIVISION Heritage Place/Riverside LOT: 63

PROPERTY ADDRESS 29 Heathmere Ct.

OWNER Spick Homes #1 LLC

MAILING ADDRESS 1263 The Esplanade Ste. C

CITY-STATE-ZIP Chico Ca 95926 PHONE (530) 891-4757

ADDITIONAL FEES MAY BE DUE IF CHANGES IN USE INCREASE SEWER IMPACT.

APPLICANT SIGNATURE [Signature]

CONSOLIDATED UTILITY BILLING USE ONLY

ACCT _____ INPUT _____ START _____

BILLING COPY



INSULATION CONTRACTORS ASSOCIATION OF AMERICA

INSULATION CERTIFICATE
53423

1321 DUKE STREET, SUITE 303 • ALEXANDRIA, VA 22314 • (703) 739-0356

TO CERTIFY THAT INSULATION HAS BEEN INSTALLED IN CONFORMANCE WITH CALIFORNIA REGULATIONS, CALIFORNIA ADMINISTRATIVE CODE, TITLE 24, STATE OF CALIFORNIA, THE BUILDING LOCATED AT:

PRICK HEMBS LOT # 63 TRACT #
STREET 29 Heathmore Ct CITY SACTO

EXTERIOR WALLS:

MANUFACTURER ct THICKNESS/TYPE 3 1/2" R-VALUE 13

CEILINGS:

BATTS: MANUFACTURER ct THICKNESS/TYPE 10" R-VALUE 30

BLOWN IN: MANUFACTURER ct THICKNESS 12" R-VALUE 30

SQUARE FOOTAGE COVERED 928 NUMBER OF BAGS USED 17

FLOORS:

MANUFACTURER THICKNESS/TYPE R-VALUE

SLAB ON GRADE:

MANUFACTURER THICKNESS/TYPE R-VALUE

WIDTH OF INSULATION INCHES

FOUNDATION WALLS:

MANUFACTURER THICKNESS/TYPE R-VALUE

GENERAL CONTRACTOR

CALIFORNIA CONTRACTORS LICENSE #

DATE

SIGNATURE TITLE

INSULATION CONTRACTOR ARCADE INSULATION

CALIFORNIA CONTRACTORS LICENSE #263784

10-1-99 DATE

Signature Title

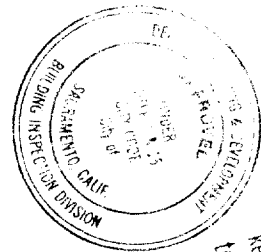
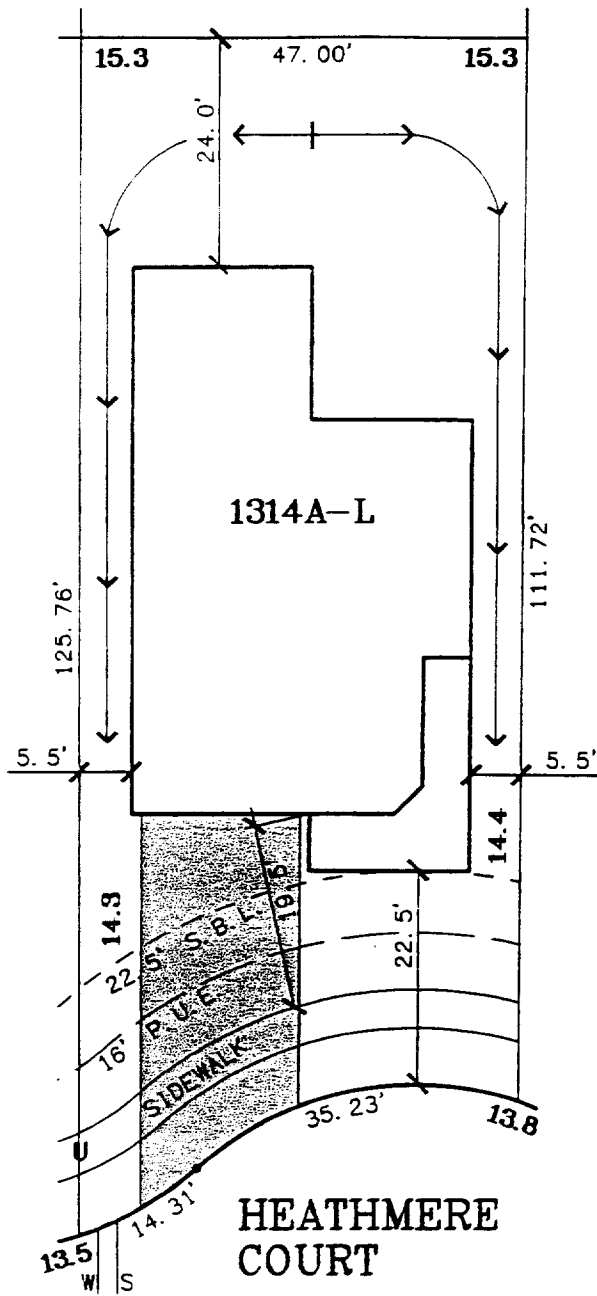

This set of plans and specifications must be kept on the job at all times and it is unlawful to make any changes or alterations from the same without written permission from the Building Inspection Division. The approval of this plan and specifications SHALL NOT be held to permit or state any violation of any City Ordinance or State Law.

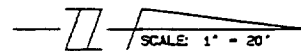

LOT AREA: 5,401 SQ.FT.

DRAWN: 3-4-99 REV

A. P. N. :
 ADDRESS : HEATHMERE COURT

APPROVED BY _____

The Spink Corporation
 2590 VENTURE OAKS WAY
 SACRAMENTO, CA. 95833
 PH:(916)925-5550 FAX:(916)921-9274

HERITAGE PLACE
 UNIT NO. 2
 LOT 63
 PLAN 1314A

RIVERSGATE
 CITY OF SACRAMENTO, CA.
 CLIENT: EPICK HOMES #1, L.L.C.
 JOB NO.: 2808-004