

CITY OF SACRAMENTO
1231 I Street, Sacramento, CA 95814

Permit No: 0010764

Insp Area: 4

Site Address: 2660 MAYBROOK DR SAC
Parcel No: 201-0410-085 NORTHBR 2-1 LOT 31

Sub-Type: NSFR
Housing (Y/N): N

CONTRACTOR
MORRISON HOMES
11344 COLOMA RD
GOLD RIVER CA 95670

OWNER

ARCHITECT

Nature of Work: NSFR MP 1854 8 RMS 2 STORY

CONSTRUCTION LENDING AGENCY : I hereby affirm under penalty of perjury that there is a construction lending agency for the performance of the work for which this permit is issued (Sec. 3097, Civ. C).

Lender's Name _____ Lender's Address _____

LICENSED CONTRACTORS DECLARATION: I hereby affirm under penalty of perjury that I am licensed under provisions of Chapter 9 (commencing with section 7000) of Division 3 of the Business and Professions Code and my license is in full force and effect.

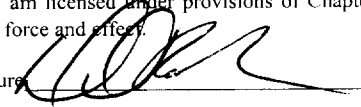
License Class B License Number 519465 Date 10-2-00 Contractor Signature 

OWNER-BUILDER DECLARATION: I hereby affirm under penalty of perjury that I am exempt from the contractors License Law for the following reason (Sec. 7031.5, Business and Professions Code; any city or county which requires a permit to construct, alter, improve, demolish, or repair any structure, prior to its issuance, also requires the applicant for such permit to file a signed statement that he or she is licensed pursuant to the provisions of the Contractors License Law (Chapter 9 (commencing with Section 7000) of Division 8 of the Business and Professions Code) or that he or she is exempt therefrom and the basis for the alleged exemption. Any violation of Section 7031.5 by any applicant for a permit subjects the applicant to a civil penalty of not more than five hundred dollars (\$500.00).

____ I, as a owner of the property, or my employees with wages as their sole compensation, will do the work, and the structure is not intended or offered for sale (Sec. 7044, Business and Professional Code: The Contractors License Law does not apply to an owner of property who builds or improves thereon, and who does such work himself or herself or through his/her own employees, provided that such improvements are not intended or offered for sale. If, however, the building or improvement is sold within one year of completion, the owner-builder will have the burden of proving that he/she did not build or improve for the purpose of sale.)

____ I, as owner of the property, am exclusively contracting with licensed contractors to construct the project (Sec. 7044, Business and Professions Code: The Contractors License Law does not apply to an owner of property who builds or improves thereon, and who contracts for such projects with a contractor(s) licensed pursuant to the Contractors License Law).

____ I am exempt under Sec. _____ B & PC for this reason: _____

Date _____ Owner Signature _____

IN ISSUING THIS BUILDING PERMIT, the applicant represents, and the city relies on the representation of the applicant, that the applicant verified all measurements and locations shown on the application or accompanying drawings and that the improvement to be constructed does not violate any law or private agreement relating to permissible or prohibited locations for such improvements. This building permit does not authorize any illegal location of any improvement or the violation of any private agreement relating to location of improvements.

I certify that I have read this application and state that all information is correct. I agree to comply with all city and county ordinances and state laws relating to building construction and hereby authorize representative(s) of this city to enter upon the above-mentioned property for inspection purposes.

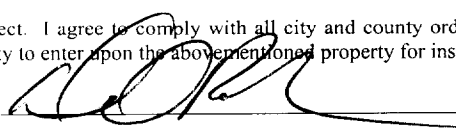
Date 10-2-00 Applicant/Agent Signature 

WORKER'S COMPENSATION DECLARATION: I hereby affirm under penalty of perjury one of the following declarations:

I have and will maintain a certificate of consent to self-insure for workers' compensation as provided for by Section 3700 of the Labor Code, for the performance of work for which the permit is issued.

I have and will maintain workers' compensation insurance, as required by Section 3700 of the Labor Code, for the performance of the work for which this permit is issued. My workers' compensation insurance carrier and policy number are:

Carrier ZURICH-AMERICAN INS. CO. Policy Number WC2815412-01

CITY OF SACRAMENTO
Exp Date 11/1/1999

____ (This section need not be completed if the permit is for \$100 or less) I certify that in the performance of the work for which this permit is issued, I shall not employ any person in any manner so as to become subject to the workers' compensation laws of California and agree that if I should become subject to the workers' compensation provisions of Section 3700 of the Labor Code, I shall forthwith comply with those provisions.

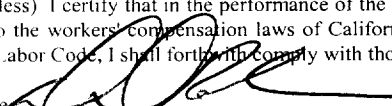
Date 10-2-00 Applicant Signature 

CITY OF SACRAMENTO
NEIGHBORHOODS, PLANNING
AND DEVELOPMENT SERVICES

WARNING: FAILURE TO SECURE WORKER'S COMPENSATION COVERAGE IS UNLAWFUL AND SHALL SUBJECT AN EMPLOYER TO CRIMINAL PENALTIES AND CIVIL FINES UP TO ONE HUNDRED THOUSAND DOLLARS (\$100,000) IN ADDITION TO THE COST OF COMPENSATION, DAMAGES AS PROVIDED FOR IN SECTION 3706 OF THE LABOR CODE, INTEREST AND ATTORNEY'S FEE.

THIS PERMIT SHALL EXPIRE BY LIMITATION IF WORK IS NOT COMMENCED WITHIN 180 DAYS.

RESIDENTIAL SUBDIVISION BUILDING PERMIT APPLICATION

Project Address: 2660 Maybrook Dr Assessor Parcel # 201-041-085
Lot Number: 31 Subdivision Northborough Village

OWNER INFORMATION:

Legal Property Owner: Morrison Homes Phone# (916) 355-8900
Owner Address: 1130 Iron Point Rd #120 City Folsom State CA Zip 95630

CONTRACTOR INFORMATION:

Contractor: Morrison Homes Lic. # 519465 Phone # 355-8900 Fax 355-0100

PROJECT INFORMATION:

Land Use Zone R1A Occupancy Group R3 Construction Type VN Fed Code 1A
No. of Stories: 2 No. of Rooms: 8 Street Width:
1st Floor Area 917 2nd Floor Area 937 Basement Roof Material
AREA IN SQUARE FOOT OF:
Dwelling/Living 1854
Garage/Storage 474
Decks/Balconies 84
Carports
SCOPE OF WORK: New Single Family Dwelling

FOR OFFICE USE ONLY

- Information Above Complete AR Flood Waiver Required Planning Approval
Violation Files Checked Flood Elevation Certificate Required Design Review Approval
Standard Setbacks Water Development Infill Area Special Fee Districts Apply:
County Sewer

THE FOLLOWING MUST BE PROVIDED IN ORDER TO SUBMIT FOR PERMIT

- 2 COMPLETE PLOT PLANS, LEGIBLE & DRAWN TO SCALE
11 X 17 COPY OF FLOOR PLAN WITH FOLLOWING INFORMATION
a) Assessor's Parcel Number c) Owners Name
b) New Floor Area d) Project Address

Date: Received by: (staff) Permit #

THIS PLAN IS A PRELIMINARY DESIGN AND IS SUBJECT TO CHANGE WITHOUT NOTICE. THE OWNER DOES NOT REPRESENT THE ACCURACY OF DIMENSIONS OR UTILITIES.

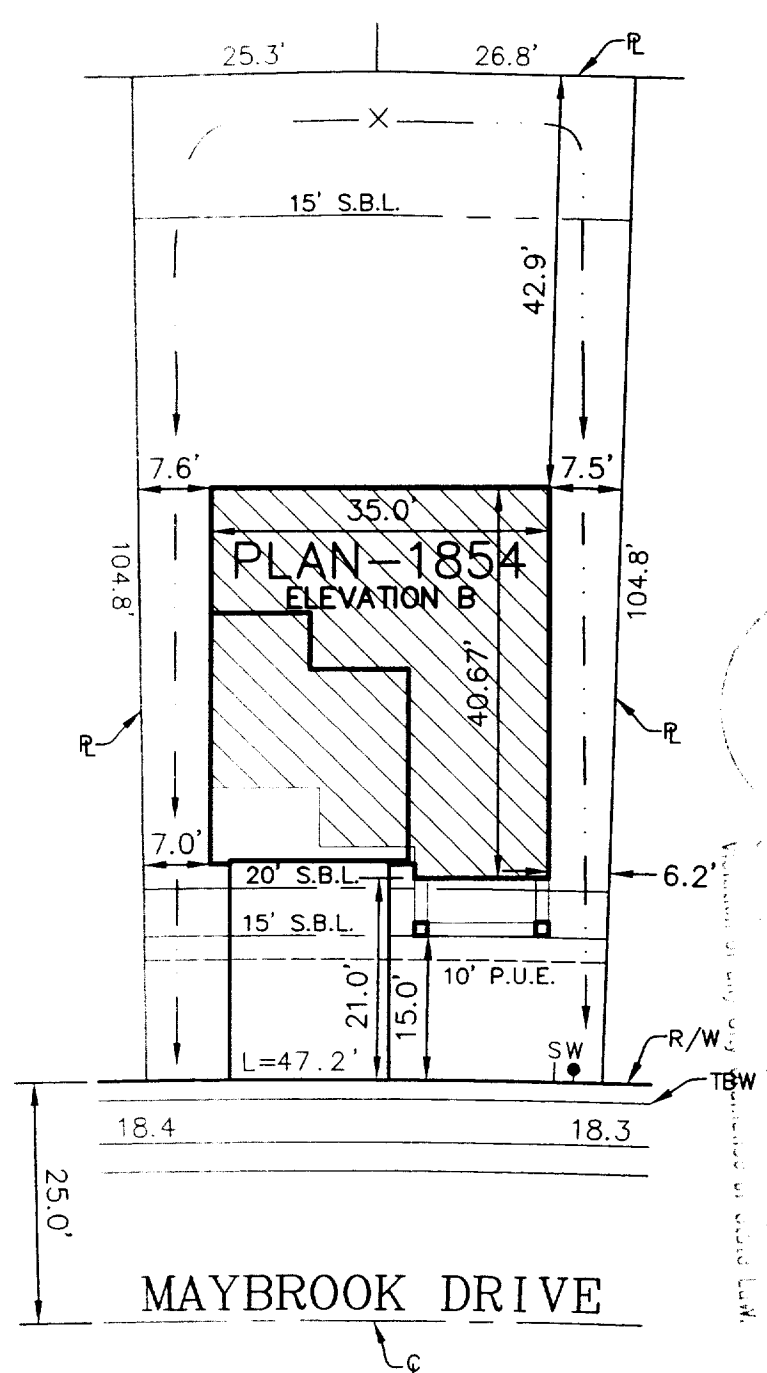

PRINT IN CONFORMANCE WITH 1997 UBC

NOTE:
 It is understood that the drainage areas, slopes and grades shall not be altered, changed, blocked, modified or in any way be reconstructed by Owner contrary to what is depicted on this Plot Plan. THESE CONDITIONS RUN WITH THE LAND AND ARE BINDING ON ALL SUBSEQUENT OWNERS.

Morrison Homes Rep. _____ Date _____
 Owner _____ Date _____

NOTE:
 All setback dimensions and elevations as shown may be adjusted to fit field conditions.

ELECTRICAL SERVICE ON LEFT SIDE OF LOT.
 A.P.N. = 201-041-085
 PAD ELEV = 20.2
 FOOTPRINT = 1854B SF
 LOT AREA = 5,206 SF
 ALLOWED LOT COVERAGE = 40% = 2,082 SF
 ACTUAL LOT COVERAGE = 27% = 1,391 SF

LOT 31
2660 MAYBROOK DRIVE
NORTHBOROUGH VILLAGE 2
COUNTY OF SACRAMENTO

APPROVAL:
[Signature]
 MORRISON HOMES Rep. _____ Date 9-6-00

3222 Ramon Circle Sacramento CA 95827
 916/366-3040 Fax 916/366-3303
 R.E.Y. ENGINEERS, Inc.
 Civil Engineers / Land Surveyors

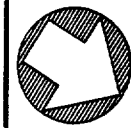

JOB NO.	2660B
DRAWN	MJM
CHECKED	BT
DATE	08-29-00
SCALE	1"=20'