

## **RESOLUTION NO. 2008-193**

Adopted by the Sacramento City Council

March 25, 2008

### **AMENDING THE SOUTH SACRAMENTO COMMUNITY PLAN LAND USE MAP FROM LOW DENSITY RESIDENTIAL 4-8 TO GENERAL COMMERCIAL (7725 SHELDON ROAD) (P07-098) (APN: 117-0212-056)**

#### **BACKGROUND**

The City Council conducted a public hearing on March 25, 2008 concerning the above plan amendment and based on documentary and oral evidence submitted at the public hearing, the Council hereby finds:

1. The proposed land use amendments are compatible with the surrounding land uses;
2. The subject site is suitable for commercial development; and
3. The proposal is consistent with the policies of the South Sacramento Community Plan.

#### **BASED ON THE FACTS SET FORTH IN THE BACKGROUND, THE CITY COUNCIL RESOLVES AS FOLLOWS:**

Section 1. The property described on the attached Exhibit A in the City of Sacramento is hereby redesignated on the South Sacramento Community Plan Land Use Map as 1.49± acres of General. (APN: 117-0212-056)

#### **Table of Contents:**

Exhibit A - Community Plan Amendment

# Exhibit A – Community Plan Amendment

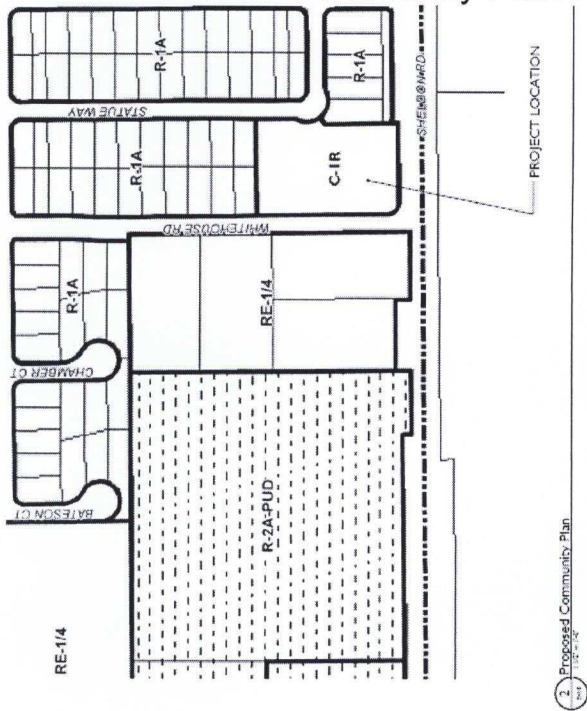

2 Proposed Community Plan

General Plan (P): Community/Neighborhood Commercial  
 Community Plan (P): General Commercial  
 Zoning (P): C-IR

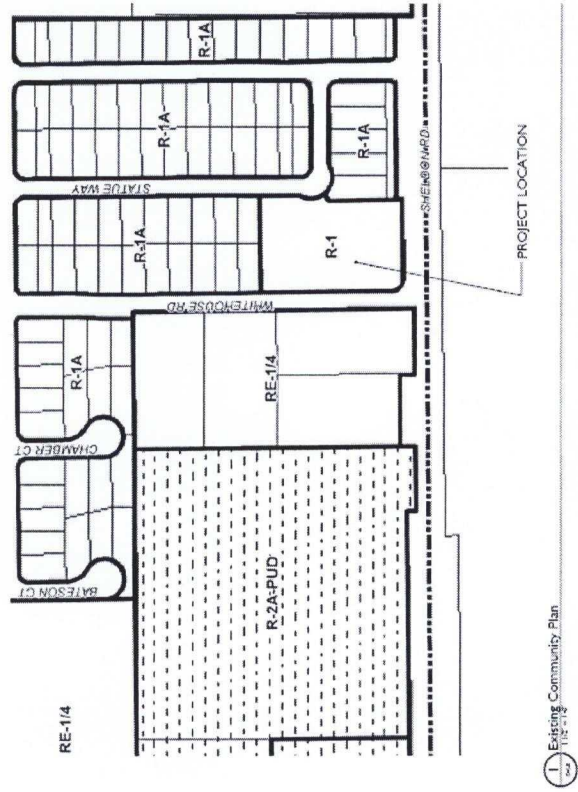

1 Existing Community Plan

General Plan (E): Low Density Residential  
 Community Plan (E): Low Density Residential  
 Zoning (E): R-1

Adopted by the City of Sacramento City Council on March 25, 2008 by the following vote:

Ayes: Councilmembers Cohn, Fong, Hammond, McCarty, Pannell, Sheedy, Tretheway, Waters, and Mayor Fargo.

Noes: None.

Abstain: None.

Absent: None.

  
\_\_\_\_\_  
Mayor Heather Fargo

Attest:

  
\_\_\_\_\_  
Dawn Bullwinkel, Assistant City Clerk