

CITY OF SACRAMENTO
1231 I Street, Sacramento, CA 95814

Permit No: 0611794
Insp Area: 4
Thos Bros: 277E6

Site Address: 2431 NORTHGATE BL SAC
Parcel No: 274-0110-046 BROOKE INSURANCE

Sub-Type: ATTACHI

CONTRACTOR
SIGN UP CO.
4200 82ND ST STE C
SACRAMENTO CA 95826

OWNER
JLD WP
642 TIBURON BL
TIBURON, CA 94920

TENANT

Nature of Work: 1 set, S/F, plastic face, channel letter w/raceway, neon illumination

CONSTRUCTION LENDING AGENCY: I hereby affirm under penalty of perjury that there is a construction lending agency for the performance of the work for which this permit is issued (Sec. 3097, Civ. C).

Lender's Name _____ Lender's Address _____

LICENSED CONTRACTORS DECLARATION: I hereby affirm under penalty of perjury that I am licensed under provisions of Chapter 9 (commencing with section 7000) of Division 3 of the Business and Professions Code and my license is in full force and effect.

License Class C-45 License Number 555805 Date 8/3/06 Contractor Signature _____

OWNER-BUILDER DECLARATION: I hereby affirm under penalty of perjury that I am exempt from the contractors License Law for the following reason (Sec. 7031.5, Business and Professions Code; any city or county which requires a permit to construct, alter, improve, demolish, or repair any structure, prior to its issuance, also requires the applicant for such permit to file a signed statement that he or she is licensed pursuant to the provisions of the Contractors License Law (Chapter 9 (commencing with Section 7000) of Division 8 of the Business and Professions Code) or that he or she is exempt therefrom and the basis for the alleged exemption. Any violation of Section 7031.5 by any applicant for a permit subjects the applicant to a civil penalty of not more than five hundred dollars (\$500.00);

I, as a owner of the property, or my employees with wages as their sole compensation, will do the work, and the structure is not intended or offered for sale (Sec. 7044, Business and Professional Code: The Contractors License Law does not apply to an owner of property who builds or improves thereon, and who does such work himself or herself or through his/her own employees, provided that such improvements are not intended or offered for sale. If, however, the building or improvement is sold within one year of completion, the owner-builder will have the burden of proving that he/she did not build or improve for the purpose of sale.)

I, as owner of the property, am exclusively contracting with licensed contractors to construct the project (Sec. 7044, Business and Professions Code: The Contractors License Law does not apply to an owner of property who builds or improves thereon, and who contracts for such projects with a contractor(s) licensed pursuant to the Contractors License Law).

I am exempt under Sec. _____ B & PC for this reason: _____
Date _____ Owner Signature _____

PAYED
CITY OF SACRAMENTO
AUG 03 2006
NEIGHBORHOODS PLANNING
AND DEVELOPMENT SERVICES

IN ISSUING THIS BUILDING PERMIT, the applicant represents, and the city relies on the representation of the applicant that the applicant verified all measurements and locations shown on the application or accompanying drawings and that the improvement to be constructed does not violate any law or private agreement relating to permissible or prohibited locations for such improvements. This building permit does not authorize any illegal location of any improvement or the violation of any private agreement relating to location of improvements.

I certify that I have read this application and state that all information is correct. I agree to comply with all city and county ordinances and state laws relating to building construction and hereby authorize representative(s) of this city to enter upon the abovementioned property for inspection purposes.

Date 8/3/06 Applicant/Agent Signature _____

WORKER'S COMPENSATION DECLARATION: I hereby affirm under penalty of perjury one of the following declarations:
I have and will maintain a certificate of consent to self-insure for workers' compensation as provided for by Section 3700 of the Labor Code, for the performance of work for which the permit is issued.

I have and will maintain workers' compensation insurance, as required by Section 3700 of the Labor Code, for the performance of the work for which this permit is issued. My workers' compensation insurance carrier and policy number are:

Carrier EXEMPT Policy Number NO EMPLOYEES Exp Date _____

(This section need not be completed if the permit is for \$100 or less) I certify that in the performance of the work for which this permit is issued, I shall not employ any person in any manner so as to become subject to the workers' compensation laws of California and agree that if I should become subject to the workers' compensation provisions of Section 3700 of the Labor Code, I shall forthwith comply with those provisions.

Date 8/3/06 Applicant Signature _____

WARNING: FAILURE TO SECURE WORKER'S COMPENSATION COVERAGE IS UNLAWFUL AND SHALL SUBJECT AN EMPLOYER TO CRIMINAL PENALTIES AND CIVIL FINES UP TO ONE HUNDRED THOUSAND DOLLARS (\$100,000) IN ADDITION TO THE COST OF COMPENSATION, DAMAGES AS PROVIDED FOR IN SECTION 3706 OF THE LABOR CODE, INTEREST AND ATTORNEY'S FEE.

THIS PERMIT SHALL EXPIRE BY LIMITATION IF WORK IS NOT COMMENCED WITHIN 180 DAYS.

Sign Permit Application

2101 Arena Blvd. Ste.200 Sacramento CA 95834
 1231 I St. Ste.200 Sacramento CA 95814
 (916) 808-5656
 * Required Information



Inspection Line
 (916) 808-7622 or 808-5716

Sign Permit # 0611794 **Area** 4

***Sign Address**

2431 NORTHGATE BLVD

| | | |
|--|----------------|------------|
| APN # <u>274-0110-046</u> Zone: <u>C-2 SPD</u> | DR-PB/ PUD/SC: | P/ZA File: |
|--|----------------|------------|

***Sign Applicant**

Property Owner \ License Contractor: Sign up Co

Address: 8230 BELVEDERE AVE Phone: 916 455-1300

Contractor License # 555805 Class C-45

***Sign Information**

| | | | |
|-----------------------|-------------------------|------------------------|-------------------------|
| Attached | | Detached | |
| Bldg. Tenant Frontage | <u>20'</u> lineal. foot | Parcel Street Frontage | lineal. foot |
| Sign I.D. Tag | *Ht. x Wth. | = Sign Area | Sign Copy |
| <u>S 060441</u> | <u>28" x 100"</u> | <u>19 1/2 sq ft</u> | <u>BROOKE INSURANCE</u> |
| <u>S</u> | | | |
| <u>S</u> | | | |
| <u>S</u> | | | |

Required Plan Review Approvals | Structural | Electrical | Design Review

| Code | Final Sign Inspection | Approved | Date |
|------|-----------------------|----------|------|
| 99 | FOOTING | | |
| 99 | BUILDING | | |
| 98 | ELECTRICAL | | |
| n/a | SPECIAL INSPECTION | | |

THIS SIGN PERMIT SHALL EXPIRE BY LIMITATION IF WORK AUTHORIZED IS NOT COMMENCED WITHIN 180 DAYS

PAID
 CITY OF SACRAMENTO
 AUG 03 2006
 NEIGHBORHOODS PLANNING
 AND DEVELOPMENT SERVICES

| Fees | | \$100.00 per application. | |
|---|----------------------|---------------------------|---------------|
| Total Sign Permit Fees : see Development Fee Schedule | | | |
| Cashier | Description | Date | Amount |
| | Sign Application Fee | | |
| | Other | | |
| | Balance | | |
| Total | Sign Permit Fee | | <u>193.30</u> |

x Pat O'Neil 8-3-06 Approved Sign Permit

CITY COPY

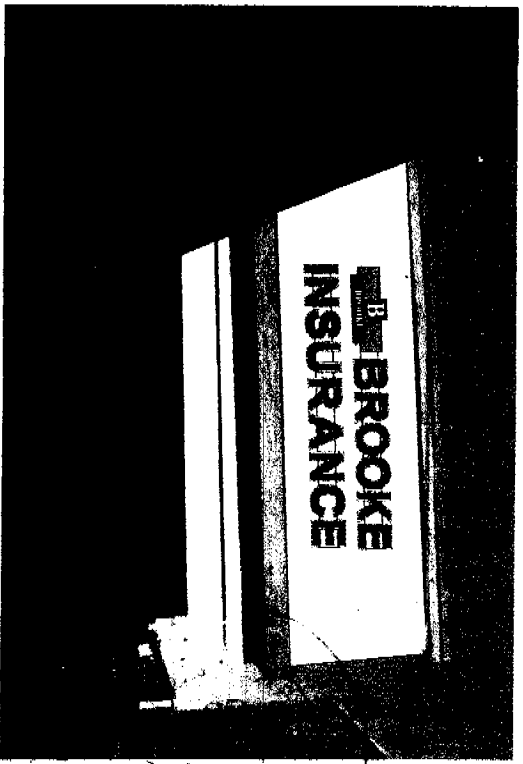

20'

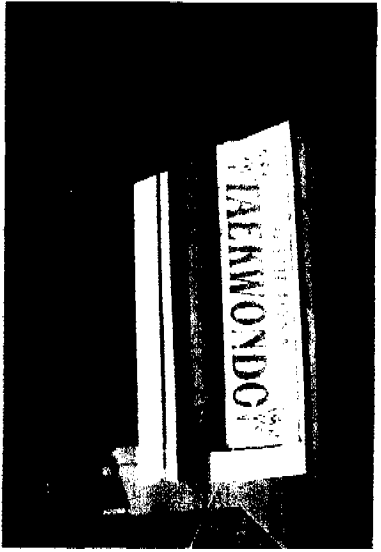

REMOVE EXISTING SIGN

ALL SIGN INSTALLATIONS ARE SUBJECT TO FIELD INSPECTIONS

EXISTING SIGN MUST BE USED AS DESIGN INTENDED

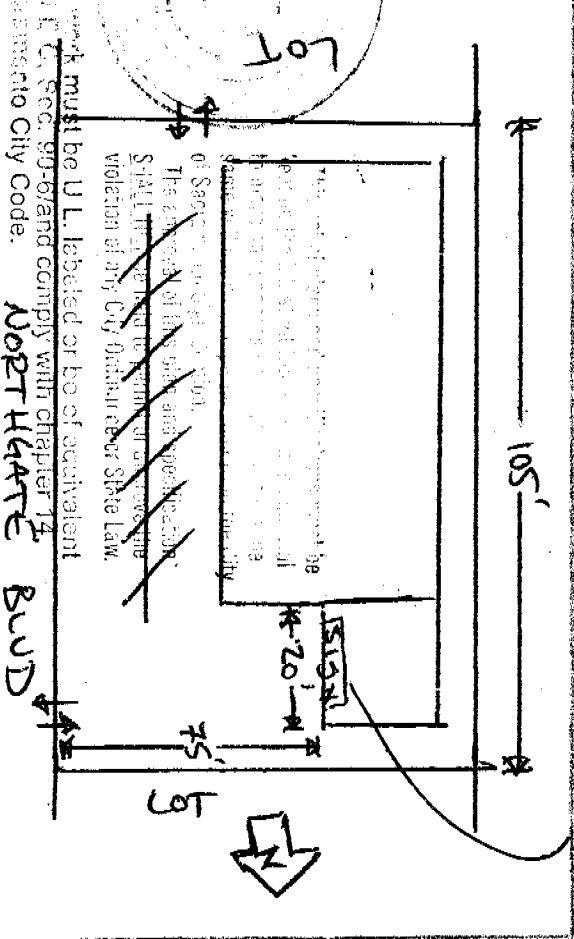

506044

105"
 BROOKE
 INSURANCE

BR signs INC.

4100 N Powerline Road, Suite G-4
 Pompano Beach FL 33073
 954-957-9961 888-957-9961
 Fax 954-957-9014
 Master Electrical Sign Contractor E111000660

| | | | |
|---|-----------------|------------|---------------|
| Job No. | B1931 | Date | April 18 2006 |
| Order | Sign Department | Supervisor | Bill Reichert |
| Comments: CHANNEL LETTERS ATTACHED TO RACEWAY PAINTED TO MATCH BUILDING | | | |

CITY COPY

Approved by: _____
 Customer/Company Contact Information
 Brooke Insurance #931
 2431 Northgate Blvd.
 Sacramento CA 95833

PLASTIC FACE CHANNEL LETTER WITH RACEWAY WITH NEON ILLUMINATION

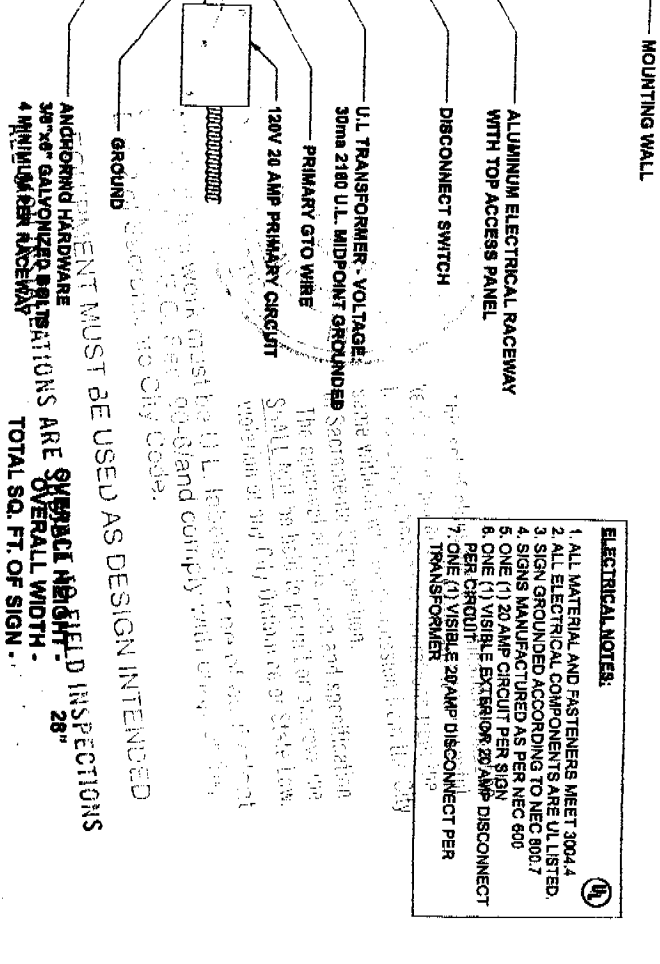
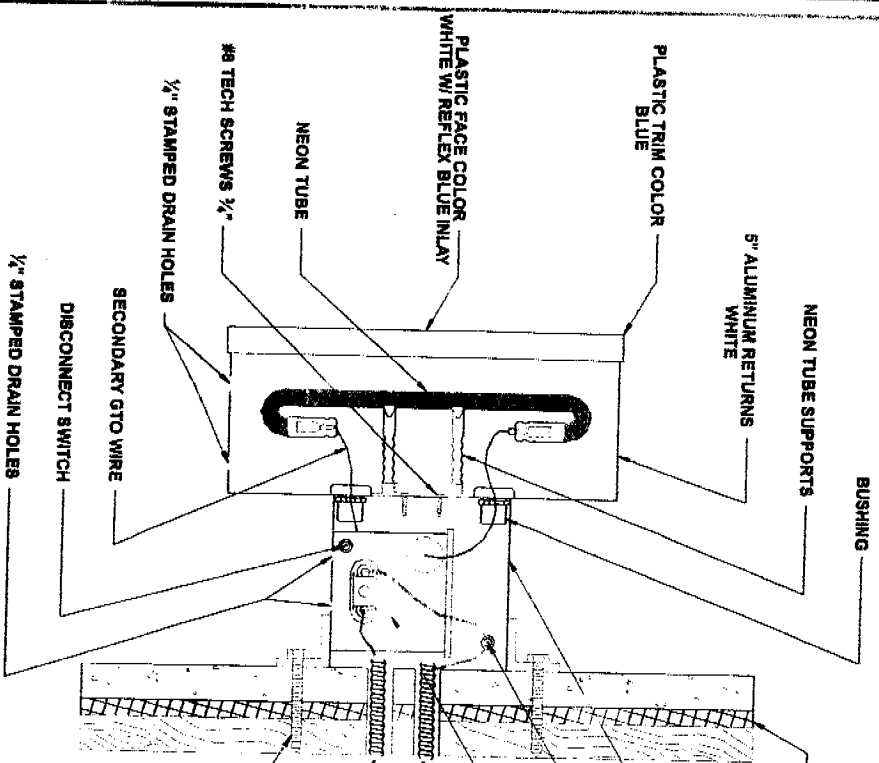

- ELECTRICAL NOTES:**
1. ALL MATERIAL AND FASTENERS MEET 3004.4
 2. ALL ELECTRICAL COMPONENTS ARE UL LISTED.
 3. SIGN GROUNDED ACCORDING TO NEC 800.7
 4. SIGNS MANUFACTURED AS PER NEC 800
 5. ONE (1) 20 AMP CIRCUIT PER SIGN
 6. ONE (1) VISIBLE EXTENSION 20 AMP DISCONNECT PER CIRCUIT
 7. ONE (1) VISIBLE 20 AMP DISCONNECT PER TRANSFORMER

ANCHORING HARDWARE MUST BE USED AS DESIGN INTENDED
 3/8" X 6" GALVANIZED STEEL ANCHORS ARE REQUIRED
 4 MINIMUM PER ANCHOR
 OVERALL HEIGHT - 28"
 TOTAL SQ. FT. OF SIGN . . .

BROOKE INSURANCE

Approved by: _____
 APPROVAL OF ALL ELECTRICAL WORK
 Customer/Company: _____
 IS SUBMITTED TO: _____
 Brooke Insurance #931
 2431 Northgate Blvd.
 Sacramento CA 95833

BR signs INC.
 4100 N Powerline Road, Suite G-4
 Pompano Beach FL 33073
 954-957-9961 888-957-9961
 Fax 954-957-9014
 Master Electrical Sign Contractor: E111000660

| | | | |
|-----------------|---------------|-----------|---------------|
| Job No | B931 | Date | April 18 2006 |
| Order Date | | Submittal | Bill Reichert |
| Sign Dimensions | 28" X 98 1/2" | | |
| Comments: | | | |