

**CITY OF SACRAMENTO**  
1231 I Street, Sacramento, CA 95814

**Permit No:** 0408872  
**Insp Area:** 2  
**Thos Bros:** 337-C4

**Site Address:** 1919 71ST AV SAC  
**Parcel No:** PARUNKN000  
N

MEADOWVIEW ESTATES NORTH LOT 39

**Sub-Type:** NSFR  
**Housing (Y/N):**

**CONTRACTOR**  
JTS COMMUNITIES  
401 WATT AV.  
SACRAMENTO CA. 95864

**OWNER**  
JTS COMMUNITIES  
401 WATT AV.  
SACRAMENTO CA. 95864

**ARCHITECT**

**Nature of Work:** JTS MP153 1 STORY 9 ROOM SFR

**CONSTRUCTION LENDING AGENCY :** I hereby affirm under penalty of perjury that there is a construction lending agency for the performance of the work for which this permit is issued (Sec. 3097, Civ. C).

Lender's Name \_\_\_\_\_ Lender's Address \_\_\_\_\_

**LICENSED CONTRACTORS DECLARATION:** I hereby affirm under penalty of perjury that I am licensed under provisions of Chapter 9 (commencing with section 7000) of Division 3 of the Business and Professions Code and my license is in full force and effect.

License Class B License Number 767107 Date 6/24/04 Contractor Signature [Signature]

**OWNER-BUILDER DECLARATION:** I hereby affirm under penalty of perjury that I am exempt from the contractors License Law for the following reason (Sec. 7031.5, Business and Professions Code; any city or county which requires a permit to construct, alter, improve, demolish, or repair any structure, prior to its issuance, also requires the applicant for such permit to file a signed statement that he or she is licensed pursuant to the provisions of the Contractors License Law (Chapter 9 (commencing with Section 7000) of Division 8 of the Business and Professions Code) or that he or she is exempt therefrom and the basis for the alleged exemption. Any violation of Section 7031.5 by any applicant for a permit subjects the applicant to a civil penalty of not more than five hundred dollars (\$500.00);

\_\_\_\_\_, I, as a owner of the property, or my employees with wages as their sole compensation, will do the work, and the structure is not intended or offered for sale (Sec. 7044, Business and Professional Code: The Contractors License Law does not apply to an owner of property who builds or improves thereon, and who does such work himself or herself or through his/her own employees, provided that such improvements are not intended or offered for sale. If, however, the building or improvement is sold within one year of completion, the owner-builder will have the burden of proving that he/she did not build or improve for the purpose of sale.)

\_\_\_\_\_, I, as owner of the property, am exclusively contracting with licensed contractors to construct the project (Sec. 7044, Business and Professions Code: The Contractors License Law does not apply to an owner of property who builds or improves thereon, and who contracts for such projects with a contractor(s) licensed pursuant to the Contractors License Law).

\_\_\_\_\_, I am exempt under Sec. \_\_\_\_\_ B & PC for this reason: \_\_\_\_\_  
Date \_\_\_\_\_ Owner Signature \_\_\_\_\_

**PAID**  
**CITY OF SACRAMENTO**  
**JUN 24 2004**  
**NORTH PERMIT**

**IN ISSUING THIS BUILDING PERMIT,** the applicant represents, and the city relies on the representation of the applicant, that the applicant verified all measurements and locations shown on the application or accompanying drawings and that the improvement to be constructed does not violate any law or private agreement relating to permissible or prohibited locations for such improvements. This building permit does not authorize any illegal location of any improvement or the violation of any private agreement relating to location of improvements.

I certify that I have read this application and state that all information is correct. I agree to comply with all city and county ordinances and state laws relating to building construction and hereby authorize representative(s) of this city to enter upon the abovementioned property for inspection purposes.

Date 6/24/04 Applicant/Agent Signature [Signature]

**WORKER'S COMPENSATION DECLARATION:** I hereby affirm under penalty of perjury one of the following declarations:

\_\_\_\_\_, I have and will maintain a certificate of consent to self-insure for workers' compensation as provided for by Section 3700 of the Labor Code, for the performance of work for which the permit is issued.

I have and will maintain workers' compensation insurance, as required by Section 3700 of the Labor Code, for the performance of the work for which this permit is issued. My workers' compensation insurance carrier and policy number are:

Carrier ZURICH INSURANCE CO Policy Number WC367556101 Exp Date 03/01/2004

\_\_\_\_\_, (This section need not be completed if the permit is for \$100 or less) I certify that in the performance of the work for which this permit is issued, I shall not employ any person in any manner so as to become subject to the workers' compensation laws of California and agree that if I should become subject to the workers' compensation provisions of Section 3700 of the Labor Code, I shall forthwith comply with those provisions.

Date 6/24/04 Applicant Signature [Signature]

**WARNING: FAILURE TO SECURE WORKER'S COMPENSATION COVERAGE IS UNLAWFUL AND SHALL SUBJECT AN EMPLOYER TO CRIMINAL PENALTIES AND CIVIL FINES UP TO ONE HUNDRED THOUSAND DOLLARS (\$100,000) IN ADDITION TO THE COST OF COMPENSATION, DAMAGES AS PROVIDED FOR IN SECTION 3706 OF THE LABOR CODE, INTEREST AND ATTORNEY'S FEE.**

**THIS PERMIT SHALL EXPIRE BY LIMITATION IF WORK IS NOT COMMENCED WITHIN 180 DAYS.**

ORIGINAL

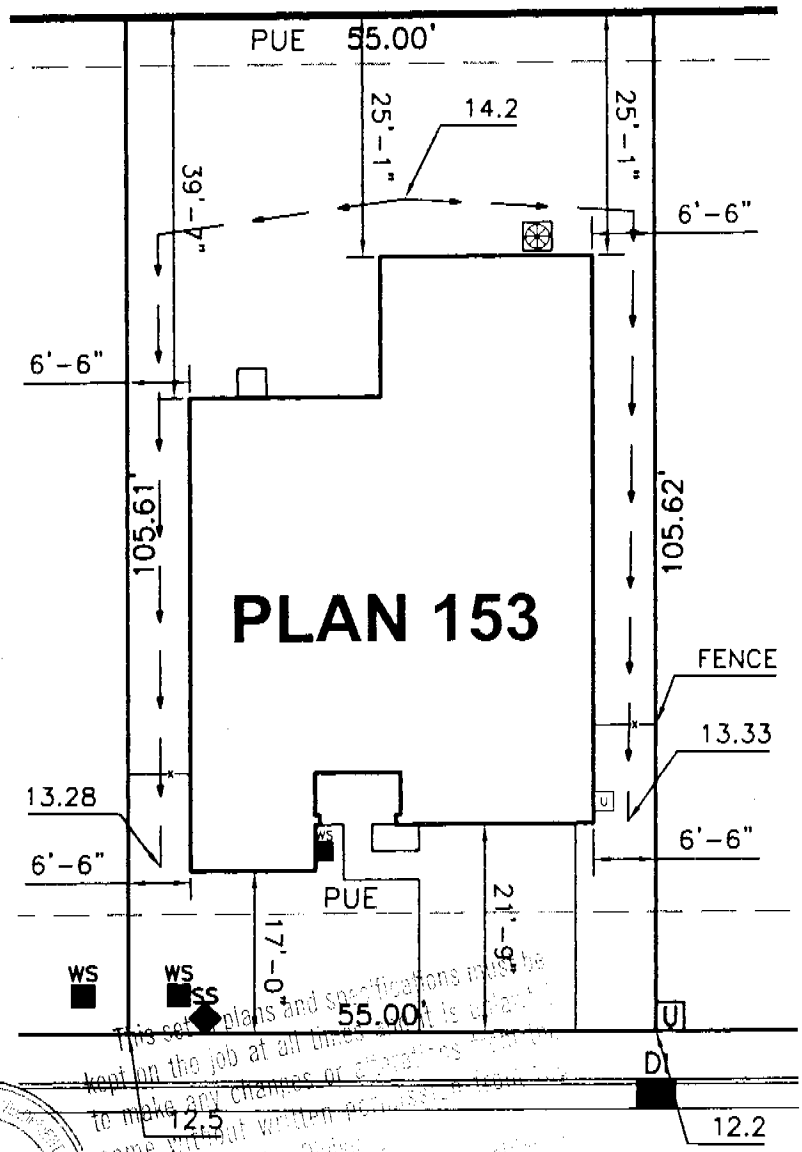

PLAN 153

71ST AVENUE

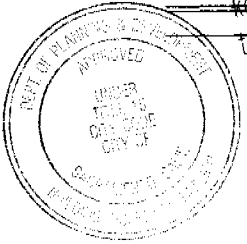

APN:
ADDRESS: 71ST AVENUE SACRAMENTO CA
STORIES: 1
GARAGES: 2
PAD: 14.5
F.F.: 15.17

- DI DRAIN INLET
- WS WATER SERVICE
- SS SEWER SERVICE
- U ELECTRICAL SERVICE
- LIGHT POLE
- TRANSFORMER

DIMENSIONS SHOWN ARE APPROXIMATE AND ARE FOR THE SOLE PURPOSE OF COUNTY/CITY APPROVAL. ADDITIONAL INFORMATION REFLECTED ON THIS DOCUMENT SUCH AS FENCE, WALL, UTILITY, AND MAILBOX LOCATIONS ARE SUBJECT TO CHANGE WITHOUT NOTIFICATION TO BUYER. THIS PLOT PLAN MAY NOT REFLECT ALL "AS BUILT" CONDITIONS WHICH MIGHT VARY FROM THIS PROPOSED PLOT PLAN.

SCALE:	1" = 20'-0"
DATE:	APRIL 15, 2004
DRAWN BY:	CD
BACK CHECKED BY:	SARAH
BUYER APPROVAL:	DATE

**MEADOWVIEW  
ESTATES  
PLOT PLAN**

**LOT 0N39**

**JTS** Working Together to Achieve Excellence

COMMUNITIES INC.

401 Watt Ave.  
Sacramento, CA 95864 (916) 487-3434

INSTALLATION  
Diamond Wall One Coat System  
Omega Products International, Inc.

Project Address

1919 71st Ave

ICBO Evaluation Service, Inc.  
Report ER-4004

Date Completed

10-2-04

Plastering Contractor

Name:

J.T.S. Stucco Div.

Address:

11285 White Rock Road

Telephone No.

(916) 635-2800

Approved contractor number as issued by Omega Products Int'l, Inc. P.N. # 2327

This is to certify that the exterior coating system on the building exterior at the above address has been installed in accordance with the evaluation report and the manufacturer's instructions.

Don Richards  
Signature of authorized representative of  
plastering contractor

10-2-04  
Date

This installation card must be presented to the building inspector after completion of work and before final inspection.

Title 24 Energy Compliance Requirements

(Micropas Version 6.01)

ITS Communities - Delta Shores Premier Series  
 Sacramento, CA - Climate Zone 12

July 23, 2003

<u>Plan</u>	<u>151</u>	<u>152</u>	<u>153</u>	<u>155</u>	<u>155</u>	
				Unit 1	unit 2	
Number of Stories	1	1	1	1	1	
Square Footage	1302	1638	1800	1190	1035	
Wall 2x4 (R13 Batt+1" Foam Board, R=4)	R-17	R-17	R-17	R-17	R-17	Total R-Value = R-17
Attic Insulation	R-30	R-30	R-30	R-30	R-30	
AFUE (Furnace)	0.80	0.80	0.80	0.80	0.80	
SEER (AC Unit)	10.0	10.0	10.0	10.0	10.0	
Duct Insulation	R-4.2	R-4.2	R-4.2	R-4.2	R-4.2	
Water Heater Energy Factor	0.62	0.62	0.62	0.62	0.62	
Tank Capacity / Gallons	40	40	40	40	40	
<u>Glass U-Values</u>	<u>Double Pane, Vinyl, Spectrally Selective (LowE2)</u>					
Horizontal Slider	0.36	0.36	0.36	0.36	0.36	
Vertical Slider	0.37	0.37	0.37	0.37	0.37	
Fixed	0.35	0.35	0.35	0.35	0.35	
Patio Door	0.42	0.42	0.42	0.42	0.42	
French Door	0.42	0.42	0.42	0.42	0.42	
<u>Solar Heat Gain Coefficient</u>	<u>HSVS = 0.33</u>	<u>Fixed = 0.34</u>	<u>Patio Door = 0.35</u>	<u>French Door = 0.35</u>		
Glazing Percent	14.6%	15.9%	15.4%	13.5%	11.7%	
T-24 Compliance Margin	2.15	1.24	0.90	1.98	3.12	

*OK to Sens Docs.  
 Could you put these in their own Binder?  
 Sat. 7-23-03*

(KBS)

# CERTIFICATION OF INSULATION

PART I GENERAL	ADDRESS OR TRACT			SACRAMENTO BUILDING PRODUCTS							
	<p style="font-size: 1.2em; margin: 0;"><i>JTS</i> <i>Masters</i></p> <p style="margin: 0;">LOT # <i>N39</i></p>			<input type="checkbox"/> P.O. BOX 854, WEST SACRAMENTO, CA 95691 LIC. #202026 <input type="checkbox"/> 1309 MELODY ROAD, MARYSVILLE, CA 95901 LIC. #202026 <input type="checkbox"/> P.O. BOX 9651, FRESNO, CA 93793-9651 LIC. #202026 <input type="checkbox"/> P.O. BOX 1631, RENO, NV 89505 LIC. #10675 <input type="checkbox"/> 3326 A PONDEROSA WAY, LAS VEGAS, NV 89118 LIC. #10675 <p style="text-align: center; margin: 5px 0;"><i>11-6-</i></p> DATE INSULATION COMPLETED							
PART II AREAS INSULATED	WALLS			CEILINGS			FLOORS				
	(                      SQUARE FEET)			(                      SQUARE FEET)			(                      SQUARE FEET)				
	TYPE OF INSULATION			TYPE OF INSULATION			TYPE OF INSULATION				
	MATERIAL <b>FIBERGLASS</b>			MATERIAL <b>FIBERGLASS</b>			MATERIAL <b>FIBERGLASS</b>				
	FORM <b>BATTS</b>			FORM <b>BATTS &amp; BLOW</b>			FORM <b>BATTS</b>				
	MANUFACTURER'S PRODUCT I.D.			MANUFACTURER'S PRODUCT I.D.			MANUFACTURER'S PRODUCT I.D.				
	MANUFACTURER			MANUFACTURER			MANUFACTURER				
	CT	OC	JM	CT	OC	JM	CT	OC	JM		
	R - VALUE INSTALLED		APPLIED THICKNESS	R - VALUE INSTALLED		APPLIED THICKNESS	R - VALUE INSTALLED		APPLIED THICKNESS		
	<i>13</i>		<i>3 1/2</i>	<i>30</i>		<i>9 12</i>					
	KNEE WALLS IF R-VALUE IS OTHER THAN WALLS ABOVE										
	MATERIAL <b>FIBERGLASS</b>			FORM <b>BATTS</b>			R VALUE			MANUFACTURER	
									CT	OC	JM
AIR INFILTRATION SEALANT											
MATERIAL <i>foam</i>						MANUFACTURER					
						<b>HILTI</b>			<b>HANDY FOAM</b>		
THIS IS TO CERTIFY THAT INSULATION AND/OR SEALANT HAS BEEN INSTALLED IN CONFORMANCE WITH APPLICABLE CODES, MATERIAL STANDARDS AND REGULATIONS.											
SIGNATURE — INSULATION CONTRACTOR <i>J.C.</i>						TITLE <b>MANAGER</b>			DATE <i>11-6-04</i>		
SIGNATURE — GENERAL CONTRACTOR						TITLE			DATE		
REMARKS											
PART III CERTIFICATION											

PERMIT NO.  
**368  
BELOW**

CITY OF SACRAMENTO  
2101 ARENA BLVD, #200  
BUILDING INSPECTIONS DIVISION

AREA NO.  
**2**

WHEN CORRECTIONS HAVE BEEN MADE, CALL 264-7622 FOR REINSPECTION OF WORK.

JOB LOCATION **JTS 71ST AVE (SEE ADDRESSES BELOW)**

INSPECTION REQUESTED **BIO/IL, PAO & SETBACKS**

THE UNDERSIGNED  BUILDING  PLUMBING  MECHANICAL  ELECTRICAL  
INSPECTOR THIS DAY INSPECTED THIS STRUCTURE FOR THE REQUESTED INSPECTION AND FOUND THE  
FOLLOWING VIOLATIONS OF CITY AND/OR STATE LAWS GOVERNING SAME:

① **REAR YARD SETBACKS MEASURED LESS THAN REQUIRED PER PLOT PLAN.**

② **PROVIDE APPROVAL FROM CITY OF SACRAMENTO PLANNING DEPT. FOR REAR YARD ENCROACHMENT.**

NOTE: YOU MAY PROCEED WITH WORK AT YOUR OWN RISK.

<u>PERMIT #</u>	<u>ADDRESS</u>
0408845	1967 71ST AVE
0408871	1901 71ST AVE
0408875	1961 "
0408844	1955 "
0408815	1949 "
0408874	1943 "
0408843	1937 "
0408873	1931 "
0408842	1923 "
0408872	1919 "
0408814	1915 "
0408841	1907 "

INSPECTOR

*J. A. ...*

DATE

**6/29/04**

BUILDING INSPECTIONS 808-5716

INSPECTOR'S COPY