

CITY OF SACRAMENTO

Permit No: 0309684

1231 I Street, Sacramento, CA 95814

Insp Area: 1

Thos Bros: 297 D4

Site Address: 920 J ST SAC

Sub-Type: HSG

Parcel No: 006-0101-011

Housing (Y/N): Y

CONTRACTOR

OWNER

ARCHITECT

SIDDIQUI JAVED T/AMNA J
1808 J ST
SACRAMENTO CA 95814

Nature of Work: COMPLETE REPAIRS FROM PERMIT# 0301028H , PER HOUSING CHECKLIST

CONSTRUCTION LENDING AGENCY : I hereby affirm under penalty of perjury that there is a construction lending agency for the performance of the work for which this permit is issued (Sec. 3097, Civ. C).

Lender's Name Lender's Address

LICENSED CONTRACTORS DECLARATION: I hereby affirm under penalty of perjury that I am licensed under provisions of Chapter 9 (commencing with section 7000) of Division 3 of the Business and Professions Code and my license is in full force and effect.

License Class License Number Date Contractor Signature

OWNER-BUILDER DECLARATION: I hereby affirm under penalty of perjury that I am exempt from the contractors License Law for the following reason (Sec. 7031.5, Business and Professions Code; any city or county which requires a permit to construct, alter, improve, demolish, or repair any structure, prior to its issuance, also requires the applicant for such permit to file a signed statement that he or she is licensed pursuant to the provisions of the Contractors License Law (Chapter 9 (commencing with Section 7000) of Division 8 of the Business and Professions Code) or that he or she is exempt therefrom and the basis for the alleged exemption. Any violation of Section 7031.5 by any applicant for a permit subjects the applicant to a civil penalty of not more than five hundred dollars (\$500.00);

I, as a owner of the property, or my employees with wages as their sole compensation, will do the work, and the structure is not intended or offered for sale (Sec. 7044, Business and Professional Code: The Contractors License Law does not apply to an owner of property who builds or improves thereon, and who does such work himself or herself or through his/her own employees, provided that such improvements are not intended or offered for sale. If, however, the building or improvement is sold within one year of completion, the owner-builder will have the burden of proving that he/she did not build or improve for the purpose of sale.)

X I, as owner of the property, am exclusively contracting with licensed contractors to construct the project (Sec. 7044, Business and Professions Code: The Contractors License Law does not apply to an owner of property who builds or improves thereon, and who contracts for such projects with a contractor(s) licensed pursuant to the Contractors License Law).

I am exempt under Sec. B & PC for this reason:

Date Owner Signature

IN ISSUING THIS BUILDING PERMIT, the applicant represents, and the city relies on the representation of the applicant, that the applicant verified all measurements and locations shown on the application or accompanying drawings and that the improvement to be constructed does not violate any law or private agreement relating to permissible or prohibited locations for such improvements. This building permit does not authorize any illegal location of any improvement or the violation of any private agreement relating to location of improvements.

I certify that I have read this application and state that all information is correct. I agree to comply with all city and county ordinances and state laws relating to building construction and herby authorize representative(s) of this city to enter upon the abovementioned property for inspection purposes.

Date 7-2-03 Applicant/Agent Signature

WORKER'S COMPENSATION DECLARATION: I hereby affirm under penalty of perjury one of the following declarations: I have and will maintain a certificate of consent to self-insure for workers' compensation as provided for by Section 3700 of the Labor Code, for the performance of work for which the permit is issued.

I have and will maintain workers' compensation insurance, as required by Section 3700 of the Labor Code, for the performance of the work for which this permit is issued. My workers' compensation insurance carrier and policy number are:

Carrier Policy Number Exp Date

(This section need not be completed if the permit is for \$100 or less) I certify that in the performance of the work for which this permit is issued, I shall not employ any person in any manner so as to become subject to the workers' compensation laws of California and agree that if I should become subject to the workers' compensation provisions of Section 3700 of the Labor Code, I shall forthwith comply with those provisions.

Date 7-2-03 Applicant Signature

WARNING: FAILURE TO SECURE WORKER'S COMPENSATION COVERAGE IS UNLAWFUL AND SHALL SUBJECT AN EMPLOYER TO CRIMINAL PENALTIES AND CIVIL FINES UP TO ONE HUNDRED THOUSAND DOLLARS (\$100,000) IN ADDITION TO THE COST OF COMPENSATION, DAMAGES AS PROVIDED FOR IN SECTION 3706 OF THE LABOR CODE, INTEREST AND ATTORNEY'S FEE.

RESIDENTIAL SUBDIVISION BUILDING PERMIT APPLICATION

Project Address: 2412 Autumn Meadow ^{Ave} Assessor Parcel # 201-0820-074
Lot Number: 74 Subdivision Heritage @ Natomas Park Village 13

OWNER INFORMATION:

0307684

Legal Property Owner: US Home Phone# (916) 858-3900
Owner Address 2366 Gold Meadow Way City Gold River State CA Zip 95670

CONTRACTOR INFORMATION:

Contractor: US Home Lic. # 451839 Phone # (916) 858-3900 Fax (916) 858-3925

Don McCloskey (916) 719-9050

PROJECT INFORMATION:

Land Use Zone RIA Occupancy Group R3 Construction Type VN Fed Code 1A

No. of Stories: 2 No. of Rooms: _____ Street Width: _____

1st Floor Area 1459 2nd Floor Area 1016 Basement _____ Roof Material _____

AREA IN SQUARE FOOT OF:

Dwelling/Living 2475

Garage/Storage 487

porch/ Decks/Balconies 23

Carports _____

SCOPE OF WORK: _____

FOR OFFICE USE ONLY

- Information Above Complete
- Violation Files Checked
- Standard Setbacks
- County Sewer
- AR Flood Waiver Required
- Flood Elevation Certificate Required
- Water Development Infill Area
- Planning Approval
- Design Review Approval
- Special Fee Districts Apply:

THE FOLLOWING MUST BE PROVIDED IN ORDER TO SUBMIT FOR PERMIT:

- 2 COMPLETE PLOT PLANS, LEGIBLE & DRAWN TO SCALE
- 11 X 17 COPY OF FLOOR PLAN WITH FOLLOWING INFORMATION
 - a) Assessor's Parcel Number
 - b) New Floor Area
 - c) Owners Name
 - d) Project Address



**INSULATION CONTRACTORS
ASSOCIATION
OF AMERICA**

43442

1321 DUKE STREET, SUITE 303 • ALEXANDRIA, VA 22314 • (703) 739-0356

THIS IS TO CERTIFY THAT INSULATION HAS BEEN INSTALLED IN CONFORMANCE WITH CURRENT ENERGY REGULATIONS CALIFORNIA ADMINISTRATIVE CODE TITLE 24, STATE OF CALIFORNIA IN THE BUILDING LOCATED AT

U.S. Homes LOT # 24 TRACT # TR88BITERS

STREET 2412 Autumn CITY SAC

EXTERIOR WALLS:

MANUFACTURER Ec THICKNESS/TYPE 3 1/2" / 5" R-VALUE 13/19

CEILINGS:

BATTS: MANUFACTURER Ec THICKNESS/TYPE 12 R-VALUE 38

BLOWN IN: MANUFACTURER AT THICKNESS 14 3/4 R-VALUE 38

SQUARE FOOTAGE COVERED 1121 NUMBER OF BAGS USED 26

FLOORS: MANUFACTURER _____ THICKNESS/TYPE _____ R-VALUE _____

SLAB ON GRADE: MANUFACTURER _____ THICKNESS/TYPE _____ R-VALUE _____

WIDTH OF INSULATION _____ INCHES

FOUNDATION WALLS: MANUFACTURER _____ THICKNESS/TYPE _____ R-VALUE _____

GENERAL CONTRACTOR _____ DATE _____
CALIFORNIA CONTRACTORS LICENSE # _____

SIGNATURE _____ TITLE _____

INSULATION CONTRACTOR **ARCADE INSULATION**
CALIFORNIA CONTRACTORS LICENSE #815286
NEVADA CONTRACTORS LICENSE #55201
DATE 11-20-5

[Signature] SIGNATURE [Signature] TITLE

THIS PLAN IS PREPARED TO SHOW THE DIMENSIONAL RELATIONSHIP FROM BUILDING FOUNDATION TO PROPERTY LINES, DRAINAGE CONTROL ELEVATIONS AND DIRECTION OF DRAINAGE FLOW. THIS IS DONE TO CONFORM TO LOCAL ORDINANCES FOR THE PURPOSE OF BUILDING PERMIT ISSUANCE. INFORMATION SHOWN ON THIS PLAN IS APPROXIMATE EXCEPT FOR MINIMUM SETBACKS WHICH ARE REQUIRED BY LOCAL ORDINANCE. THIS PLAN DOES NOT REFLECT AS-BUILT CONDITIONS WHICH WILL LIKELY VARY FROM THIS PLAN.

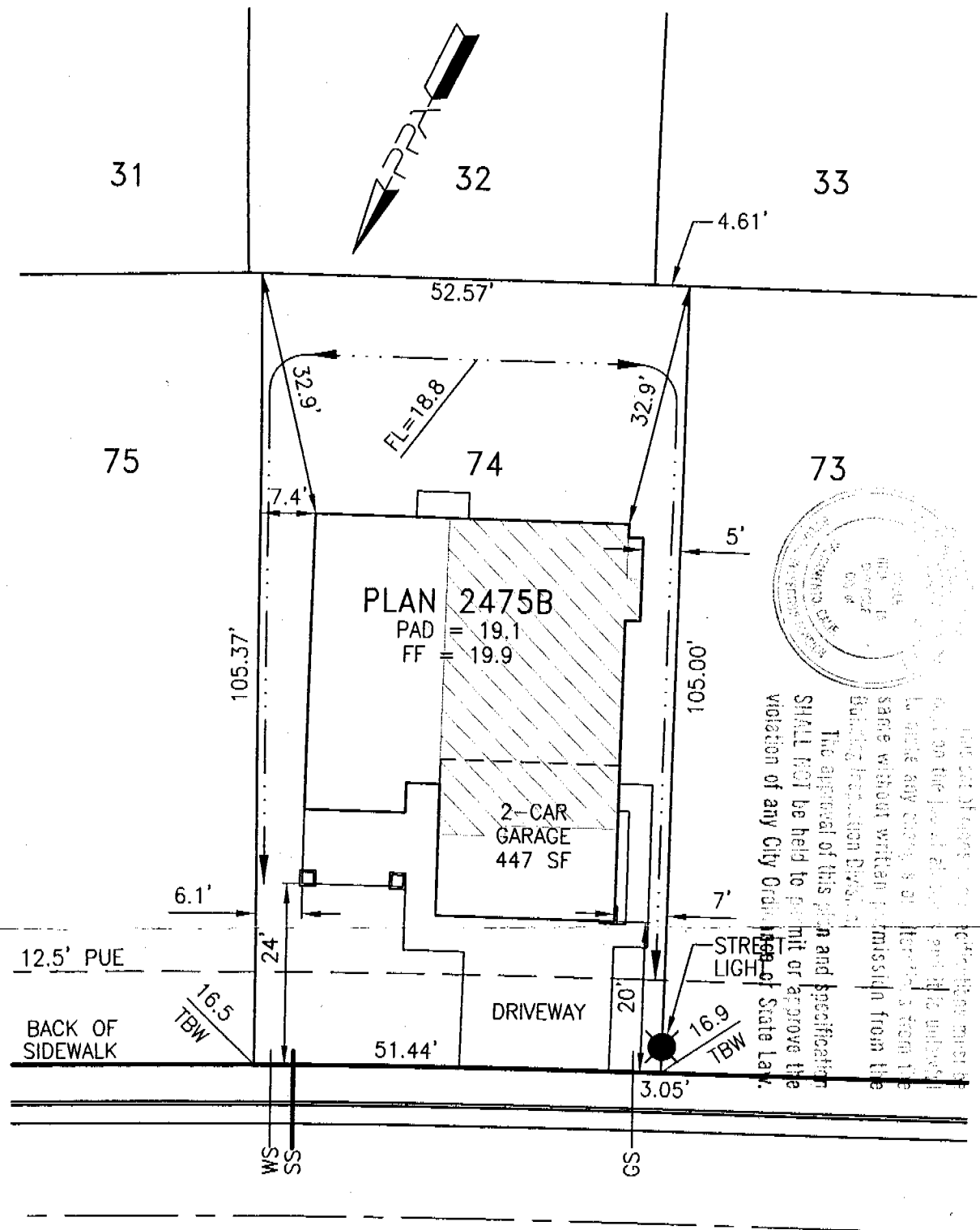

The approval of this plan and specification SHALL NOT be held to permit or approve the violation of any City Ordinance or State Law.

AUTUMN MEADOW AVENUE

| | | |
|--------------|--------------------|------|
| Approved By: | US Home Corp. Rep. | Date |
| Revision | Approved By | Date |
| 1 | | |
| 2 | | |

LOT AREA: 5867 SF
 ALLOWED LOT COVERAGE: 2347 SF = 40.0%
 ACTUAL LOT COVERAGE: 1985 SF = 33.9%
 REAR YARD AREA: 1831 SF
 NUMBER OF BEDROOMS:

It is understood that the drainage areas, slopes and grades shall not be altered, changed, blocked, modified or in any way be reconstructed by Owner contrary to what is depicted on this Plot Plan. THESE CONDITIONS RUN WITH THE LAND AND ARE BINDING ON ALL SUBSEQUENT OWNERS. All setback dimensions and elevations as shown may be adjusted to fit field conditions.

Plot Plan for **Heritage Village 13 at New Traditions** PPA Job #005006
 2412 Autumn Meadow Avenue, Sacramento, CA 95835 **Lot 74**
 APN. 201-0820-074

US Home Corporation - Sacramento Division
 2366 Gold Meadow Way, Suite 200, Gold River, CA 95670 Phone (916) 858-3900 Fax (916) 858-3925

Plot Plan Associates www.plotplans.org Date Drawn: 05/14/03 Scale: 1"=20'
 PO Box 435 Citrus Heights CA 95611-0435 (916) 769-9063 Date Revised: - Drawn By: KLM