

CITY OF SACRAMENTO  
1231 I Street, Sacramento, CA 95814

Permit No: 0611448  
Insp Area: 3  
Thos Bros: 317F1

Site Address: 3562 4TH AV SAC  
Parcel No: 013-0143-004

Sub-Type: REP  
Housing (Y/N): N

**CONTRACTOR**  
JAMESHA MECHANICAL  
8797 WINDING WY  
FAIR OAKS, CA 95628

**OWNER**  
SONG SUKI/SUE YOUNG YI  
PO BOX 5342  
SACRAMENTO, CA 95817

**ARCHITECT**

Nature of Work: REPLACED DUCTLESS A/C SPLIT SYSTEM

**CONSTRUCTION LENDING AGENCY:** I hereby affirm under penalty of perjury that there is a construction lending agency for the performance of the work for which this permit is issued (Sec. 3097, Civ. C).

Lender's Name \_\_\_\_\_ Lender's Address \_\_\_\_\_

**LICENSED CONTRACTORS DECLARATION:** I hereby affirm under penalty of perjury that I am licensed under provisions of Chapter 9 (commencing with section 7000) of Division 3 of the Business and Professions Code and my license is in full force and effect.

X License Class C-10 License Number 751050 Date 7-27-06 Contractor Signature [Signature]

**OWNER-BUILDER DECLARATION:** I hereby affirm under penalty of perjury that I am exempt from the contractors License Law for the following reason (Sec. 7031.5, Business and Professions Code; any city or county which requires a permit to construct, alter, improve, demolish, or repair any structure, prior to its issuance, also requires the applicant for such permit to file a signed statement that he or she is licensed pursuant to the provisions of the Contractors License Law (Chapter 9 (commencing with Section 7000) of Division 8 of the Business and Professions Code) or that he or she is exempt therefrom and the basis for the alleged exemption. Any violation of Section 7031.5 by any applicant for a permit subjects the applicant to a civil penalty of not more than five hundred dollars (\$500.00);

I, as a owner of the property, or my employees with wages as their sole compensation, will do the work, and the structure is not intended or offered for sale (Sec. 7044, Business and Professional Code: The Contractors License Law does not apply to an owner of property who builds or improves thereon, and who does such work himself or herself or through his/her own employees, provided that such improvements are not intended or offered for sale. If, however, the building or improvement is sold within one year of completion, the owner-builder will have the burden of proving that he/she did not build or improve for the purpose of sale.)

I, as owner of the property, am exclusively contracting with licensed contractors to construct the project (Sec. 7044, Business and Professions Code: The Contractors License Law does not apply to an owner of property who builds or improves thereon, and who contracts for such projects with a contractor(s) licensed pursuant to the Contractors License Law).

I am exempt under Sec. \_\_\_\_\_ B & PC for this reason: \_\_\_\_\_

Date \_\_\_\_\_ Owner Signature \_\_\_\_\_

IN ISSUING THIS BUILDING PERMIT, the applicant represents, and the city relies on the representation of the applicant, that the applicant verified all measurements and locations shown on the application or accompanying drawings and that the improvement to be constructed does not violate any law or private agreement relating to permissible or prohibited locations for such improvements. This building permit does not authorize any illegal location of any improvement or the violation of any private agreement relating to location of improvements.

I certify that I have read this application and state that all information is correct. I agree to comply with all city and county ordinances and state laws relating to building construction and hereby authorize representative(s) of this city to enter upon the above mentioned property for inspection purposes.

X Date 7-27-06 Applicant/Agent Signature [Signature]

**WORKER'S COMPENSATION DECLARATION:** I hereby affirm under penalty of perjury one of the following declarations:  
I have and will maintain a certificate of consent to self-insure for workers' compensation as provided for by Section 3700 of the Labor Code, for the performance of work for which the permit is issued.

I have and will maintain workers' compensation insurance, as required by Section 3700 of the Labor Code, for the performance of the work for which this permit is issued. My workers' compensation insurance carrier and policy number are:

Carrier EXEMPT Policy Number \_\_\_\_\_ Exp Date \_\_\_\_\_

(This section need not be completed if the permit is for \$100 or less) I certify that in the performance of the work for which this permit is issued, I shall not employ any person in any manner so as to become subject to the workers' compensation laws of California and agree that if I should become subject to the workers' compensation provisions of Section 3700 of the Labor Code, I shall forthwith comply with those provisions.

X Date 7-27-06 Applicant Signature [Signature]

WARNING: FAILURE TO SECURE WORKER'S COMPENSATION COVERAGE IS UNLAWFUL AND SHALL SUBJECT AN EMPLOYER TO CRIMINAL PENALTIES AND CIVIL FINES UP TO ONE HUNDRED THOUSAND DOLLARS (\$100,000) IN ADDITION TO THE COST OF COMPENSATION, DAMAGES AS PROVIDED FOR IN SECTION 3706 OF THE LABOR CODE, INTEREST AND ATTORNEY'S FEE.

THIS PERMIT SHALL EXPIRE BY LIMITATION IF WORK IS NOT COMMENCED WITHIN 180 DAYS.

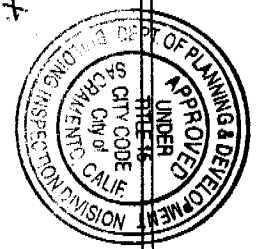
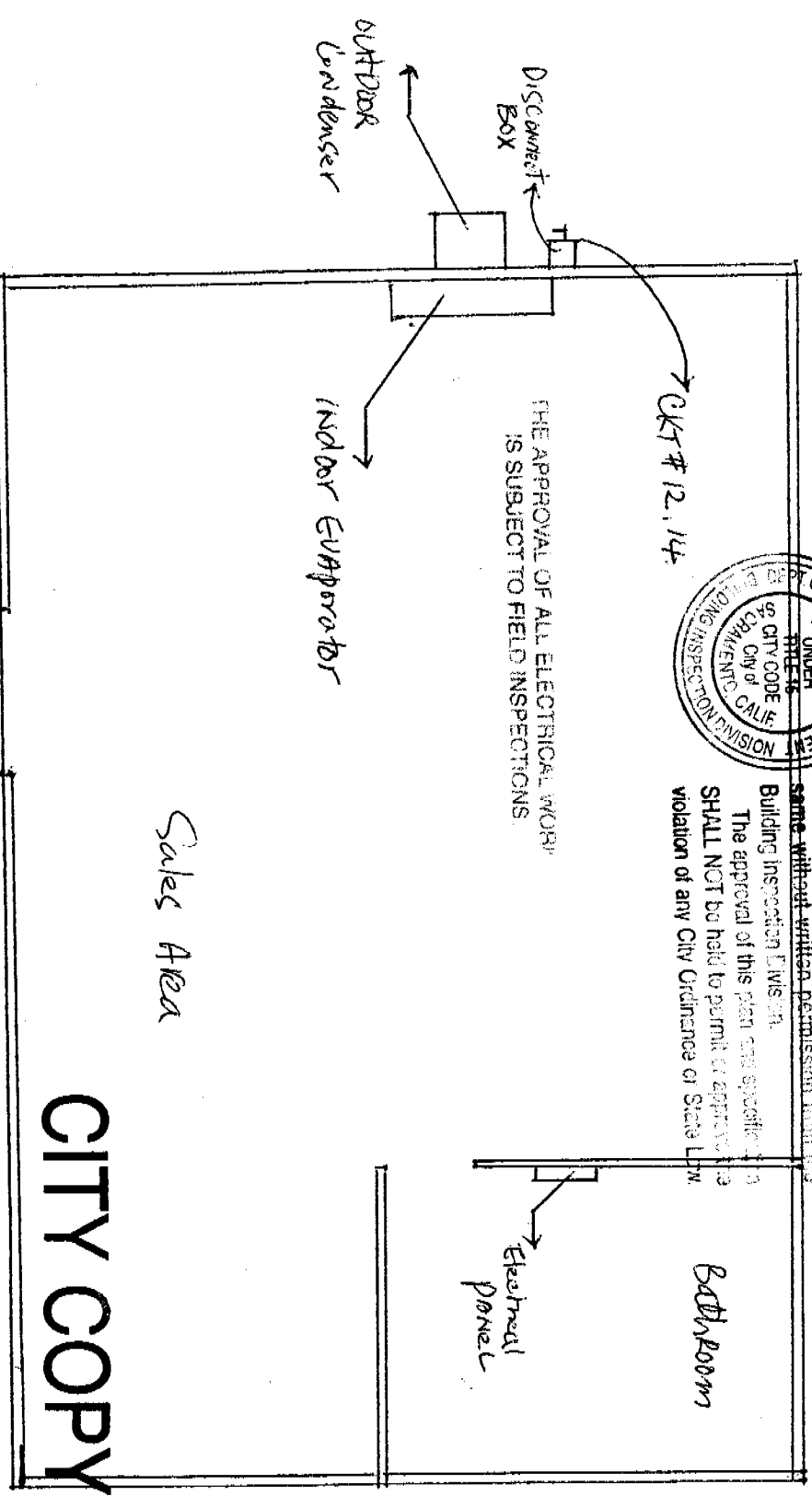

This set of plans and specifications must be kept on the job at all times and it is unlawful to make any changes or alterations from the same without written permission from the Building Inspection Division. The approval of this plan and specification SHALL NOT be held to permit or approve the violation of any City Ordinance or State Law.

**CITY COPY**

3562 4th Av

**ISSUED**  
**CITY OF SACRAMENTO**  
 JUL 25 2006  
**DOWNTOWN PERMIT CENTER**

**APPROVED PER** *[Signature]*  
**NATIONAL ELECTRICAL CODE**  
**AND CITY OF SACRAMENTO**  
**AMENDMENTS**  
 7-27-06  
 ELECTRICAL DIVISION

#0611448

MINI Ductless Split A/C System

MANUFACTURE		TURBO AIR CONDITION	
MODEL	TAS-24 HO	Serial	TA420035
Voltage/FHz	208/230 1PH 60 HZ		
CAPACITY	Cooling 21,500 BTU Heat 22,000 BTU		
Energy efficiency	MIN 10.0 SEER MAX 16.0 SEER		
Compressor	RLA 10.2 A LRA 68.0 A		
FAN Motor	FLA 0.87 A 106 W		
Design pressure	High 300 PSIG Low 150 PSIG		
Refrigerant	R22 64.5 oz		
MCA	14.5 AMPS		
MOP	30.0 AMPS		

THE APPROVAL OF ALL ELECTRICAL WORK IS SUBJECT TO FIELD INSPECTIONS.

copy 7-27-06

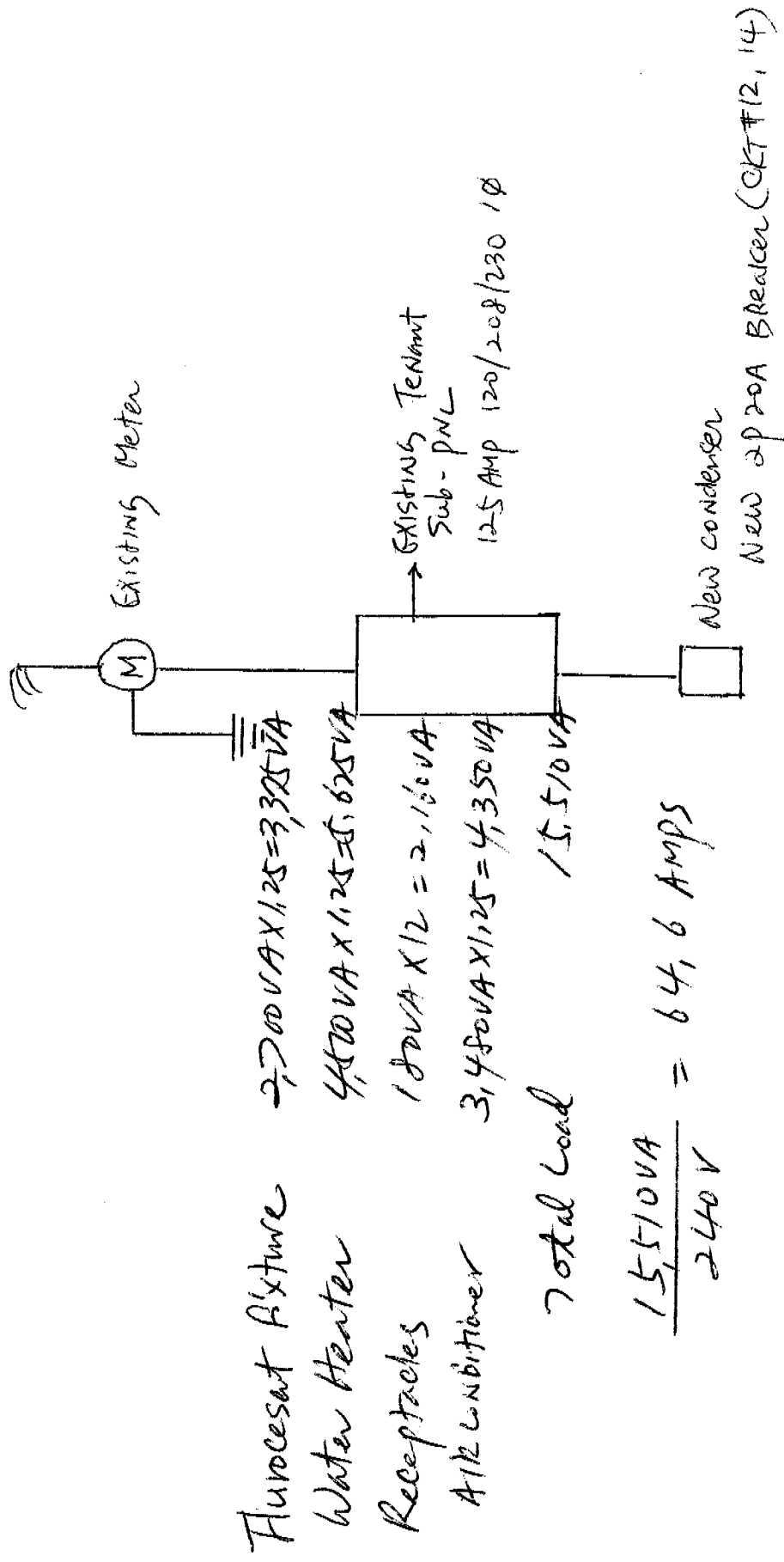

THE APPROVAL OF ALL ELECTRICAL WORK IS SUBJECT TO FIELD INSPECTIONS.

COY 7-27-06

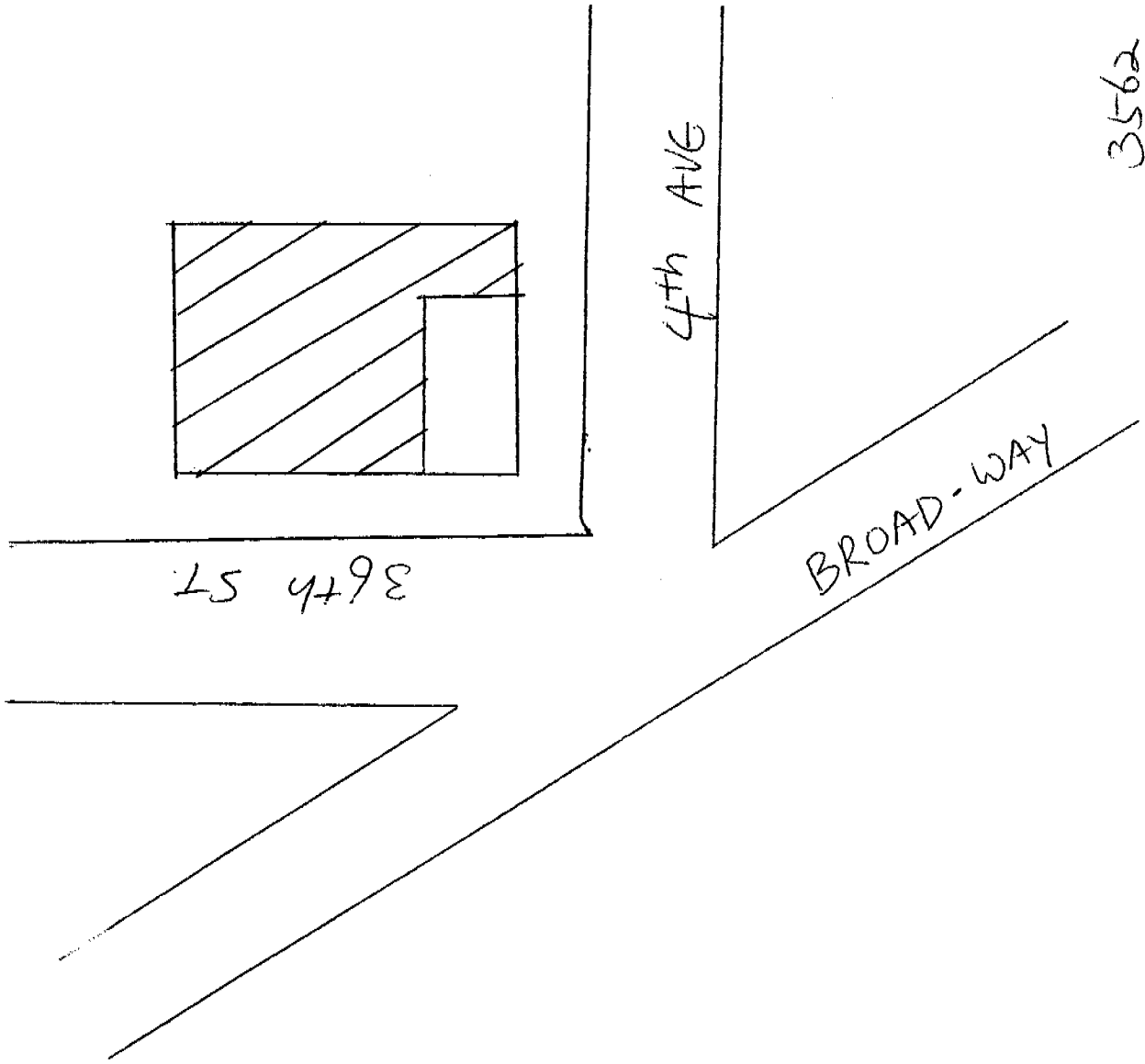

3562 4th AVE  
Sacramento, CA 95817

# APPLICATION FOR COMMERCIAL BUILDING PERMIT

**CITY OF SACRAMENTO**  
 Development Services Department - Building Division

New City Hall  
 915 I Street, 3<sup>rd</sup> floor  
 Sacramento, CA 95834  
 Fax: 916-808-1901

North Permit Center  
 2101 Arena Blvd., Suite 200  
 Sacramento, CA 95834  
 Fax: 916-808-8370

<b>ACTIVITY #</b> <div style="font-size: 24px; text-align: center;">0611448</div>	<b>Insp. Area</b>
--	-------------------

*Applicant MUST complete ALL Unshaded areas*

**ADDRESS** 3562 4<sup>th</sup> ave Sacramento, CA 95817 Suite

**PARCEL #** \_\_\_\_\_

<p style="text-align: center;"><b>CONTACT</b></p> <p>Name <u>James Yi</u></p> <p>Street Address <u>8797 Winding Way</u></p> <p>City/State/Zip <u>Fair Oaks, CA 95628</u></p> <p>Phone <u>916-601-5471</u> FAX _____</p> <p>E-mail: _____</p>	<p style="text-align: center;"><b>LICENSED CONTRACTOR</b> Lic No. # <u>251050</u></p> <p>Name <u>Jamsha mechanical</u></p> <p>Address <u>8797 Winding Way</u></p> <p>City/State/Zip <u>Fair Oaks, CA 95628</u></p> <p>Phone <u>916-863-5135</u> FAX <u>916-863-5893</u></p> <p>E-mail: <u>Jamsha@sbcglobal.net</u></p>
<p style="text-align: center;"><b>ARCHITECT/ENGINEER</b></p> <p>Name _____</p> <p>Address _____</p> <p>City/State/Zip _____</p> <p>Phone _____ FAX _____</p> <p>E-mail: _____</p>	<p style="text-align: center;"><b>OWNER</b></p> <p>Name <u>HORNE Management</u></p> <p>Address <u>6720 Solcom Blvd #207</u></p> <p>City/State/Zip <u>Sacramento, CA 95821</u></p> <p>Phone <u>916-451-0444</u> FAX <u>916-451-0333</u></p> <p>E-mail: _____</p>

→ Will permittee have any employees on the jobsite?  No  Yes → **INSURANCE CO:** \_\_\_\_\_

→ **WORKER'S COMPENSATION POLICY #** \_\_\_\_\_ **EXPIRATION DATE:** \_\_\_\_\_

**NATURE OF WORK IN DETAIL:** install ductless mini split A/C system  
install outdoor condenser & indoor evaporator coil (not on roof)

**OCCUPANT/TENANT:** \_\_\_\_\_ **VALUATION: \$** \_\_\_\_\_

<b>FLOOD STATUS</b>					<b>S.C.A.T.</b>								
JOB DESCRIPTION					BLDG <input type="checkbox"/> SHELL <input type="checkbox"/> APT <input type="checkbox"/> TI ( ) <input type="checkbox"/> REM ( ) <input type="checkbox"/> SW <input type="checkbox"/> FIRE <input type="checkbox"/> ADD <input type="checkbox"/> OTHER <input type="checkbox"/>								
INSPECTION DISCIPLINES		BLDG		MECH		PLUMB		ELEC		SITE		FIRE	
# Stories	1 <sup>st</sup> flr Area	Total Area	Use Zone	Occp Group	Const type	Fire Req. Y / N		Fed Code		Vio. File			
						SPR	ALARM						
B	L	P	M	E	F	S		D		PW	UTIL		

**COMMENTS:**

\_\_\_\_\_

\_\_\_\_\_

\_\_\_\_\_

REGIONAL SANITATION FEES?  Yes  No      HEALTH DEPARTMENT?  Yes  No

WATER FLOW TEST FOR NEW BUILDINGS OR ADDITIONS?  Yes  No