

**CITY OF SACRAMENTO**  
1231 I Street, Sacramento, CA 95814

**Permit No: 0010266**  
**Insp Area: 4**

**Site Address: 2031 FENMORE WY SAC**  
Parcel No: 225-1370-034 NORTHPT PK 7 LOT 34

Sub-Type: NSFR  
Housing (Y/N): N

CONTRACTOR  
JOHN LAING HOMES  
2150 PROFESSIONAL DR. #120  
ROSEVILLE CA. 95661

OWNER

ARCHITECT

**Nature of Work: MP 1906 2 STORY 8 ROOM SFR**

**CONSTRUCTION LENDING AGENCY :** I hereby affirm under penalty of perjury that there is a construction lending agency for the performance of the work for which this permit is issued (Sec. 3097, Civ. C).

Lender's Name \_\_\_\_\_ Lender's Address \_\_\_\_\_

**LICENSED CONTRACTORS DECLARATION:** I hereby affirm under penalty of perjury that I am licensed under provisions of Chapter 9 (commencing with section 7000) of Division 3 of the Business and Professions Code and my license is in full force and effect.

License Class D License Number CS 7596 Date 10/9/00 Contractor Signature N. Collins

**OWNER-BUILDER DECLARATION:** I hereby affirm under penalty of perjury that I am exempt from the contractors License Law for the following reason (Sec. 7031.5, Business and Professions Code; any city or county which requires a permit to construct, alter, improve, demolish, or repair any structure, prior to its issuance, also requires the applicant for such permit to file a signed statement that he or she is licensed pursuant to the provisions of the Contractors License Law (Chapter 9 (commencing with Section 7000) of Division 8 of the Business and Professions Code) or that he or she is exempt therefrom and the basis for the alleged exemption. Any violation of Section 7031.5 by any applicant for a permit subjects the applicant to a civil penalty of not more than five hundred dollars (\$500.00).

\_\_\_\_ I, as a owner of the property, or my employees with wages as their sole compensation, will do the work, and the structure is not intended or offered for sale (Sec. 7044, Business and Professional Code: The Contractors License Law does not apply to an owner of property who builds or improves thereon, and who does such work himself or herself or through his/her own employees, provided that such improvements are not intended or offered for sale. If, however, the building or improvement is sold within one year of completion, the owner-builder will have the burden of proving that he/she did not build or improve for the purpose of sale.)

\_\_\_\_ I, as owner of the property, am exclusively contracting with licensed contractors to construct the project (Sec. 7044, Business and Professions Code: The Contractors License Law does not apply to an owner of property who builds or improves thereon, and who contracts for such projects with a contractor(s) licensed pursuant to the Contractors License Law).

\_\_\_\_ I am exempt under Sec. \_\_\_\_\_ B & PC for this reason: \_\_\_\_\_  
Date \_\_\_\_\_ Owner Signature \_\_\_\_\_

PAYED  
CITY OF SACRAMENTO  
OCT 09 2000  
CITY OF SACRAMENTO  
PLANNING  
& DEVELOPMENT SERVICES

**IN ISSUING THIS BUILDING PERMIT,** the applicant represents, and the city relies on the representation of the applicant, that the applicant verified all measurements and locations shown on the application or accompanying drawings and that the improvements to be constructed does not violate any law or private agreement relating to permissible or prohibited locations for such improvements. This building does not violate any illegal location of any improvement or the violation of any private agreement relating to location of improvements.

I certify that I have read this application and state that all information is correct. I agree to comply with all city and county ordinances and state laws relating to building construction and hereby authorize representative(s) of this city to enter upon the abovementioned property for inspection purposes.

Date 10/9/00 Applicant/Agent Signature N. Collins

**WORKER'S COMPENSATION DECLARATION:** I hereby affirm under penalty of perjury one of the following declarations:

\_\_\_\_ I have and will maintain a certificate of consent to self-insure for workers' compensation as provided for by Section 3700 of the Labor Code, for the performance of work for which the permit is issued.

I have and will maintain workers' compensation insurance, as required by Section 3700 of the Labor Code, for the performance of the work for which this permit is issued. My workers' compensation insurance carrier and policy number are:

Carrier EAGLE PACIFIC INSURANCE COMPAN Policy Number 1S0002200 Exp Date 4/15/2001

\_\_\_\_ (This section need not be completed if the permit is for \$100 or less) I certify that in the performance of the work for which this permit is issued, I shall not employ any person in any manner so as to become subject to the workers' compensation laws of California and agree that if I should become subject to the workers' compensation provisions of Section 3700 of the Labor Code, I shall forthwith comply with those provisions.

Date 10/9/00 Applicant Signature N. Collins

**WARNING: FAILURE TO SECURE WORKER'S COMPENSATION COVERAGE IS UNLAWFUL AND SHALL SUBJECT AN EMPLOYER TO CRIMINAL PENALTIES AND CIVIL FINES UP TO ONE HUNDRED THOUSAND DOLLARS (\$100,000) IN ADDITION TO THE COST OF COMPENSATION, DAMAGES AS PROVIDED FOR IN SECTION 3706 OF THE LABOR CODE, INTEREST AND ATTORNEY'S FEE.**

**THIS PERMIT SHALL EXPIRE BY LIMITATION IF WORK IS NOT COMMENCED WITHIN 180 DAYS.**

Lot # 34

# OMEGA PRODUCTS INTERNATIONAL, INC.

DIAMOND WALL INSULATING STUCCO SYSTEM

JOB ADDRESS:

ICBO Report #4004

THON LAIN'S INSPIRATION  
2031 FENMORE WAY, SACR. CALIF  
95835

Date of Job Completion 8/22/00

PLASTERING CONTRACTOR:

Name: STUCCO WORKS INC

Address: 5900 WAREHOUSE WAY, SACRAMENTO C-9

Telephone No: (916) 383 66 99

Contractor Number of Diamond Wall System 2175

This is to certify that the exterior coating system on the building exterior at the above address has been installed in accordance with the evaluation report specified above and the manufacturer's instructions.

8/25/00  
Date

[Signature]  
Signature of authorized representative of  
Plastering Contractor

This installation card must be presented to the building inspector after completion of work and before final inspection.

**Natomas Unified School District**  
 1515 Sports Drive, #1 • Sacramento, CA 95834-1905  
 Phone 916/641-3300 • Fax 916/928-1629

**CERTIFICATION OF COMPLIANCE**  
**SCHOOL DISTRICT DEVELOPMENT FEES**

| <b>PART I: TO BE COMPLETED BY APPLICANT</b>  |   |                       |                     |
|--|---|-----------------------|---------------------|
| Property Owner's Name  | John Lang Homes   | (916) 780-1222        |                     |
| Owner's Address  | 1536 Eureka Road, Suite #100, Roseville, Ca 95661   |                       |                     |
| Project Address  | 2031 Fenmore Way  |                       |                     |
| Parcel Number  | 225-1370-034  | Lot                   | 34                  |
| Subdivision Name   | Northpointe Park Unit # 1 A   |                       |                     |
| Number of Units  | 1   |                       |                     |
| Print Applicant's Name   | Deanna Collins  | Applicant's Signature | <i>[Signature]</i>  |
| Title of Applicant   | Operations  | Telephone Number      | 991-1200            |
| Date   | 9/2/2000  |                       |                     |
| <b>PART II: TO BE COMPLETED BY BUILDING DEPARTMENT</b>   |   |                       |                     |
| Plan Identification Number   | 1906  |                       |                     |
| Building Type (Check One)  | <input checked="" type="checkbox"/> Residential <input type="checkbox"/> Apartment/Condominium <input type="checkbox"/> Commercial/Industrial |                       |                     |
| Square Feet of Chargeable Building Area  | 1906  |                       |                     |
| Signature  | <i>[Signature]</i>  |                       | Date                |
| Title  | Blg Insp  |                       |                     |
| <b>PART III: TO BE COMPLETED BY NATOMAS UNIFIED SCHOOL DISTRICT</b>  |   |                       |                     |
| District Certification Number  | 1-0116  |                       |                     |
| Fees Collected:  |   |                       |                     |
| Residential:   | Sq. Ft. X \$  | = \$                  | 6,194.50            |
| Apartment/Condominium:   | Sq. Ft. X \$  | = \$                  |                     |
| Commercial/Industrial:   | Sq. Ft. X \$  | = \$                  |                     |
| <b>NOTICE TO APPLICANT:</b> Pursuant to government code section 66020 (d), this will serve to notify you that the 90-day approval period in which you may protest the fees, or other payment identified above, will begin to run on the date in which the building or installation permit for this project is issued, or on which they are paid to the District, or to another public entity authorized to collect them on behalf of the District, whichever is earlier. |   |                       |                     |
| Applicant Signature:   | <i>[Signature]</i>  |                       | Date: <i>[Date]</i> |

This certification covers only the amount of square footage indicated above. Any additions or corrections to the square footage for this project will require an amendment to the Certificate of Compliance.

As the authorize Natomas Unified School District official, I hereby certify that the requirements of Government Code Section 95995 have been complied with by the above signed applicant.

SIGNATURE: \_\_\_\_\_ DATE: \_\_\_\_\_  
 TITLE: \_\_\_\_\_

**RESIDENTIAL BUILDING PERMIT APPLICATION**

New Construction       Addition       Remodels       Other

Project Address: 2031 Fenmore Ave      Assessor Parcel # 225-~~18~~-03A <sup>1370</sup>

OWNER INFORMATION: Lot 34

Legal Property Owner: John Laing Homes      Phone # 780-1222  
 Owner Address: 1536 Eureka Rd. #100,      City Roseville,      State Ca.      Zip 95661

CONTRACTOR INFORMATION: Northpointe Park Unit #7-A

Contractor: John Laing Homes Lic. # 687596      Phone # 780-1222      Fax# 780-1333

**PROJECT INFORMATION:**

Land Use Zone \_\_\_\_\_      Occupancy Group \_\_\_\_\_      Construction Type VN      Fed Code A1  
 No. of stories: 2      No. of rooms: 8      Street width: \_\_\_\_\_  
 1<sup>st</sup> Floor Area 1038      2<sup>nd</sup> Floor Area 868      Basement \_\_\_\_\_      Roof Material \_\_\_\_\_

| AREA IN SQUARE FOOT OF: | EXISTING | NEW         |
|-------------------------|----------|-------------|
| Dwelling/Living         | _____    | <u>1906</u> |
| Garage/Storage          | _____    | <u>428</u>  |
| Decks/Balconies         | _____    | <u>117</u>  |
| Carports                | _____    | _____       |

SCOPE OF WORK: \_\_\_\_\_

**FOR OFFICE USE ONLY**

- |   |   |  |
|---|---|--|
| <input type="checkbox"/> Information above complete | <input type="checkbox"/> AR Flood Waiver required             | <input type="checkbox"/> Planning Approval                   |
| <input type="checkbox"/> Violation files checked    | <input type="checkbox"/> Flood Elevation Certificate Required | <input type="checkbox"/> Design Review Approval              |
| <input type="checkbox"/> Standard setbacks          | <input type="checkbox"/> Water Development Infill Area        | <input type="checkbox"/> Special Fee Districts Apply : _____ |
| <input type="checkbox"/> County Sewer               |   |  |

**- NEW STRUCTURES & ADDITIONS**

❖ THE FOLLOWING MUST BE PROVIDED IN ORDER TO SUBMIT FOR PLAN REVIEW

- |   |   |
|---|---|
| <input type="checkbox"/> 2 COMPLETE PLANS, LEGIBLE & DRAWN TO SCALE   | ❖ Plans to include: site plan, floor plan, elevations, roof/ceiling plan, foundation and structural framing details, and structural calculations for non-conforming structures. |
| <input type="checkbox"/> 3 SETS IF PROJECT IS IN A DESIGN REVIEW AREA |   |
| <input type="checkbox"/> Title 24 Energy Compliance documentation     | <input type="checkbox"/> 11" x 17" copy of floor plan for County Assessor   |
| <input type="checkbox"/> Grading and Erosion Control Questionnaire    | <input type="checkbox"/> Plan Review Fees   |

Date: \_\_\_\_\_      Received by: (staff) \_\_\_\_\_

**ACTIVITY/PERMIT #**

residentialapp [rev 3/09/99]

INSULATION CERTIFICATE

THIS IS TO CERTIFY THAT INSULATION HAS BEEN INSTALLED IN CONFORMANCE WITH THE CURRENT ENERGY REGULATIONS, CALIFORNIA ADMINISTRATION CODE, TITLE 24, STATE OF CALIFORNIA, IN THE BUILDING LOCATED AT:

SITE ADDRESS: lot 34 Inspiration @ Natomas Park Natomas, CA  
NUMBER STREET CITY STATE  
2031 FENMORE WAY SACRAMENTO CALIFORNIA 95835

CEILINGS:

BLOW: Manufacturer Everestone Thickness 8 1/2" R/Value 30

Square Feet 568 # Bags/Lbs. per bags 17

BATTS: Manufacturer Johns Manville Thickness 10 2 1/2" R/Value 30

EXTERIOR WALLS:

Manufacturer Johns Manville Thickness 3 1/2" R/Value 13

FLOOR INSULATION:

Manufacturer Johns Manville Thickness 3 1/2" R/Value 13

AIR INFILTRATION: (TITLE 24)

Yes ~~XXXX~~ No \_\_\_\_\_

OTHER: \_\_\_\_\_

GENERAL CONTRACTOR: John Laing Homes LIC. # \_\_\_\_\_

BY: Carl & Mia TITLE Superintendent DATE 5-14-01

INSULATION CONTRACTOR: Western Insulation, Inc. LIC. # 481278

BY: James Blair TITLE Auth. Agent DATE 8/17/00

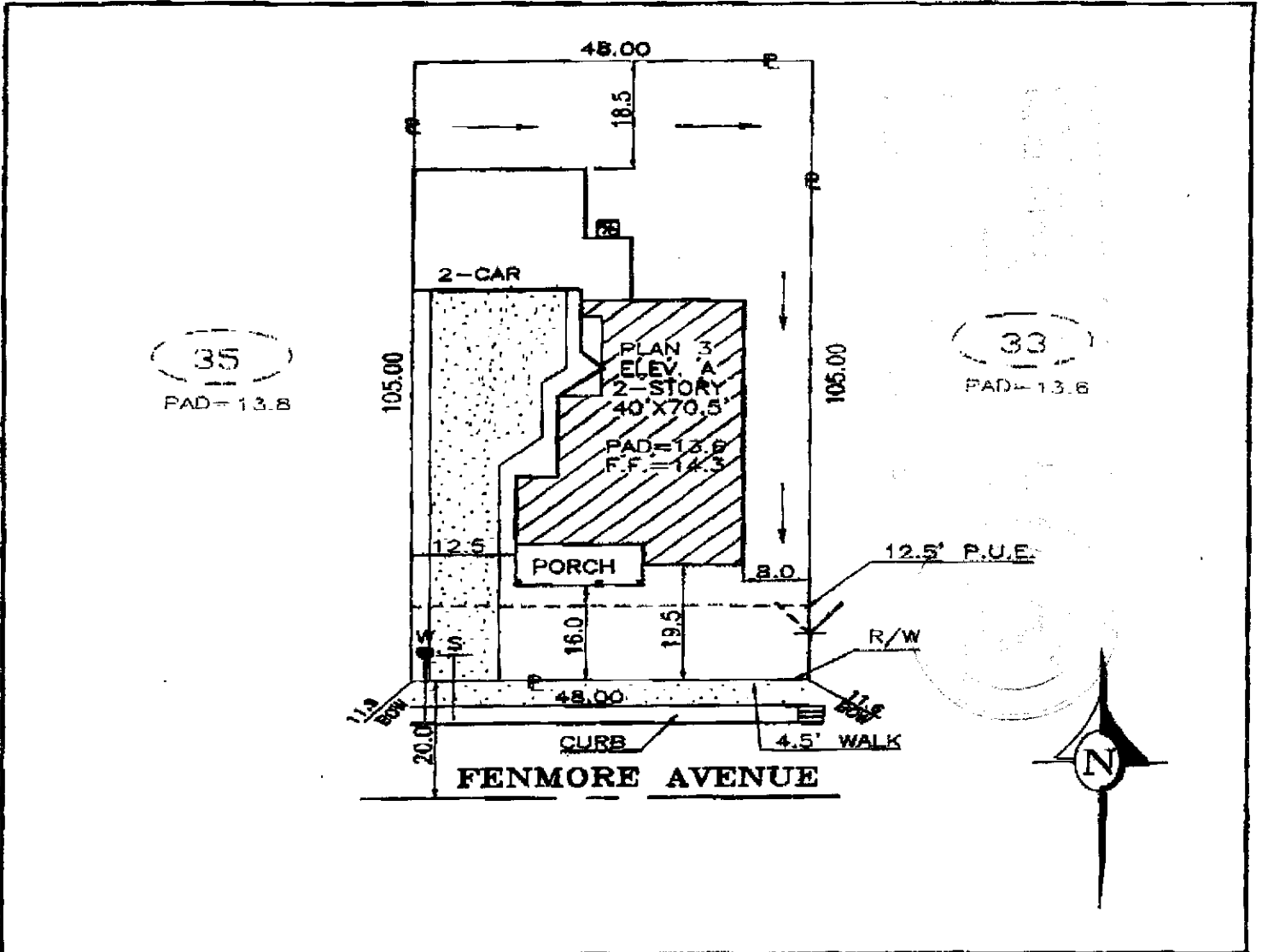

DIMENSIONS SHOWN ARE APPROXIMATE EXCEPT FOR MINIMUMS REQUIRED BY ORDINANCE. THIS PLOT DOES NOT REFLECT AS BUILT CONDITIONS AND MAY VARY FROM THIS PLAN.

|   |  |  |  |  |               |
|---|--|--|--|--|---------------|
| <b>John Laing Homes</b><br>1886 EUREKA ROAD SUITE 100<br>ROSEVILLE, CALIFORNIA 95661<br>(TEL.) 916-780-1222 (FAX.) 916-780-1333 |  | <b>INSPIRATION</b>   |  | <b>PLOT PLAN</b>                                 |               |
|   |  | NORTHPOINTE PARK UNIT 7A<br>CITY OF SACRAMENTO<br>CALIFORNIA |  | NOTES:<br>CURVED LINES ARE<br>CHORD MEASUREMENTS |               |
| ADDRESS: FENMORE AVENUE   |  | LOT COV: 29.7 %  |  | APN:   |               |
| PLAN NO.: 3-A   |  | LOT SQ. FT.: 5,040   |  | REAR YARD COVERAGE: %                            |               |
| DRAWN BY: R.P.  |  | APPROVED BY:   |  | DATE: 8/11/00 SCALE: 1"=20'                      |               |
|   |  |  |  |  | <b>LOT 34</b> |

*R.P.*