

CITY OF SACRAMENTO
1231 I Street, Sacramento, CA 95814

Permit No: 0007070
Insp Area: 4

Site Address: 15 HORNBILL CT SAC
Parcel No: 225-1210-063 LOT 66 GATEWY N 2

Sub-Type: NSFR
Housing (Y/N): N

CONTRACTOR
MARCHBROOK BUILDING CO
PO BOX 7576
STOCKTON CA 95267

OWNER

ARCHITECT

Nature of Work: NSFR MP2236 1 STORY 9 RMS

CONSTRUCTION LENDING AGENCY : I hereby affirm under penalty of perjury that there is a construction lending agency for the performance of the work for which this permit is issued (Sec. 3097, Civ. C).

Lender's Name _____ Lender's Address _____

LICENSED CONTRACTORS DECLARATION: I hereby affirm under penalty of perjury that I am licensed under provisions of Chapter 9 (commencing with section 7000) of Division 3 of the Business and Professions Code and my license is in full force and effect.

License Class B License Number 740353 Date 2/12/00 Contractor Signature Paul B...

OWNER-BUILDER DECLARATION: I hereby affirm under penalty of perjury that I am exempt from the contractors License Law for the following reason (Sec. 7031.5, Business and Professions Code: any city or county which requires a permit to construct, alter, improve, demolish, or repair any structure, prior to its issuance, also requires the applicant for such permit to file a signed statement that he or she is licensed pursuant to the provisions of the Contractors License Law (Chapter 9 (commencing with Section 7000) of Division 8 of the Business and Professions Code) or that he or she is exempt therefrom and the basis for the alleged exemption. Any violation of Section 7031.5 by any applicant for a permit subjects the applicant to a civil penalty of not more than five hundred dollars (\$500.00).

____ I, as a owner of the property, or my employees with wages as their sole compensation, will do the work, and the structure is not intended or offered for sale (Sec. 7044, Business and Professional Code: The Contractors License Law does not apply to an owner of property who builds or improves thereon, and who does such work himself or herself or through his/her own employees, provided that such improvements are not intended or offered for sale. If, however, the building or improvement is sold within one year of completion, the owner-builder will have the burden of proving that he/she did not build or improve for the purpose of sale.)

____ I, as owner of the property, am exclusively contracting with licensed contractors to construct the project (Sec. 7044, Business and Professions Code: The Contractors License Law does not apply to an owner of property who builds or improves thereon, and who contracts for such projects with a contractor(s) licensed pursuant to the Contractors License Law).

____ I am exempt under Sec. _____ B & PC for this reason: _____

Date _____ Owner Signature _____

IN ISSUING THIS BUILDING PERMIT, the applicant represents, and the city relies on the representation of the applicant, that the applicant verified all measurements and locations shown on the application or accompanying drawings and that the improvement to be constructed does not violate any law or private agreement relating to permissible or prohibited locations for such improvements. This building permit does not authorize any illegal location of any improvement or the violation of any private agreement relating to location of improvements.

I certify that I have read this application and state that all information is correct. I agree to comply with all city and county ordinances and state laws relating to building construction and hereby authorize representative(s) of this city to enter upon the abovementioned property for inspection purposes.

Date 2/12/00 Applicant/Agent Signature Paul B...

WORKER'S COMPENSATION DECLARATION: I hereby affirm under penalty of perjury one of the following declarations:

____ I have and will maintain a certificate of consent to self-insure for workers' compensation as provided for by Section 3700 of the Labor Code, for the performance of work for which the permit is issued.

to I have and will maintain workers' compensation insurance, as required by Section 3700 of the Labor Code, for the performance of the work for which this permit is issued. My workers' compensation insurance carrier and policy number are:

Carrier SAFECO INSURANCE CO OF AMERICA Policy Number WC2342690B

CITY OF SACRAMENTO
FEB 12 2000
NEIGHBORHOODS, PLANNING AND DEVELOPMENT SERVICES

____ (This section need not be completed if the permit is for \$100 or less) I certify that in the performance of the work for which this permit is issued, I shall not employ any person in any manner so as to become subject to the workers' compensation laws of California and agree that if I should become subject to the workers' compensation provisions of Section 3700 of the Labor Code, I shall forthwith comply with those provisions.

Date 2/12/00 Applicant Signature Paul B...

WARNING: FAILURE TO SECURE WORKER'S COMPENSATION COVERAGE IS UNLAWFUL AND SHALL SUBJECT AN EMPLOYER TO CRIMINAL PENALTIES AND CIVIL FINES UP TO ONE HUNDRED THOUSAND DOLLARS (\$100,000) IN ADDITION TO THE COST OF COMPENSATION, DAMAGES AS PROVIDED FOR IN SECTION 3706 OF THE LABOR CODE, INTEREST AND ATTORNEY'S FEE.

THIS PERMIT SHALL EXPIRE BY LIMITATION IF WORK IS NOT COMMENCED WITHIN 180 DAYS.

RESIDENTIAL BUILDING PERMIT APPLICATION

New Construction Addition Remodels Other

Project Address: 15 Hornbill Court Assessor Parcel # 225-1210-063

OWNER INFORMATION: Lot 66-MPD234

Legal Property Owner: Sundance Lake LLC, A Delaware Limited Liability Co. Phone # (209)473-6000
 Owner Address: P.O. Box 7576 City Stockton State CA Zip 95267

CONTRACTOR INFORMATION:

Contractor: Marchbrook Building Co Lic. # 740353 Phone # (209)473-6000 Fax # (209)473-6044

PROJECT INFORMATION:

Land Use Zone _____ Occupancy Group _____ Construction Type _____ Fed Code _____
 No. of stories: 1 No. of rooms: 8 Street width: _____
 1st Floor Area 2251 2nd Floor Area _____ Basement _____ Roof Material _____

AREA IN SQUARE FOOT OF:	EXISTING	NEW
Dwelling/Living	<u>2251</u>	_____
Garage/Storage	<u>595</u>	_____
Deck Balconies	<u>146</u>	_____
Carports	<u>N/A</u>	_____

SCOPE OF WORK: SFD

FOR OFFICE USE ONLY

- | | | |
|---|---|--|
| <input type="checkbox"/> Information above complete | <input type="checkbox"/> AR Flood Waiver required | <input type="checkbox"/> Planning Approval |
| <input type="checkbox"/> Violation files checked | <input type="checkbox"/> Flood Elevation Certificate Required | <input type="checkbox"/> Design Review Approval |
| <input type="checkbox"/> Standard setbacks | <input type="checkbox"/> Water Development Infill Area | <input type="checkbox"/> Special Fee Districts Apply : _____ |
| <input type="checkbox"/> County Sewer | | |

NEW STRUCTURES & ADDITIONS

❖ THE FOLLOWING MUST BE PROVIDED IN ORDER TO SUBMIT FOR PLAN REVIEW

- | | |
|---|---|
| <input type="checkbox"/> 2 COMPLETE PLANS, LEGIBLE & DRAWN TO SCALE | ❖ Plans to include: site plan, floor plan, elevations, roof/ceiling plan, foundation and structural framing details, and structural calculations for non-conforming structures. |
| <input type="checkbox"/> 3 SETS IF PROJECT IS IN A DESIGN REVIEW AREA | |
| <input type="checkbox"/> Title 24 Energy Compliance documentation | <input type="checkbox"/> 11" x 17" copy of floor plan for County Assessor |
| <input type="checkbox"/> Grading and Erosion Control Questionnaire | <input type="checkbox"/> Plan Review Fees |

Date: _____ Received by: (staff) _____

ACTIVITY/PERMIT # _____

INSULATION
CERTIFICATE

WES PAC INSULATION, ~~INC.~~

THIS IS TO CERTIFY THAT INSULATION HAS BEEN INSTALLED IN CONFORMANCE WITH
CURRENT ENERGY REGULATIONS, CALIFORNIA ADMINISTRATIVE CODE, TITLE 24, STATE OF
CALIFORNIA, IN THE BUILDING LOCATED AT:

Sundance Lake LOT # 66 ^{Plan} 2 ~~TRACT #~~

STREET _____

CITY Sacramento

EXTERIOR WALLS:

MANUFACTURER JM THICKNESS/TYPE 3 1/2 R-VALUE 13

CEILINGS:

BATTS:
MANUFACTURER JM THICKNESS/TYPE 12 R-VALUE 38

BLOWN IN:

MANUFACTURER Greenfiber THICKNESS/TYPE 10.3 R-VALUE 38

SQUARE FOOTAGE COVERED 1840 NUMBER OF BAGS USED 27

FLOORS:

MANUFACTURER _____ THICKNESS/TYPE _____ R-VALUE _____

SLAB ON GRADE:

MANUFACTURER _____ THICKNESS/TYPE _____ R-VALUE _____

WIDTH OF INSULATION _____ INCHES

FOUNDATION WALLS:

MANUFACTURER _____ THICKNESS/TYPE _____ R-VALUE _____

GENERAL CONTRACTOR _____

CALIFORNIA CONTRACTORS LICENSE # _____

DATE _____

SIGNATURE _____

TITLE _____

INSULATION CONTRACTOR WES PAC INSULATION, ~~INC.~~

CALIFORNIA CONTRACTORS LICENSE # _____

#487478

DATE _____

Robert Brown

SIGNATURE

Offie Ost

TITLE



Waleed Mari & Associates
Structural Engineers
1020 18th Street, Suite 24
Modesto, CA 95354
209-521-8786
209-521-3079 Fax

Gateway West
March Brook.

Sheet No.: FX1
Job No.:
Date: 9/00 By:

Plan # 2

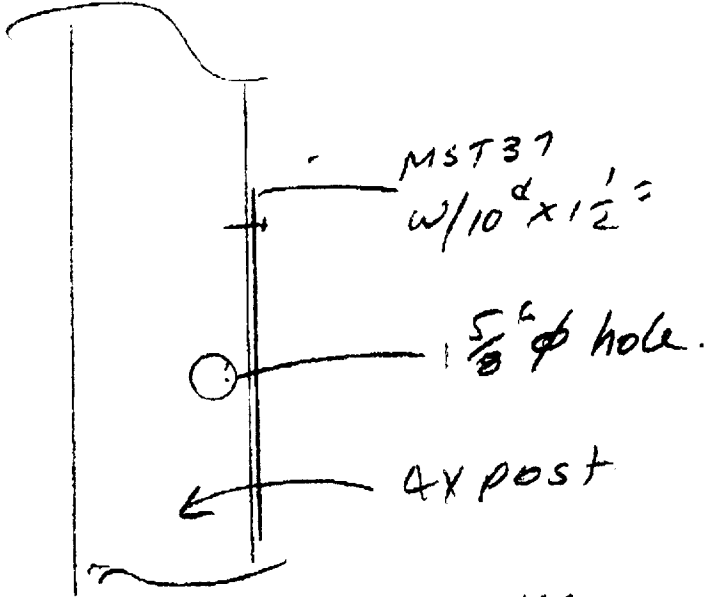

Use
C16x26 @ Notched
2x stud.

Notched stud/post

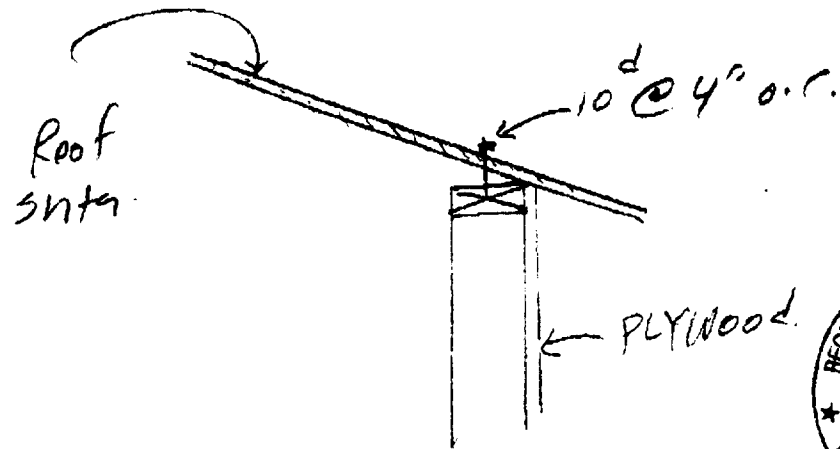

Plan # 2 @ front wall



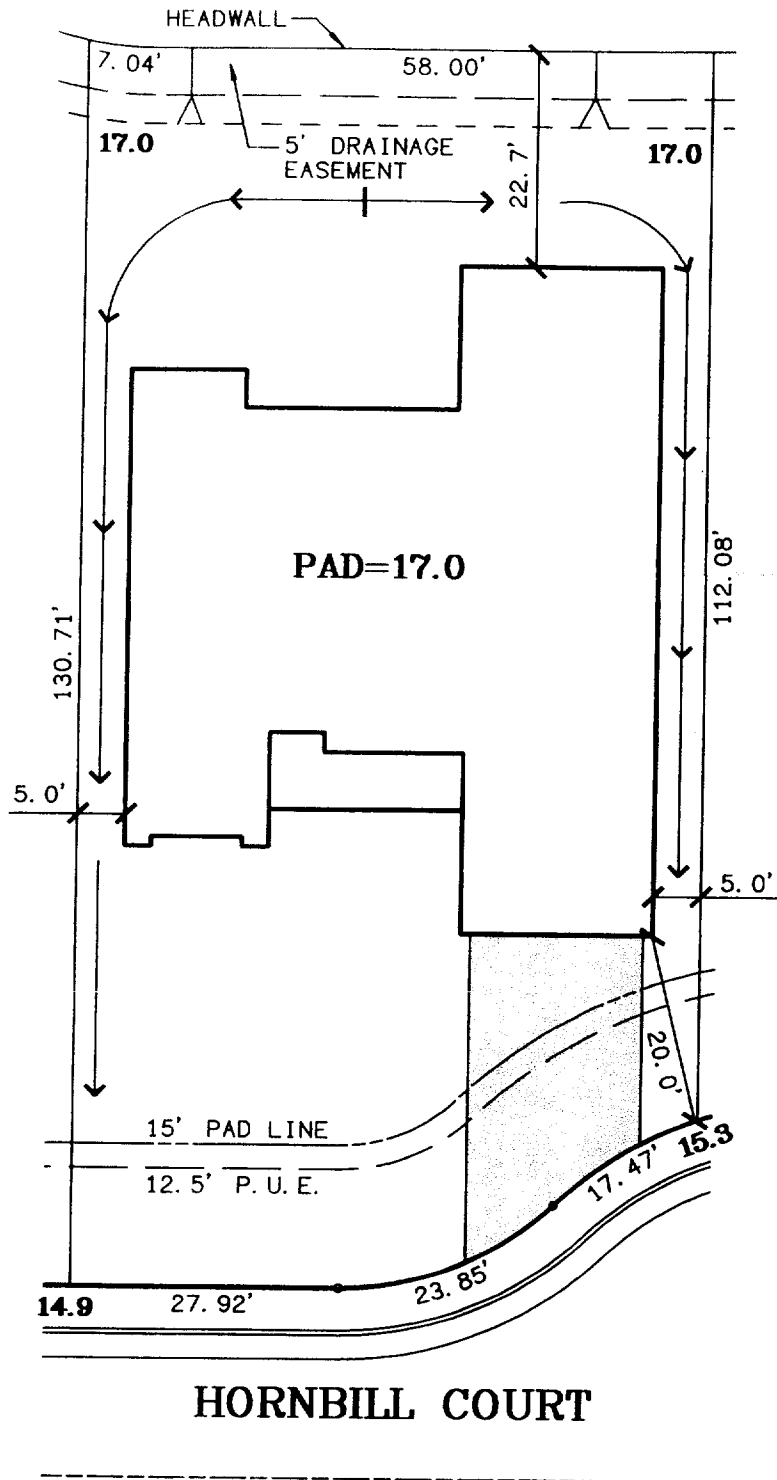

LOT 66
 PLAN 2B RIGHT
 A.P.N.:
 ADDRESS: HORNBILL COURT
 LOT AREA: 8,179 SF
 LOT COVERAGE: 37%

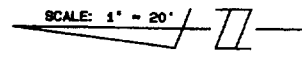

<p>The Splink Corporation 2590 VENTURE OAKS WAY SACRAMENTO, CA. 95833 PH:(916)925-5550 FAX:(916)921-9274</p>	<p>MARCHBROOK BUILDING COMPANY P.O. Box 7578 Stockton, Ca 95267 office: (209) 473-6053 fax: (209) 951-0884</p>	<p>GATEWAY NORTH VILLAGE 2 City of Sacramento, California Scale: 1"=20' June 14, 2000</p>
--	---	---