

CITY OF SACRAMENTO  
1231 I Street, Sacramento, CA 95814

Permit No: 0315734  
Insp Area: 4  
Thos Bros:  
Sub-Type: NSFR  
Housing (Y/N):

Site Address: 380 REGENCY PARK CR SAC

Parcel No: 201-0780-044

NORTHPOINTE PARK VIL.30A LOT 70

N

CONTRACTOR

FORECAST HOMES  
1796 TRIBUTE RD. STE 100, SAC. CAL.  
95815

OWNER

ARCHITECT

Nature of Work: SFR MP 1927 1 STORY 7 ROOM

**CONSTRUCTION LENDING AGENCY :** I hereby affirm under penalty of perjury that there is a construction lending agency for the performance of the work for which this permit is issued (Sec. 3097, Civ. C).

Lender's Name \_\_\_\_\_ Lender's Address \_\_\_\_\_

**LICENSED CONTRACTORS DECLARATION:** I hereby affirm under penalty of perjury that I am licensed under provisions of Chapter 9 (commencing with section 7000) of Division 3 of the Business and Professions Code and my license is in full force and effect.

License Class B License Number 685513 Date \_\_\_\_\_ Contractor Signature [Signature]

**OWNER-BUILDER DECLARATION:** I hereby affirm under penalty of perjury that I am exempt from the contractors License Law for the following reason (Sec. 7031.5, Business and Professions Code; any city or county which requires a permit to construct, alter, improve, demolish, or repair any structure, prior to its issuance, also requires the applicant for such permit to file a signed statement that he or she is licensed pursuant to the provisions of the Contractors License Law (Chapter 9 (commencing with Section 7000) of Division 8 of the Business and Professions Code) or that he or she is exempt therefrom and the basis for the alleged exemption. Any violation of Section 7031.5 by any applicant for a permit subjects the applicant to a civil penalty of not more than five hundred dollars (\$500.00);

\_\_\_\_ I, as a owner of the property, or my employees with wages as their sole compensation, will do the work, and the structure is not intended or offered for sale (Sec. 7044, Business and Professional Code: The Contractors License Law does not apply to an owner of property who builds or improves thereon, and who does such work himself or herself or through his/her own employees, provided that such improvements are not intended or offered for sale. If, however, the building or improvement is sold within one year of completion, the owner-builder will have the burden of proving that he/she did not build or improve for the purpose of sale.)

\_\_\_\_ I, as owner of the property, am exclusively contracting with licensed contractors to construct the project (Sec. 7044, Business and Professions Code: The Contractors License Law does not apply to an owner of property who builds or improves thereon, and who contracts for such projects with a contractor(s) licensed pursuant to the Contractors License Law).

\_\_\_\_ I am exempt under Sec. \_\_\_\_\_ B & PC for this reason: \_\_\_\_\_  
Date \_\_\_\_\_ Owner Signature \_\_\_\_\_

PAID  
CITY OF SACRAMENTO  
NOV 06 2003

**IN ISSUING THIS BUILDING PERMIT,** the applicant represents, and the city relies on the representation of the applicant, that the applicant verified all measurements and locations shown on the application or accompanying drawings and that the improvement to be constructed does not violate any law or private agreement relating to permissible or prohibited locations for such improvements. This building permit does not authorize any illegal location of any improvement or the violation of any private agreement relating to location of improvements.

I certify that I have read this application and state that all information is correct. I agree to comply with all city and county ordinances and state laws relating to building construction and hereby authorize representative(s) of this city to enter upon the abovementioned property for inspection purposes.

Date 11-06-07 Applicant/Agent Signature [Signature]

**WORKER'S COMPENSATION DECLARATION:** I hereby affirm under penalty of perjury one of the following declarations:

\_\_\_\_ I have and will maintain a certificate of consent to self-insure for workers' compensation as provided for by Section 3700 of the Labor Code, for the performance of work for which the permit is issued.

I have and will maintain workers' compensation insurance, as required by Section 3700 of the Labor Code, for the performance of the work for which this permit is issued. My workers' compensation insurance carrier and policy number are:

Carrier STATE FUND Policy Number 1659383 Exp Date 01/10/2004

\_\_\_\_ (This section need not be completed if the permit is for \$100 or less) I certify that in the performance of the work for which this permit is issued, I shall not employ any person in any manner so as to become subject to the workers' compensation laws of California and agree that if I should become subject to the workers' compensation provisions of Section 3700 of the Labor Code, I shall forthwith comply with those provisions.

Date 11-06-07 Applicant Signature [Signature]

WARNING: FAILURE TO SECURE WORKER'S COMPENSATION COVERAGE IS UNLAWFUL AND SHALL SUBJECT AN EMPLOYER TO CRIMINAL PENALTIES AND CIVIL FINES UP TO ONE HUNDRED THOUSAND DOLLARS (\$100,000) IN ADDITION TO THE COST OF COMPENSATION, DAMAGES AS PROVIDED FOR IN SECTION 3706 OF THE LABOR CODE, INTEREST AND ATTORNEY'S FEE.

**THIS PERMIT SHALL EXPIRE BY LIMITATION IF WORK IS NOT COMMENCED WITHIN 180 DAYS.**

RESIDENTIAL BUILDING PERMIT APPLICATION

New Construction

Addition

Remodels

Other **LOT#70**

Project Address: 380 REGENCY PARK CIR

Assessor Parcel # 201-0780-044

OWNER INFORMATION:

NORTHPOINTE PARK VILLAGE 30A

Legal Property Owner Forecast Homes Phone # (916) 920-0200  
 Owner Address: 1796 Tribute Rd. #100 City Sacramento State CA Zip 95815

CONTRACTOR INFORMATION:

Contractor: Forecast Homes Lic. # 606862 Phone # 920-0200 Fax# 920-0379

PROJECT INFORMATION:

Land Use Zone R/A Occupancy Group RS Construction Type 1/1 Fed Code 1A

No. of stories: ONE No. of rooms: 7 Street width: 40'

1<sup>st</sup> Floor Area 1927 2<sup>nd</sup> Floor Area 0 Basement N/A Roof Material TILE

AREA IN SQUARE FOOT OF:	EXISTING	NEW
Dwelling/Living	_____	<u>1927</u>
Garage/Storage	_____	<u>420</u>
Decks/Balconies	_____	_____
Carports	_____	_____

SCOPE OF WORK: New SFD

M.P.#493A

FOR OFFICE USE ONLY

- |   |   |  |
|---|---|--|
| <input type="checkbox"/> Information above complete | <input type="checkbox"/> AR Flood Waiver required             | <input type="checkbox"/> Planning Approval           |
| <input type="checkbox"/> Violation files checked    | <input type="checkbox"/> Flood Elevation Certificate Required | <input type="checkbox"/> Design Review Approval      |
| <input type="checkbox"/> Standard setbacks          | <input type="checkbox"/> Water Development Infill Area        | <input type="checkbox"/> Special Fee Districts Apply |
| <input type="checkbox"/> County Sewer               |   |  |

NEW STRUCTURES & ADDITIONS

\*THE FOLLOWING MUST BE PROVIDED IN ORDER TO SUBMIT FOR PLAN REVIEW

- |   |   |
|---|---|
| <input type="checkbox"/> 2 COMPLETE PLANS, LEGIBLE & DRAWN TO SCALE   | * Plans to include: site plan, floor plan, elevations, roof/ceiling plan, foundation and structural framing details, and structural calculations for non-conforming structures. |
| <input type="checkbox"/> 3 SETS IF PROJECT IS IN A DESIGN REVIEW AREA |   |
| <input type="checkbox"/> Title 24 Energy Compliance documentation     | <input type="checkbox"/> 11" x 17" copy of floor plan for County Assessor   |
| <input type="checkbox"/> Grading and Erosion Control Questionnaire    | <input type="checkbox"/> Plan Review Fees   |

Date: \_\_\_\_\_

Received by: (staff) \_\_\_\_\_

ACTIVITY/PERMIT # \_\_\_\_\_



**INSULATION CONTRACTORS ASSOCIATION OF AMERICA**

INSULATION CENTER/CITY  
**49234**

1321 DUKE STREET, SUITE 303 • ALEXANDRIA, VA 22314 • (703) 739-0356

THIS IS TO CERTIFY THAT INSULATION HAS BEEN INSTALLED IN CONFORMANCE WITH CURRENT ENERGY REGULATIONS, CALIFORNIA ADMINISTRATIVE CODE, TITLE 24, STATE OF CALIFORNIA, IN THE BUILDING LOCATED AT:

Forecmt  
380 Regency Park Cir LOT # 3070 TRACT # Carmel Bay  
STREET CITY SACRAMENTO

EXTERIOR WALLS:  
MANUFACTURER FG THICKNESS/TYPE 3/16 R- VALUE 13

CEILING:  
BATT: FG THICKNESS/TYPE 1/2 R- VALUE 30  
MANUFACTURER THICKNESS/TYPE 1/2 R- VALUE 30

BLOWN IN: Insulated THICKNESS/TYPE 1/2 R- VALUE 30  
MANUFACTURER THICKNESS/TYPE 1/2 R- VALUE 30

SQUARE FOOTAGE COVERED 1776 NUMBER OF BAGS USED 32

FLOORS:  
MANUFACTURER THICKNESS/TYPE R- VALUE  
SLAB ON GRADE THICKNESS/TYPE R- VALUE  
MANUFACTURER THICKNESS/TYPE R- VALUE

WIDTH OF INSULATION INCHES  
FOUNDATION WALLS: THICKNESS/TYPE R- VALUE  
MANUFACTURER THICKNESS/TYPE R- VALUE

GENERAL CONTRACTOR  
CALIFORNIA CONTRACTORS LICENSE #

Signature: [Handwritten Signature] DATE: [Handwritten Date]  
SIGNATURE TITLE

INSULATION CONTRACTOR **ARCADE INSULATION**  
CALIFORNIA CONTRACTORS LICENSE #815286  
NEVADA CONTRACTORS LICENSE #55201

Signature: [Handwritten Signature] DATE: 2/16/04  
SIGNATURE TITLE



**BASALITE®**  
PACIFIC STUCCO SYSTEMS

4290 Roseville Road  
North Highlands, CA 95660-5710  
(916) 486-4094  
Fax (916) 486-4187

**Installation Card  
Fiber Reinforced Stucco**

Job Name and Address: CANTONVILLE  
LOT 3070  
380 REGENCY PARK CIR

ICBO# 5269

2/20/04  
Date of job completion

Plastering Contractor

Name: Vision Plastering

Address: 8974 Greenback Lane Orangevale, Ca. 95662

Telephone No. 916 987-3324

Approved contractor as issued by Basalite/Pacific Stucco

#117

This is to certify the exterior coating system at the above address, has been installed in accordance with the evaluation report specified above and the manufacturers instructions.

M. S. [Signature]  
Signature of authorized representative of  
plastering contractor

3/9/04  
Date

This installation card must be presented to the building inspector after completion of work and before final inspection.

a division of **PACIFIC COAST**  
building products

# plot plan

THIS PLOT PLAN IS FOR THE PURPOSE OF SHOWING THE HOUSE TO BE CONSTRUCTED ON THE LOT AND MAY NOT REPRESENT THE FINAL AS-BUILT CONFIGURATION OF THE PROPERTY OR IMPROVEMENTS THEREON. THE ACCURACY OF THIS PLOT PLAN IS NOT GUARANTEED, NOR IS IT A PART OF ANY POLICY, REPORT OR GUARANTEE TO WHICH IT MAY BE ATTACHED. ACTUAL DIMENSIONS, OTHER THAN THE MINIMUM ORDINANCE, MAY VARY OR CHANGE WITHOUT PRIOR NOTICE, DUE TO ACTUAL SITE CONDITIONS.

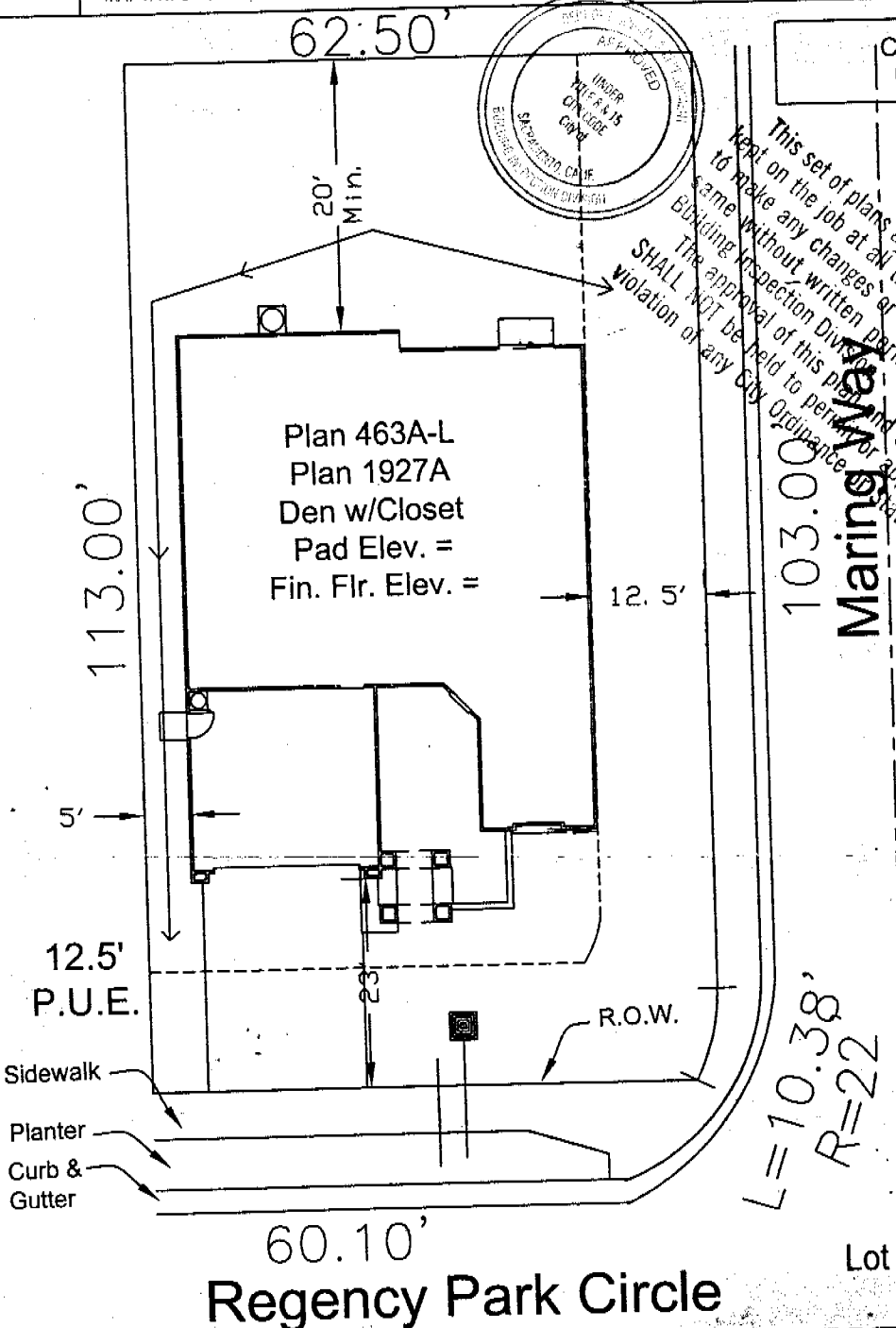

Canterbury Lot 3070

60.10'  
Regency Park Circle

Lot Sf: 7,040

Northpointe Park Village 30A

Lot #70  
380 Regency Park Circle  
City of Sacramento  
A.P.N.: 201-0780-044

Forecast Homes

Symbols Legend

- Street Light:
- Drop Inlet:
- Electric Service Box:
- Fire Hydrant:
- Pad-Mount Transformer:
- Sewer Service:
- Water Service:
- Flow Line:
- High Point:
- Flow Line:
- Elevation Back of Sidewalk:
- 2nd Story Element:

18	MAH	9/15/03	1"=20'
Phase	Drawn By	Date	Scale



Apollo Real Estate Group

1204 El Sur Way  
Sacramento, CA 95864  
(916) 978-0105