

CITY OF SACRAMENTO  
1231 I Street, Sacramento, CA 95814

Permit No: 0603752  
Insp Area: 4  
Thos Bros: 256H4

Site Address: 16 SHADMOOR PL SAC  
Parcel No: 201-1110-082  
N

THE HAMPTONS VIL. 3 LOT #82  
PAID

Sub-Type: NSFR  
Housing (Y/N):

CITY OF SACRAMENTO

CONTRACTOR  
KB HOME NORTH BAY INC.  
611 ORANGE DR  
VACAVILLE CA. 95687

OWNER  
KB HOME NORTH BAY INC  
611 ORANGE DR  
VACAVILLE, CA 95687  
APR 05 2006

ARCHITECT

Nature of Work: MP1992 2 STORY 10RM SFR

NEIGHBORHOODS PLANNING  
AND DEVELOPMENT SERVICES

**CONSTRUCTION LENDING AGENCY :** I hereby affirm under penalty of perjury that there is a construction lending agency for the performance of the work for which this permit is issued (Sec. 3097, Civ. C).

Lender's Name \_\_\_\_\_ Lender's Address \_\_\_\_\_

**LICENSED CONTRACTORS DECLARATION:** I hereby affirm under penalty of perjury that I am licensed under provisions of Chapter 9 (commencing with section 7000) of Division 3 of the Business and Professions Code and my license is in full force and effect.

License Class B License Number \_\_\_\_\_ Date 4-5-06 Contractor Signature DLR

**OWNER-BUILDER DECLARATION:** I hereby affirm under penalty of perjury that I am exempt from the contractors License Law for the following reason (Sec. 7031.5, Business and Professions Code; any city or county which requires a permit to construct, alter, improve, demolish, or repair any structure, prior to its issuance, also requires the applicant for such permit to file a signed statement that he or she is licensed pursuant to the provisions of the Contractors License Law (Chapter 9 (commencing with Section 7000) of Division 8 of the Business and Professions Code) or that he or she is exempt therefrom and the basis for the alleged exemption. Any violation of Section 7031.5 by any applicant for a permit subjects the applicant to a civil penalty of not more than five hundred dollars (\$500.00);

\_\_\_\_ I, as a owner of the property, or my employees with wages as their sole compensation, will do the work, and the structure is not intended or offered for sale (Sec. 7044, Business and Professional Code: The Contractors License Law does not apply to an owner of property who builds or improves thereon, and who does such work himself or herself or through his/her own employees, provided that such improvements are not intended or offered for sale. If, however, the building or improvement is sold within one year of completion, the owner-builder will have the burden of proving that he/she did not build or improve for the purpose of sale.)

\_\_\_\_ I, as owner of the property, am exclusively contracting with licensed contractors to construct the project (Sec. 7044, Business and Professions Code: The Contractors License Law does not apply to an owner of property who builds or improves thereon, and who contracts for such projects with a contractor(s) licensed pursuant to the Contractors License Law).

\_\_\_\_ I am exempt under Sec. \_\_\_\_\_ B & PC for this reason: \_\_\_\_\_

Date \_\_\_\_\_ Owner Signature \_\_\_\_\_

**IN ISSUING THIS BUILDING PERMIT,** the applicant represents, and the city relies on the representation of the applicant, that the applicant verified all measurements and locations shown on the application or accompanying drawings and that the improvement to be constructed does not violate any law or private agreement relating to permissible or prohibited locations for such improvements. This building permit does not authorize any illegal location of any improvement or the violation of any private agreement relating to location of improvements.

I certify that I have read this application and state that all information is correct. I agree to comply with all city and county ordinances and state laws relating to building construction and hereby authorize representative(s) of this city to enter upon the abovementioned property for inspection purposes.

Date 4-5-06 Applicant/Agent Signature DLR

**WORKER'S COMPENSATION DECLARATION:** I hereby affirm under penalty of perjury one of the following declarations:

\_\_\_\_ I have and will maintain a certificate of consent to self-insure for workers' compensation as provided for by Section 3700 of the Labor Code, for the performance of work for which the permit is issued.

I have and will maintain workers' compensation insurance, as required by Section 3700 of the Labor Code, for the performance of the work for which this permit is issued. My workers' compensation insurance carrier and policy number are:

Carrier \_\_\_\_\_ Policy Number \_\_\_\_\_ Exp Date \_\_\_\_\_

\_\_\_\_ (This section need not be completed if the permit is for \$100 or less) I certify that in the performance of the work for which this permit is issued, I shall not employ any person in any manner so as to become subject to the workers' compensation laws of California and agree that if I should become subject to the workers' compensation provisions of Section 3700 of the Labor Code, I shall forthwith comply with those provisions.

Date 4-5-06 Applicant Signature DLR

**WARNING:** FAILURE TO SECURE WORKER'S COMPENSATION COVERAGE IS UNLAWFUL AND SHALL SUBJECT AN EMPLOYER TO CRIMINAL PENALTIES AND CIVIL FINES UP TO ONE HUNDRED THOUSAND DOLLARS (\$100,000) IN ADDITION TO THE COST OF COMPENSATION, DAMAGES AS PROVIDED FOR IN SECTION 3706 OF THE LABOR CODE, INTEREST AND ATTORNEY'S FEE.

**THIS PERMIT SHALL EXPIRE BY LIMITATION IF WORK IS NOT COMMENCED WITHIN 180 DAYS.**

THIS PLOT PLAN IS NOT FOR SALES PURPOSES. THIS PLOT PLAN IS FOR THE PURPOSES OF INDICATING COMPLIANCE WITH ZONING SET BACKS, GENERAL DRAINAGE DIRECTION, AND APPROXIMATE UTILITY CONNECTION. ALL OTHER DATA SHOWN HEREON IS CONCEPTUAL. THIS PLOT PLAN DOES NOT REFLECT AS-BUILT CONDITION, RETAINING WALLS ARE OPTIONAL AND MAY OR MAY NOT BE CONSTRUCTED.

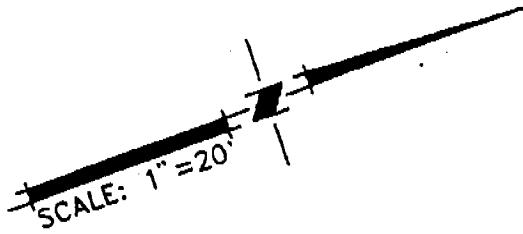

This set of plans and specifications must be kept on the job at all times and it is unlawful to make any changes or alterations from the same without written permission from the Building Inspection Division. The approval of this plan and specification SHALL NOT be held to permit or approve the violation of any City Ordinance or State Law.



SOUNDWALL

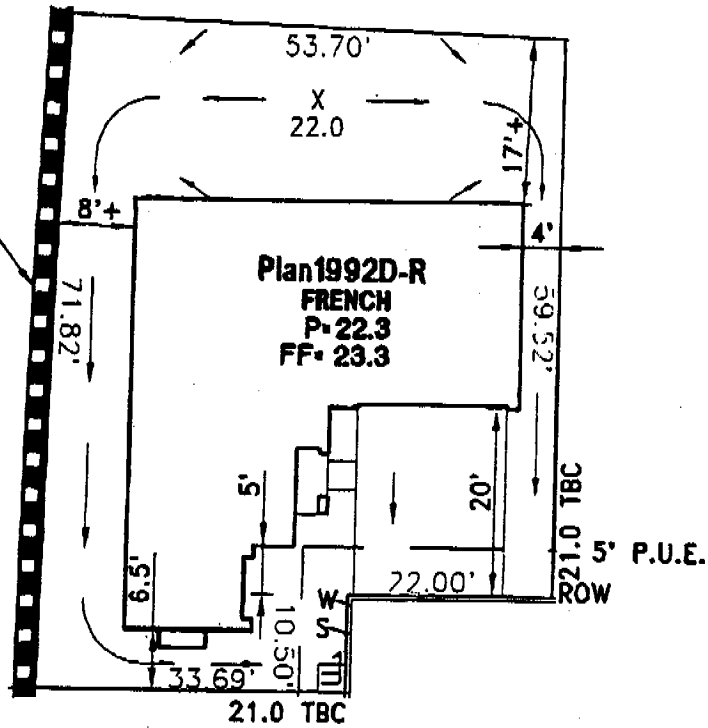

LEGEND

- DRAIN INLET
- S SEWER SERVICE
- W WATER SERVICE
- STREET LIGHT
- ▲ TRANSFORMER
- U UTILITY BOX
- STREET LIGHT SERVICE POINT
- FIRE HYDRANT
- STOP SIGN

16 SHADMOOR PLACE

THE HAMPTONS - VILLAGE 3 - CLUSTER  
KB HOME NORTH BAY  
PLOT PLAN FOR LOT 82

A.P.N.:  
LOT AREA: 3659 S.F.  
ADDRESS: 16 SHADMOOR PLACE  
CITY OF SACRAMENTO, CALIFORNIA

**WOOD ROGERS**  
ENGINEERING • PLANNING • MAPPING • SURVEYING  
9301 C STREET, BLDG. 100-B, SACRAMENTO, CA 95816  
PHONE: (916) 341-7755 FAX: (916) 341-7757

MARCH 2006 DRAWN: GDM 1217.013

CJC

J:\Jobs\1217-Natomes Meadows\The Hamptons-v3\Civil\Plotplan\10f\_082.dwg 3/13/06 2:13pm gmcckoin

**INSTALLATION CERTIFICATE**

LOT 82 PLANE 1992 CF-6R  
 Site Address 16 SHADMOOR PL KB HOME - HAMPTONS (CLUSTER)  
 Permit Number 0603752

An installation certificate is required to be posted at the building site or made available for all appropriate inspections. (The information provided on this form is required, however, use of this form to provide the information is optional.) After completion of final inspection a copy must be provided to the building department (upon request) and the building owner or occupancy, per Section 10-103(b).

**HVAC SYSTEMS:**

**Heating Equipment**

Equip. Type (pkg. Heat pump)	CEC Certified Mfr Name and Model #	# of Identical Systems	Efficiency (AFUE, etc.) or CF-IR value	Duct Location (attic, etc.)	Duct or Piping R-value	Heating Load (Btu/hr)	Heating Capacity (Btu/hr)	
FURNACE	Carrier 58STX070-12	1	80%	ATTIC	6	28,313	70,000	PLAN 1708
FURNACE	Carrier 58STX070-12	1	80%	ATTIC	6	27,627	70,000	PLAN 1722
FURNACE	Carrier 58STX070-12	1	80%	ATTIC	6	31,392	70,000	PLAN 1848
FURNACE	Carrier 58STX090-15	1	80%	ATTIC	6	27,627	90,000	PLAN 1922

**Cooling Equipment**

Equip. Type (pkg. Heat pump)	CEC Certified Compressor Unit Mfr Name and Model #	# of Identical Systems	Efficiency (SEER, etc.) or CF-IR value	Duct Location (attic, etc.)	Duct R-value	Cooling Load (Btu/hr)	Cooling Capacity (Btu/hr)	
A/C	Carrier 36BRC035*	1	13.0	ATTIC	6	22,792	33,100	PLAN 1708
A/C	Carrier 36BRC035*	1	13.0	ATTIC	6	23,526	33,100	PLAN 1722
A/C	Carrier 36BRC035*	1	13.0	ATTIC	6	26,043	33,100	PLAN 1848
A/C	Carrier 36BRC042*	1	13.0	ATTIC	6	23,526	38,600	PLAN 1922

\* = TXV valve installed as part of coil

(1) Reads greater than or equal to  
 I, the undersigned, verify that equipment listed above is: 1) the actual equipment installed, 2) equivalent to or more efficient than that specified in the certificate of compliance (Form CP-1R) submitted for compliance with the Energy Efficiency Standard for residential buildings, and 3) equipment that meets or exceeds the appropriate requirements for manufactured devices (from the Appliance Efficiency Regulations or Part 6), where applicable.

*John Ballarade 6/24/05*  
 Signature, Date

**BEUTLER CORPORATION**  
 Installing Subcontractor (Co. Name)  
 OR General Contractor (Co. Name) OR Owner

# INSTALLATION CERTIFICATE

(Page 2 of 13)

Site Address **16 SHADMOOR PL**

Permit Number  
**0603752**

**FENESTRATION/GLAZING:**

Manufacturer/Brand Name (GROUP LIKE PRODUCTS)	Product U-Factor (cf-IR value)	Product SHGC (cf-IR value)	# of Panes	Total Quantity of Like Product (Quantity)	Square Feet	Exterior Shading Device or Overhang	Comments/Notes Special Features
1. <b>PACIFIC</b>	<b>.35</b>	<b>SH</b>	<b>2</b>				
2. <b>↓</b>	<b>.35</b>	<b>20</b>	<b>2</b>				<b>LOWE<sup>2</sup></b>
3. <b>↓</b>	<b>.35</b>	<b>20</b>	<b>2</b>				<b>↓</b>
4. <b>↓</b>	<b>.35</b>	<b>20</b>	<b>2</b>				
5. <b>↓</b>	<b>.35</b>	<b>20</b>	<b>2</b>				
6.							
7.							
8.							
9.							
10.							
11.							
12.							
13.							
14.							
15.							

- 1. Manufactured fenestration products use the values from the product label. Field fabricated fenestration products use the default values from Section 115 of the Energy Efficiency Standards.
- 2. Installed U-Factor must be less than or equal to values from CF-IR. Installed SHGC must be less than or equal to value from CF-IR, or a shading device (exterior or overhang) is installed as specified on the CF-IR. Alternatively, installed weighted average U-Factors for the total fenestration area are less than or equal to values from CF-IR.

I, the undersigned, verify that the fenestration/glazing listed above my signature: 1) is the actual fenestration product installed; 2) is equivalent to or has a lower U-Factor and lower SHGC than that specified in the certificate of compliance (Form CF-IR) submitted for compliance with the Energy Efficiency Standards for residential buildings; and 3) the product meets or exceeds the appropriate requirements for manufactured devices (from Part 6), where applicable.

Item #s  
(if applicable)

Signature, Date

*[Signature]* 12/13/04

Installing Subcontractor (Co. Name) OR  
General Contractor (Co. Name) OR Owner  
OR Window Distributor

Item #s  
(if applicable)

Signature, Date

Installing Subcontractor (Co. Name) OR  
General Contractor (Co. Name) OR Owner  
OR Window Distributor

Item #s  
(if applicable)

Signature, Date

Installing Subcontractor (Co. Name) OR  
General Contractor (Co. Name) OR Owner  
OR Window Distributor

COPY TO: Building Department  
HERS Provider (if applicable)  
Building Owner at Occupancy

Compliance Expires

**INSTALLATION CERTIFICATE**

(Page 1 of 13)

**CF-6R**

Hamptons Clusters- Plan # 1992

Site Address 16 SHADMOOR PL

Permit Number 0603752

An installation certificate is required to be posted at the building site or made available for all appropriate inspections. (The information provided on this form is required; however, use of this form to provide the information is optional.) After completion of final inspection, a copy must be provided to the building department (upon request) and the building owner at occupancy, per Section 10-103(b).

**HVAC SYSTEMS:**

**Heating Equipment**

Equip. Type (pkg. heat pump)	CEC Certified Mfr Name and Model Number	# of Identical Systems	Efficiency (AFUE, etc.) <sup>1</sup> [ $\geq$ CF-1R value]	Duct Location (attic, etc.)	Duct or Piping R-value	Heating Load (Btu/hr)	Heating Capacity (Btu/hr)

**Cooling Equipment**

Equip. Type (pkg. heat pump)	CEC Certified Compressor Unit Mfr Name and Model Number	# of Identical Systems	Efficiency (SEER, etc.) <sup>1</sup> [ $\geq$ CF-1R value]	Duct Location (attic, etc.)	Duct R-value	Cooling Load (Btu/hr)	Cooling Capacity (Btu/hr)

1.  $\geq$  reads greater than or equal to.

I, the undersigned, verify that equipment listed above is: 1) is the actual equipment installed, 2) equivalent to or more efficient than that specified in the certificate of compliance (Form CF-1R) submitted for compliance with the *Energy Efficiency Standards* for residential buildings, and 3) equipment that meets or exceeds the appropriate requirements for manufactured devices (from the *Appliance Efficiency Regulations* or Part 6), where applicable.

Signature, Date \_\_\_\_\_

Installing Subcontractor (Co. Name)  
OR General Contractor (Co. Name) OR Owner

**WATER HEATING SYSTEMS:**

Heater Type	CEC Certified Mfr Name & Model Number	Distribution Type (Std. Point-of-Use)	If Recirculation, Control Type	# of Identical Systems	Rated <sup>2</sup> Input (kW or Btu/hr)	Tank Volume (gallons)	Efficiency <sup>2</sup> (EF, RE)	Standby <sup>2</sup> Loss (%)	External Insulation R-value <sup>3</sup>
GAS	AO Smith GVR-50	STD	n/a	1	40,000	50	.62	n/a	R16

- For small gas storage (rated input of less than or equal to 75,000 Btu/hr), electric resistance and heat pump water heaters, list Energy Factor. For large gas storage water heaters (rated input of greater than 75,000 Btu/hr), list Recovery Efficiency, Standby Loss and Rated Input. For instantaneous gas water heaters, list Recovery Efficiency and Rated Input.
- R-12 external insulation is mandatory for storage water heaters with an energy factor of less than 0.58.

**Faucets & Shower Heads:**

All faucets and showerheads installed are certified to the Commission, pursuant to Title 24, Part 6, Section 111.

I, the undersigned, verify that equipment listed above my signature is: 1) the actual equipment installed; 2) equivalent to or more efficient than that specified in the certificate of compliance (Form CF-1R) submitted for compliance with the *Energy Efficiency Standards* for residential buildings; and 3) equipment that meets or exceeds the appropriate requirements for manufactured devices (from the *Appliance Efficiency Regulations* or Part 6), where applicable.

Signature, Date \_\_\_\_\_

Installing Subcontractor (Co. Name) OR  
General Contractor (Co. Name) OR Owner

COPY TO: Building Department  
HERS Provider (if applicable)  
Building Owner at Occupancy



**WALLACE - KUHL & ASSOCIATES INC.**  
 GEOTECHNICAL ENGINEERING CONSTRUCTION TESTING

**Corporate Office**  
 3050 Industrial Blvd.  
 West Sacramento  
 CA 95691  
 916 372-1434

**Rocklin Office**  
 500 Menlo Drive  
 Suite 100  
 Rocklin, CA 95765  
 916 435-9722

**Stockton Office**  
 3410 W. Hammer Ln.  
 Suite F  
 Stockton, CA 95219  
 209 234-7722

**EPOXY DOWEL INSTALLATION INSPECTION REPORT**

Date	06-19-06	Job No.	5406.19	Weather	Clear	DSA File No.			
Project	Hamptons Vill. 3 Lots 82 - 90			Technician	Clay Weldon	DSA Application No.			
Location	Natomas			Reviewed By		Permit Number			
Type of Work	Epoxy Observation			Review Date		Date Revised (if applicable)			
Contractor / Builder	KB	Sub-Contractor	CVC	Project Inspector					
Lot No. / Location	Anchor/Dowel Diameter & Length	Hardware Type	No. of Anchor/Dowels	Hole Diameter	Embedment	Cleaning Method	Concrete Strength	Adhesive Product Name	Expiration Date
Lot 82	5/8" x 24"	HTT22	1	3/4"	12	Brush, blow, brush	3000 p.s.i.	Simpson Set 22	11 / 07
Lot 82	5/8" x 12"	AB	6	"	7	"	"	"	"
Lot 83	"	"	16	"	"	"	"	"	"
Lot 84	"	"	7	"	"	"	"	"	"
Lot 85	"	"	10	"	"	"	"	"	"
Lot 86	"	"	4	"	"	"	"	"	"
Lot 87	"	"	1	"	"	"	"	"	"
Lot 88	"	"	2	"	"	"	"	"	"
Lot 89	"	"	5	"	"	"	"	"	"
Lot 90	"	"	9	"	"	"	"	"	"

**Comments: Epoxy installation appears to be in accordance with approved plans**

*[Signature]*  
 Signed

This Report is Subject to Revision Until Final Review by Supervisor

Copy Left On-Site

Page 1 of 1



**WALLACE • KUHL & ASSOCIATES INC.**  
 GEOTECHNICAL ENGINEERING CONSTRUCTION TESTING

**Corporate Office**  
 3050 Industrial Blvd.  
 West Sacramento  
 CA 95691  
 916 372-1434

**Rocklin Office**  
 500 Menlo Drive  
 Suite 100  
 Rocklin, CA 95765  
 916 435-9722

**Stockton Office**  
 3410 W. Hammer Ln.  
 Suite F  
 Stockton, CA 95219  
 209 234-7722

**CONCRETE SAMPLING AND TESTING REPORT**

Date	04-27-06	Job No.	5406.19	Weather	Sunny	DSA File No.	
Project	Hamptons VILL-3			Technician	Mason Younce	DSA Application No.	
Location	Lots 79-84 / Shadmoor PL, Sac			Reviewed By		Permit Number	
Type of Work	PT SOG CONC PLACEMENT			Review Date		Date Revised (if applicable)	
Contractor/Builder	KB HOMES	Sub-Contractor	CVC	Supplier	Central	Project Inspector	

Placement for:	Footings	SOG	X	PT SOG	Tilt-up Panels	Cast in Place Walls	Other
Strength Requirement (per plans & spec)	3,000psi			Mix Design Number	750	Total yards placed	285

Lot/Sample Number	Truck Number	Ticket Number	Batch Time	Ambient Temp	Concrete Temp	Slump	% Air	Sample Location
79 / 1	7107	1543006	6:38	63	69	4 3/4		PT SOG NORTHEAST CORNER
80 / 2	7109	1543041	7:19	64	71	5 1/4		PT SOG SOUTHEAST CORNER
81 / 3	7132	1543143	8:20	67	72	4 3/4		PT SOG SOUTHWEST CORNER
82 / 4	5142	1543198	8:40	72	75	5		PT SOG SOUTHWEST CORNER
83 / 5	7137	1543320	9:40	83	78	5		PT SOG SOUTHWEST CORNER
84 / 6	7131	1543357	9:55	83	77	4 3/4		PT SOG NORTHEAST CORNER

**Comments:** Arrived on job site for concrete placement observation for PT SOG lots 79-84 located on Shadmoor PL. Cast 1 set of 3 per lot. Concrete placed by CVC was consolidated by mechanical vibrator, and appeared to be in general conformance with approved plans.

*Mason Younce*  
 Signed

Reviewed By \_\_\_\_\_

THIS REPORT IS SUBJECT TO REVISION UNTIL FINAL REVIEW BY SUPERVISOR

Copy left on site

Page \_\_\_\_\_ of \_\_\_\_\_



3050 Industrial Boulevard, West Sacramento, California 95691  
 Telephone (916) 372-1434 Fax (916) 372-2565  
 www.wallace-kuhl.com

Job No.  
 5706.19

**FIELD REPORT**

PROJECT NAME: <i>Hampshire Villa #3</i>	CLIENT OR OWNER: <i>K &amp; Homes</i>	DATE: <i>4.26.06</i>
GENERAL LOCATION/WORK: <i>Natomas</i>	OWNER OR CLIENT'S REPRESENTATIVE: <i>JASON</i>	DAY OF WEEK: <i>WEDNESDAY</i>
TYPE OF WORK: <i>SHADMOCK WY &amp; SHADMOCK PL.</i>	PHONE: <i>530-237-4154</i>	SUPERVISOR: <i>JIM DEAM</i>
<i>SATURATION CHECK</i>	WEATHER: <i>Clear</i>	TECHNICIAN: <i>JOHN BERNHARD</i>

TEST NUMBER	LOCATION	MEETS PROJECT REQUIREMENTS		COMMENTS
		YES	NO	
1	<i>Lot # 79 Near Shadmoock Pl.</i>	<input checked="" type="checkbox"/>	<input type="checkbox"/>	<i>SHADMOCK PLAS</i>
2	<i>80</i>	<input checked="" type="checkbox"/>	<input type="checkbox"/>	
3	<i>81</i>	<input checked="" type="checkbox"/>	<input type="checkbox"/>	
4	<i>82</i>	<input checked="" type="checkbox"/>	<input type="checkbox"/>	
5	<i>83</i>	<input checked="" type="checkbox"/>	<input type="checkbox"/>	
6	<i>84</i>	<input checked="" type="checkbox"/>	<input type="checkbox"/>	

NOTES:

*On Site This AM and found lots listed above to be in saturation condition.*

WHITE COPY - FIELD FOLDER CANARY COPY - PROJECT ENGINEER PINK COPY - CLIENT	COPY GIVEN TO: <i>JASON</i>	REPORT BY: <i>J.B.</i>
---	--------------------------------	---------------------------

This report presents opinions formed as a result of our observation of activities relating to geotechnical engineering. It is the contractor's responsibility to comply with the plans and specifications throughout the duration of the project irrespective of the presence of our representative. Our work does not include supervision or direction of the actual work of the contractor, his employees or agents. Horizontal and vertical lines and grades were determined by others. Our firm will not be responsible for job or site safety on this project.