

CITY OF SACRAMENTO
1231 I Street, Sacramento, CA 95814

Permit No: 0307162
Insp Area: 4
Thos Bros: 257-C4

Site Address: 4867 BROADWATER DR SAC
Parcel No: 225-1790-006 CREEKSIDE 4 LOT 06

Sub-Type: NSFR
Housing (Y/N): N

CONTRACTOR
KB HOME NORTH BAY INC.
611 ORANGE DR
VACAVILLE CA. 95687

OWNER

ARCHITECT

Nature of Work: MP2300 2 STORY 11 ROOM SFR

CONSTRUCTION LENDING AGENCY : I hereby affirm under penalty of perjury that there is a construction lending agency for the performance of the work for which this permit is issued (Sec. 3097, Civ. C).

Lender's Name _____ Lender's Address _____

LICENSED CONTRACTORS DECLARATION: I hereby affirm under penalty of perjury that I am licensed under provisions of Chapter 9 (commencing with section 7000) of Division 3 of the Business and Professions Code and my license is in full force and effect.

License Class B License Number 761970 Date 6-2-03 Contractor Signature Dianne Stahl

OWNER-BUILDER DECLARATION: I hereby affirm under penalty of perjury that I am exempt from the contractors License Law for the following reason (Sec. 7031.5, Business and Professions Code; any city or county which requires a permit to construct, alter, improve, demolish, or repair any structure, prior to its issuance, also requires the applicant for such permit to file a signed statement that he or she is licensed pursuant to the provisions of the Contractors License Law (Chapter 9 (commencing with Section 7000) of Division 8 of the Business and Professions Code) or that he or she is exempt therefrom and the basis for the alleged exemption. Any violation of Section 7031.5 by any applicant for a permit subjects the applicant to a civil penalty of not more than five hundred dollars (\$500.00);

I, as a owner of the property, or my employees with wages as their sole compensation, will do the work, and the structure is not intended or offered for sale (Sec. 7044, Business and Professional Code: The Contractors License Law does not apply to an owner of property who builds or improves thereon, and who does such work himself or herself or through his/her own employees, provided that such improvements are not intended or offered for sale. If, however, the building or improvement is sold within one year of completion, the owner-builder will have the burden of proving that he/she did not build or improve for the purpose of sale.)

I, as owner of the property, am exclusively contracting with licensed contractors to construct the project (Sec. 7044, Business and Professions Code: The Contractors License Law does not apply to an owner of property who builds or improves thereon, and who contracts for such projects with a contractor(s) licensed pursuant to the Contractors License Law).

I am exempt under Sec. _____ B & PC for this reason: _____

Date _____ Owner Signature _____

PAID
CITY OF SACRAMENTO
JUN 02 2003
NORTH PERMIT
CENTER

IN ISSUING THIS BUILDING PERMIT, the applicant represents, and the city relies on the representation of the applicant, that the applicant verified all measurements and locations shown on the application or accompanying drawings and that the improvement to be constructed does not violate any law or private agreement relating to permissible or prohibited locations for such improvements. This building permit does not authorize any illegal location of any improvement or the violation of any private agreement relating to location of improvements.

I certify that I have read this application and state that all information is correct. I agree to comply with all city and county ordinances and state laws relating to building construction and hereby authorize representative(s) of this city to enter upon the abovementioned property for inspection purposes.

Date 6-2-03 Applicant/Agent Signature Dianne Stahl

WORKER'S COMPENSATION DECLARATION: I hereby affirm under penalty of perjury one of the following declarations:

I have and will maintain a certificate of consent to self-insure for workers' compensation as provided for by Section 3700 of the Labor Code, for the performance of work for which the permit is issued.

I have and will maintain workers' compensation insurance, as required by Section 3700 of the Labor Code, for the performance of the work for which this permit is issued. My workers' compensation insurance carrier and policy number are:

Carrier A. I. G. Policy Number WC 7085103 Exp Date 05/01/2003

(This section need not be completed if the permit is for \$100 or less) I certify that in the performance of the work for which this permit is issued, I shall not employ any person in any manner so as to become subject to the workers' compensation laws of California and agree that if I should become subject to the workers' compensation provisions of Section 3700 of the Labor Code, I shall forthwith comply with those provisions.

Date 6-2-03 Applicant Signature Dianne Stahl

WARNING: FAILURE TO SECURE WORKER'S COMPENSATION COVERAGE IS UNLAWFUL AND SHALL SUBJECT AN EMPLOYER TO CRIMINAL PENALTIES AND CIVIL FINES UP TO ONE HUNDRED THOUSAND DOLLARS (\$100,000) IN ADDITION TO THE COST OF COMPENSATION, DAMAGES AS PROVIDED FOR IN SECTION 3706 OF THE LABOR CODE, INTEREST AND ATTORNEY'S FEE.

THIS PERMIT SHALL EXPIRE BY LIMITATION IF WORK IS NOT COMMENCED WITHIN 180 DAYS.

RESIDENTIAL SUBDIVISION BUILDING PERMIT APPLICATION

Project Address: 4867 Broadwater Drive Assessor Parcel # 225-1790006
 Lot Number: 6 Subdivision Creekside Village #

OWNER INFORMATION:

Legal Property Owner: KB Home Phone# 707-469-2464
 Owner Address: 111 Orange Dr City Vallejo State CA Zip 95687

CONTRACTOR INFORMATION: 0307162

Contractor: KB Home Lic. # 255425 Phone # 707-469-2464 Fax 723-1082

PROJECT INFORMATION:

Land Use Zone R1A Occupancy Group R3 Construction Type VN Fed Code 1A
 No. of Stories: 2 No. of Rooms: _____ Street Width: _____
 1st Floor Area 1013 2nd Floor Area 1287 Basement _____ Roof Material _____

AREA IN SQUARE FOOT OF:

Dwelling/Living	<u>2300</u>
Garage/Storage	<u>421</u>
Decks/Balconies	<u>14</u>
Carports	_____

SCOPE OF WORK: _____

FOR OFFICE USE ONLY

<input type="checkbox"/> Information Above Complete	<input type="checkbox"/> AR Flood Waiver Required	<input type="checkbox"/> Planning Approval
<input type="checkbox"/> Violation Files Checked	<input type="checkbox"/> Flood Elevation Certificate Required	<input type="checkbox"/> Design Review Approval
<input type="checkbox"/> Standard Setbacks	<input type="checkbox"/> Water Development Infill Area	<input type="checkbox"/> Special Fee Districts Apply:
<input type="checkbox"/> County Sewer		

←THE FOLLOWING MUST BE PROVIDED IN ORDER TO SUBMIT FOR PERMIT←

2 COMPLETE PLOT PLANS, LEGIBLE & DRAWN TO SCALE

11 X 17 COPY OF FLOOR PLAN WITH FOLLOWING INFORMATION

a) Assessor's Parcel Number	c) Owners Name
b) New Floor Area	d) Project Address

INSULATION CERTIFICATE

THIS IS TO CERTIFY THAT INSULATION HAS BEEN INSTALLED IN CONFORMANCE WITH THE CURRENT ENERGY REGULATIONS, CALIFORNIA ADMINISTRATION CODE, TITLE 24, STATE OF CALIFORNIA, IN THE BUILDING LOCATED AT:

4867 BROADWATER DR.

STREET ADDRESS LOT 6 CREEKSIDE SACRAMENTO CA
NUMBER CITY STATE

C EILINGS:

BLOW: MANUFACTURER GREEN FIBER THICKNESS 10.3" R/VALUE 38
SQUARE FEET 1217 #BAGS/LBS PER BAGS 55

BATTS: MANUFACTURER JOHNS MANVILLE THICKNESS 13" R/VALUE 38
JOHNS MANVILLE

E XTERIOR WALLS:

MANUFACTURER JOHNS MANVILLE THICKNESS 3.5" R/VALUE 13
JOHNS MANVILLE

F LOOR INSULATION:

MANUFACTURER JOHNS MANVILLE THICKNESS 6.5" R/VALUE 19
JOHNS MANVILLE

A IR INFILTRATION: (TITLE 24)

YES XXX NO

C OMBER: _____

GENERAL CONTRACTOR: KB HOMES LICENSE # _____

BY: _____ TITLE _____ DATE _____

INSULATION CONTRACTOR: WESTERN INSULATION LP LICENSE # 794484

BY: Becky Gutierrez TITLE AUTH. AGENT DATE 10/10/03
BECKY GUTHERZ

INSULATION CERTIFICATE

THIS IS TO CERTIFY THAT INSULATION HAS BEEN INSTALLED IN CONFORMANCE WITH THE CURRENT ENERGY REGULATIONS, CALIFORNIA ADMINISTRATION CODE, TITLE 24, STATE OF CALIFORNIA, IN THE BUILDING LOCATED AT:

SITE ADDRESS LOT & CREEKSIDE NATOMAS SACRAMENTO CA
NUMBER CITY STATE

CEILINGS:

BLOW: MANUFACTURER GREEN FIBER THICKNESS 10.3" R/VALUE 38
SQUARE FEET 1299 #BAGS/LBS PER BAGS 52

BATTS: MANUFACTURER JOHNS MANVILLE THICKNESS 13" 38
JOHNS MANVILLE

EXTERIOR WALLS:

MANUFACTURER JOHNS MANVILLE THICKNESS 3.5" R/VALUE 13
JOHNS MANVILLE

FLOOR INSULATION:

MANUFACTURER JOHNS MANVILLE THICKNESS 6.5" R/VALUE 19
JOHNS MANVILLE

AIR INFILTRATION: (TITLE 24)
YES XXX NO _____

OTHER: _____

GENERAL CONTRACTOR: KB HOMES LICENSE # _____

BY: _____ TITLE _____ DATE _____

INSULATION CONTRACTOR: WESTERN INSULATION LP LICENSE # 794484

BY: Becky Gutmerz TITLE AUTH. AGENT DATE 9/9/03
BECKY GUTMERZ

THIS PLOT PLAN IS FOR THE PURPOSES OF INDICATING COMPLIANCE WITH ZONING SET BACKS, GENERAL DRAINAGE DIRECTION, AND APPROXIMATE UTILITY CONNECTION. ALL OTHER DATA SHOWN HEREON IS CONCEPTUAL. THIS PLOT PLAN DOES NOT REFLECT AS-BUILT CONDITION, RETAINING WALLS AND WALKWAY STEPS ARE OPTIONAL AND MAY OR MAY NOT BE CONSTRUCTED. CHANGES IN THE FIELD WHICH ARE INCONSISTENT WITH THIS PLAN SHALL BE SUBJECT TO VERBAL, FOLLOWED BY WRITTEN APPROVAL BY THE CITY OF SACRAMENTO.

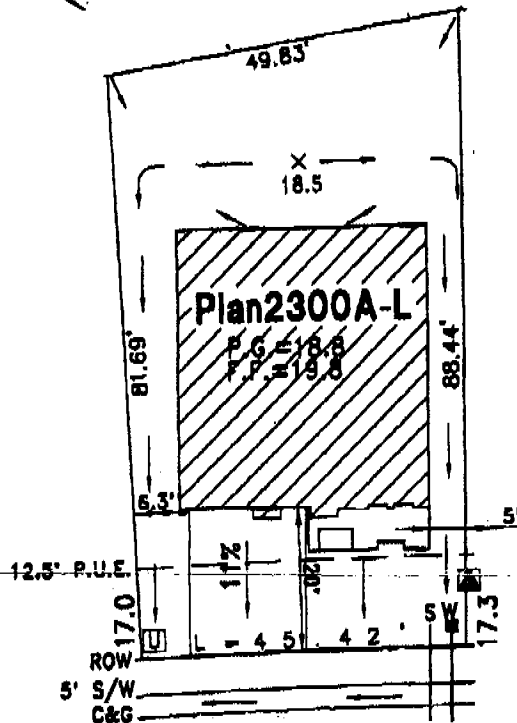
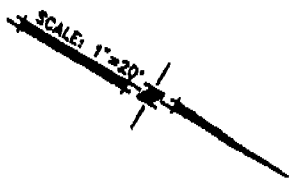

BROADWATER DRIVE

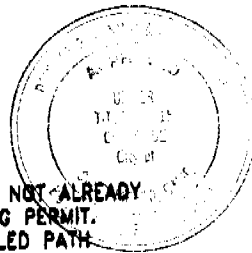

NOTES:

1. LANDSCAPING, SIDEWALK, WATER METER, IF NOT ALREADY INSTALLED, TO BE INSTALLED WITH BUILDING PERMIT.
2. ALL SEWER CLEANOUTS LOCATED IN TRAVELED PATH MUST HAVE A TRAFFIC RATED COVER.
3. IRRIGATION SERVICE FOR THE LANDSCAPE STRIP IN THE RIGHT-OF-WAY SHALL BE CONNECTED TO THE HOMEOWNER'S WATER SERVICE AFTER THE WATER METER.

- UTILITY SERVICE BOX
- STREET LIGHT
- FIRE HYDRANT

A.P.N.: 225-179-06
 LOT FOOTAGE: 4022 SQ. FT.
 ADDRESS: 4867 BROADWATER DRIVE
 CITY OF SACRAMENTO

CREEKSIDE VILLAGE 4
 KB HOME CORPORATION
 PLOT PLAN FOR LOT 6



WOOD RODGERS
 ENGINEERING - MAPPING - PLANNING - SURVEYING
 3301 C St, Bldg. 100-B Tel 916.341.7780
 Sacramento, CA 95816 Fax 916.341.7787

DATE: MAY 2003	DRAWN: FJ	CHECKED: RS	JOB #: 1035.012
-------------------	--------------	----------------	--------------------

J:\Jobs\Creekside Village\Civil\WVillage4\PlotPlans\Lot_06.dwg 5/13/03 1:02pm jpwonhlysh