

CONSTRUCTION LENDING AGENCY

I hereby affirm under penalty of perjury that there is a construction lending agency for the performance of the work for which this permit is issued (Sec. 3097, Civ. C).

Lenders Name _____
Lenders Address _____

LICENSED CONTRACTORS DECLARATION

I hereby affirm under penalty of perjury that I am licensed under provisions of Chapter 9 (commencing with Section 7000) of Division 3 of the Business and Professions Code and my license is in full force and effect.

License Class C-10 Lic. Number 803019
Date 4/5/99 Contractor Paul Cook
(Signature)

OWNER - BUILDER DECLARATION

I hereby affirm under penalty of perjury that I am exempt from the Contractors License Law for the following reason (Sec. 7031.5, Business and Professions Code: Any city or county which requires a permit to construct, alter, improve, demolish, or repair any structure, prior to its issuance, also requires the applicant for such permit to file a signed statement that he or she is licensed pursuant to the provisions of the Contractors License Law (Chapter 9 (commencing with Section 7000) of Division 8 of the Business and Professions Code) or that he or she is exempt therefrom and the basis for the alleged exemption. Any violation of Section 7031.5 by any applicant for a permit subjects the applicant to a civil penalty of not more than five hundred dollars (\$500.00):

I, as owner of the property, or my employees with wages as their sole compensation, will do the work, and the structure is not intended or offered for sale (Sec. 7044, Business and Professions Code: The Contractors License Law does not apply to an owner of property who builds or improves thereon, and who does such work himself or herself or through his or her own employees, provided that such improvements are not intended or offered for sale. If, however, the building or improvement is sold within one year of completion, the owner-builder will have the burden of proving that he or she did not build or improve for the purpose of sale.)

I, as owner of the property, am exclusively contracting with licensed contractors to construct the project (Sec. 7044, Business and Professions Code: The Contractors License Law does not apply to an owner of property who builds or improves thereon, and who contracts for such projects with a contractor(s) licensed pursuant to the Contractors License Law).

I am exempt under Sec. _____ B & P C for this reason _____

Date _____ Owner _____ (Signature)

In issuing this building permit, the applicant represents, and the City relies on the representation of the applicant, that the applicant verified all measurements and locations shown on the application or accompanying drawings and that the improvement to be constructed does not violate any law or private agreement relating to permissible or prohibited locations for such improvements. This building permit does not authorize any illegal location of any improvement or the violation of any private agreement relating to location of improvements.

I certify that I have read this application and state that all information is correct. I agree to comply with all city and county ordinances and state laws relating to building construction and hereby authorize representative of this city to enter upon the aforementioned property for inspection purposes.

Date 4/5/99 Signature of Applicant or Agent Paul Cook

SITE ADDRESS: 4401 Broadway 5-20585 C-2 3CS INSP. AREA

ASSESSOR PARCEL NO. 014-0763-028 PERMIT NO. 9903209

NAME OF APPLICANT: Pacific Neon ADDRESS: P.O. Box 15100 ZIP CODE: 95851 PHONE NO.: 9270527

BUSINESS OWNER: Safe SIGN INFORMATION

ATTACHED INTERIOR / ELECT. SINGLE FACED
 ILLUMINATED NON-ILLUMINATED BILLBOARD / SUBDIVISION
 INDIVIDUAL LETTERS PAINTED ON BUILDING LOGO
 METAL POLE DOUBLE FACED
 PLASTIC MONUMENT VINYL/CATOR FOAM
 WOODEN PROJECTING RE-FACE

SIGN COPY: Safe Credit Union

CITY OF SACRAMENTO PERMIT SERVICES
BUILDING INSPECTION DIVISION 264-7619

WORKER'S COMPENSATION DECLARATION

I hereby affirm under penalty of perjury one of the following declarations:

I have and will maintain a certificate of consent to self-insure for workers' compensation as provided for by Section 3700 of the Labor Code, for the performance of work for which the permit is issued.

I have and will maintain workers' compensation insurance, as required by Section 3700 of the Labor Code, for the performance of the work for which this permit is issued. My workers' compensation insurance carrier and policy number are: _____

Carrier: _____
Policy Number: _____

(This section need not be completed if the permit is for one hundred dollars (\$100) or less) I certify that in the performance of the work for which this permit is issued, I shall not employ any person in any manner so as to become subject to the workers' compensation laws of California and agree that if I should become subject to the workers' compensation provisions of Section 3700 of the Labor Code, I shall forthwith comply with those provisions.

Date: _____ Applicant: _____ (Signature)

WARNING: FAILURE TO SECURE WORKERS' COMPENSATION COVERAGE IS UNLAWFUL AND SHALL SUBJECT AN EMPLOYER TO CRIMINAL PENALTIES AND CIVIL FINES UP TO ONE HUNDRED THOUSAND DOLLARS (\$100,000) IN ADDITION TO THE COST OF COMPENSATION DAMAGES AS PROVIDED FOR IN SECTION 3706 OF THE LABOR CODE, INTEREST AND ATTORNEY'S FEES.

THIS PERMIT SHALL EXPIRE BY LIMITATION IF WORK AUTHORIZED IS NOT COMMENCED WITHIN 180 DAYS.

APPROVED BY: _____ DATE: _____	RECEIVED AMOUNT: _____
DENIED BY: _____ DATE: _____	DATE: _____
BUILDING INSPECTOR: _____	DATE: _____
ELECTRICAL INSPECTOR: _____	DATE: _____
SIGN INSPECTOR: _____	DATE: _____
FEES:	RECEIVED AMOUNT
SIGN APPLICATION FEE	_____
SIGN PERMIT FEE	_____
ELECTRICAL SIGN FEE	_____
CITY BUSINESS LICENSE	_____
OTHER	_____
TOTAL \$	_____

ILLUMINATED CHANNEL LETTERS

REVISED 19 APRIL 1999

SCALE: 3/8" = 1'-0"

SPECIFICATIONS:
 FABRICATE AND INSTALL ONE (1) SET OF INTERNALLY ILLUMINATED CHANNEL LETTERS / LOGO

ONE (1) SET OF NON ILLUMINATED FCO LETTERS

LETTERS/LOGO:
 ALUMINUM CONSTRUCTION,
 POLISHED GOLD RETURNS AND TRIMCAP

FACE:
 015-2 SG WHITE ACRYLITE WITH
 @3M VINYL FILM OVERLAY

"DOME" @3M 3630-74 KUMQUAT
 DRANGE

FCO LETTERS:
 "CREDIT UNION" 1/4" SINTRA PAINT TO MATCH @3M 3630-157 SULTAN BLUE (REFLEX BLUE), SEMI-GLOSS FINISH, MOUNT WITH 1/2" STANDOFFS

ILLUMINATION:
 WHITE NEON AS REQUIRED

FILE COPY

SOUTH ELEVATION
 SCALE 3/32" = 1' - 0"

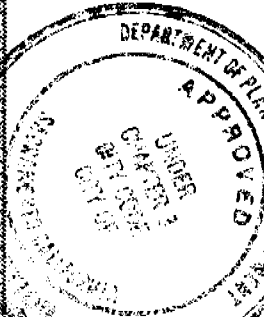
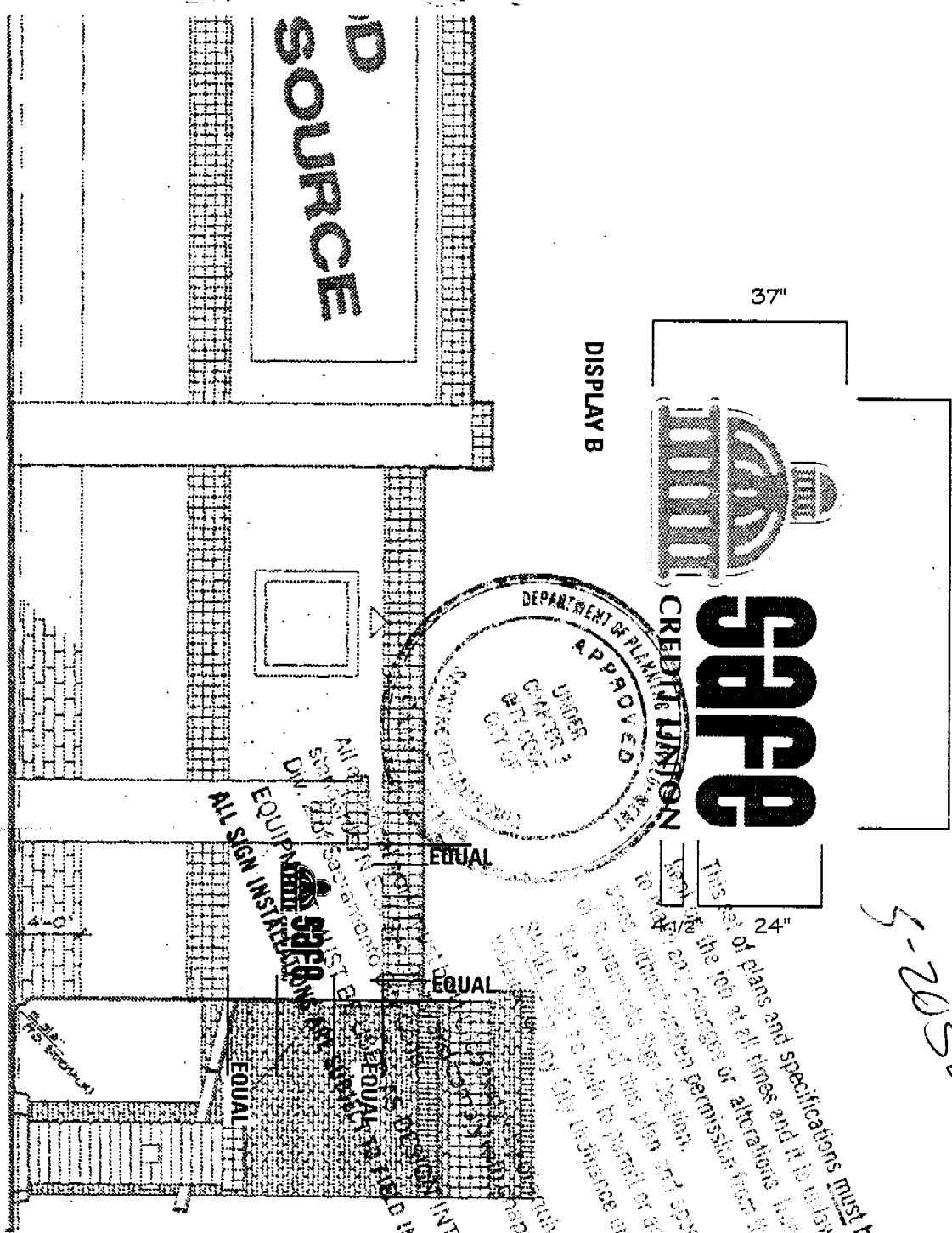

5-20585

This set of plans and specifications must be used for the job at all times and it is unlawful to make any changes or alterations from the original without written permission from the City of Sacramento. The approval of this plan and specifications shall be void in the absence of the signature of the Department of Planning, Chapter 15.

ALL WORK SHALL BE IN ACCORDANCE WITH THE CITY OF SACRAMENTO DEPARTMENT OF PLANNING AND INSPECTOR'S OFFICE. ALL SIGN INSTRUMENTS SHALL BE IN ACCORDANCE WITH THE CITY OF SACRAMENTO DEPARTMENT OF PLANNING AND INSPECTOR'S OFFICE.

CLIENT: SAFE CREDIT UNION

ADDRESS: DAVID RANDOLPH 99-3154

ADDRESS: 4401 BROADWAY, SACRAMENTO, CA

DATE: 20F3

DATE: 26 MAR 99 / REV 31 MAR 99 / GRAPHICS FINAL 5 APRIL 99 / REV 12 APRIL 99 / REV 19 APR 99

ALL DESIGN, CONCEPTS, AND WRITTEN MATERIALS ARE CONFIDENTIAL AND ARE THE SOLE EXCLUSIVE PROPERTY OF PACIFIC NEON COMPANY. NO PORTION OF THIS INFORMATION MAY BE DISCLOSED OR USED FOR ANY PURPOSE WITHOUT PRIOR WRITTEN CONSENT OF PACIFIC NEON COMPANY. ILLUSTRATIONS DEPICT CONCEPTS ONLY AND IS NOT INTENDED FOR FABRICATION. ©1999

Pacific Neon Company
Pacific Neon Company
 1576 SILICA AVE., SACRAMENTO, CA 95815 • 916.927.8527 FAX 916.927.2414



Typical Channel Letter / HAGE Installation

ILLUMINATED CHANNEL LETTER HAGE INSTALL

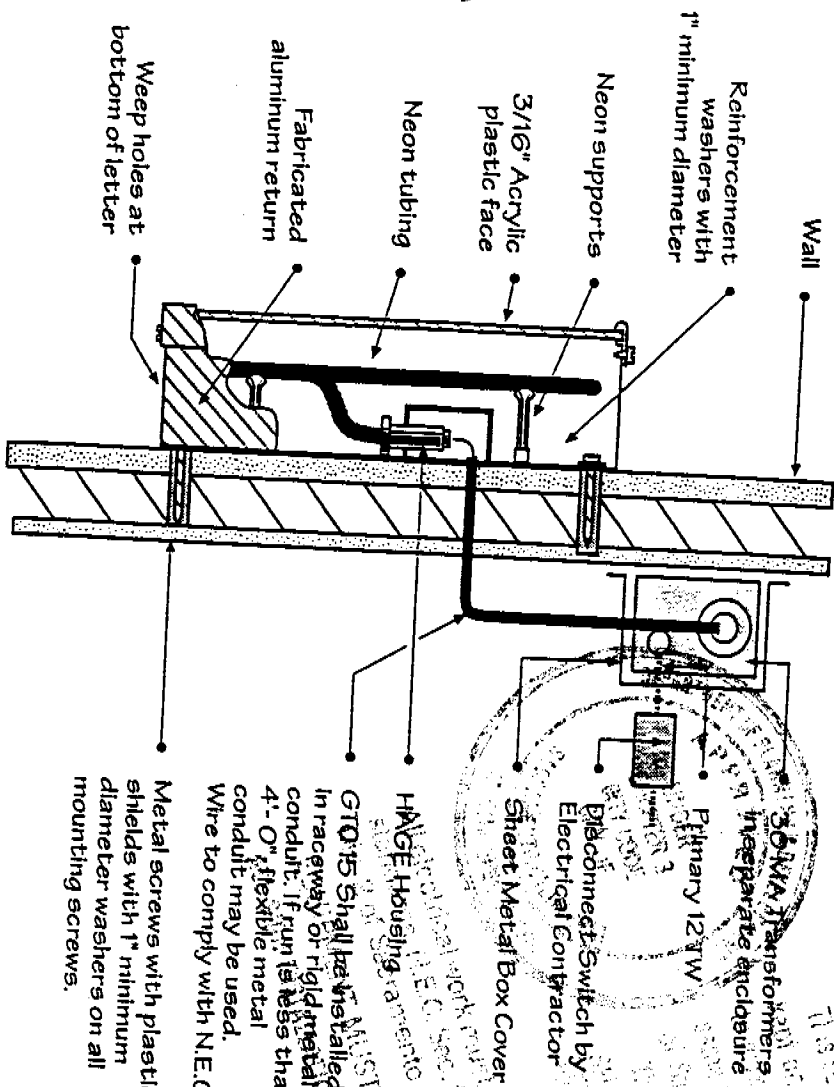

Individually Illuminated Channel Letter with HAGE Housing

30 MVA Transformer in separate enclosure
 Primary 120V
 Disconnect Switch by Electrical Contractor
 Sheet Metal Box Cover
 HAGE Housing
 GTO'S Shall have installed in raceway or rigid metal conduit. If run in less than 4'-0" flexible metal conduit may be used. Wire to comply with N.E.C.
 Metal screws with plastic shields with 1" minimum diameter washers on all mounting screws.

APPROVED PER 1999
 NATIONAL ELECTRICAL CODE
 AND CITY OF SACRAMENTO
 AMENDMENTS:
TM 4-9-99
 ELECTRICAL DIVISION

MUST BE USED AS DESIGN INTENDED
 HAGE Housing is not to be used as design intended
 GTO'S Shall have installed in raceway or rigid metal conduit. If run in less than 4'-0" flexible metal conduit may be used. Wire to comply with N.E.C.

SECTION DETAIL AT LEFT REPRESENTS A TYPICAL NEON ILLUMINATED CHANNEL LETTER INSTALLATION
 WALL MATERIAL AND/OR ELECTRICAL ACCESS MAY DIFFER FROM ILLUSTRATION
 PLEASE REFER TO ENCLOSED DETAILS, ORIGINAL ARCHITECTURAL INFORMATION OR FIELD VERIFICATION FOR ACTUAL ON SITE WORKING CONDITIONS

ITEM: VARIOUS
 DATE: 18 NOVEMBER 96
 ITEM#: 96-0000
 ITEM: VARIOUS

NOTE: ILLUSTRATIONS AS SHOWN, AS POSSIBLE BASED ON INFORMATION PROVIDED
 UNLESS OTHERWISE SPECIFIED, ALL DIMENSIONS ARE IN INCHES
 Goldwings of the 1960s - 1965
 Pacific Neon Company
 1518 SULLY AVE., SACRAMENTO, CA 95815 - 916.927.9577 FAX 916.927.2414 ©1996

SITE PLAN

PRELIMINARY 26 MARCH 1999

SCALE: NONE

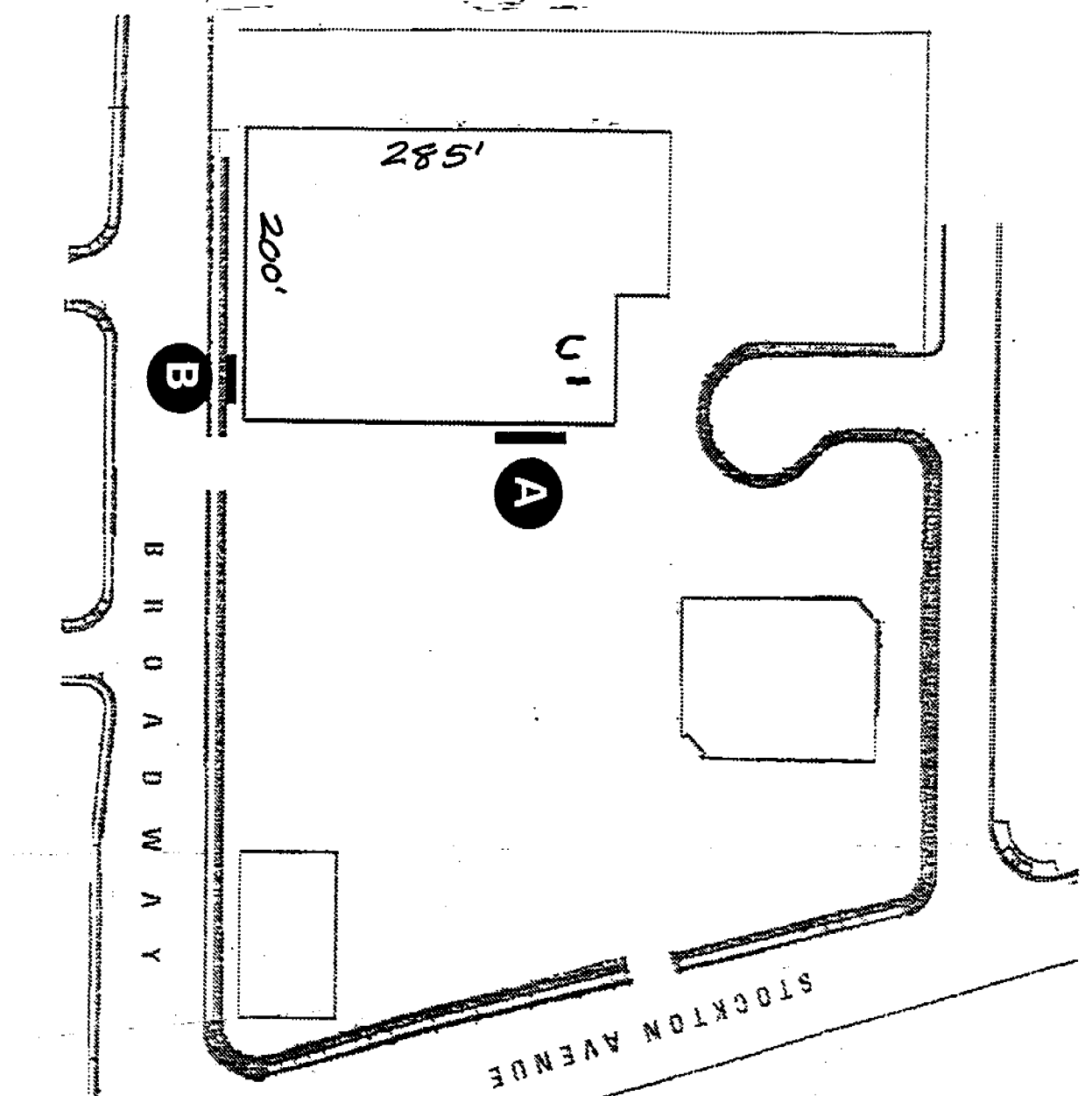

B I L D I N G

CLIENT: SAFE CREDIT UNION
DATE: 26 MAR 99

ARCHIT: DAVID RANDOLPH 99-3154
ADDRESS: 4401 BROADWAY, SACRAMENTO, CA

PH: 3 OF 3