

CITY OF SACRAMENTO
1231 I Street, Sacramento, CA 95814

Permit No: 0100007
Insp Area: 4

Site Address: 4231 RIVER SWAN LN SAC
Parcel No: 225-1240-057 GATEWAY N 2 LOT 92

Sub-Type: NSFR
Housing (Y/N): N

CONTRACTOR
MARCHBROOK BUILDING CO
PO BOX 7576
STOCKTON CA 95267

OWNER

ARCHITECT

Nature of Work: NSFR MP2505 6/7 12 RMS 2 STORY

CONSTRUCTION LENDING AGENCY: I hereby affirm under penalty of perjury that there is a construction lending agency for the performance of the work for which this permit is issued (Sec. 3097, Civ. C).

Lender's Name _____ Lender's Address _____

LICENSED CONTRACTORS DECLARATION: I hereby affirm under penalty of perjury that I am licensed under provisions of Chapter 9 (commencing with section 7000) of Division 3 of the Business and Professions Code and my license is in full force and effect.

License Class B License Number 740353 Date 1/9/01 Contractor Signature Paul B...

OWNER-BUILDER DECLARATION: I hereby affirm under penalty of perjury that I am exempt from the contractors License Law for the following reason (Sec. 7031.5, Business and Professions Code, any city or county which requires a permit to construct, alter, improve, demolish, or repair any structure, prior to its issuance, also requires the applicant for such permit to file a signed statement that he or she is licensed pursuant to the provisions of the Contractors License Law (Chapter 9 (commencing with Section 7000) of Division 8 of the Business and Professions Code) or that he or she is exempt therefrom and the basis for the alleged exemption. Any violation of Section 7031.5 by any applicant for a permit subjects the applicant to a civil penalty of not more than five hundred dollars (\$500.00):

____ I, as a owner of the property, or my employees with wages as their sole compensation, will do the work, and the structure is not intended or offered for sale (Sec. 7044, Business and Professional Code. The Contractors License Law does not apply to an owner of property who builds or improves thereon, and who does such work himself or herself or through his/her own employees, provided that such improvements are not intended or offered for sale. If, however, the building or improvement is sold within one year of completion, the owner-builder will have the burden of proving that he/she did not build or improve for the purpose of sale.)

____ I, as owner of the property, am exclusively contracting with licensed contractor(s) pursuant to Section 7044, Business and Professions Code. The Contractors License Law does not apply to an owner of property who builds or improves thereon, and who contracts for such projects with a contractor(s) licensed pursuant to the Contractors License Law.

____ I am exempt under Sec. _____ B & PC for this reason: _____

Date _____ Owner Signature _____

PAID
CITY OF SACRAMENTO
JAN 09 2001
NEIGHBORHOODS PLANNING AND DEVELOPMENT SERVICES

IN ISSUING THIS BUILDING PERMIT, the applicant represents, and the city relies on the representation of the applicant, that the applicant verified all measurements and locations shown on the application or accompanying drawings and that the improvement to be constructed does not violate any law or private agreement relating to permissible or prohibited locations for such improvements. This building permit does not authorize any illegal location of any improvement or the violation of any private agreement relating to location of improvements.

I certify that I have read this application and state that all information is correct. I agree to comply with all city and county ordinances and state laws relating to building construction and hereby authorize representative(s) of this city to enter upon the abovementioned property for inspection purposes.

Date 1/9/01 Applicant/Agent Signature Paul B...

WORKER'S COMPENSATION DECLARATION: I hereby affirm under penalty of perjury one of the following declarations:

____ I have and will maintain a certificate of consent to self-insure for workers' compensation as provided for by Section 3700 of the Labor Code, for the performance of work for which the permit is issued.

B I have and will maintain workers' compensation insurance, as required by Section 3700 of the Labor Code, for the performance of the work for which this permit is issued. My workers' compensation insurance carrier and policy number are:

Carrier SAFECO INSURANCE CO OF AMERICA Policy Number WC2342690D Exp Date 07/01/2001

____ (This section need not be completed if the permit is for \$100 or less) I certify that in the performance of the work for which this permit is issued, I shall not employ any person in any manner so as to become subject to the workers' compensation laws of California and agree that if I should become subject to the workers' compensation provisions of Section 3700 of the Labor Code, I shall forthwith comply with those provisions.

Date 1/9/01 Applicant Signature Paul B...

WARNING: FAILURE TO SECURE WORKER'S COMPENSATION COVERAGE IS UNLAWFUL AND SHALL SUBJECT AN EMPLOYER TO CRIMINAL PENALTIES AND CIVIL FINES UP TO ONE HUNDRED THOUSAND DOLLARS (\$100,000) IN ADDITION TO THE COST OF COMPENSATION, DAMAGES AS PROVIDED FOR IN SECTION 3706 OF THE LABOR CODE, INTEREST AND ATTORNEY'S FEE.

THIS PERMIT SHALL EXPIRE BY LIMITATION IF WORK IS NOT COMMENCED WITHIN 180 DAYS.

RESIDENTIAL BUILDING PERMIT APPLICATION

New Construction Addition Remodels Other

Project Address 4231 River Court Lane Assessor Parcel # 225-1240-0577

OWNER INFORMATION: 10795 - 11425 067
 Legal Property Owner Sundance Lake LLC, A Delaware Limited Liability Co. Phone # (209)473-6000
 Owner Address: P.O. Box 7576 City Stockton State CA Zip 95267

CONTRACTOR INFORMATION:
 Contractor: Marchbrook Building Co Lic. # 740353 Phone # (209)473-6000 Fax# (209)473-6044

PROJECT INFORMATION:
 Land Use Zone _____ Occupancy Group _____ Construction Type _____ Fed Code _____
 No. of stories: 2 No. of rooms 12 Street width: _____
 1st Floor Area 1391 2nd Floor Area 1477 Basement _____ Roof Material _____

AREA IN SQUARE FOOT OF:	EXISTING	NEW
Dwelling/Living	<u>2873</u>	_____
Garage/Storage	<u>667</u>	_____
Decks/Balconies	<u>189</u>	_____
Carports	<u>N/A</u>	_____

SCOPE OF WORK: SFD

FOR OFFICE USE ONLY

- | | | |
|---|---|--|
| <input type="checkbox"/> Information above complete | <input type="checkbox"/> AR Flood Waiver required | <input type="checkbox"/> Planning Approval |
| <input type="checkbox"/> Violation files checked | <input type="checkbox"/> Flood Elevation Certificate Required | <input type="checkbox"/> Design Review Approval |
| <input type="checkbox"/> Standard setbacks | <input type="checkbox"/> Water Development Infill Area | <input type="checkbox"/> Special Fee Districts Apply : _____ |
| <input type="checkbox"/> County Sewer | | |

NEW STRUCTURES & ADDITIONS

❖ THE FOLLOWING MUST BE PROVIDED IN ORDER TO SUBMIT FOR PLAN REVIEW

- | | |
|---|---|
| <input type="checkbox"/> 2 COMPLETE PLANS, LEGIBLE & DRAWN TO SCALE | ❖ Plans to include: site plan, floor plan, elevations, roof/ceiling plan, foundation and structural framing details, and structural calculations for non-conforming structures. |
| <input type="checkbox"/> 3 SETS IF PROJECT IS IN A DESIGN REVIEW AREA | |
| <input type="checkbox"/> Title 24 Energy Compliance documentation | <input type="checkbox"/> 11" x 17" copy of floor plan for County Assessor |
| <input type="checkbox"/> Grading and Erosion Control Questionnaire | <input type="checkbox"/> Plan Review Fees |

Date: _____ Received by (staff) _____

ACTIVITY/PERMIT #



WesPac

insulation

a MASCO Company



809 North Market Blvd., Ste. 11 • Sacramento, CA 95834
 (916) 927-7149 • Fax (916) 927-4257
 Lic. #487478

Installed Insulation Certificate

We certify that the building insulation listed herein is installed in conformance with current energy conservation regulations, California Administrative Code, Title 24, State of California

R FACTOR	AREA	TYPE	INCHES/BAGS (BLOWN)
R38	AFTIC	FIBERGLASS BLOWN	16 2/32 BAGS
R38	CEILING	FIBERGLASS BATT	
R12	EXTERIOR WALL	FIBERGLASS BATT	

Certified by *Annex Mary*

Title SECRETARY

Address of Lot Number 92

Date Installed



ACE • KUHL & ASSOCIATES INC.
TECHNICAL ENGINEERING • CONSTRUCTION TESTING

3050 Industrial Blvd.
PO Box 1137
West Sacramento
California 95691
916-372-1434

1-2-01		JOB NO. 3895.14		WEATHER		TEMP. ° at ° at		AM PM	
JEWELRY NOR-11				Technician I		Staff E/G			
-S# 91,92				Technician II		Project E/G			
ALL TEST				Technician III		Senior E/G			
0 mi. radius <input checked="" type="checkbox"/>		Outside 50 mi. radius <input type="checkbox"/>		Nuclear Densities <input type="checkbox"/>		Principal E/G <input type="checkbox"/>			
	REG HRS	OT HRS	TOTAL HRS	TRAVEL	ON JOB	VEHICLE	MILES		
2.5	1.5		20	.5		# 14	160		

ACTIONS
ON SITE AS REQUESTED TO PERFORM PULL TEST
5/8" & 7/8" ALL-TREAD FOR HTT22'S & PHD8'S (A PULL
OF 7500# AND A GAGE PSI OF 3400# USING JACK A
& GAGE #5A @ THE FOLLOWING LOCATIONS.

#91- 1EA PHD8 S/WALL OF GARAGE, 1EA HTT22 W/WALL
V9 ROOM, 1EA HTT22 E/WALL FRONT BEDROOM. PASSED

#92- 3EA HTT22'S E/WALL OF KITCHEN GARAGE, 1EA
HTT22 E/WALL KITCHEN, 1EA PHD8 S/WALL BACK BEDROOM, 1EA
HTT22 W/WALL UNDER STAIR WELL. PASSED

2



ALLACE • KUHL & ASSOCIATES INC.
 GEOTECHNICAL ENGINEERING • CONSTRUCTION TESTING

3050 Industrial Blvd.
 PO Box 1137
 West Sacramento
 California 95691
 916-372-1434

DATE 4-2-01		JOB NO. 3895.14		WEATHER		TEMP.		* at	AM
PROJECT GATEWAY North		Technician I		<input type="checkbox"/>		Staff E/G		<input type="checkbox"/>	
LOCATION Lots # 91-92		Technician II		<input type="checkbox"/>		Project E/G		<input type="checkbox"/>	
TYPE OF WORK Full Test		Technician III		<input type="checkbox"/>		Senior E/G		<input type="checkbox"/>	
Inside 50 mi. radius <input checked="" type="checkbox"/>		Outside 50 mi. radius <input type="checkbox"/>		Nuclear Densities		Principal E/G		<input type="checkbox"/>	
PERSONNEL	REG. HRS	OT HRS	TOTAL HRS	TRAVEL	ON JOB	VEHICLE	MILES		
E.S.	1.5	0	20.5		# 14		160		

OBSERVATIONS:
 ON SITE HE REQUESTED TO PERFORM PULL TEST
 IN 5/8" & 7/8" ALL-BREADTH FOR HTT22'S & PHD8'S (A PULL
 VALUE OF 7500# AND A GAGE PSI. OF 3400# USING LINKA
 WITH GAGE #5A @ THE FOLLOWING LOCATIONS.
 AT #91-1EA PHD8 S/WALL OF GARAGE, 1EA HTT22 W/WALL
 LIVING ROOM, 1EA HTT22 E/WALL FRONT BEDROOM. PASSED
 AT #92-3EA HTT22'S E/WALL OF KITCHEN GARAGE, 1EA
 HTT22 E/WALL KITCHEN, 1EA PHD8 S/WALL BACK BEDROOM, 1EA
 HTT22 W/WALL UNDER STAIR WELL. PASSED

SCALE: 1"=20'

5' DRAINAGE ESMT
8' PAD LINE

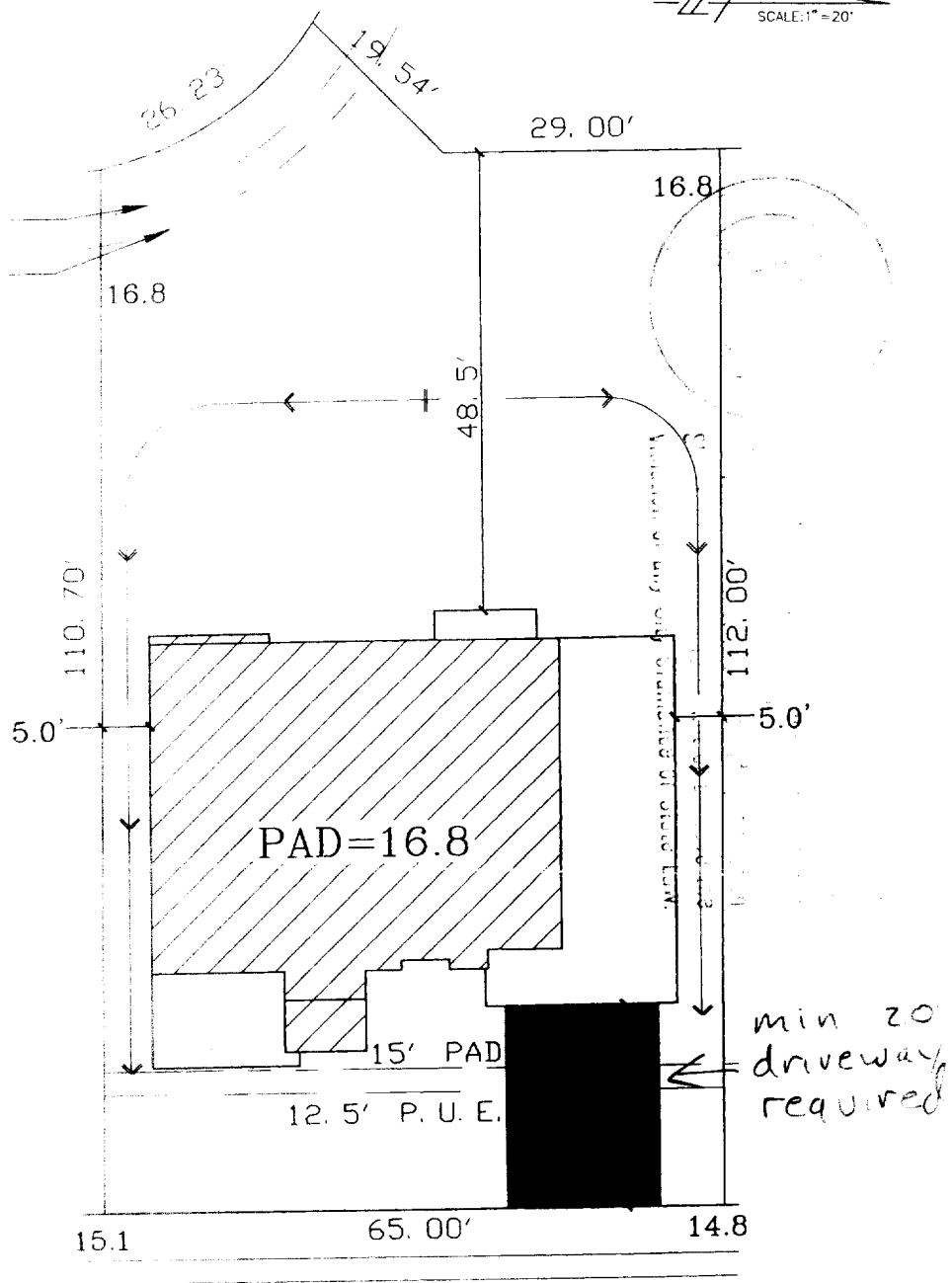

RIVER SWAN LANE

LOT 92
 PLAN 3A RIGHT
 A.P.N.:
 ADDRESS: RIVER SWAN LANE
 LOT AREA: 7,468 SF
 LOT COVERAGE: 31%

The Splink Corporation
 2590 VENTURE OAKS WAY
 SACRAMENTO, CA. 95833
 PH:(916)925-5550 FAX:(916)921-9274

MARCHBROOK BUILDING COMPANY
 P.O. Box 7576
 Stockton, Ca 95267
 office: (209) 473-6053
 fax: (209) 951-0684

GATEWAY NORTH VILLAGE 2
 City of Sacramento, California
 Scale: 1"=20'
 December 13, 2000

J:\JOBS\5000-S\55780010\CIVIL\VILLAGE2\LOT92.DWG 12/13/00 16:42