

CITY OF SACRAMENTO

1231 I Street, Sacramento, CA 95814

Permit No: 9913402

Insp Area: 4

Site Address: 2690 PICKERING WY SAC

Parcel No: 274-0540-015

LOT 15-3 HERITAGE PL 1

Sub-Type: NSFR

Housing (Y/N): N

CONTRACTOR

EPICK INC.
1263 THE ESPLANADE
CHICO CA 95926

OWNER

ARCHITECT

Nature of Work: NSFR MP1710 8 RMS/OFFICE OPT. 1870 SQ FT/397 SQ FT GAR.

CONSTRUCTION LENDING AGENCY: I hereby affirm under penalty of perjury that there is a construction lending agency for the performance of the work for which this permit is issued (Sec. 3097, Civ. C).

Lender's Name Bank Lender's Address 15245 Douglas Blvd Roseville 95661

LICENSED CONTRACTORS DECLARATION: I hereby affirm under penalty of perjury that I am licensed under provisions of Chapter 9 (commencing with section 7000) of Division 3 of the Business and Professions Code and my license is in full force and effect.

License Class B License Number 663708 Date 3/16/00 Contractor Signature [Signature]

OWNER-BUILDER DECLARATION: I hereby affirm under penalty of perjury that I am exempt from the contractors License Law for the following reason (Sec. 7031.5, Business and Professions Code: any city or county which requires a permit to construct, alter, improve, demolish, or repair any structure, prior to its issuance, also requires the applicant for such permit to file a signed statement that he or she is licensed pursuant to the provisions of the Contractors License Law (Chapter 9 (commencing with Section 7000) of Division 8 of the Business and Professions Code) or that he or she is exempt therefrom and the basis for the alleged exemption. Any violation of Section 7031.5 by any applicant for a permit subjects the applicant to a civil penalty of not more than five hundred dollars (\$500.00);

I, as a owner of the property, or my employees with wages as their sole compensation, will do the work, and the structure is not intended or offered for sale (Sec. 7044, Business and Professional Code: The Contractors License Law does not apply to an owner of property who builds or improves thereon, and who does such work himself or herself or through his/her own employees, provided that such improvements are not intended or offered for sale. If, however, the building or improvement is sold within one year of completion, the owner-builder will have the burden of proving that he/she did not build or improve for the purpose of sale.)

I, as owner of the property, am exclusively contracting with licensed contractors to construct the project (Sec. 7044, Business and Professions Code: The Contractors License Law does not apply to an owner of property who builds or improves thereon, who contracts for such projects with a contractor(s) licensed pursuant to the Contractors License Law).

I am exempt under Sec. B & PC for this reason: NEIGHBORHOODS, PLANNING AND DEVELOPMENT SERVICES
Date _____ Owner Signature _____

IN ISSUING THIS BUILDING PERMIT, the applicant represents, and the city relies on the representation of the applicant, that the applicant verified all measurements and locations shown on the application or accompanying drawings and that the improvement to be constructed does not violate any law or private agreement relating to permissible or prohibited locations for such improvements. This building permit does not authorize any illegal location of any improvement or the violation of any private agreement relating to location of improvements.

I certify that I have read this application and state that all information is correct. I agree to comply with all city and county ordinances and state laws relating to building construction and hereby authorize representative(s) of this city to enter upon the above-mentioned property for inspection purposes.

Date 3/16/00 Applicant/Agent Signature [Signature]

WORKER'S COMPENSATION DECLARATION: I hereby affirm under penalty of perjury one of the following declarations:

I have and will maintain a certificate of consent to self-insure for workers' compensation as provided for by Section 3700 of the Labor Code, for the performance of work for which the permit is issued.

I have and will maintain workers' compensation insurance, as required by Section 3700 of the Labor Code, for the performance of the work for which this permit is issued. My workers' compensation insurance carrier and policy number are:

Carrier STATE FUND Policy Number 1442812-98 Exp Date 10/01/1999

(This section need not be completed if the permit is for \$100 or less) I certify that in the performance of the work for which this permit is issued, I shall not employ any person in any manner so as to become subject to the workers' compensation laws of California and agree that if I should become subject to the workers' compensation provisions of Section 3700 of the Labor Code, I shall forthwith comply with those provisions.

Date 3/16/00 Applicant Signature [Signature]

WARNING: FAILURE TO SECURE WORKER'S COMPENSATION COVERAGE IS UNLAWFUL AND SHALL SUBJECT AN EMPLOYER TO CRIMINAL PENALTIES AND CIVIL FINES UP TO ONE HUNDRED THOUSAND DOLLARS (\$100,000) IN ADDITION TO THE COST OF COMPENSATION, DAMAGES AS PROVIDED FOR IN SECTION 3706 OF THE LABOR CODE, INTEREST AND ATTORNEY'S FEE.

THIS PERMIT SHALL EXPIRE BY LIMITATION IF WORK IS NOT COMMENCED WITHIN 180 DAYS.

RESIDENTIAL BUILDING PERMIT APPLICATION

New Construction Addition Remodels Other

OK

Project Address: 2490 Pickeringway Ct 15-3 Assessor Parcel # 274-0590-015

OWNER INFORMATION:

Legal Property Owner: Epick Homes #1 LLC Phone # (530) 891-4757
Owner Address: 1263 The Esplanade City Chico State Calif Zip 95926

CONTRACTOR INFORMATION:

Contractor: EPICK Inc. Lic. # 463708 Phone # (530) 891-4757 Fax # (530) 891-4206

PROJECT INFORMATION:

Land Use Zone R1A Occupancy Group R3 Construction Type VN Fed Code A

No. of stories: 1 No. of rooms: 7 Street width: _____

1st Floor Area 1710 2nd Floor Area - Basement _____ Roof Material Conc + tile
+160'

AREA IN SQUARE FOOT OF:	EXISTING	NEW
Dwelling/Living	<u>1870</u>	_____
Garage/Storage	<u>397</u>	_____
Decks/Balconies	_____	_____
Carports	_____	_____

SCOPE OF WORK: S.F.D. M.P. 1710
w/ off. opt (+160)

FOR OFFICE USE ONLY

- Information above complete
- AR Flood Waiver required
- Planning Approval
- Violation files checked
- Flood Elevation Certificate Required
- Design Review Approval
- Standard setbacks
- Water Development Infill Area
- Special Fee Districts Apply: _____
- County Sewer

NEW STRUCTURES & ADDITIONS

❖ THE FOLLOWING MUST BE PROVIDED IN ORDER TO SUBMIT FOR PLAN REVIEW

- 2 COMPLETE PLANS, LEGIBLE & DRAWN TO SCALE ❖ Plans to include: site plan, floor plan, elevations, roof/ceiling plan, foundation and structural framing details, and structural calculations for non-conforming structures.
- 3 SETS IF PROJECT IS IN A DESIGN REVIEW AREA
- Title 24 Energy Compliance documentation
- 11" x 17" copy of floor plan for County Assessor
- Grading and Erosion Control Questionnaire
- Plan Review Fees

Date: _____

Received by: (staff) _____

ACTIVITY/PERMIT # _____

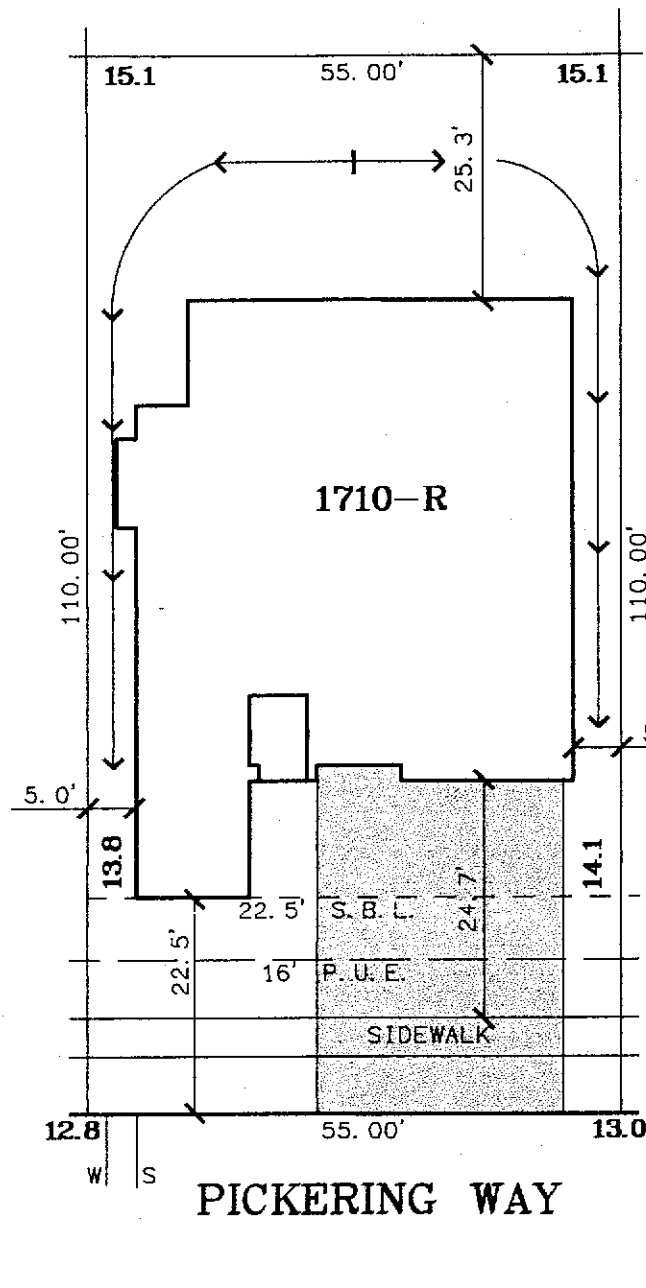

THESE DIMENSIONS ARE BASED ON THE RECORD PLANS FOR THE PROJECT AND THE FIELD SURVEY. THE DIMENSIONS OF ANY OTHER PROPERTY OR INTEREST ARE NOT TO BE CONSIDERED AS A GUARANTEE OF THE ACCURACY OF THESE DIMENSIONS. THE DIMENSIONS OF ANY OTHER PROPERTY OR INTEREST ARE NOT TO BE CONSIDERED AS A GUARANTEE OF THE ACCURACY OF THESE DIMENSIONS.

LOT AREA: 6,050 SQ.FT.

DRAWN: 11-15-99

A. P. N. :
 ADDRESS : 2690 PICKERING WAY



APPROVED BY

The Spink Corporation

2590 VENTURE OAKS WAY
 SACRAMENTO, CA. 95833
 PH:(916)925-5550 FAX:(916)921-9274

HERITAGE PLACE
 UNIT NO. 3

LOT 15-3
 PLAN 1710

RIVERSGATE

CITY OF SACRAMENTO, CA.
 CLIENT: EPICK HOMES #1, L.L.C.
 JOB NO.: 2808-004