

CITY OF SACRAMENTO
1231 I Street, Sacramento, CA 95814

Permit No: 0104948
Insp Area: 4

Site Address: 1830 BAINES AV SAC
Parcel No: 225-1110-032

NORTHPT PK 12 LOT 32

Sub-Type: NSFR
Housing (Y/N): N

CONTRACTOR
FENNAR RENAISSANCE INC
2240 DOUGLAS BL
ROSEVILLE CA 95661

OWNER
FENNAR RENAISSANCE INC
2240 DOUGLAS BLVD #250
ROSEVILLE CA 95661

ARCHITECT

Nature of Work: NSFR MP652X4 OPT 2988 SQ FT/11 RMS

CONSTRUCTION LENDING AGENCY: I hereby affirm under penalty of perjury that there is a construction lending agency for the performance of the work for which this permit is issued (Sec. 3097, Civ. C.)

Lender's Name _____ Lender's Address _____

LICENSED CONTRACTORS DECLARATION: I hereby affirm under penalty of perjury that I am licensed under provisions of Chapter 9 (commencing with section 7000) of Division 3 of the Business and Professions Code and my license is in full force and effect.

License Class F License Number 732248 Date 6/11/02 Contractor Signature J. Price

OWNER-BUILDER DECLARATION: I hereby affirm under penalty of perjury that I am exempt from the contractors License Law for the following reason (Sec. 7031.5, Business and Professions Code: any city or county which requires a permit to construct, alter, improve, demolish, or repair any structure, prior to its issuance, also requires the applicant for such permit to file a signed statement that he or she is licensed pursuant to the provisions of the Contractors License Law (Chapter 9 (commencing with Section 7000) of Division 8 of the Business and Professions Code) or that he or she is exempt therefrom and the basis for the alleged exemption. Any violation of Section 7031.5 by any applicant for a permit subjects the applicant to a civil penalty of not more than five hundred dollars (\$500.00).

I, as a owner of the property, or my employees with wages as their sole compensation, will do the work, and the structure is not intended or offered for sale (Sec. 7044, Business and Professional Code). The Contractors License Law does not apply to an owner of property who builds or improves thereon, and who does such work himself or herself or through his/her own employees, provided that such improvements are not intended or offered for sale. If, however, the building or improvement is sold within one year of completion, the owner-builder will have the burden of proving that he/she did not build or improve for the purpose of sale.)

I, as owner of the property, am exclusively contracting with licensed contractors to construct the project (Sec. 7044, Business and Professions Code). The Contractors License Law does not apply to an owner of property who builds or improves thereon, and who contracts for such projects with a contractor(s) licensed pursuant to the Contractors License Law.)

I am exempt under Sec. _____ B & PC for this reason: _____

Date _____ Owner Signature _____

IN ISSUING THIS BUILDING PERMIT, the applicant represents, and the city relies on the representation of the applicant, that the applicant verified all measurements and locations shown on the application or accompanying drawings and that the improvement to be constructed does not violate any law or private agreement relating to permissible or prohibited locations for such improvements. This building permit does not authorize any illegal location of any improvement or the violation of any private agreement relating to location of improvements.

I certify that I have read this application and state that all information is correct. I agree to comply with all city and county ordinances and state laws relating to building construction and hereby authorize representative(s) of this city to enter upon the abovementioned property for inspection purposes.

Date 6/11/02 Applicant/Agent Signature J. Price

WORKER'S COMPENSATION DECLARATION: I hereby affirm under penalty of perjury one of the following declarations:

I have and will maintain a certificate of consent to self-insure for workers' compensation as provided for by Section 3700 of the Labor Code, for the performance of work for which the permit is issued

I have and will maintain workers' compensation insurance, as required by Section 3700 of the Labor Code, for the performance of the work for which this permit is issued. My workers' compensation insurance carrier and policy number are:

Carrier CNA INSURANCE COMPANY Policy Number WC138201151 Exp Date 06/01/2002

(This section need not be completed if the permit is for \$100 or less) I certify that in the performance of the work for which this permit is issued, I shall not employ any person in any manner so as to become subject to the workers' compensation laws of California and agree that if I should become subject to the workers' compensation provisions of Section 3700 of the Labor Code, I shall forthwith comply with those provisions.

Date 6/11/02 Applicant Signature J. Price

WARNING: FAILURE TO SECURE WORKER'S COMPENSATION COVERAGE IS UNLAWFUL AND SHALL SUBJECT AN EMPLOYER TO CRIMINAL PENALTIES AND CIVIL FINES UP TO ONE HUNDRED THOUSAND DOLLARS (\$100,000) IN ADDITION TO THE COST OF COMPENSATION, DAMAGES AS PROVIDED FOR IN SECTION 3706 OF THE LABOR CODE, INTEREST AND ATTORNEY'S FEE.

THIS PERMIT SHALL EXPIRE BY LIMITATION IF WORK IS NOT COMMENCED WITHIN 180 DAYS.

RESIDENTIAL BUILDING PERMIT APPLICATION

New Construction
 Addition
 Remodels
 Other

Project Address: 1030 BAINES AVE
 Assessor Parcel # 225-111-032-000

OWNER INFORMATION: LOT 32

Legal Property Owner: LENNAR RENAISSANCE, INC.
 Phone # (916) 773-4083
 Owner Address: 2240 DOUGLAS BLVD. #250
 City ROSEVILLE
 State CA
 Zip 95661

CONTRACTOR INFORMATION:

Contractor: SAME AS ABOVE
 Lic. # 732348 B
 Phone # 773-4083
 Fax# 773-4086

PROJECT INFORMATION:

Land Use Zone R/A
 Occupancy Group R3
 Construction Type VN
 Fed Code 1A
 No. of stories: 1
 No. of rooms: 11
 Street width: 40
 1st Floor Area 2593
 2nd Floor Area *
 Basement _____
 Roof Material _____

AREA IN SQUARE FOOT OF:	EXISTING	NEW
Dwelling/Living	_____	<u>2988</u>
Garage/Storage	_____	<u>432</u>
Decks/Balconies	_____	<u>98</u>
Carports	_____	_____

SCOPE OF WORK: MP 2888/ 652X4
* BONUS ROOM PER PLANNING DIRECTORS SPECIAL PERMIT (395 SF.)

FOR OFFICE USE ONLY

- | | | |
|---|---|--|
| <input type="checkbox"/> Information above complete | <input type="checkbox"/> AR Flood Waiver required | <input type="checkbox"/> Planning Approval |
| <input type="checkbox"/> Violation files checked | <input type="checkbox"/> Flood Elevation Certificate Required | <input type="checkbox"/> Design Review Approval |
| <input type="checkbox"/> Standard setbacks | <input type="checkbox"/> Water Development Infill Area | <input type="checkbox"/> Special Fee Districts Apply : _____ |
| <input type="checkbox"/> County Sewer | | |

NEW STRUCTURES & ADDITIONS

❖ THE FOLLOWING MUST BE PROVIDED IN ORDER TO SUBMIT FOR PLAN REVIEW

- | | |
|--|--|
| <input type="checkbox"/> 2 COMPLETE PLANS, LEGIBLE & DRAWN TO SCALE
<input type="checkbox"/> 3 SETS IF PROJECT IS IN A DESIGN REVIEW AREA | ❖ <i>Plans to include: site plan, floor plan, elevations, roof/ceiling plan, foundation and structural framing details, and structural calculations for non-conforming structures.</i> |
| <input type="checkbox"/> Title 24 Energy Compliance documentation
<input type="checkbox"/> Grading and Erosion Control Questionnaire | <input type="checkbox"/> 11" x 17" copy of floor plan for County Assessor
<input type="checkbox"/> Plan Review Fees |

Date: _____ Received by: (staff) _____

ACTIVITY/PERMIT #
0104948

\$190,650³⁶

ENGEL INSULATION, INC.

CALIFORNIA CONTRACTOR'S LICENSE #745646

460 Roseville Road • Roseville, CA 95678

(916) 786-2088 / (916) 969-6191

THIS IS TO CERTIFY THAT INSULATION HAS BEEN INSTALLED IN CONFORMANCE WITH CURRENT ENERGY REGULATIONS; CALIFORNIA ADMINISTRATIVE CODE, TITLE 24, STATE OF CALIFORNIA, IN THE BUILDING LOCATED AT:

TRACT SOMERSET LOT 32/652xy
STREET _____ CITY SACRAMENTO

EXTERIOR WALLS: CT 2x4 3 1/2 13
MANUFACTURER CT THICKNESS 2x6 R-VALUE 6 1/4 R-VALUE 19

CEILING AREA: BATS
MANUFACTURER CT THICKNESS 12 R-VALUE 38

CEILING: BLOWN IN
MANUFACTURER INSUL-SHE THICKNESS 1 3/4 R-VALUE 38

SQUARE FOOTAGE 2150 NUMBER OF BAGS USED 49
~~Garage~~ Garage CH

MANUFACTURER CT THICKNESS 6 1/4 R-VALUE 19

EXTERIOR KNEEWALL:
MANUFACTURER CT THICKNESS 6 1/4 R-VALUE 19
INTERIOR KNEEWALL:
MANUFACTURER CT THICKNESS 6 1/4 R-VALUE 19

APPLIED CAULK & SEALANT TO ALL EXTERIOR OPENINGS & PENETRATIONS

YES NO

GENERAL CONTRACTOR _____
CALIFORNIA CONTRACTORS
LICENSE # _____ DATE _____

SIGNATURE _____ TITLE _____
INSULATION CONT. SIGNATURE Roseville TITLE Rec. Sec. Rep. Manager DATE 11/19/10

KwikKote

No. 200-004014

Stucco System Installation Card

Job Name: SOMERSET
Address: 1830 BAINES AVE.
 , CA
Lot #: 0000032

Stucco System Trade Name: KWIK KOTE
Stucco System Manufacturer: KWIK KOTE CORP.

ICBO Evaluation Service, Inc.
Report No. 3607
Date of Job Completion:

Home Builder: LENNAR RENAISSANCE
Address: 2240 DOUGLAS BLVD #250
 ROSEVILLE, CA

Stucco Contractor: KENYON PLASTERING, INC.
Address: PO BOX 2077
 North Highlands, CA

Telephone Number: 916/349-8191

Approved Contractor Number as
issued by the Stucco Manufacturer: 1001

Card Print Date: 09/24/2001

This is to certify that the stucco system on the building exterior at the above address had been installed in accordance with the evaluation report specified above and the manufacturer's instructions.



Signature of authorized representative of stucco contractor

2-14-02

Date

31
P=13.5

33
P=12.9

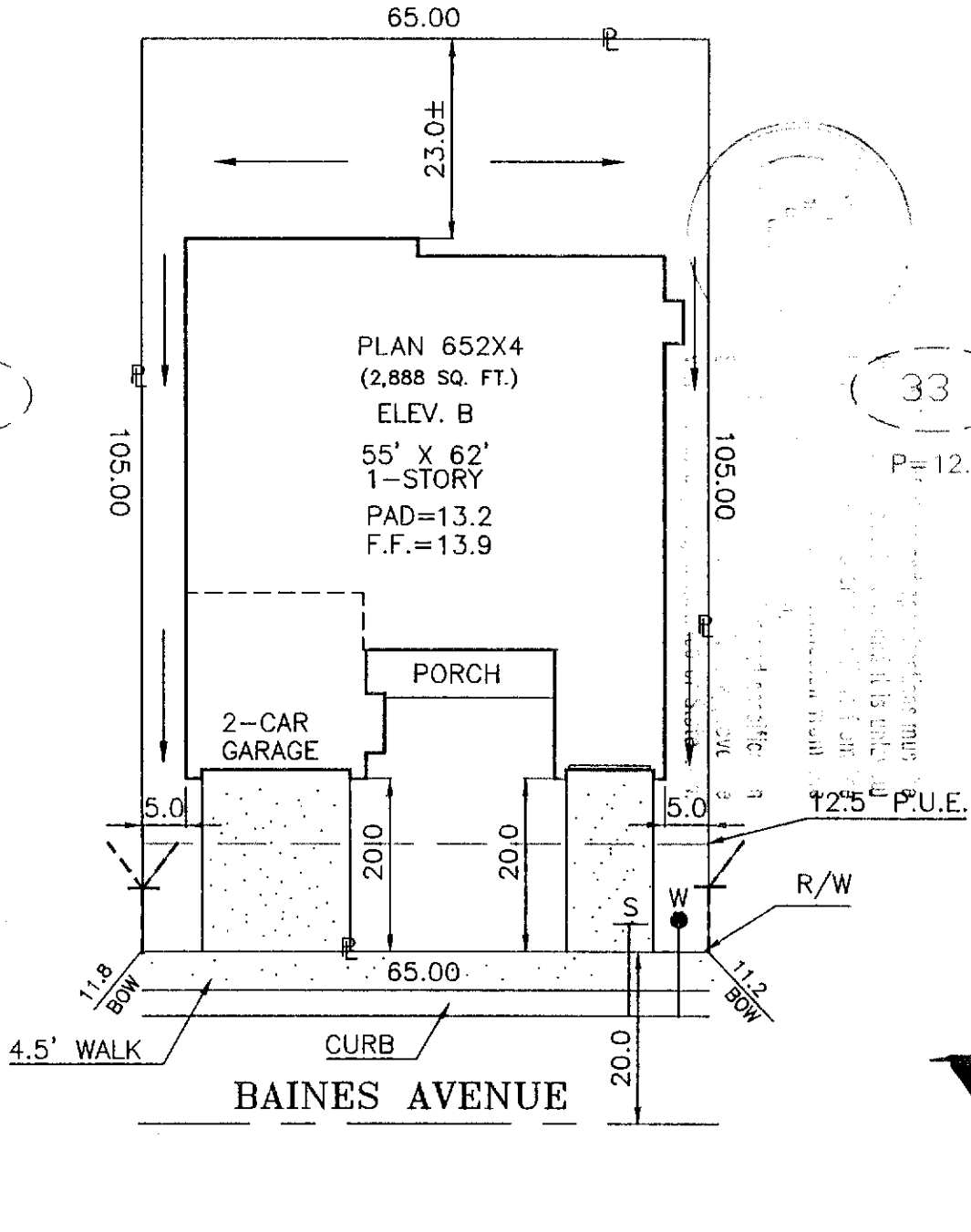

DIMENSIONS SHOWN ARE APPROXIMATE EXCEPT FOR MINIMUMS REQUIRED BY ORDINANCE.
THIS PLOT DOES NOT REFLECT AS BUILT CONDITIONS AND MAY VARY FROM THIS PLAN.

RENAISSANCE H O M E S 2240 DOUGLAS BLVD. SUITE 250, ROSEVILLE, CALIFORNIA 95661 PHONE (916) 773-4083 FAX (916) 773-4086	SOMERSET		PLOT PLAN NOTES:
	NORTHPOINTE PARK UNIT 12 CITY OF SACRAMENTO SACTO. COUNTY CALIFORNIA		
ADDRESS: 1830 BAINES AVENUE	LOT COV: 44.4 %	APN:	LOT 32
PLAN NO.: 652X4-B	LOT SQ. FT.: 6,825	REAR YARD COVERAGE: %	
DRAWN BY: R.P.	APPROVED BY:	DATE: 3/28/01 SCALE: 1"=20'	