

CITY OF SACRAMENTO
1231 I Street, Sacramento, CA 95814

Permit No: 9907470
Insp Area: 4

Site Address: 79 CAFARO CR SAC
Parcel No: GATEWAY WEST LOT 76

Sub-Type: NSFR
Housing (Y/N): N

CONTRACTOR
BEAZER HOMES
3009 DOUGLAS BL #150
ROSEVILLE CA 95661

OWNER

ARCHITECT

Nature of Work: MP 1973 1 STORY 8 ROOM SFR

CONSTRUCTION LENDING AGENCY: I hereby affirm under penalty of perjury that there is a construction lending agency for the performance of the work for which this permit is issued (Sec. 3097, Civ. C).

Lender's Name _____ Lender's Address _____

LICENSED CONTRACTORS DECLARATION: I hereby affirm under penalty of perjury that I am licensed under provisions of Chapter 9 (commencing with section 7000) of Division 3 of the Business and Professions Code and my license is in full force and effect.

License Class B License Number 721191 Date 7/13/99 Contractor Signature Sheryl Van Maeren

OWNER-BUILDER DECLARATION: I hereby affirm under penalty of perjury that I am exempt from the contractors License Law for the following reason (Sec. 7031.5, Business and Professions Code; any city or county which requires a permit to construct, alter, improve, demolish, or repair any structure, prior to its issuance, also requires the applicant for such permit to file a signed statement that he or she is licensed pursuant to the provisions of the Contractors License Law (Chapter 9 (commencing with Section 7000) of Division 8 of the Business and Professions Code) or that he or she is exempt therefrom and the basis for the alleged exemption. Any violation of Section 7031.5 by any applicant for a permit subjects the applicant to a civil penalty of not more than five hundred dollars (\$500.00);

____ I, as a owner of the property, or my employees with wages as their sole compensation, will do the work, and the structure is not intended or offered for sale (Sec. 7044, Business and Professional Code: The Contractors License Law does not apply to an owner of property who builds or improves thereon, and who does such work himself or herself or through his/her own employees, provided that such improvements are not intended or offered for sale. If, however, the building or improvement is sold within one year of completion, the owner-builder will have the burden of proving that he/she did not build or improve for the purpose of sale.)

____ I, as owner of the property, am exclusively contracting with licensed contractors to construct the project (Sec. 7044, Business and Professions Code: The Contractors License Law does not apply to an owner of property who builds or improves thereon, and who contracts for such projects with a contractor(s) licensed pursuant to the Contractors License Law).

____ I am exempt under Sec. _____ B & PC for this reason: _____

Date _____ Owner Signature _____

IN ISSUING THIS BUILDING PERMIT, the applicant represents, and the city relies on the representation of the applicant, that the applicant verified all measurements and locations shown on the application or accompanying drawings and that the improvement to be constructed does not violate any law or private agreement relating to permissible or prohibited locations for such improvements. This building permit does not authorize any illegal location of any improvement or the violation of any private agreement relating to location of improvements.

I certify that I have read this application and state that all information is correct. I agree to comply with all city and county ordinances and state laws relating to building construction and hereby authorize representative(s) of this city to enter upon the abovementioned property for inspection purposes.

Date 7/13/99 Applicant/Agent Signature Sheryl Van Maeren

WORKER'S COMPENSATION DECLARATION: I hereby affirm under penalty of perjury one of the following declarations:

____ I have and will maintain a certificate of consent to self-insure for workers' compensation as provided for by Section 3700 of the Labor Code, for the performance of work for which the permit is issued.

I have and will maintain workers' compensation insurance, as required by Section 3700 of the Labor Code, for the performance of the work for which this permit is issued. My workers' compensation insurance carrier and policy number are:

Carrier LIBERTY MUTUAL INS CO. Policy Number WA2-65D-004147-059 Exp Date 04/01/2000

____ (This section need not be completed if the permit is for \$100 or less) I certify that in the performance of the work for which this permit is issued, I shall not employ any person in any manner so as to become subject to the workers' compensation laws of California and agree that if I should become subject to the workers' compensation provisions of Section 3700 of the Labor Code, I shall forthwith comply with those provisions.

Date 7/13/99 Applicant Signature Sheryl Van Maeren

WARNING: FAILURE TO SECURE WORKER'S COMPENSATION COVERAGE IS UNLAWFUL AND SHALL SUBJECT AN EMPLOYER TO CRIMINAL PENALTIES AND CIVIL FINES UP TO ONE HUNDRED THOUSAND DOLLARS (\$100,000) IN ADDITION TO THE COST OF COMPENSATION, DAMAGES AS PROVIDED FOR IN SECTION 3706 OF THE LABOR CODE, INTEREST AND ATTORNEY'S FEE.

THIS PERMIT SHALL EXPIRE BY LIMITATION IF WORK IS NOT COMMENCED WITHIN 180 DAYS.

THIS PLAN IS PREPARED TO SHOW THE DIMENSIONAL RELATIONSHIP FROM BUILDING FOUNDATION TO PROPERTY LINE, DESIGN DRAINAGE CONTROL ELEVATIONS, AND DIRECTION OF DRAINAGE FLOW TO CONFORM WITH LOCAL ORDINANCES FOR THE PURPOSE OF BUILDING PERMIT ISSUANCE. INFORMATION SHOWN IS APPROXIMATE EXCEPT FOR THOSE SETBACKS WHICH ARE MINIMUMS REQUIRED BY ORDINANCE. THIS PLOT DOES NOT REFLECT AS BUILT CONDITIONS WHICH WILL LIKELY VARY FROM THIS PLAN.

ISSUED

JUL 12 1999

CITY OF SACRAMENTO
DEVELOPMENT SERVICES DIV

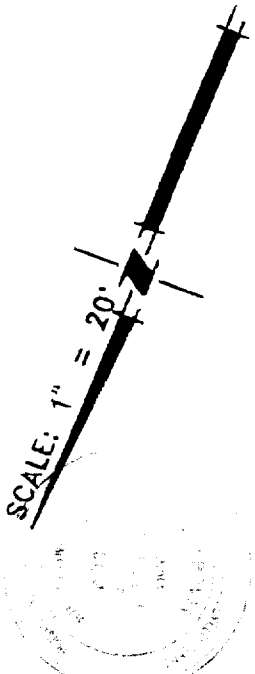

This set of plans and specifications must be kept on the job at all times and it is unlawful to make any changes or alterations from the same without written permission from the Planning Inspection Division.
The approval of this plan and specification shall NOT be held to permit or approve the violation of any City Ordinance or State Law.

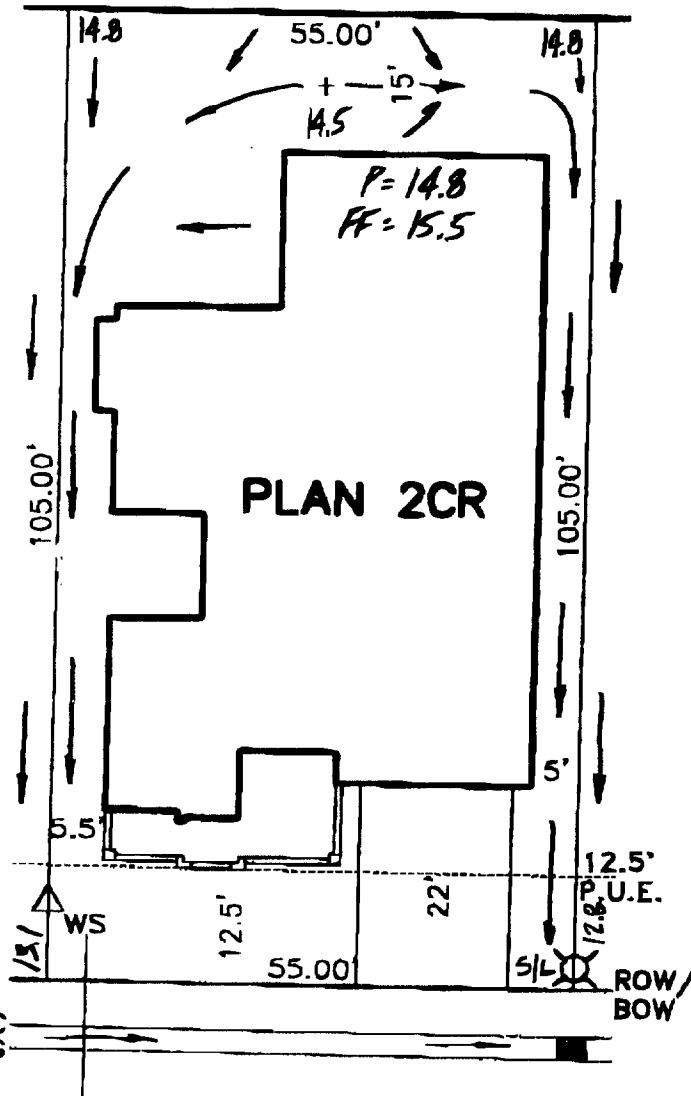

ROUTING/APPROVAL		
	✓	INITIALS
President		
Project Development		
Construction	✓	<i>[Signature]</i>
Marketing	✓	<i>[Signature]</i>
Admin.		
Accounting		

CAFARO CIRCLE

△ = UTILITY TRANSFORMER

LOT COVERAGE = 40%

PLOT PLAN
LOT 76
GATEWAY VILLAGE 2
FOR
BEAZER HOMES

SACRAMENTO CALIFORNIA

WOOD-RODGER INC.

DATE: MAY, 1999	DRAWN: P.D.M.	PROJECT NO: 99BEZ-022
--------------------	------------------	--------------------------

JWH 5-28-99

Natomas Unified School District

1515 Sports Drive, #1 • Sacramento, CA 95834-1905

Phone 916/641-3300 • Fax 916/928-1629

CERTIFICATION OF COMPLIANCE

SCHOOL DISTRICT DEVELOPMENT FEES

PART I: TO BE COMPLETED BY APPLICANT			
Property Owner's Name	Beazer Homes		
Owner's Address	3009 Douglas Blvd., Ste. 150, Roseville, CA. 95661		
Project Address	99 CAFARO CIR	Lot 76	
Parcel Number	225-0140-019		
Subdivision Name	Gateway West (Memories)		
Number of Units	1		
Print Applicant's Name	Sheryl Van Maren	Applicant's Signature	<i>Sheryl Van Maren</i>
Title of Applicant	Starts Coordinator		
Date	6/7/99	Telephone Number	773-3888
PART II: TO BE COMPLETED BY BUILDING DEPARTMENT			
Plan Identification Number	1973		
Building Type (Check One)	<input checked="" type="checkbox"/> Residential <input type="checkbox"/> Apartment/Condominium <input type="checkbox"/> Commercial/Industrial		
Square Feet of Chargeable Building Area	1973		
Signature	<i>[Signature]</i>		
Title		Date	7-8-99
PART III: TO BE COMPLETED BY NATOMAS UNIFIED SCHOOL DISTRICT			
District Certification Number	CC-0116		
Fees Collected:			
Residential:	1973 Sq. Ft. X \$ 4.57	= \$	9016.61
Apartment/Condominium:	Sq. Ft. X \$	= \$	
Commercial/Industrial:	Sq. Ft. X \$	= \$	
NOTICE TO APPLICANT: Pursuant to government code section 66020 (d), this will serve to notify you that the 90-day approval period in which you may protest the fees, or other payment identified above, will begin to run on the date in which the building or installation permit for this project is issued, or on which they are paid to the District, or to another public entity authorized to collect them on behalf of the District, whichever is earlier.			
Applicant Signature:	<i>Sheryl Van Maren</i>		Date: 6/7/99

This certification covers only the amount of square footage indicated above. Any additions or corrections to the square footage for this project will require an amendment to the Certificate of Compliance.

As the authorize Natomas Unified School District official, I hereby certify that the requirements of Government Code Section 95995 have been complied with by the above signed applicant.

SIGNATURE: *[Signature]* DATE: 7/8/99
TITLE: FI³ R¹

CERTIFICATION OF INSULATION

GENERAL

BEAZER

LOT # *76*

- P.O. BOX 854, WEST SACRAMENTO, CA 95691 LIC. #202026
- 1309 MELODY ROAD, MARYSVILLE, CA 95901 LIC. #202026
- P.O. BOX 9651, FRESNO, CA 93793-9651 LIC. #202026
- P.O. BOX 1631, RENO, NV 89505 LIC. #10675
- 3326 A PONDEROSA WAY, LAS VEGAS, NV 89118 LIC. #10675

MEMORIES

DATE INSULATION COMPLETED

PART II AREAS INSULATED

WALLS		CEILINGS			FLOORS	
(SQUARE FEET)		(SQUARE FEET)			(SQUARE FEET)	
TYPE OF INSULATION		TYPE OF INSULATION			TYPE OF INSULATION	
MATERIAL FIBERGLASS		MATERIAL FIBERGLASS			MATERIAL FIBERGLASS	
FORM BATTS		FORM BATTS & BLOW			FORM BATTS	
MANUFACTURER'S PRODUCT I D		MANUFACTURER'S PRODUCT I D			MANUFACTURER'S PRODUCT I D	
MANUFACTURER		MANUFACTURER			MANUFACTURER	
OCF		OCF			OCF	
		BAGS				
R - VALUE INSTALLED	APPLIED THICKNESS	R - VALUE INSTALLED	APPLIED THICKNESS	MIN. INSTALLED WEIGHT PER SQUARE FOOT	R - VALUE INSTALLED	APPLIED THICKNESS
<i>13</i>	<i>3 5/8"</i>	<i>38</i> <i>38</i>	<i>12 1/4"</i> <i>14 3/4"</i>			
KNEE WALLS IF R-VALUE IS OTHER THAN WALLS ABOVE						
MATERIAL FIBERGLASS		FORM BATTS		R VALUE		MANUFACTURER OCF
AIR INFILTRATION SEALANT						
MATERIAL <i>FOAM</i>				MANUFACTURER W R GRACE		

THIS IS TO CERTIFY THAT INSULATION AND/OR SEALANT HAS BEEN INSTALLED IN CONFORMANCE WITH APPLICABLE CODES, MATERIAL STANDARDS AND REGULATIONS.

SIGNATURE - INSULATION CONTRACTOR <i>[Signature]</i>	TITLE MANAGER	DATE <i>9-1-99</i>
SIGNATURE - GENERAL CONTRACTOR <i>[Signature]</i>	TITLE	DATE

REMARKS

COUNTY SANITATION DISTRICT NO. 1
SACRAMENTO REGIONAL COUNTY SANITATION DISTRICT

SEWER IMPACT FEE
PERMIT AND CALCULATION SHEET *gmv*

APPLICATION NO. *City* BLDG PERMIT NO. *City*

GENERAL INFORMATION THIS PERMIT GOOD ONLY WHEN VALIDATED BY THE CASHIER

NET 76 \$2,414.00
T: FROM 592870 07/07/99
RECEIPT 707822 071 \$2,414.00

33270 x 7/1/99

THIS PERMIT TO CONNECT EXPIRES ONE YEAR FROM DATE OF ISSUANCE

FEE CALCULATION BUILDING USE

INSPECTION	RESIDENTIAL	SF	RF	MF	UNITS
CSD-1	<input checked="" type="checkbox"/>	29.00			
SRCSD					
CONSTRUCTION		2,385.00			
IN-LIEU					
TOTAL FEE					2,414.00

APN: *225-0140-019*

DESCRIPTION / SUBDIVISION *Gateway West (Memorias)* LOT: *76*

PROPERTY ADDRESS *79 Cafaro Circle*

OWNER *Beazer Homes*

MAILING ADDRESS *3009 Douglas Blvd., Ste. 150*

CITY-STATE-ZIP *Roseville, Ca. 95061* PHONE *773-3888*

ADDITIONAL FEES MAY BE DUE IF CHANGES IN USE INCREASE SEWER IMPACT.

APPLICANT SIGNATURE *[Signature]*

CONSOLIDATED UTILITY BILLING USE ONLY

ACCT INPUT START

Kwik-Kote
STUCCO SYSTEM
INSTALLATION CARD

Job Address: *Beazer - Memorias Lot 76 79 Cafaro Cir SACRO*
 State Contractor: *John W. Kote*
 Approved Contractor Number: *990138-001*
 Telephone Number: *916-486-1111*
 Address: *North Highlands, CA 95663*
 PO Box 200
 Date of use: *8/24/99*
 Report No. *9-29-99*
 GSO Available from *9-29-99*
 Name: *Stucco Manufacturer: KWIK KOTE CORP*
 Signature of authorized representative of stucco contractor: *[Signature]*
 Date: *8/24/99*