

**CITY OF SACRAMENTO**  
1231 I Street, Sacramento, CA 95814

**Permit No: 0013583**  
**Insp Area: 4**

**Site Address: 3739 BROADLAND ST SAC**  
Parcel No: 225-1430-014  
N

Sub-Type: NSFR  
NATOMAS CROSSING UNIT 22 LOT 14  
Housing (Y/N):

**CONTRACTOR**  
RYLAND HOMES  
1380 LEAD HILL BLVD. STE 108  
ROSEVILLE CA 95661

**OWNER**

**ARCHITECT**

**Nature of Work: MP 2383 2 STORY 10 ROOM SFR**

**CONSTRUCTION LENDING AGENCY:** I hereby affirm under penalty of perjury that there is a construction lending agency for the performance of the work for which this permit is issued (Sec. 3097, Civ. C).

Lender's Name \_\_\_\_\_ Lender's Address \_\_\_\_\_

**LICENSED CONTRACTORS DECLARATION:** I hereby affirm under penalty of perjury that I am licensed under provisions of Chapter 9 (commencing with section 7000) of Division 3 of the Business and Professions Code and my license is in full force and effect.

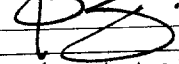
License Class B License Number 54648 Date 11.17.00 Contractor Signature 

**OWNER-BUILDER DECLARATION:** I hereby affirm under penalty of perjury that I am exempt from the contractors License Law for the following reason (Sec. 7031.5, Business and Professions Code: any city or county which requires a permit to construct, alter, improve, demolish, or repair any structure, prior to its issuance, also requires the applicant for such permit to file a signed statement that he or she is licensed pursuant to the provisions of the Contractors License Law (Chapter 9 (commencing with Section 7000) of Division 8 of the Business and Professions Code) or that he or she is exempt therefrom and the basis for the alleged exemption). Any violation of Section 7031.5 by any applicant for a permit subjects the applicant to a civil penalty of not more than five hundred dollars (\$500.00):

I, as a owner of the property, or my employees with wages as their sole compensation, will do the work, and the structure is not intended or offered for sale (Sec. 7044, Business and Professional Code: The Contractors License Law does not apply to an owner of property who builds or improves thereon, and who does such work himself or herself or through his/her own employees, provided that such improvements are not intended or offered for sale. If, however, the building or improvement is sold within one year of completion, the owner-builder will have the burden of proving that he/she did not build or improve for the purpose of sale.)

I, as owner of the property, am exclusively contracting with licensed contractors to construct the project (Sec. 7044, Business and Professions Code: The Contractors License Law does not apply to an owner of property who builds or improves thereon and who contracts for such projects with a contractor(s) licensed pursuant to the Contractors License Law).

**CITY OF SACRAMENTO**

I am exempt under Sec. \_\_\_\_\_ B & PC for this reason: \_\_\_\_\_  
Date \_\_\_\_\_ Owner Signature \_\_\_\_\_

NOV 17 2000

**NEIGHBORHOODS PLANNING & DEVELOPMENT SERVICES**

**IN ISSUING THIS BUILDING PERMIT,** the applicant represents, and the city relies on the representation, that the applicant verified all measurements and locations shown on the application or accompanying drawings and that the improvement to be constructed does not violate any law or private agreement relating to permissible or prohibited locations for such improvements. This building permit does not authorize any illegal location of any improvement or the violation of any private agreement relating to location of improvements.

I certify that I have read this application and state that all information is correct. I agree to comply with all city and county ordinances and state laws relating to building construction and hereby authorize representative(s) of this city to enter upon the abovementioned property for inspection purposes.

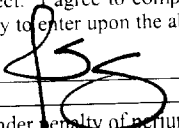
Date 11.17.00 Applicant/Agent Signature 

**WORKER'S COMPENSATION DECLARATION:** I hereby affirm under penalty of perjury one of the following declarations:  
I have and will maintain a certificate of consent to self-insure for workers' compensation as provided for by Section 3700 of the Labor Code, for the performance of work for which the permit is issued.

I have and will maintain workers' compensation insurance, as required by Section 3700 of the Labor Code, for the performance of the work for which this permit is issued. My workers' compensation insurance carrier and policy number are:

Carrier American Protection Policy Number 482003219-01 Exp Date 6.1.01

(This section need not be completed if the permit is for \$100 or less) I certify that in the performance of the work for which this permit is issued, I shall not employ any person in any manner so as to become subject to the workers' compensation laws of California and agree that if I should become subject to the workers' compensation provisions of Section 3700 of the Labor Code, I shall forthwith comply with those provisions.

Date 11.17.00 Applicant Signature 

**WARNING: FAILURE TO SECURE WORKER'S COMPENSATION COVERAGE IS UNLAWFUL AND SHALL SUBJECT AN EMPLOYER TO CRIMINAL PENALTIES AND CIVIL FINES UP TO ONE HUNDRED THOUSAND DOLLARS (\$100,000) IN ADDITION TO THE COST OF COMPENSATION, DAMAGES AS PROVIDED FOR IN SECTION 3706 OF THE LABOR CODE, INTEREST AND ATTORNEY'S FEE.**

**THIS PERMIT SHALL EXPIRE BY LIMITATION IF WORK IS NOT COMMENCED WITHIN 180 DAYS.**

RESIDENTIAL SUBDIVISION BUILDING PERMIT APPLICATION

114

Project Address: 3739 BROADLAND CT  
Lot Number: 114

Assessor Parcel # 13583  
Subdivision Natomas Crossing Unit# 22  
225-1430014

OWNER INFORMATION:

Legal Property Owner: Ryland Homes Phone# 784-1330#14  
Owner Address: 1380 Lead Hill Rd. City Roseville State CA Zip 95661

CONTRACTOR INFORMATION:

Contractor: Ryland Homes Lic. # 54648 Phone # 784-1330#14 Fax 784-9805

PROJECT INFORMATION: Plan Four MP 2383

Land Use Zone RIA Occupancy Group R3 Construction Type VN Fed Code IA  
No. of Stories: 2 No. of Rooms: 10 Street Width: 41'  
1<sup>st</sup> Floor Area 1238 2<sup>nd</sup> Floor Area 1145 Basement \_\_\_\_\_ Roof Material Tile  
AREA IN SQUARE FOOT OF:  
Dwelling/Living 2383  
Garage/Storage 625  
Decks/Balconies \_\_\_\_\_  
Carports \_\_\_\_\_  
SCOPE OF WORK: SFD.

FOR OFFICE USE ONLY

- Information Above Complete
- Violation Files Checked
- Standard Setbacks
- County Sewer
- AR Flood Waiver Required
- Flood Elevation Certificate Required
- Water Development Infill Area
- Planning Approval
- Design Review Approval
- Special Fee Districts Apply:

THE FOLLOWING MUST BE PROVIDED IN ORDER TO SUBMIT FOR PERMIT

- 2 COMPLETE PLOT PLANS, LEGIBLE & DRAWN TO SCALE
- 11 X 17 COPY OF FLOOR PLAN WITH FOLLOWING INFORMATION
  - a) Assessor's Parcel Number
  - b) New Floor Area
  - c) Owners Name
  - d) Project Address

Date: \_\_\_\_\_ Received by: (staff) \_\_\_\_\_ Permit # \_\_\_\_\_



# WesPac

## insulation

MASCO Company



809 North Market Blvd., Ste. 11 • Sacramento, CA 95834

(916) 927-7149 • Fax (916) 927-4257

Lic. #487478

### Installed Insulation Certificate

We certify that the building insulation listed herein is installed in conformance with current energy conservation regulations, California Administrative Code, Title 24, State of California

RICTOR	AREA	TYPE	INCHES/BAGS (BLOWN)
R38	Ceiling	fiberglass blow	
R38	Ceiling	fiberglass batt	
R13	Ext. wall	fiberglass batt	

Certified by Jimmy Timoney

Title W. P. 2102

PROJECT NO. W. P. 2102  
PROPERTY HERITAGE / ID#  
Address or Lot Number

Date Installed

Natomas Unified School District  
1515 Sports Drive, #1 • Sacramento, CA 95834-1905  
Phone 916/641-3300 • Fax 916/928-1629

**CERTIFICATION OF COMPLIANCE**

**SCHOOL DISTRICT DEVELOPMENT FEES**

**PART I: TO BE COMPLETED BY APPLICANT**

Property Owner's Name **Ryland Homes**

Owner's Address **1380 Lead Hill Rd #108 Roseville, CA 95661**

Project Address **373A BROADLAND ST.**

Parcel Number

Subdivision Name **Natomas Crossing Unit# 22**

Number of Units **ONE**

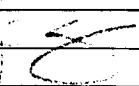
Print Applicant's Name **Linda Steinfeldt** Applicant's Signature 

Title of Applicant **Subdivision Manager**

Date **11-8-00** Telephone Number **916-784-1336 X14**

**PART II: TO BE COMPLETED BY BUILDING DEPARTMENT**

Plan Identification Number **2383**

Building Type (Check One)  
 Residential       Apartment/Condominium       Commercial/Industrial

Square Feet of Chargeable Building Area **2383**

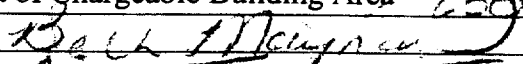
Signature  Date **11/15/00**

Title **Asst. Dir.**

**PART III: TO BE COMPLETED BY NATOMAS UNIFIED SCHOOL DISTRICT**

District Certification Number	<b>01-967</b>		
Fees Collected:			
Residential:	<b>2383</b>	Sq. Ft. X \$ <b>3.25</b>	= \$ <b>7744.75</b>
Apartment/Condominium:		Sq. Ft. X \$	= \$
Commercial/Industrial:		Sq. Ft. X \$	= \$

**NOTICE TO APPLICANT:** Pursuant to government code section 66020 (d), this will serve to notify you that the 90-day approval period in which you may protest the fees, or other payment identified above, will begin to run on the date in which the building or installation permit for this project is issued, or on which they are paid to the District, or to another public entity authorized to collect them on behalf of the District, whichever is earlier.

Applicant Signature:  Date: **11-16-00**

This certification covers only the amount of square footage indicated above. Any additions or corrections to the square footage for this project will require an amendment to the Certificate of Compliance.

As the authorize Natomas Unified School District official, I hereby certify that the requirements of Government Code Section 95995 have been complied with by the above signed applicant.

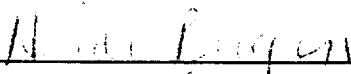
SIGNATURE:  DATE: **11/15/00**

TITLE: **Asst. Dir.**

114

COUNTY SANITATION DISTRICT NO. 1  
 SACRAMENTO REGIONAL COUNTY SANITATION DISTRICT  
**SEWER IMPACT FEE**  
 PERMIT AND CALCULATION SHEET

*EFF*  
 11-14-00

APPLICATION NO:		BLDG PERMIT NO: <i>017Y</i>	
GENERAL INFORMATION		THIS PERMIT GOOD ONLY WHEN VALIDATED BY THE CASHIER	
		<i>265016 EFB</i>	
		<i>11-14-00</i>	
THIS PERMIT TO CONNECT EXPIRES ONE YEAR FROM DATE OF ISSUANCE		BUILDING USE	
FEE CALCULATION		RESIDENTIAL SF <input checked="" type="checkbox"/> MF <input type="checkbox"/>	
INSPECTION		COMMERCIAL USE	UNITS
CSD-1	<b>473</b>		
SRCSD	<b>2404</b>		
CONSTRUCTION			
IN-LIEU			
<b>TOTAL FEE</b>	<b>2877</b>		
APN:	<b>225-1250-023</b>		
DESCRIPTION/ SUBDIVISION	<b>Natomas Crossing Unit 22</b>	LOT:	<b>114</b>
PROPERTY ADDRESS	<b>3739 <del>Brookdale</del> St</b>		
OWNER	<b>Ryland Homes</b>		
MAILING ADDRESS	<b>1380 Lead Hill Rd. #108</b>		
CITY-STATE-ZIP	<b>Roseville, CA</b>	PHONE	<b>916-784-1330#14</b>
ADDITIONAL FEES MAY BE DUE IF CHANGES IN USE INCREASE SEWER IMPACT.			
APPLICANT SIGNATURE	<i>Linda Steinfeldt</i>		
CONSOLIDATED UTILITY BILLING USE ONLY			
ACCT	INPUT	START	

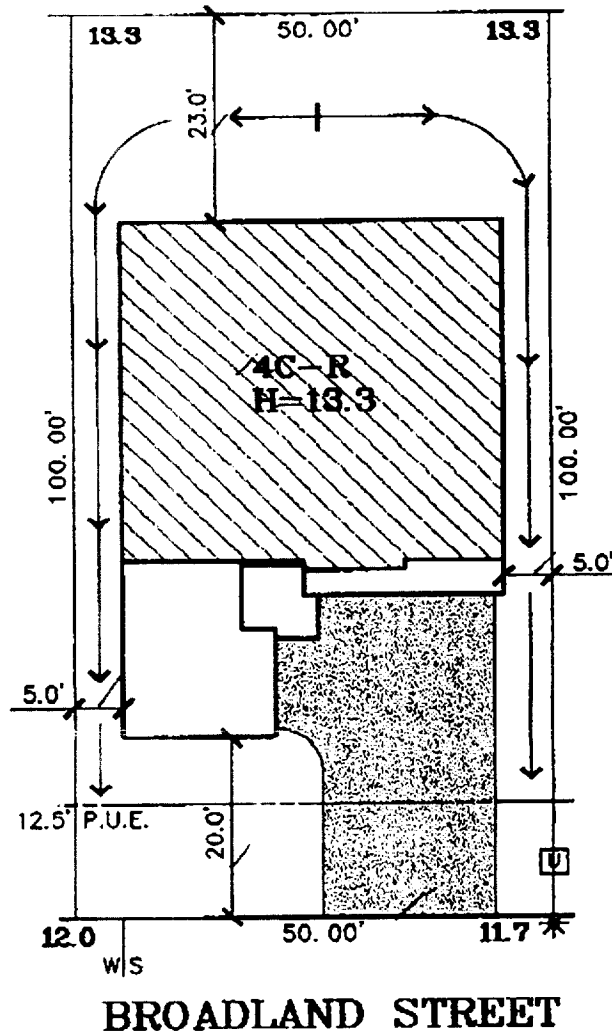

This set of plans and specifications must be kept on the job at all times and it is unlawful to make any changes or alterations from the same without written permission from the Building Inspector. This set of plans and specifications must be kept on the job at all times and it is unlawful to make any changes or alterations from the same without written permission from the Building Inspector.

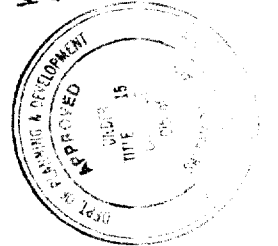

**LEGEND**

- PUBLIC UTILITY EASEMENT
- S SEWER SERVICE
- W WATER SERVICE
- ☐ UTILITY BOX
- \* STREET LIGHT
- ▣ DRAIN INLET
- ◆ FIRE HYDRANT

DATE: 11-2-00  
 LOT AREA: 5,000 SF  
 LOT COVERAGE: 37%

THIS PLAN IS PREPARED TO SHOW THE DIMENSIONAL RELATIONSHIP FROM BUILDING FOUNDATION TO PROPERTY LINE, DESIGN DRAINAGE CONTROL ELEVATIONS, AND DIRECTION OF DRAINAGE FLOW TO CONFORM WITH LOCAL ORDINANCES FOR THE PURPOSE OF BUILDING PERMIT ISSUANCE. INFORMATION SHOWN IS APPROXIMATE EXCEPT FOR THOSE SETBACKS WHICH ARE MINIMUMS REQUIRED BY ORDINANCE. THIS PLOT PLAN DOES NOT REFLECT AS BUILT CONDITIONS WHICH WILL LIKELY VARY FROM THIS PLAN.

**The Splink Corporation**  
 2590 VENTURE OAKS WAY  
 SACRAMENTO, CA. 95833  
 PH:(916)925-5550 FAX:(916)921-9274

NATOMAS CROSSING  
 VILLAGE 22  
 3739 BROADLAND ST.  
 A.P.N.:  
 LOT 14  
 PLAN 4C

**RYLAND HERITAGE**  
 CITY OF SACRAMENTO, CA.  
 CLIENT: RYLAND HOMES  
 CONTACT: LINDA STEINFELDT  
 PHONE: 916-784-1330  
 JOB NO.: 7684-003