

**CITY OF SACRAMENTO**  
1231 I Street, Sacramento, CA 95814

**Permit No: 0108245**  
**Insp Area: 4**

**Site Address: 5100 ALDERBERRY WY SAC**  
Parcel No: 201-0420-058  
N

NORTHBOROUGH VIL 5-2 LOT 20

Sub-Type: NSFR  
Housing (Y/N):

**CONTRACTOR**  
CENTEX HOMES  
4300 DOUGLAS BLVD  
STE. 210 95661

**OWNER**

**ARCHITECT**

**Nature of Work: NSFR MP1773 1 STORY 8 RMS**

**CONSTRUCTION LENDING AGENCY:** I hereby affirm under penalty of perjury that there is a construction lending agency for the performance of the work for which this permit is issued (Sec. 7097, Civ. Code)

Lender's Name \_\_\_\_\_ Lender's Address \_\_\_\_\_

**LICENSED CONTRACTORS DECLARATION:** I hereby affirm under penalty of perjury that I am licensed under provisions of Chapter 9 (commencing with section 7000) of Division 8 of the Business and Professions Code and my license is in full force and effect.

License Class F License Number 734094 Date \_\_\_\_\_ Contractor Signature Denise Steiner

**OWNER-BUILDER DECLARATION:** I hereby affirm under penalty of perjury that I am exempt from the contractors License Law for the following reason (Sec. 7031.5, Business and Professions Code, any city or county which requires a permit to construct, alter, improve, demolish, or repair any structure, prior to its issuance, also requires the applicant for such permit to file a signed statement that he or she is licensed pursuant to the provisions of the Contractors License Law (Chapter 9 (commencing with Section 7000) of Division 8 of the Business and Professions Code) or that he or she is exempt therefrom and the basis for the alleged exemption). Any violation of Section 7031.5 by any applicant for a permit subjects the applicant to a civil penalty of not more than five hundred dollars (\$500.00).

I, as a owner of the property, or my employees with wages as their sole compensation, will do the work, and the structure is not intended or offered for sale (Sec. 7044, Business and Professional Code). The Contractors License Law does not apply to an owner of property who builds or improves thereon, and who does such work himself or herself or through his/her own employees, provided that such improvements are not intended or offered for sale. If, however, the building or improvement is sold within one year of completion, the owner-builder will have the burden of proving that he/she did not build or improve for the purpose of sale.

I, as owner of the property, am exclusively contracting with licensed contractors to construct the project (Sec. 7044, Business and Professions Code). The Contractors License Law does not apply to an owner of property who builds or improves thereon, and who contracts for such projects with a contractor(s) licensed pursuant to the Contractors License Law.

I am exempt under Sec. \_\_\_\_\_ B & P.C. for this reason: \_\_\_\_\_

Date \_\_\_\_\_ Owner Signature \_\_\_\_\_

**IN ISSUING THIS BUILDING PERMIT,** the applicant represents, and the city hereby certifies to the applicant, that the applicant verified all measurements and locations shown on the application or accompanying drawings and that the improvement to be constructed does not violate any law or private agreement relating to permissible or prohibited locations for such improvements. This building permit does not authorize any illegal location of any improvement or the violation of any private agreement relating to location of improvements.

I certify that I have read this application and state that all information is correct. I agree to comply with all city and county ordinances and state laws relating to building construction and hereby authorize representative(s) of this city to enter upon the abovementioned property for inspection purposes.

Date \_\_\_\_\_ Applicant-Agent Signature \_\_\_\_\_

**WORKER'S COMPENSATION DECLARATION:** I hereby affirm under penalty of perjury one of the following declarations:

I have and will maintain a certificate of consent to self-insure for workers' compensation as provided for by Section 3700 of the Labor Code, for the performance of work for which the permit is issued.

I have and will maintain workers' compensation insurance, as required by Section 3700 of the Labor Code, for the performance of the work for which this permit is issued. My workers' compensation insurance carrier and policy number are:

Carrier AMERICAN GUARANTEE & LIABILITY Policy Number WC8322096-02 Exp Date 10/01/2000

(This section need not be completed if the permit is for \$100 or less) I certify that in the performance of the work for which this permit is issued, I shall not employ any person in any manner so as to become subject to the workers' compensation laws of California and agree that if I should become subject to the workers' compensation provisions of Section 3700 of the Labor Code, I shall forthwith comply with those provisions.

Date \_\_\_\_\_ Applicant Signature \_\_\_\_\_

**WARNING: FAILURE TO SECURE WORKER'S COMPENSATION COVERAGE IS UNLAWFUL AND SHALL SUBJECT AN EMPLOYER TO CRIMINAL PENALTIES AND CIVIL FINES UP TO ONE HUNDRED THOUSAND DOLLARS (\$100,000) IN ADDITION TO THE COST OF COMPENSATION, DAMAGES AS PROVIDED FOR IN SECTION 3706 OF THE LABOR CODE, INTEREST AND ATTORNEY'S FEE.**

**THIS PERMIT SHALL EXPIRE BY LIMITATION IF WORK IS NOT COMMENCED WITHIN 180 DAYS.**

**RESIDENTIAL BUILDING PERMIT APPLICATION**

New Construction

Addition

Remodels

Other

2

Project Address: 5100 Alderberry Way

Assessor Parcel # 201-0420-

**OWNER INFORMATION:**

Lot 20

8245

Legal Property Owner: Center Homes

Phone # 786-8693

Owner Address: 3700 Douglas Blvd #150 City Roseville

State CA Zip 95661

**CONTRACTOR INFORMATION:**

Contractor: Center Homes Lic. # 734094

Phone # 786-8693 Fax# 786-6802

**PROJECT INFORMATION:**

Land Use Zone RIA

Occupancy Group R3

Construction Type VN

Fed Code 1A

No. of stories: 1

No. of rooms: \_\_\_\_\_

Street width: \_\_\_\_\_

1<sup>st</sup> Floor Area 1773

2<sup>nd</sup> Floor Area \_\_\_\_\_

Basement \_\_\_\_\_

Roof Material \_\_\_\_\_

**AREA IN SQUARE FOOT OF:**

~~EXISTING~~

NEW

Dwelling/Living \_\_\_\_\_

1773

Garage/Storage \_\_\_\_\_

472

Decks/Balconies \_\_\_\_\_

Carports \_\_\_\_\_

SCOPE OF WORK: MP 1773

New SFR

**FOR OFFICE USE ONLY**

Information above complete

AR Flood Waiver required

Planning Approval

Violation files checked

Flood Elevation Certificate Required

Design Review Approval

Standard setbacks

Water Development Infill Area

Special Fee Districts Apply : \_\_\_\_\_

County Sewer

**NEW STRUCTURES & ADDITIONS**

◆ THE FOLLOWING MUST BE PROVIDED IN ORDER TO SUBMIT FOR PLAN REVIEW

2 COMPLETE PLANS, LEGIBLE & DRAWN TO SCALE

◆ Plans to include: site plan, floor plan, elevations, roof/ceiling plan, foundation and structural framing details, and structural calculations for non-conforming structures.

3 SETS IF PROJECT IS IN A DESIGN REVIEW AREA

Title 24 Energy Compliance documentation

11" x 17" copy of floor plan for County Assessor

Grading and Erosion Control Questionnaire

Plan Review Fees

Date: \_\_\_\_\_

Received by: (staff) \_\_\_\_\_

ACTIVITY/PERMIT # \_\_\_\_\_

**INSULATION CERTIFICATE**

**THIS IS TO CERTIFY THAT INSULATION HAS BEEN INSTALLED IN CONFORMANCE WITH THE CURRENT ENERGY REGULATIONS, CALIFORNIA ADMINISTRATION CODE, TITLE 24, STATE OF CALIFORNIA, IN THE BUILDING LOCATED AT:**

**SITE ADDRESS:** LOT 220 NORTHBOROUGH NATOMAS CA  
NUMBER STREET CITY STATE

**CEILINGS:**

**BLOW:** MANUFACTURER GREENSTONE THICKNESS 10.3" R/VALUE 38  
SQUARE FEET 1583 # BAGS/LBS PER BAGS 55

**BATTS:** MANUFACTURER JOHNS MANVILLE THICKNESS 13 R/VALUE 38  
JOHNS MANVILLE

**EXTERIOR WALLS:**

MANUFACTURER JOHNS MANVILLE THICKNESS 3.5" R/VALUE 13  
JOHNS MANVILLE

**FLOOR INSULATION:**

MANUFACTURER JOHNS MANVILLE THICKNESS N/A R/VALUE N/A

**AIR INFILTRATION: (TITLE 24)**

YES XX NO \_\_\_\_\_

**OTHER:** \_\_\_\_\_  
\_\_\_\_\_

**GENERAL CONTRACTOR:** CENTEX HOMES LICENSE# \_\_\_\_\_

**BY:** \_\_\_\_\_ TITLE: \_\_\_\_\_ DATE \_\_\_\_\_

**INSULATION CONTRACTOR:** WESTERN INSULATION L.P. LICENSE 794484

**BY:** *[Signature]* TITLE: AUTH. AGENT DATE 11/16/01

**CENTEX HOMES**

3700 Douglas Blvd.  
Suite #180  
Roseville, California, 95661

Phone: 916 786-6802  
Fax: 916 786-6802

March 27, 2001

City of Sacramento  
Building Department  
1231 I Street, Suite 200  
Sacramento, California 95814

Re: Northpointe / Northborough  
Lot: 220  
Address: 5100 Alderburg Wy

Dear Building Inspector:

This letter is to serve as a guarantee that Centex Homes will complete the front yard landscaping, on the above referenced lot. This shall be completed within 30 days from the close of escrow.

The delay is due to heavy rains last month, which has prevented us from completing the landscaping prior to the close of escrow.

We thank you for your cooperation in this matter.

Respectfully,

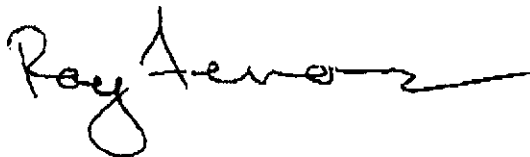

Ray Ferrarini  
Area Construction Manager  
Centex Homes, Sacramento Division

Cc: File

Lot Area = 6,189 sf  
 Building Footprint = 2,314 sf  
 Grass Coverage = 37.4%  
 Porch Allowance = 69 sf  
 Net Coverage = 36.3%

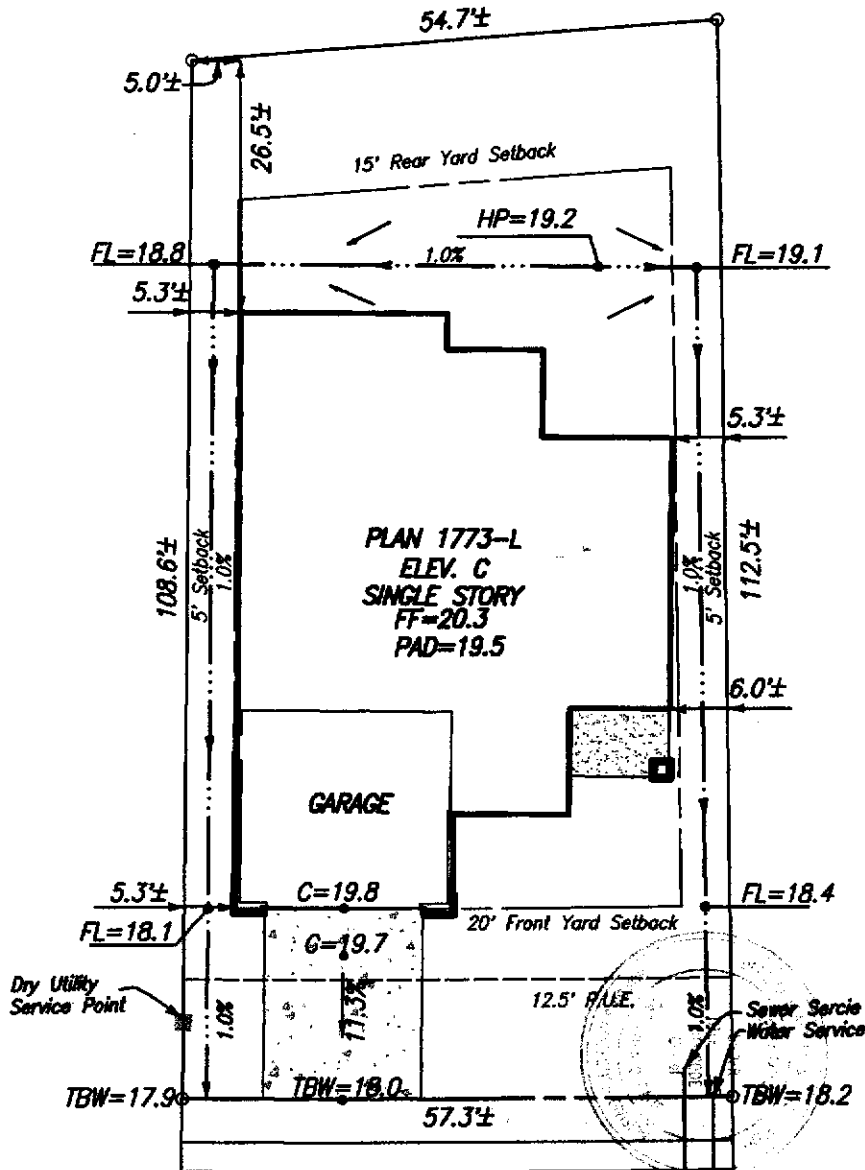
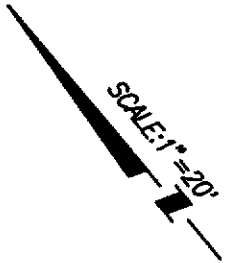

5100 ALDERBERRY WAY

This set of plans and specifications shall be held in full force and effect until the City of Sacramento, California, has approved this plan and operation. It shall not be held to permit or approve the violation of any City Ordinance or State Law.

Plot Plan for Lot 20  
 Northborough Village 5-2  
 City of Sacramento

**Centex Homes**  
 3700 Douglas Blvd., Suite 150  
 Roseville, CA 95661  
 Ph.: (916) 786-8693

Plan 1773 Rev. C  
**Centex Review & Approval:**  
 By: *[Signature]* Date: 4/23

**Note:**  
 This plot plan has been prepared for the purpose of showing the building foundation relationship to the property line, proposed drainage elevations and direction of flow to conform to local ordinances and for the purpose of building permit issuance. Information shown is approximate except for those setbacks which are minimums required by ordinance. This plot does not reflect as-built conditions which will likely vary from this plan.

**Murray Smith & Associates Engineering, Inc.**  
 3110 Gold Canal Drive  
 Rancho Cordova, CA 95670  
 Ph.: (916) 635-1511

April 16, 2001 PN: 99030