

**CITY OF SACRAMENTO**  
1231 I Street, Sacramento, CA 95814

**Permit No: 0318841**  
**Insp Area: 4**  
**Thos Bros: 257-C4**

**Site Address: 471 PELICAN BAY CR SAC**  
Parcel No: 201-0730-074  
N

**HERITAGE @ NATOMAS PARK 1B LOT 12**  
Sub-Type: NSFR  
Housing (Y/N):

CONTRACTOR  
US HOME  
2366 GOLD MEADOW DR STE 100  
GOLD RIVER, CA 95670 77041

OWNER

ARCHITECT

**Nature of Work: MP1538 1 STORY 6 ROOM SFR**

**CONSTRUCTION LENDING AGENCY :** I hereby affirm under penalty of perjury that there is a construction lending agency for the performance of the work for which this permit is issued (Sec. 3097, Civ. C).

Lender's Name \_\_\_\_\_ Lender's Address \_\_\_\_\_

**LICENSED CONTRACTORS DECLARATION:** I hereby affirm under penalty of perjury that I am licensed under provisions of Chapter 9 (commencing with section 7000) of Division 3 of the Business and Professions Code and my license is in full force and effect.

License Class B License Number 451839 Date 12/15/13 Contractor Signature Don McClary

**OWNER-BUILDER DECLARATION:** I hereby affirm under penalty of perjury that I am exempt from the contractors License Law for the following reason (Sec. 7031.5, Business and Professions Code; any city or county which requires a permit to construct, alter, improve, demolish, or repair any structure, prior to its issuance, also requires the applicant for such permit to file a signed statement that he or she is licensed pursuant to the provisions of the Contractors License Law (Chapter 9 (commencing with Section 7000) of Division 8 of the Business and Professions Code) or that he or she is exempt therefrom and the basis for the alleged exemption. Any violation of Section 7031.5 by any applicant for a permit subjects the applicant to a civil penalty of not more than five hundred dollars (\$500.00);

\_\_\_\_ I, as a owner of the property, or my employees with wages as their sole compensation, will do the work, and the structure is not intended or offered for sale (Sec. 7044, Business and Professional Code: The Contractors License Law does not apply to an owner of property who builds or improves thereon, and who does such work himself or herself or through his/her own employees, provided that such improvements are not intended or offered for sale. If, however, the building or improvement is sold within one year of completion, the owner-builder will have the burden of proving that he/she did not build or improve for the purpose of sale.)

\_\_\_\_ I, as owner of the property, am exclusively contracting with licensed contractors to construct the project (Sec. 7044, Business and Professions Code: The Contractors License Law does not apply to an owner of property who builds or improves thereon, and who contracts for such projects with a contractor(s) licensed pursuant to the Contractors License Law).

\_\_\_\_ I am exempt under Sec. \_\_\_\_\_ B & PC for this reason: \_\_\_\_\_

Date \_\_\_\_\_ Owner Signature \_\_\_\_\_

**IN ISSUING THIS BUILDING PERMIT,** the applicant represents, and the city relies on the representation of the applicant, that the applicant verified all measurements and locations shown on the application or accompanying drawings and that the improvement to be constructed does not violate any law or private agreement relating to permissible or prohibited locations for such improvements. This building permit does not authorize any illegal location of any improvement or the violation of any private agreement relating to location of improvements.

I certify that I have read this application and state that all information is correct. I agree to comply with all city and county ordinances and state laws relating to building construction and hereby authorize representative(s) of this city to enter upon the abovementioned property for inspection purposes.

Date 12/15/13 Applicant/Agent Signature Don McClary

**WORKER'S COMPENSATION DECLARATION:** I hereby affirm under penalty of perjury one of the following declarations:

\_\_\_\_ I have and will maintain a certificate of consent to self-insure for workers' compensation as provided for by Section 3700 of the Labor Code, for the performance of work for which the permit is issued.

I have and will maintain workers' compensation insurance as required by Section 3700 of the Labor Code, for the performance of the work for which this permit is issued. My workers' compensation insurance carrier and policy number are:

Carrier OLD REPUBLIC INS. CO. Policy Number MWC10815000 Exp Date 11/01/2003

\_\_\_\_ (This section need not be completed if the permit is for \$100 or less) I certify that in the performance of the work for which this permit is issued, I shall not employ any person in any manner so as to become subject to the workers' compensation laws of California and agree that if I should become subject to the workers' compensation provisions of Section 3700 of the Labor Code, I shall forthwith comply with those provisions.

Date 12/15/13 Applicant Signature Don McClary

**WARNING: FAILURE TO SECURE WORKER'S COMPENSATION COVERAGE IS UNLAWFUL AND SHALL SUBJECT AN EMPLOYER TO CRIMINAL PENALTIES AND CIVIL FINES UP TO ONE HUNDRED THOUSAND DOLLARS (\$100,000) IN ADDITION TO THE COST OF COMPENSATION, DAMAGES AS PROVIDED FOR IN SECTION 3706 OF THE LABOR CODE, INTEREST AND ATTORNEY'S FEE.**

**THIS PERMIT SHALL EXPIRE BY LIMITATION IF WORK IS NOT COMMENCED WITHIN 180 DAYS.**

## RESIDENTIAL SUBDIVISION BUILDING PERMIT APPLICATION

Project Address: 471 Pelican Bay Cir. Assessor Parcel # 201-0730-074  
 Lot Number: 12 Subdivision Heritage @ Natomas Park Village 1B

### OWNER INFORMATION:

Legal Property Owner: <u>US Home</u>	Phone# <u>(916) 858-3900</u>
Owner Address <u>2366 Gold Meadow Way</u>	City <u>Gold River</u> State <u>ca</u> Zip <u>95670</u>

### CONTRACTOR INFORMATION:

Contractor: <u>US Home</u>	Lic. # <u>451839</u>	Phone # <u>(916) 858-3900</u>	Fax <u>(916) 858-3925</u>
----------------------------	----------------------	-------------------------------	---------------------------

Don McCloskey (916) 719-9050

3

### PROJECT INFORMATION:

Land Use Zone <u>RIA</u>	Occupancy Group <u>R3</u>	Construction Type <u>VN</u>	Fed Code <u>1A</u>
No. of Stories: <u>1</u>	No. of Rooms: _____	Street Width: _____	
1 <sup>st</sup> Floor Area <u>1538</u>	2 <sup>nd</sup> Floor Area _____	Basement _____	Roof Material _____

AREA IN SQUARE FOOT OF:

Dwelling/Living	<u>1538</u>
Garage/Storage	<u>456</u>
Decks/Balconies	_____
Carpports	_____

SCOPE OF WORK: \_\_\_\_\_

- |  |  |  |
|--|--|--|
| <p style="font-size: small; margin: 0;">FOR OFFICE USE ONLY</p> <ul style="list-style-type: none"> <li><input type="checkbox"/> Information Above Complete</li> <li><input type="checkbox"/> Violation Files Checked</li> <li><input type="checkbox"/> Standard Setbacks</li> <li><input type="checkbox"/> County Sewer</li> </ul> | <ul style="list-style-type: none"> <li><input type="checkbox"/> AR Flood Waiver Required</li> <li><input type="checkbox"/> Flood Elevation Certificate Required</li> <li><input type="checkbox"/> Water Development Infill Area</li> </ul> | <ul style="list-style-type: none"> <li><input type="checkbox"/> Planning Approval</li> <li><input type="checkbox"/> Design Review Approval</li> <li><input type="checkbox"/> Special Fee Districts Apply:</li> </ul> |
|--|--|--|

--THE FOLLOWING MUST BE PROVIDED IN ORDER TO SUBMIT FOR PERMIT--

- 2 COMPLETE PLOT PLANS, LEGIBLE & DRAWN TO SCALE
- 11 X 17 COPY OF FLOOR PLAN WITH FOLLOWING INFORMATION
 

a) Assessor's Parcel Number	c) Owners Name
b) New Floor Area	d) Project Address

THIS PLAN IS PREPARED TO SHOW THE DIMENSIONAL RELATIONSHIP FROM BUILDING FOUNDATION TO PROPERTY LINES, DRAINAGE CONTROL ELEVATIONS AND DIRECTION OF DRAINAGE FLOW. THIS IS DONE TO CONFORM TO LOCAL ORDINANCES FOR THE PURPOSE OF BUILDING PERMIT ISSUANCE. INFORMATION SHOWN ON THIS PLAN IS APPROXIMATE EXCEPT FOR MINIMUM SETBACKS WHICH ARE REQUIRED BY LOCAL ORDINANCE. THIS PLAN DOES NOT REFLECT AS BUILT CONDITIONS WHICH WILL VARY FROM THIS PLAN.

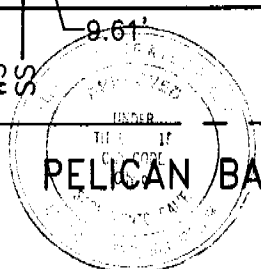
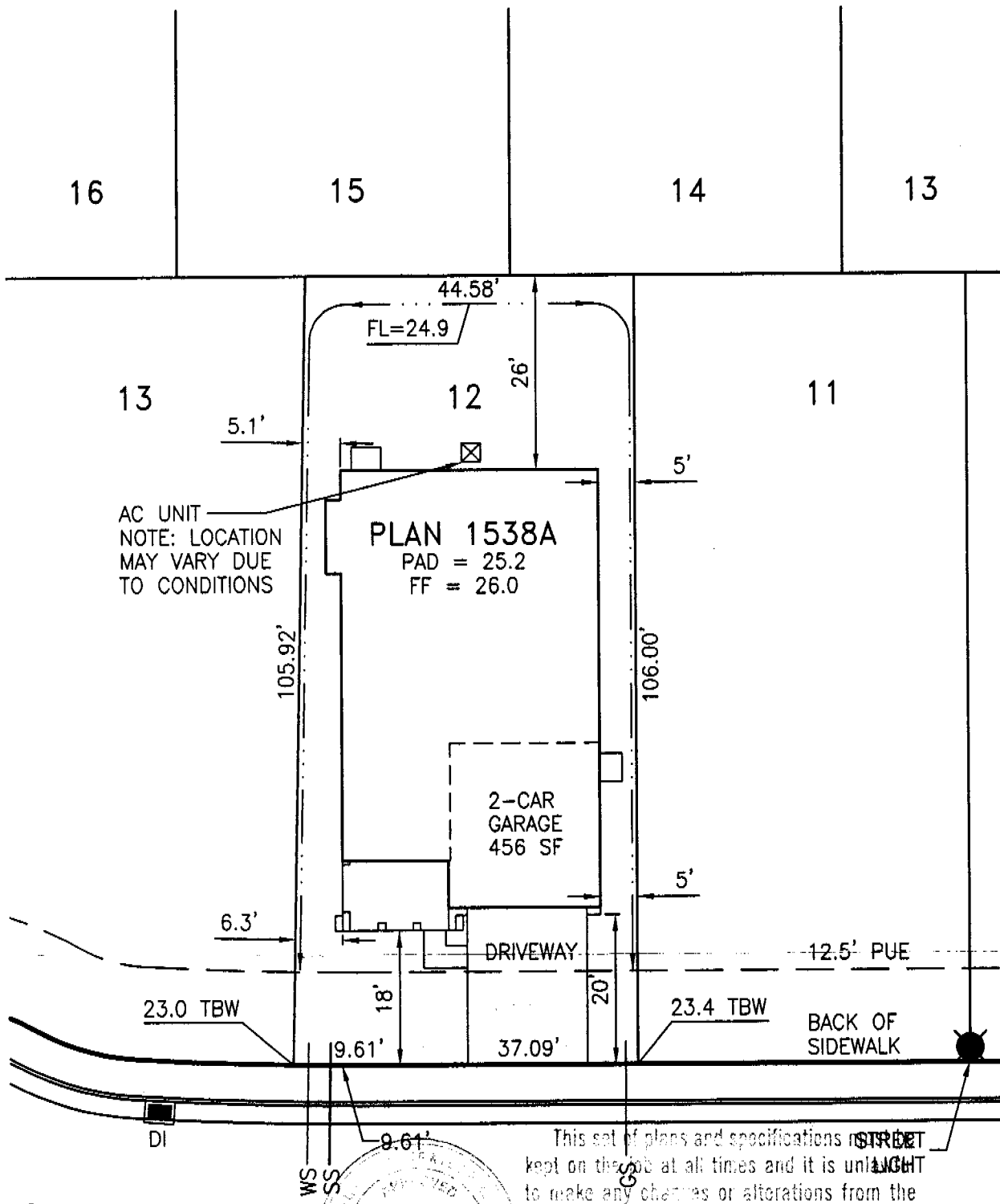

This set of plans and specifications is to be kept on the job at all times and it is the responsibility of the contractor to make any changes or alterations from the same without written permission from the Building Inspection Division. The approval of this plan and specification shall not be held to permit or approve the violation of any City Ordinance or State Law.

Approved By:	US Home Corp. Rep.	Date
Revision	Approved By	Date
▲		
▲		

LOT AREA: 4838 SF  
 ALLOWED LOT COVERAGE: 2177 SF = 45.0%  
 ACTUAL LOT COVERAGE: 1994 SF = 41.2%  
 REAR YARD AREA: 1166 SF  
 NUMBER OF BEDROOMS:

It is understood that the drainage areas, slopes and grades shall not be altered, changed, blocked, modified or in any way be reconstructed by Owner contrary to what is depicted on this Plot Plan. THESE CONDITIONS RUN WITH THE LAND AND ARE BINDING ON ALL SUBSEQUENT OWNERS. All setback dimensions and elevations as shown may be adjusted to fit field conditions.

Plot Plan for Heritage at Natomas Park Village 1B PPA Job #005010  
**Heritage Park - Caribbean** Lot 12  
 471 Pelican Bay Circle, Sacramento, CA 95835 APN 201-0730-074

**US Home Corporation - Sacramento Division**  
 2366 Gold Meadow Way, Suite 200, Gold River, CA 95670 Phone (916) 858-3900 Fax (916) 858-3925

**Plot Plan Associates** www.plotplans.org Date Drawn: 12/03/03 Scale: 1"=20'  
 PO Box 435 Citrus Heights CA 95611-0435 (916) 769-9063 Date Revised: - Drawn By: KLM

D:\005010\Plotplans\Village1B\5101B012.dwg

# CERTIFICATION OF INSULATION

PART I GENERAL

PART II AREAS INSULATED

PART III CERTIFICATION

<b>ADDRESS OR TRACT</b> <div style="font-size: 2em; font-family: cursive;">US Homes</div> <div style="font-size: 2em; font-family: cursive; margin-top: 20px;">Heritage P14 CarB</div>	<b>SACRAMENTO BUILDING PRODUCTS</b> LOT # <del>100</del> 12 <input checked="" type="checkbox"/> P.O. BOX 854, WEST SACRAMENTO, CA 95691 LIC. #202026 <input type="checkbox"/> 1309 MELODY ROAD, MARYSVILLE, CA 95901 LIC. #202026 <input type="checkbox"/> P.O. BOX 9651, FRESNO, CA 93793-9651 LIC. #202026 <input type="checkbox"/> P.O. BOX 1631, RENO, NV 89505 LIC. #10675 <input type="checkbox"/> 3326 A PONDEROSA WAY, LAS VEGAS, NV 89118 LIC. #10675 DATE INSULATION COMPLETED <span style="font-size: 1.5em; font-family: cursive;">7-17-04</span>
---	--

WALLS			CEILINGS			FLOORS		
( SQUARE FEET)			( SQUARE FEET)			( SQUARE FEET)		
TYPE OF INSULATION			TYPE OF INSULATION			TYPE OF INSULATION		
MATERIAL <b>FIBERGLASS</b>			MATERIAL <b>FIBERGLASS</b>			MATERIAL <b>FIBERGLASS</b>		
FORM <b>BATTS</b>			FORM <b>BATTS &amp; BLOW</b>			FORM <b>BATTS</b>		
MANUFACTURER'S PRODUCT I.D.			MANUFACTURER'S PRODUCT I.D.			MANUFACTURER'S PRODUCT I.D.		
MANUFACTURER			MANUFACTURER			MANUFACTURER		
CT	OC	JM	CT	OC	JM	CT	OC	JM
BAGS								
R - VALUE INSTALLED	APPLIED THICKNESS	R - VALUE INSTALLED	APPLIED THICKNESS	MIN. INSTALLED WEIGHT PER SQUARE FOOT	R - VALUE INSTALLED	APPLIED THICKNESS		
13	3.5	38	12.4 14.75					
KNEE WALLS IF R-VALUE IS OTHER THAN WALLS ABOVE								
MATERIAL <b>FIBERGLASS</b>		FORM <b>BATTS</b>	R VALUE			MANUFACTURER		
						CT	OC	JM
AIR INFILTRATION SEALANT								
MATERIAL <span style="font-size: 2em; font-family: cursive;">Foam</span>					MANUFACTURER <b>HILTI</b>		<b>HANDY FOAM</b>	

THIS IS TO CERTIFY THAT INSULATION AND/OR SEALANT HAS BEEN INSTALLED IN CONFORMANCE WITH APPLICABLE CODES, MATERIAL STANDARDS AND REGULATIONS.

SIGNATURE — INSULATION CONTRACTOR <span style="font-size: 1.5em; font-family: cursive;">J.C.</span>	TITLE <b>MANAGER</b>	DATE <span style="font-size: 1.5em; font-family: cursive;">6-17-04</span>
SIGNATURE — GENERAL CONTRACTOR	TITLE	DATE
REMARKS		