

CITY OF SACRAMENTO
1231 I Street, Sacramento, CA 95814

Permit No: 9912076
Insp Area: 2

Site Address: 7452 SHELBY ST SAC
Parcel No: 117-1350-021
N

Sub-Type: NSFR
Housing (Y/N):
LOT 21 LAGUNA VEGA NORTH UNIT 1

CONTRACTOR
E. R. HORTON INC.
110 BLUE RAVINE RD STE. 209
DUNSMITH CA 95630

OWNER

ARCHITECT

Nature of Work: MP 1591 2 STORY 7 ROOM SFR

CONSTRUCTION LENDING AGENCY : I hereby affirm under penalty of perjury that there is a construction lending agency for the performance of the work for which this permit is issued (Sec. 3097, Civ. C).

Lender's Name _____ Lender's Address _____

LICENSED CONTRACTORS DECLARATION: I hereby affirm under penalty of perjury that I am licensed under provisions of Chapter 9 (commencing with section 7000) of Division 3 of the Business and Professions Code and my license is in full force and effect.

License Class B License Number 754120 Date 11/17/99 Contractor Signature [Signature]

OWNER-BUILDER DECLARATION: I hereby affirm under penalty of perjury that I am exempt from the contractors License Law for the following reason (Sec. 7031.5, Business and Professions Code; any city or county which requires a permit to construct, alter, improve, demolish, or repair any structure, prior to its issuance, also requires the applicant for such permit to file a signed statement that he or she is licensed pursuant to the provisions of the Contractors License Law (Chapter 9 (commencing with Section 7000) of Division 3 of the Business and Professions Code) or that he or she is exempt therefrom and the basis for the alleged exemption. Any violation of Section 7031.5 by any applicant for a permit subjects the applicant to a civil penalty of not more than five hundred dollars (\$500.00).

I, _____ as a owner of the property, or my employees with wages as their sole compensation, will do the work, and the structure is not intended or offered for sale (Sec. 7044, Business and Professional Code. The Contractors License Law does not apply to an owner of property who builds or improves thereon, and who does such work himself or herself or through his/her own employees, provided that such improvements are not intended or offered for sale. If, however, the building or improvement is sold within one year of completion, the owner-builder will have the burden of proving that he/she did not build or improve for the purpose of sale.)

I, _____ as owner of the property, am exclusively contracting with licensed contractors to construct the project (Sec. 7044, Business and Professions Code). The Contractors License Law does not apply to an owner of property who builds or improves thereon, and who contracts for such projects with a contractor licensed pursuant to the Contractors License Law.)

Exempt under Sec. _____ B & PC for this reason: _____

Date _____ Owner Signature _____

IN ISSUING THIS BUILDING PERMIT, the applicant represents, and the city relies on the representation of the applicant, that the applicant verified all measurements and locations shown on the application or accompanying drawings and that the improvement to be constructed does not violate any law or private agreement relating to permissible or prohibited locations for such improvements. This building permit does not authorize any illegal location of an improvement or the violation of any private agreement relating to location of improvements.

I certify that I have read this application and state that all information is correct. I agree to comply with all city and county ordinances and state laws relating to building construction and hereby authorize representative(s) of this city to enter upon the abovementioned property for inspection purposes.

Date 11/17/99 Applicant Agent Signature [Signature]

WORKER'S COMPENSATION DECLARATION: I hereby affirm under penalty of perjury one of the following declarations:

I have and will maintain a certificate of consent to self-insure for workers' compensation as provided for by Section 3700 of the Labor Code, for the performance of work for which the permit is issued.

I have and will maintain workers' compensation insurance, as required by Section 3700 of the Labor Code, for the performance of the work for which this permit is issued. My workers' compensation insurance carrier and policy number are:

Carrier ARGONAUT INS. CO. Policy Number WC62600115505 Exp Date 07/01/2000

This section need not be completed if the permit is for \$100 or less) I certify that in the performance of the work for which this permit is issued, I shall not employ any person in any manner so as to become subject to the workers' compensation laws of California and agree that if I should become subject to the workers' compensation provisions of Section 3700 of the Labor Code, I shall forthwith comply with those provisions.

Date 11/17/99 Applicant Signature [Signature]

WARNING: FAILURE TO SECURE WORKER'S COMPENSATION COVERAGE IS UNLAWFUL AND SHALL SUBJECT AN EMPLOYER TO CRIMINAL PENALTIES AND CIVIL FINES UP TO ONE HUNDRED THOUSAND DOLLARS (\$100,000) IN ADDITION TO THE COST OF COMPENSATION, DAMAGES AS PROVIDED FOR IN SECTION 3706 OF THE LABOR CODE, INTEREST AND ATTORNEY'S FEE.

THIS PERMIT SHALL EXPIRE BY LIMITATION IF WORK IS NOT COMMENCED WITHIN 180 DAYS.

**Certification of Compliance
School District Development Fees**

(Print or Type) If Printing, press hard for four copies

PART I - To be completed by the applicant

OWNER'S NAME D. R. HORTON
 OWNER'S ADDRESS 110 BLUE RAUINE RD. STE 209 FOLSOM CA 95630
 PROJECT ADDRESS 7452 SHELBY STREET SAC.
 PARCEL NUMBER 117-1350-021 LOT NO. 21
 SUBDIVISION NAME LAGUNA VEOA
 NUMBER OF UNITS S. F. HOME

Upon payment of the fees listed below, a 90-day approval period commences upon which the applicant paying the fees may protest such fees. Any failure to file such protest within the 90-day period shall result in forfeiture of any rights to challenge such fees, through litigation or otherwise.

APPLICANT'S SIGNATURE [Signature]
 TITLE OF APPLICANT SUFF.
 DATE 10/19/99 PHONE NUMBER 755-1234

PLAN IDENTIFICATION NUMBER 9912076R
 BUILDING TYPE
 RESIDENTIAL () APARTMENT/CONDOMINIUM () COMMERCIAL/INDUSTRIAL ()
 SQUARE FEET OF CHARGEABLE BUILDING AREA 1591
 SIGNATURE [Signature]
 TITLE Bldg Insp DATE 10/25/99

SCHOOL DISTRICT EWISD
 DISTRICT CERTIFICATION NO. 24341

EXEMPT	COMMENTS			
RESIDENTIAL/APT/CONDO	(1) 1591	SQ FT X \$	1.93	= \$ 3,070.63
COMMERCIAL/INDUSTRIAL		SQ FT X \$		= \$
OTHER FEE	City/Type (1) 1591	SQ FT X \$	1.34	= \$ 2,131.94
TOTAL FEES COLLECTED	(1) 1591	X	3.27	= \$ 5,202.57

This Certification covers only the amount of square footage indicated above. Any additions or corrections to the square footage for this project will require an amendment to the Certificate of Compliance.

As the authorized school district official, I hereby certify that the requirements of Government Code Section 65995 and any other authorized requirements have been complied with by the above signed applicant.

SIGNATURE [Signature] TITLE [Signature] DATE NOV 10 1999

COUNTY SANITATION DISTRICT NO. 1
 SACRAMENTO REGIONAL COUNTY SANITATION DISTRICT
SEWER IMPACT FEE
 PERMIT AND CALCULATION SHEET

APPLICATION NO:		BLDG PERMIT NO:	
GENERAL INFORMATION		THIS PERMIT GOOD ONLY WHEN VALIDATED BY THE CASHIER	
<ul style="list-style-type: none"> - REPT 26 \$2,855.00 - TRAN 401179 11/10/99 - RECEIPT 725493 C#1 \$2,855.00 		<p style="text-align: right;">255591 11/10/99</p> <p>THIS PERMIT TO CONNECT EXPIRES ONE YEAR FROM DATE OF ISSUANCE</p>	
FEE CALCULATION		BUILDING USE	
INSPECTION	11	RESIDENTIAL SF <input type="checkbox"/>	MF <input type="checkbox"/>
CSD-1	470	COMMERCIAL USE	UNITS
SRCSD	2,385		
CONSTRUCTION			
IN-LIEU			
TOTAL FEE	2,855		
APN: 117-1350-021			
DESCRIPTION/ SUBDIVISION		LOT:	
LAGUNA VEGA		21	
PROPERTY ADDRESS 7452 SHELBY ST. SAC.			
OWNER D.R. HORTON			
MAILING ADDRESS 110 BLUE EAVINE RD.			
CITY-STATE-ZIP		PHONE	
FOLSOM		355-1234	
ADDITIONAL FEES MAY BE DUE IF CHANGES IN USE INCREASE SEWER IMPACT.			
APPLICANT SIGNATURE <i>[Signature]</i>			
CONSOLIDATED UTILITY BILLING USE ONLY			
ACCT _____ INPUT _____ START _____			

INSPECTOR'S COPY

CERTIFICATION OF INSULATION

PART I GENERAL

ADDRESS OR TRACT D.R. NORTON 7452 LAGUNA VEGA LOT # 21	SACRAMENTO INSULATION CONTRACTORS <input checked="" type="checkbox"/> P.O. BOX 854, WEST SACRAMENTO, CA 95691 LIC. #202026 <input type="checkbox"/> 1309 MELODY ROAD, MARYSVILLE, CA 95901 LIC. #202026 <input type="checkbox"/> P.O. BOX 9651, FRESNO, CA 93793-9651 LIC. #202026 <input type="checkbox"/> P.O. BOX 1631, RENO, NV 89505 LIC. #10675 <input type="checkbox"/> 3326 A PONDEROSA WAY, LAS VEGAS, NV 89118 LIC. #10675 DATE INSULATION COMPLETED 3-30-00
---	--

WALLS		CEILINGS			FLOORS	
SQUARE FEET)		SQUARE FEET)			SQUARE FEET)	
TYPE OF INSULATION		TYPE OF INSULATION			TYPE OF INSULATION	
MATERIAL FIBERGLASS		MATERIAL FIBERGLASS			MATERIAL FIBERGLASS	
FORM BATTS		FORM BATTS & BLOW			FORM BATTS	
MANUFACTURER'S PRODUCT I D		MANUFACTURER'S PRODUCT I D			MANUFACTURER'S PRODUCT I D	
MANUFACTURER		MANUFACTURER			MANUFACTURER	
OCF		OCF BAGS			OCF	
R-VALUE INSTALLED	APPLIED THICKNESS	R-VALUE INSTALLED	APPLIED THICKNESS	MIN. INSTALLED WEIGHT PER SQUARE FOOT	R-VALUE INSTALLED	APPLIED THICKNESS
13 19	3 5/8" 5 1/4"	30 30	9" 12"			
KNEE WALLS IF R-VALUE IS OTHER THAN WALLS ABOVE						
MATERIAL FIBERGLASS		FORM BATTS		R VALUE	MANUFACTURER OCF	
AIR INFILTRATION SEALANT						
MATERIAL FOAM				MANUFACTURER W R GRACE		

THIS IS TO CERTIFY THAT INSULATION AND/OR SEALANT HAS BEEN INSTALLED IN CONFORMANCE WITH APPLICABLE CODES, MATERIAL STANDARDS AND REGULATIONS.

SIGNATURE - INSULATION CONTRACTOR <i>Bill Seiberg</i>	TITLE MANAGER	DATE 3-21-00
SIGNATURE - GENERAL CONTRACTOR	TITLE	DATE

REMARKS

RESIDENTIAL BUILDING PERMIT APPLICATION

- New Construction
 Addition
 Remodels
 Other

Project Address: 7452 SHELBY STREET Assessor Parcel # 117-1350-021
 Lot Number: 21 LAGUNA VEGA

OWNER INFORMATION:

Legal Property Owner: D.R. Horton Phone # (916) 355-1234
 Owner Address: 110 Blue Ravine Road #209 City Folsom State CA Zip 95630

CONTRACTOR INFORMATION:

Contractor: D.R. Horton Lic. # 750190 Phone # 355-1234 Fax # 355-8077

PROJECT INFORMATION:

Land Use Zone RIA Occupancy Group R3 Construction Type VN Fed Code 1A
 No. of stories: 2 No. of rooms: 7 Street width: 44' ROW
 1st Floor Area 716 SF 2nd Floor Area 875 SF Basement _____ Roof Material CONC. TILE

AREA IN SQUARE FOOT OF:	EXISTING	NEW
Dwelling/Living	_____	<u>1591 SF.</u>
Garage/Storage	_____	<u>435 SF.</u>
Decks/Balconies	_____	_____
Carports	_____	_____

SCOPE OF WORK: New Construction

FOR OFFICE USE ONLY:

- | | | |
|---|---|--|
| <input type="checkbox"/> Information above complete | <input type="checkbox"/> AR Flood Waiver required | <input type="checkbox"/> Planning Approval |
| <input type="checkbox"/> Violation files checked | <input type="checkbox"/> Flood Elevation Certificate Required | <input type="checkbox"/> Design Review Approval |
| <input type="checkbox"/> Standard setbacks | <input type="checkbox"/> Water Development Infill Area | <input type="checkbox"/> Special Fee Districts Apply : _____ |
| <input type="checkbox"/> County Sewer | | |

NEW STRUCTURES & ADDITIONS

❖ THE FOLLOWING MUST BE PROVIDED IN ORDER TO SUBMIT FOR PLAN REVIEW

- | | |
|---|---|
| <input type="checkbox"/> 2 COMPLETE PLANS, LEGIBLE & DRAWN TO SCALE | ❖ Plans to include: site plan, floor plan, elevations, roof/ceiling plan, foundation and structural framing details, and structural calculations for non-conforming structures. |
| <input type="checkbox"/> 3 SETS IF PROJECT IS IN A DESIGN REVIEW AREA | |
| <input type="checkbox"/> Title 24 Energy Compliance documentation | <input type="checkbox"/> 11" x 17" copy of floor plan for County Assessor |
| <input type="checkbox"/> Grading and Erosion Control Questionnaire | <input type="checkbox"/> Plan Review Fees |

Date: _____ Received by: (staff) _____

ACTIVITY/PERMIT #

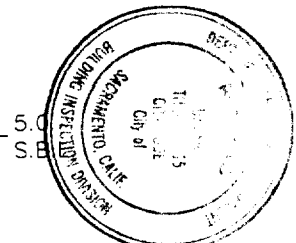
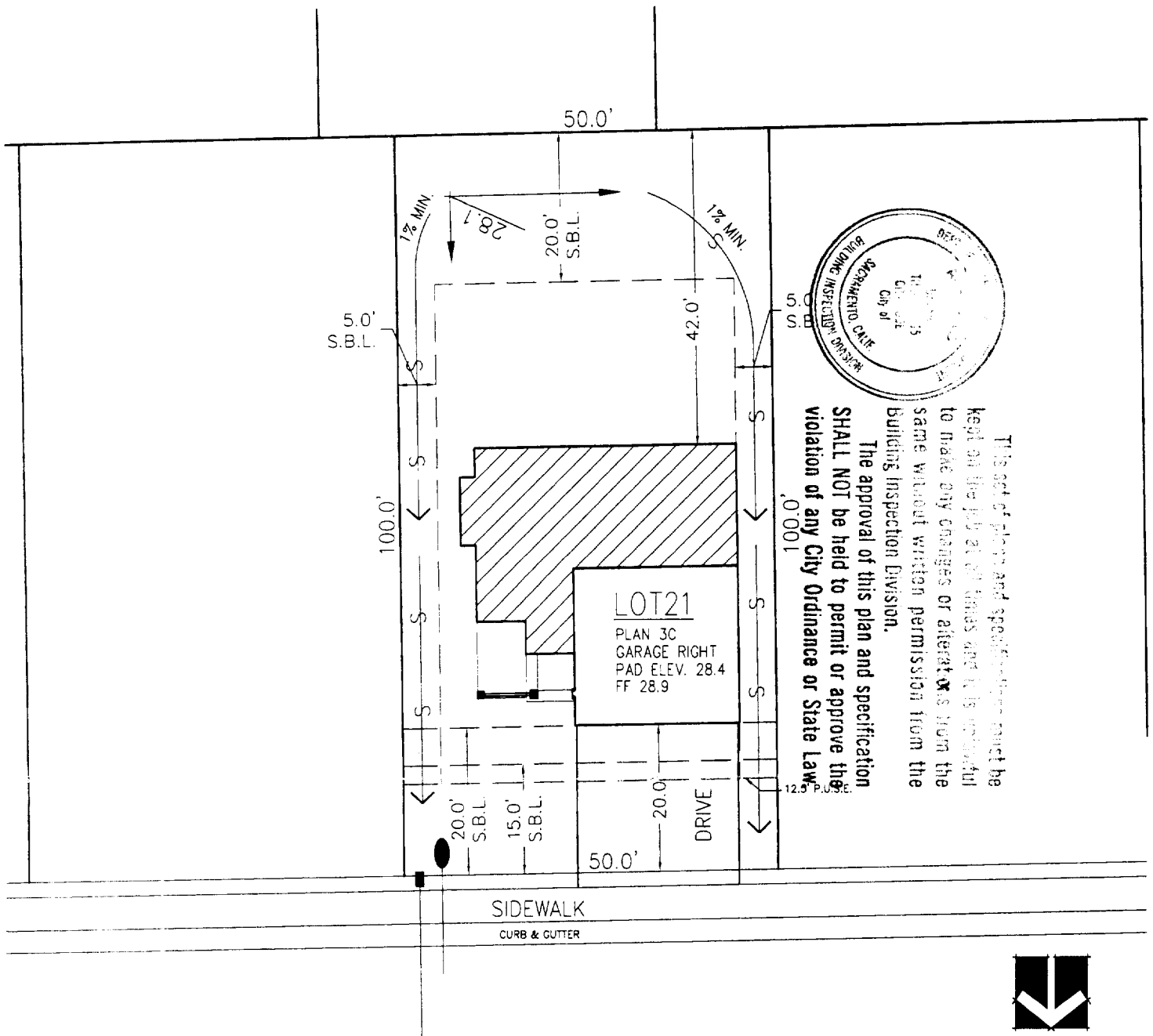

This set of plans and specifications must be kept on the job at all times and it is unlawful to make any changes or alterations from the same without written permission from the Building Inspection Division.
 The approval of this plan and specification SHALL NOT be held to permit or approve the violation of any City Ordinance or State Law.



NORTH

Scale: 1" = 20'

SITE INFORMATION

Client: D.R. Horton
 Project: Laguna Vega
 Plat: Laguna Vega North Village 1
 Location: Sacramento, CA. 95758
 Lot: 21
 Street Address: 7452 Shelby Street
 Plan/Elevation: Plan 3 / Elev. C

Use Zone: PUD
 Min. Gar. Setback: 20 ft.
 Min. Front Setback: 15 ft.
 Min. Rear Setback: 20 ft.
 Pad Elev.: 28.4
 Garage: Right
 APN: 117-1350-021

Note:
 Finish grade shall slope away from the building at 2% for the first five feet (5'). The minimum slope for all grades and swale shall be one percent (1%).



Laguna Vega North Village 1

Plot Plan For D.R. Horton

DATE: 10-15-99
 JOB NO: 58322.08

