

CITY OF SACRAMENTO

Permit No: 0109632

1231 I Street, Sacramento, CA 95814

Insp Area: 4

Site Address: 3312 CALLA LILY WY SAC

Sub-Type: NSFR

Parcel No: 274-0570-007

NATOMAS W 2 LOT 27

Housing (Y/N): N

CONTRACTOR

KAUFMAN AND BROAD
611 ORANGE DR
VACAVILLE CA. 95687

OWNER

ARCHITECT

Nature of Work: NSFR MP1706 8 RMS 1 STORY

CONSTRUCTION LENDING AGENCY : I hereby affirm under penalty of perjury that there is a construction lending agency for the performance of the work for which this permit is issued (Sec. 3097, Civ. C).

Lender's Name

Lender's Address

LICENSED CONTRACTORS DECLARATION: I hereby affirm under penalty of perjury that I am licensed under provisions of Chapter 9 (commencing with section 7000) of Division 3 of the Business and Professions Code and my license is in full force and effect.

License Class 3

License Number 761970

Date 8/21/01

Contractor Signature

OWNER-BUILDER DECLARATION: I hereby affirm under penalty of perjury that I am exempt from the contractors License Law for the following reason (Sec. 7031.5, Business and Professions Code; any city or county which requires a permit to construct, alter, improve, demolish, or repair any structure, prior to its issuance, also requires the applicant for such permit to file a signed statement that he or she is licensed pursuant to the provisions of the Contractors License Law (Chapter 9 (commencing with Section 7000) of Division 8 of the Business and Professions Code) or that he or she is exempt therefrom and the basis for the alleged exemption. Any violation of Section 7031.5 by any applicant for a permit subjects the applicant to a civil penalty of not more than five hundred dollars (\$500.00);

I, as a owner of the property, or my employees with wages as their sole compensation, will do the work, and the structure is not intended or offered for sale (Sec. 7044, Business and Professional Code: The Contractors License Law does not apply to an owner of property who builds or improves thereon, and who does such work himself or herself or through his/her own employees, provided that such improvements are not intended or offered for sale. If, however, the building or improvement is sold within one year of completion, the owner-builder will have the burden of proving that he/she did not build or improve for the purpose of sale.)

I, as owner of the property, am exclusively contracting with licensed contractors to construct the project (Sec. 7044, Business and Professions Code: The Contractors License Law does not apply to an owner of property who builds or improves thereon, and who contracts for such projects with a contractor(s) licensed pursuant to the Contractors License Law).

I am exempt under Sec. B & PC for this reason:

Date

Owner Signature

IN ISSUING THIS BUILDING PERMIT, the applicant represents, and the city relies on the representation of the applicant, that the applicant verified all measurements and locations shown on the application or accompanying drawings and that the improvement to be constructed does not violate any law or private agreement relating to permissible or prohibited locations for such improvements. Building permits do not authorize any illegal location of any improvement or the violation of any private agreement relating to location of improvements.

I certify that I have read this application and state that all information is correct. I agree to comply with all city and county ordinances and state laws relating to building construction and hereby authorize representative(s) of this city to enter upon the above mentioned property for inspection purposes.

Date 8/21/01

Applicant/Agent Signature

WORKER'S COMPENSATION DECLARATION: I hereby affirm under penalty of perjury one of the following declarations:

I have and will maintain a certificate of consent to self-insure for workers' compensation as provided for by Section 3700 of the Labor Code, for the performance of work for which the permit is issued.

I have and will maintain workers' compensation insurance, as required by Section 3700 of the Labor Code, for the performance of the work for which this permit is issued. My workers' compensation insurance carrier and policy number are:

Carrier CONTINENTAL CAS. CO.

Policy Number WC188899094

Exp Date 05/01/2000

(This section need not be completed if the permit is for \$100 or less) I certify that in the performance of the work for which this permit is issued, I shall not employ any person in any manner so as to become subject to the workers' compensation laws of California and agree that if I should become subject to the workers' compensation provisions of Section 3700 of the Labor Code, I shall forthwith comply with those provisions.

Date 8/21/01

Applicant Signature

WARNING: FAILURE TO SECURE WORKER'S COMPENSATION COVERAGE IS UNLAWFUL AND SHALL SUBJECT AN EMPLOYER TO CRIMINAL PENALTIES AND CIVIL FINES UP TO ONE HUNDRED THOUSAND DOLLARS (\$100,000) IN ADDITION TO THE COST OF COMPENSATION, DAMAGES AS PROVIDED FOR IN SECTION 3706 OF THE LABOR CODE, INTEREST AND ATTORNEY'S FEE.

THIS PERMIT SHALL EXPIRE BY LIMITATION IF WORK IS NOT COMMENCED WITHIN 180 DAYS.

RESIDENTIAL SUBDIVISION BUILDING PERMIT APPLICATION

Project Address: 3312 Calla Lily way Assessor Parcel # 274-0570 807
Lot Number: 27 Subdivision Natomas West Village

OWNER INFORMATION:

Legal Property Owner: KB Home Phone# 707-469-2464
Owner Address: 611 Orange dr City Vacaville State CA Zip 95687

CONTRACTOR INFORMATION:

Contractor: KB Home Lic. # 761970 Phone # 707-469-2464, 469-2405

PROJECT INFORMATION:

Land Use Zone RIA Occupancy Group R3 Construction Type VN Fed Code 1A
No. of Stories: 1 No. of Rooms: _____ Street Width: _____
1st Floor Area 1700 2nd Floor Area _____ Basement _____ Roof Material _____
AREA IN SQUARE FOOT OF:
Dwelling/Living 1700
Garage/Storage 433
Decks/Balconies 25
Carports _____
SCOPE OF WORK: New Single Family Dwelling

FOR OFFICE USE ONLY

- Information Above Complete
- Violation Files Checked
- Standard Setbacks
- County Sewer
- AR Flood Waiver Required
- Flood Elevation Certificate Required
- Water Development Infill Area
- Planning Approval
- Design Review Approval
- Special Fee Districts Apply:

THE FOLLOWING MUST BE PROVIDED IN ORDER TO SUBMIT FOR PERMIT

- 2 COMPLETE PLOT PLANS, LEGIBLE & DRAWN TO SCALE
- 11 X 17 COPY OF FLOOR PLAN WITH FOLLOWING INFORMATION
 - a) Assessor's Parcel Number
 - b) New Floor Area
 - c) Owners Name
 - d) Project Address

CERTIFICATION OF INSULATION

PART I GENERAL

PART II AREAS INSULATED

ADDRESS OR TRACT

SACRAMENTO INSULATION CONTRACTORS

KB HOMES

LOT # *27*

- P.O. BOX 854, WEST SACRAMENTO, CA 95691 LIC. #202026
- 1309 MELODY ROAD, MARYSVILLE, CA 95901 LIC. #202026
- P.O. BOX 9651, FRESNO, CA 93793-9651 LIC. #202026
- P.O. BOX 1631, RENO, NV 89505 LIC. #10675
- 3326 A PONDEROSA WAY, LAS VEGAS, NV 89118 LIC. #10675

CALIFORNIA GARDENS

DATE INSULATION COMPLETED

WALLS

CEILING

FLOORS

(SQUARE FEET)

(SQUARE FEET)

(SQUARE FEET)

TYPE OF INSULATION

TYPE OF INSULATION

TYPE OF INSULATION

MATERIAL

FIBERGLASS

MATERIAL

FIBERGLASS

MATERIAL

FIBERGLASS

FORM

BATTS

FORM

BATTS & BLOW

FORM

BATTS

MANUFACTURER'S PRODUCT I.D.

MANUFACTURER'S PRODUCT I.D.

MANUFACTURER'S PRODUCT I.D.

MANUFACTURER

OCF

MANUFACTURER

OCF

BAGS

MANUFACTURER

OCF

R - VALUE
INSTALLED

APPLIED
THICKNESS

R - VALUE
INSTALLED

APPLIED
THICKNESS

MIN. INSTALLED
WEIGHT PER
SQUARE FOOT

R - VALUE
INSTALLED

APPLIED
THICKNESS

13

3 5/8"

38
38

12 3/4"
14 3/4"

KNEE WALLS IF R-VALUE IS OTHER THAN WALLS ABOVE

MATERIAL

FIBERGLASS

FORM

BATTS

R VALUE

MANUFACTURER

OCF

AIR INFILTRATION SEALANT

MATERIAL

FOAM

MANUFACTURER

W R GRACE

THIS IS TO CERTIFY THAT INSULATION AND/OR SEALANT HAS BEEN INSTALLED IN CONFORMANCE WITH APPLICABLE CODES, MATERIAL STANDARDS AND REGULATIONS.

SIGNATURE - INSULATION CONTRACTOR

Jeff Cable

TITLE

MANAGER

DATE

2/22/02

SIGNATURE - GENERAL CONTRACTOR

TITLE

DATE

REMARKS

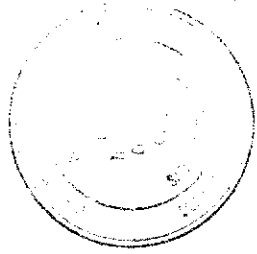
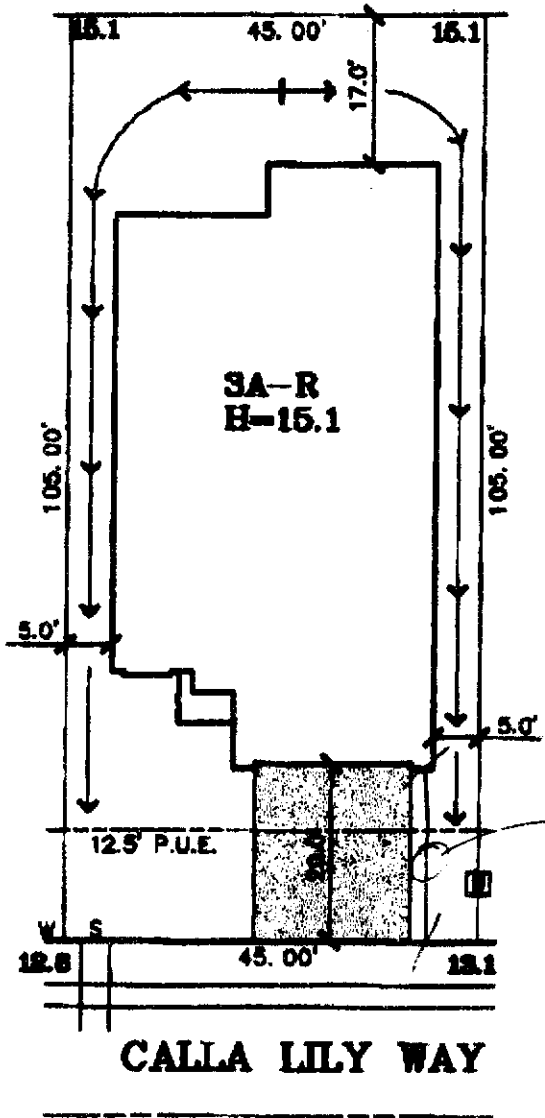

min garage setback 20'



DATE: 6-19-01
 A.P.N.: 274-0670-007
 ADDRESS: 3312 CALLA LILY WAY

LOT AREA: 4,725 SF
 LOT COVERAGE: 46%

Stantec

Stantec Consulting Inc.
 2590 Venture Oaks Way
 Sacramento, CA 95833-3288
 Tel. 916.925.5560
 Fax. 916.921.9274
 www.stantec.com

**NATOMAS WEST
 VILLAGE 2
 LOT 27
 PLAN 3A**

CALIFORNIA GARDENS

CITY OF SACRAMENTO, CA
 CLIENT: KAUFMAN & BROAD