

CITY OF SACRAMENTO

Permit No: 0004879

1231 I Street, Sacramento, CA 95814

Insp Area: 4

Site Address: 3859 AETNA SPRINGS WY SAC

Sub-Type: NSFR

Parcel No: 225-1180-033

LOT 33 GATEWAY W 1

Housing (Y/N): N

CONTRACTOR

OWNER

ARCHITECT

KAUFMAN AND BROAD  
611 ORANGE DR  
VACAVILLE CA 95687

Nature of Work: NSFR MP1968 9 RMS 2 STORY

CONSTRUCTION LENDING AGENCY : I hereby affirm under penalty of perjury that there is a construction lending agency for the performance of the work for which this permit is issued (Sec. 3097, Civ. C).

Lender's Name \_\_\_\_\_ Lender's Address \_\_\_\_\_

LICENSED CONTRACTORS DECLARATION: I hereby affirm under penalty of perjury that I am licensed under provisions of Chapter 9 (commencing with section 7000) of Division 3 of the Business and Professions Code and my license is in full force and effect.

License Class B License Number 255425 Date 5/18/00 Contractor Signature [Signature]

OWNER-BUILDER DECLARATION: I hereby affirm under penalty of perjury that I am exempt from the contractors License Law for the following reason (Sec. 7031.5, Business and Professions Code; any city or county which requires a permit to construct, alter, improve, demolish, or repair any structure, prior to its issuance, also requires the applicant for such permit to file a signed statement that he or she is licensed pursuant to the provisions of the Contractors License Law (Chapter 9 (commencing with Section 7000) of Division 8 of the Business and Professions Code) or that he or she is exempt therefrom and the basis for the alleged exemption. Any violation of Section 7031.5 by any applicant for a permit subjects the applicant to a civil penalty of not more than five hundred dollars (\$500.00);

I, as a owner of the property, or my employees with wages as their sole compensation, will do the work, and the structure is not intended or offered for sale (Sec. 7044, Business and Professional Code: The Contractors License Law does not apply to an owner of property who builds or improves thereon, and who does such work himself or herself or through his/her own employees, provided that such improvements are not intended or offered for sale. If, however, the building or improvement is sold within one year of completion, the owner-builder will have the burden of proving that he/she did not build or improve for the purpose of sale.)

I, as owner of the property, am exclusively contracting with licensed contractors to construct the project (Sec. 7044, Business and Professions Code: The Contractors License Law does not apply to an owner of property who builds or improves thereon, and who contracts for such projects with a contractor(s) licensed pursuant to the Contractors License Law).

I am exempt under Sec. \_\_\_\_\_ B & PC for this reason: \_\_\_\_\_  
Date \_\_\_\_\_ Owner Signature \_\_\_\_\_

IN ISSUING THIS BUILDING PERMIT, the applicant represents, and the city relies on the representation of the applicant, that the applicant verified all measurements and locations shown on the application or accompanying drawings and that the improvement to be constructed does not violate any law or private agreement relating to permissible or prohibited locations for such improvements. This building permit does not authorize any illegal location of any improvement or the violation of any private agreement relating to location of improvements.

I certify that I have read this application and state that all information is correct. I agree to comply with all city and county ordinances and state laws relating to building construction and hereby authorize representative(s) of this city to enter upon the abovementioned property for inspection purposes.

Date 5/18/00 Applicant/Agent Signature [Signature]

WORKER'S COMPENSATION DECLARATION: I hereby affirm under penalty of perjury one of the following declarations:

I have and will maintain a certificate of consent to self-insure for workers' compensation as provided for by Section 3700 of the Labor Code, for the performance of work for which the permit is issued.

I have and will maintain workers' compensation insurance, as required by Section 3700 of the Labor Code, for the performance of the work for which this permit is issued. My workers' compensation insurance carrier policy number are:

Carrier CONTINENTAL CAS. CO. Policy Number WC188899094 Exp Date 5/1/2000

(This section need not be completed if the applicant is self-insuring.) I certify that in the performance of the work for which this permit is issued, I shall not employ any person in any manner so as to become subject to the workers' compensation laws of California and agree that if I should become subject to the workers' compensation provisions of Section 3700 of the Labor Code, I shall forthwith comply with those provisions.

Date 5/18/00 Applicant Signature [Signature]

WARNING: FAILURE TO SECURE WORKER'S COMPENSATION COVERAGE IS UNLAWFUL AND SHALL SUBJECT AN EMPLOYER TO CRIMINAL PENALTIES AND CIVIL FINES UP TO ONE HUNDRED THOUSAND DOLLARS (\$100,000) IN ADDITION TO THE COST OF COMPENSATION, DAMAGES AS PROVIDED FOR IN SECTION 3706 OF THE LABOR CODE, INTEREST AND ATTORNEY'S FEE.

THIS PERMIT SHALL EXPIRE BY LIMITATION IF WORK IS NOT COMMENCED WITHIN 180 DAYS.

### RESIDENTIAL BUILDING PERMIT APPLICATION

- New Construction    
  Addition    
  Remodels    
  Other

Project Address: \_\_\_\_\_ Assessor Parcel # \_\_\_\_\_

**OWNER INFORMATION: Kaufman & Broad**

|                                       |                                     |
|---------------------------------------|-------------------------------------|
| Legal Property Owner: Kaufman & Broad | Phone # (707) 469-2400              |
| Owner Address: 611 Orange Drive       | City Vacaville, State Ca. Zip 95687 |

**CONTRACTOR INFORMATION:**

Contractor: Kaufman & Broad Lic. # 255425 / B Phone # 707 469-2400 # 469-2404

**PROJECT INFORMATION:**

|   |  |                              |                         |
|---|--|------------------------------|-------------------------|
| Land Use Zone: <u>RIA</u>               | Occupancy Group: <u>R3</u>             | Construction Type: <u>VN</u> | Fed Code: <u>1A</u>     |
| No. of stories: <u>2</u>                | No. of rooms: <u>4</u>                 | Street width: <u>N/A</u>     |                         |
| 1 <sup>st</sup> Floor Area: <u>1026</u> | 2 <sup>nd</sup> Floor Area: <u>939</u> | Basement: <u>0</u>           | Roof Material: <u>0</u> |

| AREA IN SQUARE FOOT OF: | EXISTING    | NEW   |
|-------------------------|-------------|-------|
| Dwelling/Living         | <u>1965</u> | _____ |
| Garage/Storage          | <u>468</u>  | _____ |
| Decks/Balconies         | <u>128</u>  | _____ |
| Carports                | <u>0</u>    | _____ |

SCOPE OF WORK: S.F.O.

**FOR OFFICE USE ONLY**

- |   |   |  |
|---|---|--|
| <input type="checkbox"/> Information above complete | <input type="checkbox"/> AR Flood Waiver required             | <input type="checkbox"/> Planning Approval                   |
| <input type="checkbox"/> Violation files checked    | <input type="checkbox"/> Flood Elevation Certificate Required | <input type="checkbox"/> Design Review Approval              |
| <input type="checkbox"/> Standard setbacks          | <input type="checkbox"/> Water Development Infill Area        | <input type="checkbox"/> Special Fee Districts Apply : _____ |
| <input type="checkbox"/> County Sewer               |   |  |

**NEW STRUCTURES & ADDITIONS**

◆ THE FOLLOWING MUST BE PROVIDED IN ORDER TO SUBMIT FOR PLAN REVIEW

- |   |   |
|---|---|
| <input type="checkbox"/> 2 COMPLETE PLANS, LEGIBLE & DRAWN TO SCALE   | ◆ Plans to include: site plan, floor plan, elevations, roof/ceiling plan, foundation and structural framing details, and structural calculations for non-conforming structures. |
| <input type="checkbox"/> 3 SETS IF PROJECT IS IN A DESIGN REVIEW AREA |   |
| <input type="checkbox"/> Title 24 Energy Compliance documentation     | <input type="checkbox"/> 11" x 17" copy of floor plan for County Assessor   |
| <input type="checkbox"/> Grading and Erosion Control Questionnaire    | <input type="checkbox"/> Plan Review Fees   |

Date: \_\_\_\_\_ Received by: (staff) \_\_\_\_\_

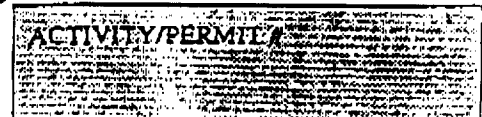

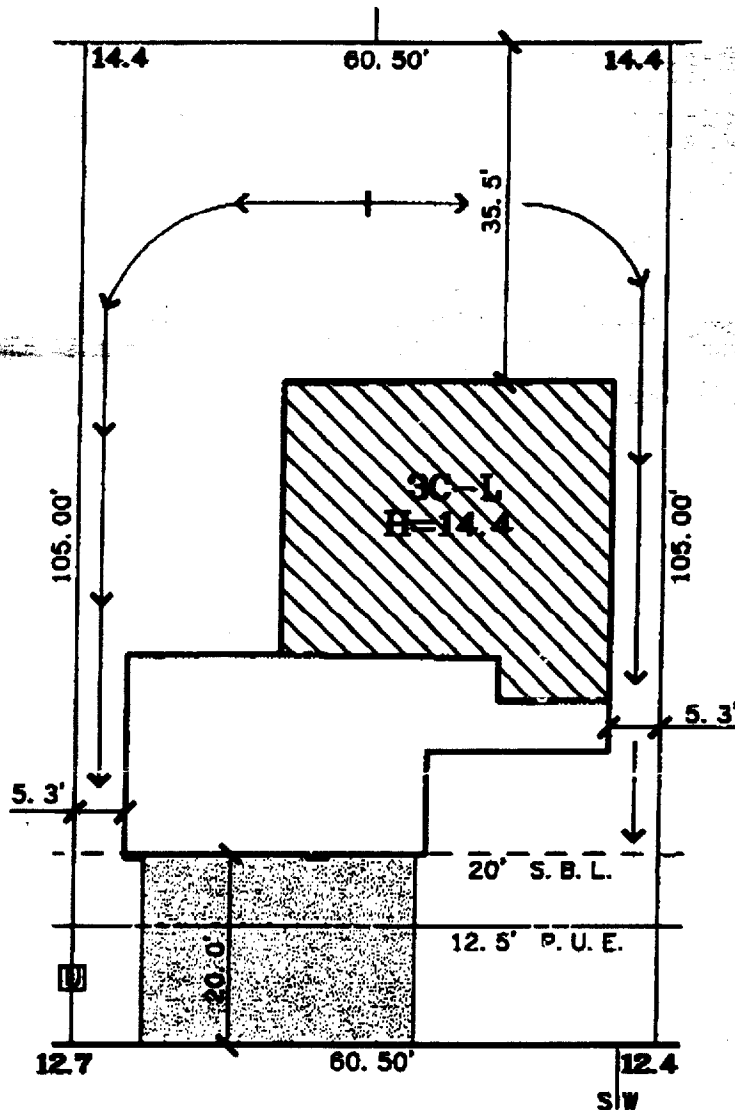

**AETNA SPRINGS WAY**

DATE: 4-21-00

A.P.N.:

ADDRESS: 3860 AETNA SPRINGS WAY

LOT AREA: 6,363 SF  
LOT COVERAGE: 29%

**The Splink Corporation**

2590 VENTURE OAKS WAY  
SACRAMENTO, CA 95833

PH:(916)925-5550 FAX:(916)921-9274

**GATEWAY WEST  
VILLAGE 1 UNIT 4  
LOT 33  
PLAN 3C**

**GATEWAY WEST**

CITY OF SACRAMENTO, CA.  
CLIENT: KAUFMAN & BROAD  
JOB NO.: 4734-042



871 Coleman Ave., #200  
 San Jose, CA 95110-1831  
 Tel: (408) 293-0813  
 Fax: (408) 293-0890

>>>>>> OUTGOING 89655 VIA FAX <<<<<<<

Date: 11-29-2000

From: Leif Lysen  
 Chien Lee & Associates, Inc.  
 871 Coleman Ave, Ste #200  
 San Jose, CA 95110-1831  
 Tel: (408) 293-0813 Fax: (408) 293-0890

To: Wally  
 K&B Gateway West Jobsite  
 Fax: (916) 419-0126

Proj: K&B Gateway West Proj No: 01669.00

| Sets | Shts | Size   | Description            |
|------|------|--------|------------------------|
| 1    | 1    | 8.5X11 | Transmittal            |
| 1    | 2    | 8.5X11 | Plan 240.15M2 Head-Out |

Notes:

In response to your question. Wet-stamped to follow.



