

CITY OF SACRAMENTO

1231 I Street, Sacramento, CA 95814

Permit No: 0009715

Insp Area: 4

Site Address: 670 EASTBROOK WY SAC

Parcel No: 201-0370-014

NORTHBOROUGH 3-1 LOT 14

Sub-Type: NSFR

Housing (Y/N): N

CONTRACTOR

ES HOME
2366 GOLD MEADOW DR
SFE # 100 95670

OWNER

ARCHITECT

Nature of Work: MP 2566 2 STORY 9 ROOM SFR

CONSTRUCTION LENDING AGENCY: I hereby affirm under penalty of perjury that there is a construction lending agency for the performance of the work for which this permit is issued (Sec. 3097, Civ. C)

Lender's Name: Lender's Address:

LICENSED CONTRACTORS DECLARATION: I hereby affirm under penalty of perjury that I am licensed under provisions of Chapter 9 (commencing with section 7000) of Division 3 of the Business and Professions Code and my license is in full force and effect.

License Class: B License Number: 44153 Date: Contractor Signature: [Signature]

OWNER-BUILDER DECLARATION: I hereby affirm under penalty of perjury that I am exempt from the contractors License Law for the following reason (Sec. 7031.5, Business and Professions Code: any city or county which requires a permit to construct, alter, improve, demolish, or repair any structure, prior to its issuance, also requires the applicant for such permit to file a signed statement that he or she is licensed pursuant to the provisions of the Contractors License Law (Chapter 9 (commencing with Section 7000) of Division 8 of the Business and Professions Code) or that he or she is exempt therefrom and the basis for the alleged exemption. Any violation of Section 7031.5 by any applicant for a permit subjects the applicant to a civil penalty of not more than five hundred dollars (\$500.00);

I, as a owner of the property, or my employees with wages as their sole compensation, will do the work, and the structure is not intended or offered for sale (Sec. 7044, Business and Professional Code: The Contractors License Law does not apply to an owner of property who builds or improves thereon, and who does such work himself or herself or through his/her own employees, provided that such improvements are not intended or offered for sale. If, however, the building or improvement is sold within one year of completion, the owner-builder will have the burden of proving that he/she did not build or improve for the purpose of sale.)

I, as owner of the property, am exclusively contracting with licensed contractors to construct the project (Sec. 7044, Business and Professions Code: The Contractors License Law does not apply to an owner of property who builds or improves thereon, and who contracts for such projects with a contractor(s) licensed pursuant to the Contractors License Law).

I am exempt under Sec. B & PC for this reason:

Date: Owner Signature:

IN ISSUING THIS BUILDING PERMIT, the applicant represents, and the city relies on the representation of the applicant, that the applicant verified all measurements and locations shown on the application or accompanying drawings and that the improvement to be constructed does not violate any law or private agreement relating to permissible or prohibited locations for such improvements. This building permit does not authorize any illegal location of any improvement or the violation of any private agreement relating to location of improvements.

I certify that I have read this application and state that all information is correct. I agree to comply with all city and county ordinances and state laws relating to building construction and herby authorize representative(s) of this city to enter upon the abovementioned property for inspection purposes.

Date: 5/20/00 Applicant/Agent Signature: [Signature]

WORKER'S COMPENSATION DECLARATION: I hereby affirm under penalty of perjury one of the following declarations:

I have and will maintain a certificate of consent to self-insure for workers' compensation as provided for by Section 3700 of the Labor Code, for the performance of work for which the permit is issued.

I have and will maintain workers' compensation insurance, as required by Section 3700 of the Labor Code, for the performance of the work for which this permit is issued. My workers' compensation insurance carrier and policy number are:

Carrier: OLD REPUBLIC INS. CO. Policy Number: MWC107468 00 Exp Date: 11/1/2000

(This section need not be completed if the permit is for \$100 or less) I certify that in the performance of the work for which this permit is issued, I shall not employ any person in any manner which would make such person subject to the workers' compensation laws of California and agree that if I should become subject to the workers' compensation provisions of Section 3700 of the Labor Code, I shall forthwith comply with those provisions.

Date: Applicant Signature: [Signature]

WARNING: FAILURE TO SECURE WORKER'S COMPENSATION COVERAGE IS UNLAWFUL AND SHALL SUBJECT AN EMPLOYER TO CRIMINAL PENALTIES AND CIVIL FINES UP TO ONE HUNDRED THOUSAND DOLLARS (\$100,000) IN ADDITION TO THE COST OF COMPENSATION, DAMAGES AS PROVIDED FOR IN SECTION 3706 OF THE LABOR CODE, INTEREST AND ATTORNEY'S FEE.

THIS PERMIT SHALL EXPIRE BY LIMITATION IF WORK IS NOT COMMENCED WITHIN 180 DAYS.

RESIDENTIAL SUBDIVISION BUILDING PERMIT APPLICATION

Project Address: 670 Eastbrook Way
Lot Number: 14

Assessor Parcel # 201 - 037 - 014
Subdivision NORTHBOROUGH VILLAGE 3-1

OWNER INFORMATION:

Legal Property Owner: US HOME Phone# 858-3900
Owner Address: 366 GOLD MEADOW WAY City GOLD RIVER State CA Zip 95670

CONTRACTOR INFORMATION:

Contractor: US HOME Lic. # 451839 Phone # 858-3900 Fax 858-3925

DON MCCLOSKEY 719-9050

PROJECT INFORMATION:

Land Use Zone RIA Occupancy Group R3 Construction Type VN Fed Code 1A
No. of Stories: 2 No. of Rooms: _____ Street Width: _____
1st Floor Area 1329 2nd Floor Area 1237 Basement _____ Roof Material _____
AREA IN SQUARE FOOT OF:
Dwelling/Living 2566
Garage/Storage 445
Decks/Balconies 33
Carports _____
SCOPE OF WORK: _____

FOR OFFICE USE ONLY

- Information Above Complete
- Violation Files Checked
- Standard Setbacks
- County Sewer
- AR Flood Waiver Required
- Flood Elevation Certificate Required
- Water Development Infill Area
- Planning Approval
- Design Review Approval
- Special Fee Districts Apply:

THE FOLLOWING MUST BE PROVIDED IN ORDER TO SUBMIT FOR PERMIT

- 2 COMPLETE PLOT PLANS, LEGIBLE & DRAWN TO SCALE
- 11 X 17 COPY OF FLOOR PLAN WITH FOLLOWING INFORMATION
 - a) Assessor's Parcel Number
 - b) New Floor Area
 - c) Owners Name
 - d) Project Address

Date:

Received by: (staff)

Permit #

Lot Area = 5,565 sf
 Building Footprint = 2,021 sf
 Gross Coverage = 36.3%
 Porch Allowance = 54 sf
 Net Coverage = 35.4%

Northborough Drive

SCALE: 1" = 20'

APN:

201-037-014

Address:

670 Eastbrook Circle

Owner:

Plan:

2546 L

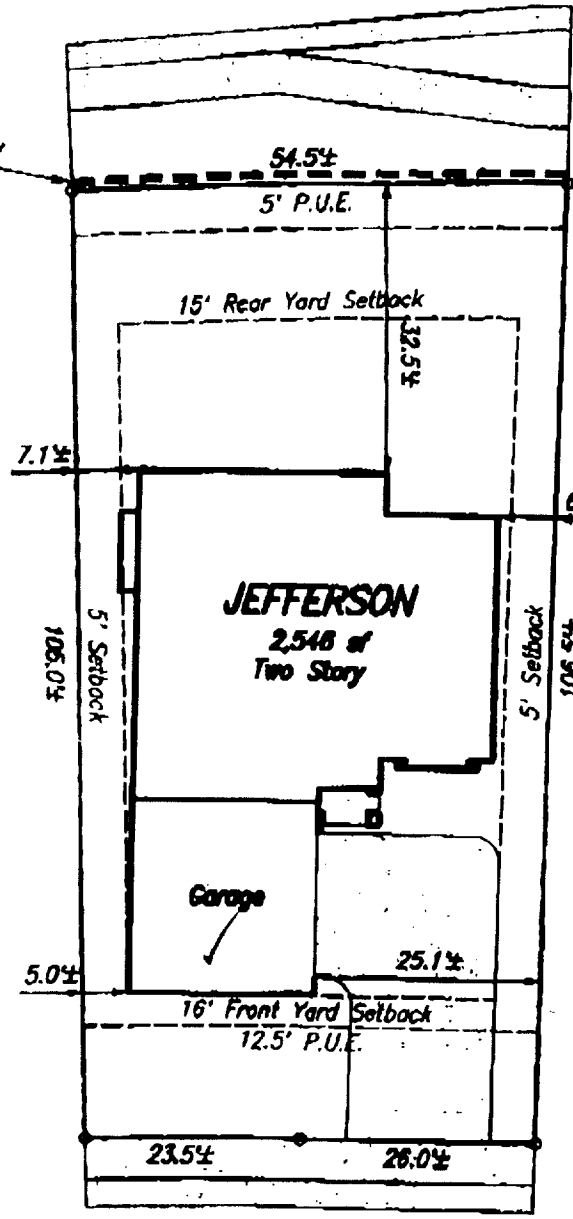

Eastbrook Circle

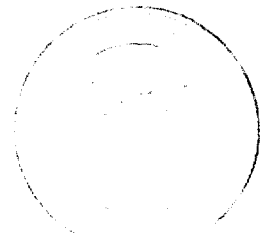

I, the undersigned, being a duly qualified and sworn-in Professional Engineer, do hereby certify that the above information is true and correct to the best of my knowledge and belief, and that I am not providing any false or misleading information. I am not providing any false or misleading information. I am not providing any false or misleading information.

Plot Plan for Lot 14 for Northborough Village 3-1
 U.S.Home - Northborough - Traditions Series
 City of Sacramento

Note:

This plot plan has been prepared for the purpose of showing the building foundation relationship to the property line, proposed drainage elevations and direction of flow to conform to local ordinances and for the purpose of building permit issuance. Information shown is approximate except for those setbacks which are minimums required by ordinance. This plot does not reflect as-built conditions which will likely vary from this plan.

Murray Smith & Associates
 Engineering, Inc.
 3110 Gold Canal Drive
 Rancho Cordova, CA 95670
 Ph.: (916) 635-1511

August 11, 2000

PN: 99003