

CITY OF SACRAMENTO

Permit No: 9801242

1231 I Street, Sacramento, CA 95814

Insp Area: 2

Site Address: 1 NIKKI CT SAC

Sub-Type: NSFR

Parcel No: 1171000005

LOT 5

Housing (Y/N): N

CONTRACTOR

THE FORECAST GROUP
1796 TRIBUTE RD
#100 95815
Phone: 916-920-0200

OWNER

THE FORECAST GROUP
1796 TRIBUTE RD #100
SACRAMENTO CA 95815
Phone:

ARCHITECT

Phone:

Nature of Work: NEW SFD MP 1324 PLAN #1

CONSTRUCTION LENDING AGENCY: I hereby affirm under penalty of perjury that there is a construction lending agency for the performance of the work for which this permit is issued (Sec. 3097, Civ. C).

Lender's Name: NONE Lender's Address:

LICENSED CONTRACTORS DECLARATION: I hereby affirm under penalty of perjury that I am licensed under provisions of Chapter 9 (commencing with section 7000) of Division 3 of the Business and Professions Code and my license is in full force and effect.

License Class: B License Number: C20766 Date: 11/98 Contractor Signature: [Signature]

OWNER-BUILDER DECLARATION: I hereby affirm under penalty of perjury that I am exempt from the contractors License Law for the following reason (Sec. 7031.5, Business and Professions Code; any city or county which requires a permit to construct, alter, improve, demolish, or repair any structure, prior to its issuance, also requires the applicant for such permit to file a signed statement that he or she is licensed pursuant to the provisions of the Contractors License Law (Chapter 9 (commencing with Section 7000) of Division 8 of the Business and Professions Code) or that he or she is exempt therefrom and the basis for the alleged exemption. Any violation of Section 7031.5 by any applicant for a permit subjects the applicant to a civil penalty of not more than five hundred dollars (\$500.00);

I, as a owner of the property, or my employees with wages as their sole compensation, will do the work, and the structure is not intended or offered for sale (Sec. 7044, Business and Professional Code: The Contractors Law does not apply to an owner of property who builds or improves thereon, and who does such work himself or herself or through his or her own employees, provided that such improvements are not intended or offered for sale. If, however, the building or improvement is sold within one year of completion, the owner-builder will have the burden of proving that he or she did not build or improve for the purpose of sale.)

I, as owner of the property, am exclusively contracting with licensed contractors to construct the project (Sec. 7044, Business and Professions Code: The contractors License Law does not apply to an owner of property who builds or improves thereon, and who contracts for such projects with a contractor(s) licensed pursuant to the Contractors License Law).

I am exempt under Sec. B & PC for this reason: Date Owner Signature

IN ISSUING THIS BUILDING PERMIT, the applicant represents, and the city relies on the representation of the applicant, that the applicant verified all measurements and locations shown on the application or accompanying drawings and that the improvement to be constructed does not violate any law or private agreement relating to permissible or prohibited locations for such improvements. This building permit does not authorize any illegal location of any improvement or the violation of any private agreement relating to location of improvements.

Date: 3/9/99 Applicant/Agent Signature: [Signature]

WORKER'S COMPENSATION DECLARATION: I hereby affirm under penalty of perjury one of the following declarations:

I have and will maintain a certificate of consent to self-insure for workers' compensation as provided for by Section 3700 of the Labor Code, for the performance of work for which the permit is issued.

I have and will maintain workers' compensation insurance, as required by Section 3700 of the Labor Code, for the performance of the work for which this permit is issued. My workers' compensation insurance carrier and policy number are:

Carrier: FIREMALE FUND Policy Number: DLX 8076-2671 1-1-99

(This section need not be completed if the permit is for \$100 or less) I certify that in the performance of the work for which this permit is issued, I shall not employ any person in any manner so as to become subject to the workers' compensation laws of California and agree that if I should become subject to the workers' compensation provisions of Section 3700 of the Labor Code, I shall forthwith comply with those provisions.

Date: 3/9/99 Applicant Signature: [Signature]

WARNING: FAILURE TO SECURE WORKER'S COMPENSATION COVERAGE IS UNLAWFUL AND SHALL SUBJECT AN EMPLOYER TO CRIMINAL PENALTIES AND CIVIL FINES UP TO ONE HUNDRED THOUSAND DOLLARS (\$100,000) IN ADDITION TO THE COST OF COMPENSATION, DAMAGES AS PROVIDED FOR IN SECTION 3706 OF THE LABOR CODE, INTEREST AND ATTORNEY'S FEE.

THIS PERMIT SHALL EXPIRE BY LIMITATION IF WORK IS NOT COMMENCED WITHIN 180 DAYS.

INSTALLATION CARD

WESTERN ONE STUCCO SYSTEM

SACRAMENTO STUCCO PRODUCTS CO., INC.

ICBO Evaluation Service, Inc.

Report No. 3899

Date of Job Completion

7/7/98

Job Address:

Lot 105

5241 Francesca St

Plastering Contractor

Name:

Shanklin Contractors, Inc

Address:

3574 Almond Street #5  
Sacramento, CA 95817

Telephone Number

916-55-9717

Approved Applicator's License Number as

556

Issued by Western Stucco Products

This is to certify that the plastering system on the building exterior at the above address has been installed in accordance with the evaluation report specified above and the manufacturer's instruction.

Signature of authorized representative of plastering contractor

John Shanklin

Date

7/7/98

No.

Installation card must be presented to the building inspector after completion of work and before final inspection.

COUNTY SANITATION DISTRICT NO. 1  
 SACRAMENTO REGIONAL COUNTY SANITATION DISTRICT  
**SEWER IMPACT FEE**  
 PERMIT AND CALCULATION SHEET *2/14/98*

APPLICATION NO:

BLDG. PERMIT NO: *CITY*

GENERAL INFORMATION

THIS PERMIT GOOD ONLY WHEN  
 VALIDATED BY THE CASHIER

*241752 2/14/98*  
 THIS PERMIT TO CONNECT EXPIRES  
 ONE YEAR FROM DATE OF ISSUANCE

FEE CALCULATION

BUILDING USE

INSPECTION	RESIDENTIAL	SF	MF	UNITS
CSD-1		<input checked="" type="checkbox"/>	<input type="checkbox"/>	
SRCSD				
CONSTRUCTION				
IN-LIEU				
<b>TOTAL FEE</b>				<b><i>2689</i></b>

APN:

DESCRIPTION/  
 SUBDIVISION

TRACT, BLOCK, LOT, & UNIT

LOT: **5**

PROPERTY ADDRESS

CITY, STATE, ZIP

OWNER

PHONE (AREA CODE) NUMBER

MAILING ADDRESS

CITY, STATE, ZIP

CITY-STATE-ZIP

PHONE

ADDITIONAL FEES MAY BE DUE IF CHANGES IN USE INCREASE SEWER IMPACT

APPLICANT SIGNATURE

DATE

INDICATE IF OTHER BILLING USE ONE

BILLING COPY

# CERTIFICATION OF INSULATION

ADDRESS OR TRACT

SACRAMENTO INSULATION CONTRACTORS

Forecast Homes LOT # 5  
Astikos

- P.O. BOX 854, WEST SACRAMENTO, CA 95691 LIC. #202026
- 3243 INDUSTRIAL DRIVE, YUBA CITY, CA 95993 LIC. #202026
- P.O. BOX 9651, FRESNO, CA 93793-9651 LIC. #202026
- P.O. BOX 1631, RENO, NV 89505 LIC. #10675
- 3326 A PONDEROSA WAY, LAS VEGAS, NV 89118 LIC. #10675

DATE INSULATION COMPLETED

7-16-98

PART I GENERAL

PART II AREAS INSULATED

WALLS		CEILINGS			FLOORS	
( SQUARE FEET)		( SQUARE FEET)			( SQUARE FEET)	
TYPE OF INSULATION		TYPE OF INSULATION			TYPE OF INSULATION	
MATERIAL	<b>FIBERGLASS</b>	MATERIAL	<b>FIBERGLASS</b>		MATERIAL	<b>FIBERGLASS</b>
FORM	<b>BATTS</b>	FORM	<b>BATTS &amp; BLOW</b>		FORM	<b>BATTS</b>
MANUFACTURER'S PRODUCT I.D.		MANUFACTURER'S PRODUCT I.D.			MANUFACTURER'S PRODUCT I.D.	
MANUFACTURER		MANUFACTURER			MANUFACTURER	
OCF		OCF			OCF	
BAGS						
R - VALUE INSTALLED	APPLIED THICKNESS	R - VALUE INSTALLED	APPLIED THICKNESS	MIN. INSTALLED WEIGHT PER SQUARE FOOT	R - VALUE INSTALLED	APPLIED THICKNESS
13	3 5/8"	38	15 1/4" 12 1/2"	—	—	—

KNEE WALLS IF R-VALUE IS OTHER THAN WALLS ABOVE

MATERIAL:	FORM	R VALUE	MANUFACTURER
<b>FIBERGLASS</b>	<b>BATTS</b>	—	<b>OCF</b>

AIR INFILTRATION SEALANT

MATERIAL:	MANUFACTURER
<b>Foam</b>	<b>W R GRACE</b>

**THIS IS TO CERTIFY THAT INSULATION AND/OR SEALANT HAS BEEN INSTALLED IN CONFORMANCE WITH APPLICABLE CODES, MATERIAL STANDARDS AND REGULATIONS.**

SIGNATURE - INSULATION CONTRACTOR	TITLE	DATE
	MANAGER	6/1/98
SIGNATURE - GENERAL CONTRACTOR	TITLE	DATE
	SACRAMENTO	7/16/98

REMARKS

# Certification of Compliance School District Development Fees

*(Print or Type) If Printing, press hard for four copies*

## PART I To be completed by the APPLICANT

OWNER'S NAME \_\_\_\_\_  
 OWNER'S ADDRESS \_\_\_\_\_  
 PROJECT ADDRESS 1 NIKKI Ct  
 PARCEL NUMBER \_\_\_\_\_ LOT NO. 5  
 SUBDIVISION NAME \_\_\_\_\_  
 NUMBER OF UNITS \_\_\_\_\_

*Upon payment of the fees listed below, a 90-day approval period commences upon which the applicant paying the fees may protest such fees. Any failure to file such protest within the 90-day period shall result in forfeiture of any rights to challenge such fees, through litigation or otherwise.*

APPLICANT'S SIGNATURE \_\_\_\_\_  
 TITLE OF APPLICANT \_\_\_\_\_  
 DATE \_\_\_\_\_ PHONE NUMBER 70200

## PART II To be completed by BUILDING DEPARTMENT

PLAN IDENTIFICATION NUMBER 1324  
 BUILDING TYPE  
 RESIDENTIAL ( ) APARTMENT/CONDOMINIUM ( ) COMMERCIAL/INDUSTRIAL ( )  
 SQUARE FEET OF CHARGEABLE BUILDING AREA 1324  
 SIGNATURE \_\_\_\_\_  
 TITLE \_\_\_\_\_ DATE \_\_\_\_\_

## PART III To be completed by SCHOOL DISTRICT

SCHOOL DISTRICT \_\_\_\_\_  
 DISTRICT CERTIFICATION NO. 20595  
 EXEMPT \_\_\_\_\_ COMMENTS \_\_\_\_\_

RESIDENTIAL/APT/CONDO	<u>1324</u> SQ FT X \$	<u>1.93</u>	= \$	<u>2555.32</u>
COMMERCIAL/INDUSTRIAL	SQ FT X \$		= \$	
OTHER FEE TYPE	<u>1324</u> SQ FT X \$	<u>1.34</u>	= \$	<u>1774.16</u>
TOTAL FEES COLLECTED	<u>1324</u>	<u>3.27</u>	= \$	<u>4329.48</u>

This Certification covers only the amount of square footage indicated above. Any additions or corrections to the square footage for this project will require an amendment to the Certificate of Compliance.

As the authorized school district official, I hereby certify that the requirements of Government Code Section 65995 and any other authorized requirements have been complied with by the above signed applicant.

## AUTHORIZED SCHOOL DISTRICT OFFICIAL

SIGNATURE \_\_\_\_\_ DATE \_\_\_\_\_  
 TITLE \_\_\_\_\_

**PAID**  
**MAR 09 1998**

Facilities Planning  
Elk Grove Unified School District  
3rd copy: Applicant

NOTE: THIS PLOT IS PREPARED TO SHOW THE DIMENSIONAL RELATIONSHIP FROM BUILDING FOUNDATION TO PROPERTY LINE, DESIGN DRAINAGE ELEVATIONS, AND DIRECTION OF DRAINAGE FLOW TO CONFORM WITH LOCAL ORDINANCES FOR THE PURPOSES OF BUILDING PERMIT ISSUANCE. INFORMATION SHOWN IS APPROXIMATE EXCEPT FOR THOSE SETBACKS WHICH ARE MINIMUMS REQUIRED BY ORDINANCE.

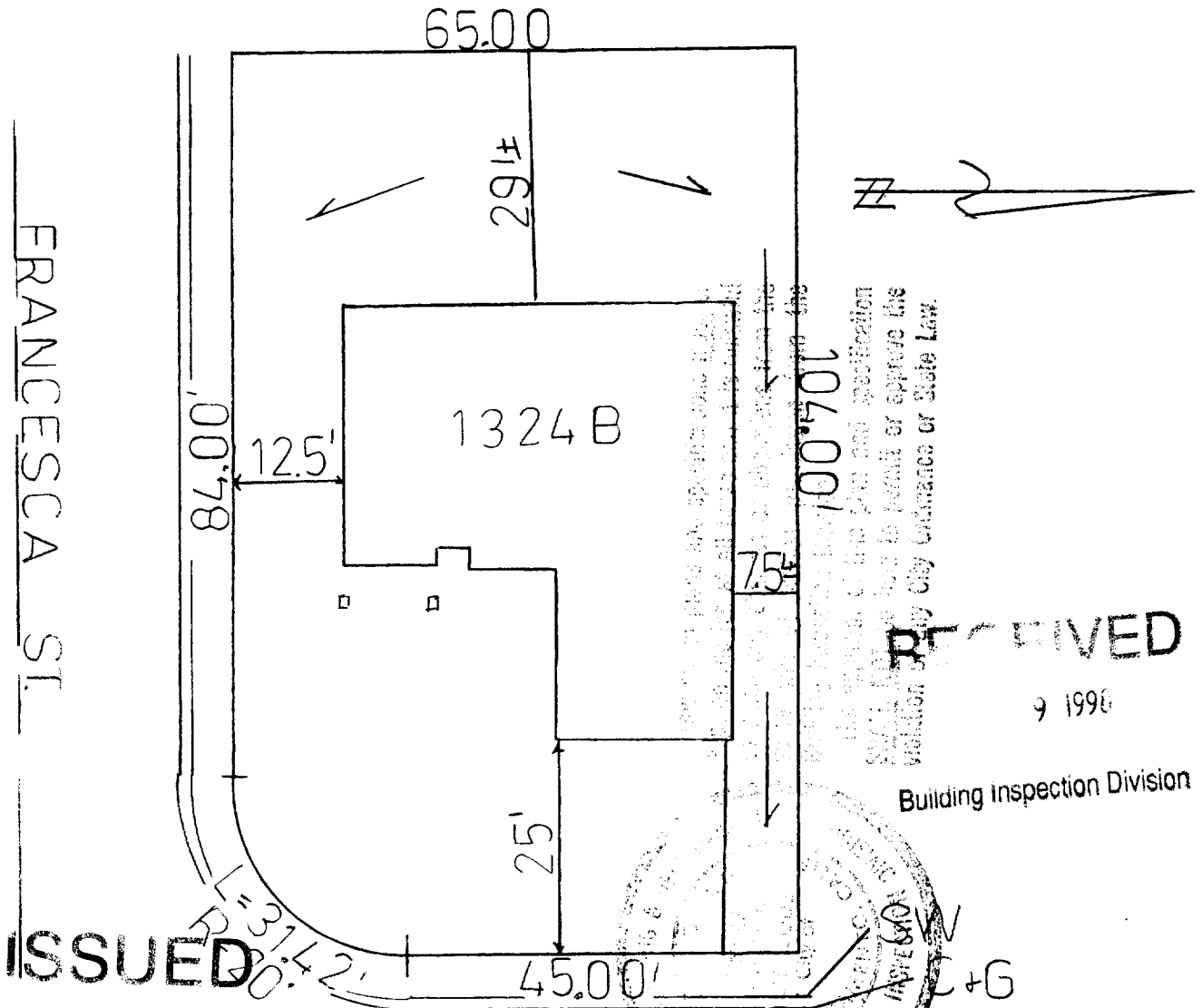

ISSUED

MAR 09 1998

RECEIVED  
9 1998  
Building Inspection Division

DEPARTMENT SERVICES DIV NIKKI CT.

NOTE: THIS PLAN IS INTENDED TO REFERENCE THE BUILDING PLAN DESIGNATED FOR THIS LOT. ALL SETBACKS OTHER THAN THE MINIMUM CODE REQUIREMENTS ARE APPROXIMATE. AS BUILT FIELD CONDITIONS MAY VARY.

NOTE: FOR INFORMATIONAL PURPOSES ONLY. TITLE RECORDS SHOULD BE CONSULTED FOR LOCATION OF EASEMENTS AND BOUNDARIES AND EXACT DIMENSIONS. THIS PLAN DOES NOT SHOW UNDERGROUND UTILITIES.

**ASTIKOS RANCH**

**LOT #5**  
 PARCEL #: 117-1000-005  
 ADDRESS: 1 NIKKI COURT  
 COUNTY: SACRAMENTO

**The Forecast Group**  
 1796 Tribute Road, Suite 100  
 Sacramento, CA 95815  
 (916) 920-0200

Scale 1"=20'

DATE: 2/16/98

DRAWN BY: MAH