

**CITY OF SACRAMENTO**  
1231 I Street, Sacramento, CA 95814

**Permit No: 0404329**  
**Insp Area: 2**  
**Thos Bros: 337D4**

**Site Address: 201 HIGHFIELD CR SAC**  
Parcel No: MEADOWVIEW ESTATES LOT 195

Sub-Type: NSFR  
Housing (Y/N): N

CONTRACTOR  
JTS COMMUNITIES  
401 WATT AV.  
SACRAMENTO CA. 95864

OWNER

ARCHITECT

**Nature of Work: JTS MP114 1 STORY 9 ROOM SFR**

**CONSTRUCTION LENDING AGENCY :** I hereby affirm under penalty of perjury that there is a construction lending agency for the performance of the work for which this permit is issued (Sec. 3097, Civ. C).

Lender's Name \_\_\_\_\_ Lender's Address \_\_\_\_\_

**LICENSED CONTRACTORS DECLARATION:** I hereby affirm under penalty of perjury that I am licensed under provisions of Chapter 9 (commencing with section 7000) of Division 3 of the Business and Professions Code and my license is in full force and effect.

License Class B License Number 767107 Date 4/02/04 Contractor Signature Ronald Caldwell

**OWNER-BUILDER DECLARATION:** I hereby affirm under penalty of perjury that I am exempt from the contractors License Law for the following reason (Sec. 7031.5, Business and Professions Code; any city or county which requires a permit to construct, alter, improve, demolish, or repair any structure, prior to its issuance, also requires the applicant for such permit to file a signed statement that he or she is licensed pursuant to the provisions of the Contractors License Law (Chapter 9 (commencing with Section 7000) of Division 8 of the Business and Professions Code) or that he or she is exempt therefrom and the basis for the alleged exemption. Any violation of Section 7031.5 by any applicant for a permit subjects the applicant to a civil penalty of not more than five hundred dollars (\$500.00);

\_\_\_\_\_, I, as a owner of the property, or my employees with wages as their sole compensation, will do the work, and the structure is not intended or offered for sale (Sec. 7044, Business and Professional Code: The Contractors License Law does not apply to an owner of property who builds or improves thereon, and who does such work himself or herself or through his/her own employees, provided that such improvements are not intended or offered for sale. If, however, the building or improvement is sold within one year of completion, the owner-builder will have the burden of proving that he/she did not build or improve for the purpose of sale.)

\_\_\_\_\_, I, as owner of the property, am exclusively contracting with licensed contractors to construct the project (Sec. 7044, Business and Professions Code: The Contractors License Law does not apply to an owner of property who builds or improves thereon, and who contracts for such projects with a contractor(s) licensed pursuant to the Contractors License Law).

I am exempt under Sec. \_\_\_\_\_ B & PC for this reason: \_\_\_\_\_

Date \_\_\_\_\_ Owner Signature \_\_\_\_\_

**IN ISSUING THIS BUILDING PERMIT,** the applicant represents, and the city relies on the representation of the applicant, that the applicant verified all measurements and locations shown on the application or accompanying drawings and that the improvement to be constructed does not violate any law or private agreement relating to permissible or prohibited locations for such improvements. This building permit does not authorize any illegal location of any improvement or the violation of any private agreement relating to location of improvements.

I certify that I have read this application and state that all information is correct. I agree to comply with all city and county ordinances and state laws relating to building construction and hereby authorize representative(s) of this city to enter upon the aforementioned property for inspection purposes.

Date 4/02/04 Applicant/Agent Signature Ronald Caldwell

**WORKER'S COMPENSATION DECLARATION:** I hereby affirm under penalty of perjury one of the following declarations:

\_\_\_\_\_, I have and will maintain a certificate of consent to self-insure for workers' compensation as provided for by Section 3700 of the Labor Code, for the performance of work for which the permit is issued.

I have and will maintain workers' compensation insurance, as required by Section 3700 of the Labor Code, for the performance of the work for which this permit is issued. My workers' compensation insurance carrier and policy number are:

Carrier ZURICH INSURANCE CO Policy Number WC367556101 Exp Date 03/01/2004

\_\_\_\_\_, (This section need not be completed if the permit is for \$100 or less) I certify that in the performance of the work for which this permit is issued, I shall not employ any person in any manner so as to become subject to the workers' compensation laws of California and agree that if I should become subject to the workers' compensation provisions of Section 3700 of the Labor Code, I shall forthwith comply with those provisions.

Date 4/02/04 Applicant Signature Ronald Caldwell

**WARNING: FAILURE TO SECURE WORKER'S COMPENSATION COVERAGE IS UNLAWFUL AND SHALL SUBJECT AN EMPLOYER TO CRIMINAL PENALTIES AND CIVIL FINES UP TO ONE HUNDRED THOUSAND DOLLARS (\$100,000) IN ADDITION TO THE COST OF COMPENSATION, DAMAGES AS PROVIDED FOR IN SECTION 3706 OF THE LABOR CODE, INTEREST AND ATTORNEY'S FEE.**

**THIS PERMIT SHALL EXPIRE BY LIMITATION IF WORK IS NOT COMMENCED WITHIN 180 DAYS.**

ORIGINAL

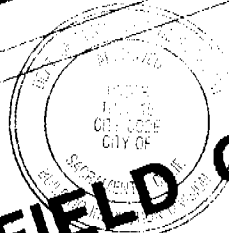
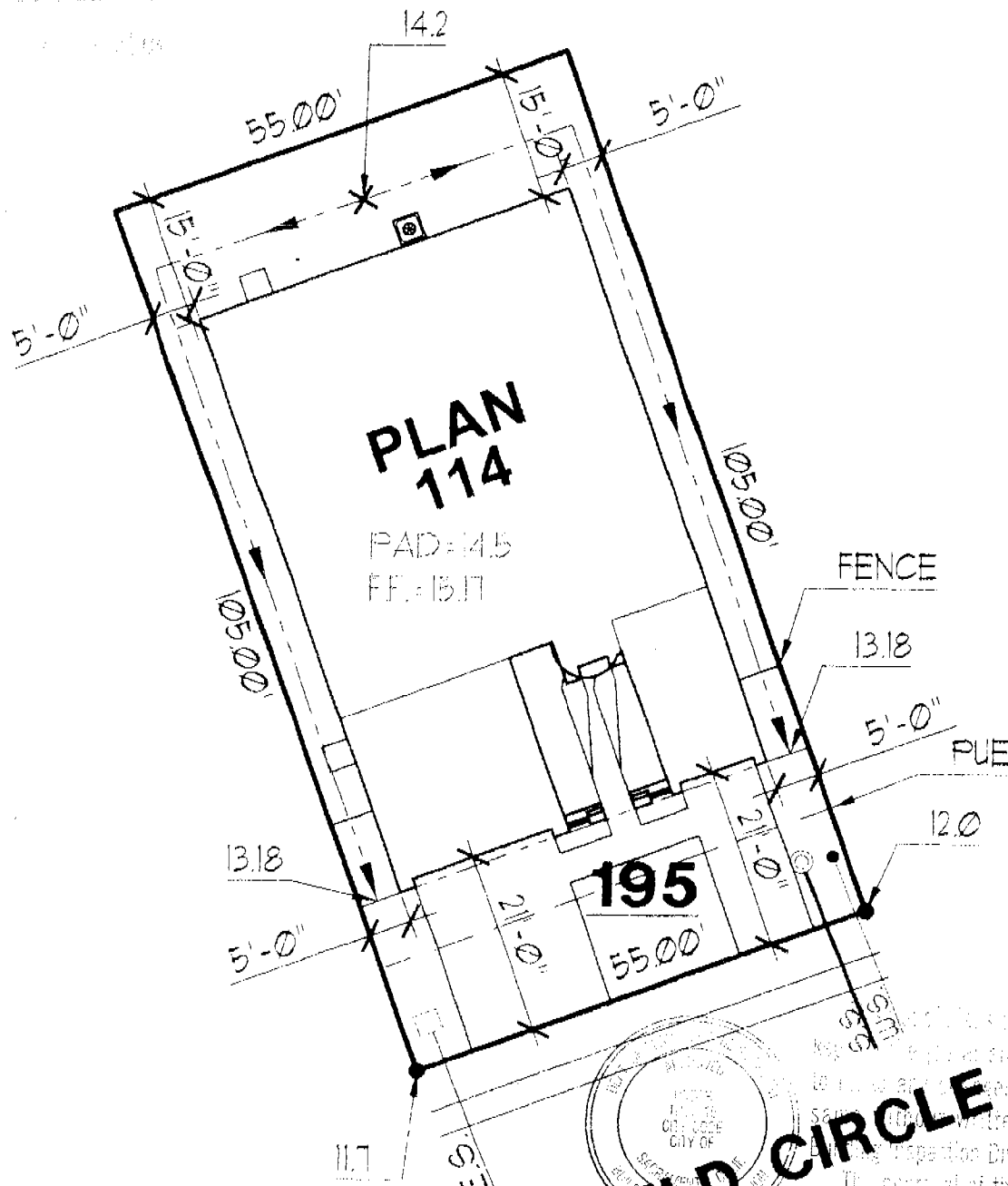

**HIGHFIELD CIRCLE**

The approval of this plan and specifications SHALL NOT be held to permit or approve the violation of any City Ordinance or State Law.

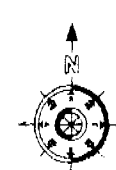

DIMENSIONS SHOWN ARE APPROXIMATE AND ARE FOR THE SOLE PURPOSE OF COUNTY/CITY APPROVAL. ADDITIONAL INFORMATION REFLECTED ON THIS DOCUMENT SUCH AS FENCE, WALL, UTILITY, AND MAIL BOX LOCATIONS ARE SUBJECT TO CHANGE WITHOUT NOTIFICATION TO BUYER. THIS PLOT PLAN MAY NOT REFLECT ALL "AS BUILT" CONDITIONS WHICH MIGHT VARY FROM THIS PROPOSED PLOT PLAN.

|  |                           |   |   |
|--|---------------------------|---|---|
| 1 STORY HOUSE<br>3 CAR GARAGE<br><br>APN # | <b>PROPOSED SITE PLAN</b> | <b>JTS</b><br><small>Working Together to Achieve Excellence</small><br>401 Watt Avenue<br>Sacramento, CA 95821 (916) 487-3434 | <b>MEADOWVIEW ESTATES</b><br><br>SCALE = 1" = 20'<br>DATE FEB 23 2004 |
| APPROVED FOR RELEASE _____ DATE _____      |                           | APPROVED FOR RELEASE _____ DATE _____   |   |

**INSTALLATION CERTIFICATE**

**CF-6R**

LOT - PLAN JTS Communities - The Meadows Permit Number

**Site Address**

An installation certificate is required to be posted at the building site or made available for all appropriate inspections. (The information provided on this form is required; however, use of this form to provide the information is optional.) After completion of final inspection a copy must be provided to the building department (upon request) and the building owner at occupancy, per Section 10-103(b).

**HVAC SYSTEMS:**

**Heating Equipment**

| Equip. Type (pkg. Heat pump) | CEC Certified Mfr name and Model # | # of Identical Systems | (1) Efficiency (AFUE, etc.) > CF-1R value | Duct Location (attic, etc.) | Duct or Piping R-value | Heating Load (Btu/hr) | Heating Capacity (Btu/hr) | PLAN   |
|------------------------------|------------------------------------|------------------------|---|-----------------------------|------------------------|-----------------------|---------------------------|--------|
| FURNACE                      | York #P4HUA12L048                  | 1                      | 80%                                       | ATTIC                       | 4.2                    | 26,065                | 60,000                    | 103    |
| FURNACE                      | York #P4HUA12L048                  | 1                      | 80%                                       | ATTIC                       | 4.2                    | 29,452                | 60,000                    | 104    |
| FURNACE                      | York #P4HUB16L064                  | 1                      | 80%                                       | ATTIC                       | 4.2                    | 36,474                | 80,000                    | 108    |
| FURNACE                      | York #P4HUB16L064                  | 1                      | 80%                                       | ATTIC                       | 4.2                    | 37,762                | 80,000                    | 114    |
| FURNACE                      | York #P4HUC20L080                  | 1                      | 80%                                       | ATTIC                       | 4.2                    | 43,093                | 100,000                   | 115    |
| FURNACE                      | York #P4HUC20L080                  | 1                      | 80%                                       | ATTIC                       | 4.2                    | 40,199                | 100,000                   | 116    |
| FURNACE                      | York #P4HUB16L064                  | 1                      | 80%                                       | ATTIC                       | 4.2                    | 42,336                | 80,000                    | 119    |
| FURNACE                      | York #P4HUC20L080                  | 1                      | 80%                                       | ATTIC                       | 4.2                    | 35,914                | 100,000                   | 134    |
| FURNACE                      | York #P4HUA12L032                  | 1                      | 80%                                       | ATTIC                       | 4.2                    | 44,950                | 40,000                    | 151    |
| FURNACE                      | York #P4HUA12L048                  | 1                      | 80%                                       | ATTIC                       | 4.2                    | 24,199                | 60,000                    | 152    |
| FURNACE                      | York #P4HUA12L048                  | 1                      | 80%                                       | ATTIC                       | 4.2                    | 30,299                | 60,000                    | 153    |
| FURNACE                      | York #P4HUB16L064                  | 1                      | 80%                                       | ATTIC                       | 4.2                    | 39,865                | 80,000                    | 154    |
| FURNACE                      | York #P4HUA12L032                  | 1                      | 80%                                       | ATTIC                       | 4.2                    | 20,477                | 40,000                    | 155 U1 |
| FURNACE                      | York #P4HUA12L032                  | 1                      | 80%                                       | ATTIC                       | 4.2                    | 20,477                | 40,000                    | 155 U2 |

**Cooling Equipment**

| Equip. Type (pkg. Heat pump) | CEC Certified Compressor Unit: Mfr Name and Model # | # of Identical Systems | (1) Efficiency (SEER, etc.) > CF-1R value | Duct Location (attic, etc.) | Duct R-value | Cooling Load (Btu/hr) | Cooling Capacity (Btu/hr) | PLAN   |
|------------------------------|---|------------------------|---|-----------------------------|--------------|-----------------------|---------------------------|--------|
| A/C                          | York #H*RA030                                       | 1                      | 10.0                                      | ATTIC                       | 4.2          | 23,615                | 28,400                    | 103    |
| A/C                          | York #H*RA030                                       | 1                      | 10.0                                      | ATTIC                       | 4.2          | 26,104                | 28,400                    | 104    |
| A/C                          | York #H*RA048                                       | 1                      | 10.0                                      | ATTIC                       | 4.2          | 33,975                | 44,000                    | 108    |
| A/C                          | York #H*RA036                                       | 1                      | 10.0                                      | ATTIC                       | 4.2          | 30,577                | 33,400                    | 114    |
| A/C                          | York #H*RA048                                       | 1                      | 10.0                                      | ATTIC                       | 4.2          | 35,417                | 44,000                    | 115    |
| A/C                          | York #H*RA048                                       | 1                      | 10.0                                      | ATTIC                       | 4.2          | 40,080                | 44,000                    | 116    |
| A/C                          | York #H*RA036                                       | 1                      | 10.0                                      | ATTIC                       | 4.2          | 31,747                | 33,400                    | 119    |
| A/C                          | York #H*RA048                                       | 1                      | 10.0                                      | ATTIC                       | 4.2          | 39,518                | 44,000                    | 134    |
| A/C                          | York #H*RA048                                       | 1                      | 10.0                                      | ATTIC                       | 4.2          | 21,687                | 23,200                    | 151    |
| A/C                          | York #H*RA024                                       | 1                      | 10.0                                      | ATTIC                       | 4.2          | 25,605                | 28,400                    | 152    |
| A/C                          | York #H*RA030                                       | 1                      | 10.0                                      | ATTIC                       | 4.2          | 27,282                | 28,400                    | 153    |
| A/C                          | York #H*RA042                                       | 1                      | 10.0                                      | ATTIC                       | 4.2          | 25,092                | 42,000                    | 154    |
| A/C                          | York #H*RA024                                       | 1                      | 10.0                                      | ATTIC                       | 4.2          | 19,817                | 23,200                    | 155 U1 |
| A/C                          | York #H*RA024                                       | 1                      | 10.0                                      | ATTIC                       | 4.2          | 18,817                | 23,200                    | 155 U2 |

(1) > reads greater than or equal to.

I, the undersigned, verify that equipment listed above is: 1) the actual equipment installed, 2) equivalent to or more efficient than that specified in the certificate of compliance (Form CF-1R) submitted for compliance with the Energy Efficiency Standards for residential buildings, and 3) equipment that meets or exceeds the appropriate requirements for manufactured appliances (from the Energy Efficiency Regulations or Part 6), where applicable.

Signature: Date

BEUTLER CORPORATION  
Installing Subcontractor (Co. Name)  
OR General Contractor (Co. Name) OR Owner

**WATER HEATING SYSTEMS:**

| Heater Type | CEC Certified Mfr Name & Model # | Distribution Type (Std. point of use) | If Recirculation Control Type | # of Identical Systems | (2) Rated Input (kW or Btu/hr) | Tank Volume (gallons) | (3) Efficiency (EF, RE) | (2) Standby Loss (%) | External Insulation R-value |
|-------------|----------------------------------|---------------------------------------|-------------------------------|------------------------|--------------------------------|-----------------------|-------------------------|----------------------|-----------------------------|
|-------------|----------------------------------|---------------------------------------|-------------------------------|------------------------|--------------------------------|-----------------------|-------------------------|----------------------|-----------------------------|

# CERTIFICATION OF INSULATION

|   |   |                              |                              |                                     |   |                 |   |                        |                      |  |
|---|---|------------------------------|------------------------------|-------------------------------------|---|-----------------|---|------------------------|----------------------|--|
| PART I<br>GENERAL   | ADDRESS OR TRACT  |                              | SACRAMENTO BUILDING PRODUCTS |                                     |   |                 |   |                        |                      |  |
|   | <p style="font-size: 2em; margin: 0;"><i>JTS</i></p> <p style="font-size: 1.5em; margin: 0;"><i>The Masters</i></p> <p style="font-size: 1.5em; margin: 0;"><i>Meadowview</i></p> |                              | LOT # <i>195</i>             |                                     | <input type="checkbox"/> P.O. BOX 854, WEST SACRAMENTO, CA 95691 LIC. #202026<br><input type="checkbox"/> 1309 MELODY ROAD, MARYSVILLE, CA 95901 LIC. #202026<br><input type="checkbox"/> P.O. BOX 9651, FRESNO, CA 93793-9651 LIC. #202026<br><input type="checkbox"/> P.O. BOX 1631, RENO, NV 89505 LIC. #10675<br><input type="checkbox"/> 3326 A PONDEROSA WAY, LAS VEGAS, NV 89118 LIC. #10675 |                 |   |                        |                      |  |
|   |   | DATE INSULATION COMPLETED    |                              |                                     |   |                 |   |                        |                      |  |
| PART II<br>AREAS<br>INSULATED   | WALLS   |                              |                              | CEILINGS                            |   |                 | FLOORS                                      |                        |                      |  |
|   | (                      SQUARE FEET)   |                              |                              | (                      SQUARE FEET) |   |                 | (                      SQUARE FEET)         |                        |                      |  |
|   | TYPE OF INSULATION  |                              |                              | TYPE OF INSULATION                  |   |                 | TYPE OF INSULATION                          |                        |                      |  |
|   | MATERIAL <b>FIBERGLASS</b>  |                              |                              | MATERIAL <b>FIBERGLASS</b>          |   |                 | MATERIAL <b>FIBERGLASS</b>                  |                        |                      |  |
|   | FORM <b>BATTS</b>   |                              |                              | FORM <b>BATTS &amp; BLOW</b>        |   |                 | FORM <b>BATTS</b>                           |                        |                      |  |
|   | MANUFACTURER'S PRODUCT I.D.   |                              |                              | MANUFACTURER'S PRODUCT I.D.         |   |                 | MANUFACTURER'S PRODUCT I.D.                 |                        |                      |  |
|   | MANUFACTURER  |                              |                              | MANUFACTURER                        |   |                 | MANUFACTURER                                |                        |                      |  |
|   | CT  | OC                           | JM                           | CT                                  | OC  | JM              | CT  | OC                     | JM                   |  |
|   | BAGS  |                              |                              |                                     |   |                 |   |                        |                      |  |
|   | R - VALUE<br>INSTALLED  | APPLIED<br>THICKNESS         |                              | R - VALUE<br>INSTALLED              | APPLIED<br>THICKNESS  |                 | MIN. INSTALLED<br>WEIGHT PER<br>SQUARE FOOT | R - VALUE<br>INSTALLED | APPLIED<br>THICKNESS |  |
|   | <i>13</i><br><i>19</i>  | <i>3 1/2</i><br><i>5 1/2</i> |                              | <i>30</i>                           | <i>10 1/4</i>   |                 |   |                        |                      |  |
|   | KNEE WALLS IF R-VALUE IS OTHER THAN WALLS ABOVE   |                              |                              |                                     |   |                 |   |                        |                      |  |
| MATERIAL <b>FIBERGLASS</b>  |   | FORM <b>BATTS</b>            |                              | R VALUE                             |   |                 | MANUFACTURER                                |                        |                      |  |
|   |   |                              |                              |                                     |   |                 | CT  | OC                     | JM                   |  |
| AIR INFILTRATION SEALANT  |   |                              |                              |                                     |   |                 |   |                        |                      |  |
| MATERIAL  |   |                              |                              |                                     |   | MANUFACTURER    |   |                        |                      |  |
|   |   |                              |                              |                                     |   | <b>HILTI</b>    |   | <b>HANDY FOAM</b>      |                      |  |
| THIS IS TO CERTIFY THAT INSULATION AND/OR SEALANT HAS BEEN INSTALLED IN CONFORMANCE WITH APPLICABLE<br>CODES, MATERIAL STANDARDS AND REGULATIONS. |   |                              |                              |                                     |   |                 |   |                        |                      |  |
| SIGNATURE — INSULATION CONTRACTOR   |   |                              |                              | TITLE <b>MANAGER</b>                |   | DATE            |   |                        |                      |  |
| SIGNATURE — GENERAL CONTRACTOR <i>J. C.</i>   |   |                              |                              |                                     |   | DATE <i>8-3</i> |   |                        |                      |  |
| REMARKS   |   |                              |                              |                                     |   |                 |   |                        |                      |  |