

CITY OF SACRAMENTO
1231 I Street, Sacramento, CA 95814

Permit No: 0012793
Insp Area: 4

Site Address: 3385 SWALLOWS NEST DR SAC
Parcel No: COSTA BL AT SW NEST LOT 36

Sub-Type: NSFR
Housing (Y/N): N

CONTRACTOR
REGIS CONTRACTORS
1425 RIVER PARK DR SUITE 530
SACRAMENTO CA. 95815

OWNER

ARCHITECT

Nature of Work: MP 2293 1 STORY 8 ROOM SFR

CONSTRUCTION LENDING AGENCY : I hereby affirm under penalty of perjury that there is a construction lending agency for the performance of the work for which this permit is issued (Sec. 3097, Civ. C).

Lender's Name _____ Lender's Address _____

LICENSED CONTRACTORS DECLARATION: I hereby affirm under penalty of perjury that I am licensed under provisions of Chapter 9 (commencing with section 7000) of Division 3 of the Business and Professions Code and my license is in full force and effect.

License Class _____ License Number _____ Date 11-2-00 Contractor Signature Don Moon

OWNER-BUILDER DECLARATION: I hereby affirm under penalty of perjury that I am exempt from the contractors License Law for the following reason (Sec. 7031.5, Business and Professions Code; any city or county which requires a permit to construct, alter, improve, demolish, or repair any structure, prior to its issuance, also requires the applicant for such permit to file a signed statement that he or she is licensed pursuant to the provisions of the Contractors License Law (Chapter 9 (commencing with Section 7000) of Division 3 of the Business and Professions Code) or that he or she is exempt therefrom and the basis for the alleged exemption. Any violation of Section 7031.5 by any applicant for a permit subjects the applicant to a civil penalty of not more than five hundred dollars (\$500.00).

_____, I, as a owner of the property, or my employees with wages as their sole compensation, will do the work, and the structure is not intended or offered for sale (Sec. 7044, Business and Professional Code). The Contractors License Law does not apply to an owner of property who builds or improves thereon, and who does such work himself or herself or through his/her own employees, provided that such improvements are not intended or offered for sale. If, however, the building or improvement is sold within one year of completion, the owner-builder will have the burden of proving that he/she did not build or improve for the purpose of sale.)

_____, I, as owner of the property, am exclusively contracting with licensed contractors to construct the project (Sec. 7044, Business and Professions Code). The Contractors License Law does not apply to an owner of property who builds or improves thereon, and who contracts for such projects with a contractor(s) licensed pursuant to the Contractors License Law.)

_____, I am exempt under Sec. _____ B & PC for this reason: _____

Date _____ Owner Signature _____

IN ISSUING THIS BUILDING PERMIT, the applicant represents, and the city relies on the representation of the applicant, that the applicant verified all measurements and locations shown on the application or accompanying drawings and that the improvement to be constructed does not violate any law or private agreement relating to permissible or prohibited locations for such improvements. This building permit does not authorize any illegal location of any improvement or the violation of any private agreement relating to location of improvements.

I certify that I have read this application and state that all information is correct. I agree to comply with all city and county ordinances and state laws relating to building construction and hereby authorize representative(s) of this city to enter upon the abovementioned property for inspection purposes.

Date 11-2-00 Applicant/Agent Signature Don Moon

WORKER'S COMPENSATION DECLARATION: I hereby affirm under penalty of perjury one of the following declarations:

_____, I have and will maintain a certificate of consent to self-insure for workers' compensation as provided for by Section 3700 of the Labor Code, for the performance of work for which the permit is issued.

I have and will maintain workers' compensation insurance, as required by Section 3700 of the Labor Code, for the performance of the work for which this permit is issued. My workers' compensation insurance carrier and policy number are:

Carrier LIBERTY MUTUAL Policy Number WC2-151-030013-019

_____, (This section need not be completed if the permit is for \$100 or less) I certify that in the performance of the work for which this permit is issued, I shall not employ any person in any manner so as to become subject to the workers' compensation laws of California and agree that if I should become subject to the workers' compensation provisions of Section 3700 of the Labor Code, I shall forthwith comply with those provisions.

Date 11-2-00 Applicant Signature Don Moon

WARNING: FAILURE TO SECURE WORKER'S COMPENSATION COVERAGE IS UNLAWFUL AND SHALL SUBJECT AN EMPLOYER TO CRIMINAL PENALTIES AND CIVIL FINES UP TO ONE HUNDRED THOUSAND DOLLARS (\$100,000) IN ADDITION TO THE COST OF COMPENSATION, DAMAGES AS PROVIDED FOR IN SECTION 3706 OF THE LABOR CODE, INTEREST AND ATTORNEY'S FEE.

THIS PERMIT SHALL EXPIRE BY LIMITATION IF WORK IS NOT COMMENCED WITHIN 180 DAYS.

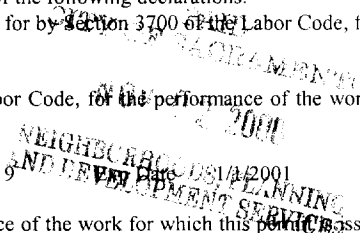



INSULATION CONTRACTORS ASSOCIATION OF AMERICA

INSULATION CERTIFICATE
63758

1321 DUKE STREET SUITE 303 • ALEXANDRIA, VA 22314 • (703) 739-0356

THIS IS TO CERTIFY THAT INSULATION HAS BEEN INSTALLED IN CONFORMANCE WITH CURRENT ENERGY REGULATIONS, CALIFORNIA ADMINISTRATIVE CODE, TITLE 24, STATE OF CALIFORNIA, IN THE BUILDING LOCATED AT:

REBELS HOMES LOT # 30 TRACT # _____

STREET 3385 SWALLOW NEST LANE SACRAMENTO

EXTERIOR WALLS

MANUFACTURER _____ THICKNESS / TYPE _____ VALUE _____ R-

CEILING

BATTS

MANUFACTURER _____ THICKNESS / TYPE _____ VALUE _____ R

BLOWN IN

MANUFACTURER CF WINDSAFE III THICKNESS 12" VALUE 30 R

SUBJECT TO THE FOLLOWING: 2200 NUMBER OF BASIS SETS

EXTERIOR

MANUFACTURER _____ THICKNESS / TYPE _____ VALUE _____ R

CEILING

MANUFACTURER _____ THICKNESS / TYPE _____ VALUE _____ R

FOUNDATION WALLS

MANUFACTURER _____ THICKNESS / TYPE _____ VALUE _____ R

GENERAL CONTRACTOR

NAME _____ TITLE _____

DATE _____

SIGNATURE _____

TITLE _____

INSULATION CONTRACTOR ARCADE INSULATION

CA CALIFORNIA CONTRACTORS LICENSE #263784

DATE 5-22-01

NAME [Signature] TITLE _____

NAME [Signature] TITLE _____

KWIKKOTE
STUCCO SYSTEM
INSTALLATION CARD

#C30234
REGIS CONTRACTORS
COSTA BLANCA LOT # 36
3385 SWALLOWS NEST SACRAMENTO

Stucco System Trade Name: KWIK KOTE
Name Stucco Manufacturer: KWIK KOTE CORP
ICBO Evaluation Service, Inc. Report No. 3607
Date of Job Completion 5-2-01

Stucco Contractor Kenyon Plastering, Inc.
Name John W. Kenyon, III
Address P.O. Box 2077
North Highlands, CA 95660
Telephone # (916) 349-8191

Approved Contractor Number as issued by the Stucco Manufacturer: 1

This is to certify that the stucco system on the building exterior at the above address had been installed in accordance with the evaluation report specified above and the manufacturer's instructions.

Signature of authorized representative of stucco contractor:

John Kenyon III

Date: 5-15-01

Builder Copy

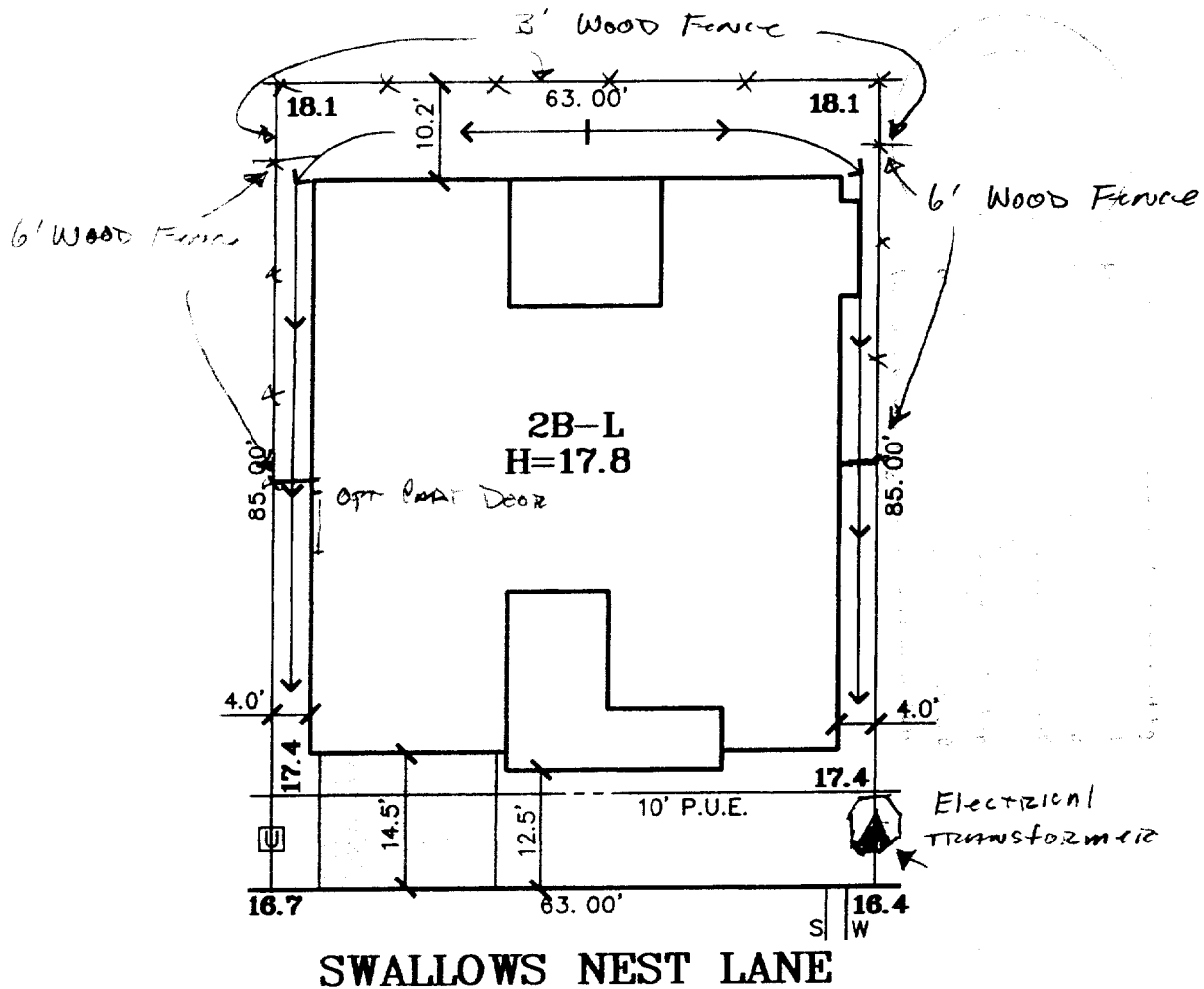

SCALE: 1" = 20'

DATE: 10-09-00

A.P.N.:

ADDRESS: 3385 SWALLOWS NEST LANE

LOT AREA: 5,355 SF
LOT COVERAGE: 43%

The Splink Corporation

2590 VENTURE OAKS WAY
SACRAMENTO, CA. 95833

PH (916)925-5550 FAX (916)921-9274

**COSTA BLANCA
AT SWALLOWS NEST**

LOT 36
PLAN 2B

COSTA BLANCA

CITY OF SACRAMENTO, CA
CLIENT: REGIS HOMES
JOB NO.: 7908-004