

CITY OF SACRAMENTO
1231 I Street, Sacramento, CA 95814

Permit No: 0012274
Insp Area: 4

Site Address: 2080 MOONSTONE WY SAC
Parcel No: 225-1410-049 NORTHPT PK 7-2 LOT 49

Sub-Type: NSFR
Housing (Y/N): N

CONTRACTOR
CENTEX HOMES
3360 DOUGLAS BLVD
STE 210 95661

OWNER

ARCHITECT

Nature of Work: NSFR MP1400 7 RMS

CONSTRUCTION LENDING AGENCY: I hereby affirm under penalty of perjury that there is a construction lending agency for the performance of the work for which this permit is issued (Sec. 3097, Civ. C).

Lender's Name N/A Lender's Address _____

LICENSED CONTRACTORS DECLARATION: I hereby affirm under penalty of perjury that I am licensed under provisions of Chapter 9 (commencing with section 7000) of Division 3 of the Business and Professions Code and my license is in full force and effect.

License Class B License Number 734094 Date 10-23-00 Contractor Signature Debbie Stowers

OWNER-BUILDER DECLARATION: I hereby affirm under penalty of perjury that I am exempt from the contractors License Law for the following reason (Sec. 7031.5, Business and Professions Code; any city or county which requires a permit to construct, alter, improve, demolish, or repair any structure, prior to its issuance, also requires the applicant for such permit to file a signed statement that he or she is licensed pursuant to the provisions of the Contractors License Law (Chapter 9 (commencing with Section 7000) of Division 3 of the Business and Professions Code) or that he or she is exempt therefrom and the basis for the alleged exemption. Any violation of Section 7031.5 by any applicant for a permit subjects the applicant to a civil penalty of not more than five hundred dollars (\$500.00).

I, as a owner of the property, or my employees with wages as their sole compensation, will do the work, and the structure is not intended or offered for sale (Sec. 7044, Business and Professional Code. The Contractors License Law does not apply to an owner of property who builds or improves thereon, and who does such work himself or herself or through his/her own employees, provided that such improvements are not intended or offered for sale. If, however, the building or improvement is sold within one year of completion, the owner-builder will have the burden of proving that he/she did not build or improve for the purpose of sale.)

I, as owner of the property, am exclusively contracting with licensed contractors to construct the project (Sec. 7044, Business and Professions Code. The Contractors License Law does not apply to an owner of property who builds or improves thereon, and who contracts for such projects with a contractor(s) licensed pursuant to the Contractors License Law)

I am exempt under Sec. _____ B & PC for this reason: _____

Date _____ Owner Signature _____

IN ISSUING THIS BUILDING PERMIT, the applicant represents, and the city relies on the representation of the applicant, that the applicant verified all measurements and locations shown on the application or accompanying drawings and that the improvement to be constructed does not violate any law or private agreement relating to permissible or prohibited locations for such improvements. This building permit does not authorize any illegal location of any improvement or the violation of any private agreement relating to location of improvements.

I certify that I have read this application and state that all information is correct. I agree to comply with all city and county ordinances and state laws relating to building construction and hereby authorize representative(s) of this city to enter upon the abovementioned property for inspection purposes.

Date 10-23-00 Applicant Agent Signature Debbie Stowers

WORKER'S COMPENSATION DECLARATION: I hereby affirm under penalty of perjury one of the following declarations:

I have and will maintain a certificate of consent to self-insure for workers' compensation as provided for by Section 3700 of the Labor Code, for the performance of work for which the permit is issued.

I have and will maintain workers' compensation insurance, as required by Section 3700 of the Labor Code, for the performance of the work for which this permit is issued. My workers' compensation insurance carrier and policy number are:

Carrier AMER. GUAR. & LIAB. INS. Policy Number WC8322096-02 Exp Date 10/01/2000

(This section need not be completed if the permit is for \$100 or less) I certify that in the performance of the work for which this permit is issued, I shall not employ any person in any manner so as to become subject to the workers' compensation laws of California and agree that if I should become subject to the workers' compensation provisions of Section 3700 of the Labor Code, I shall forthwith comply with those provisions.

Date 10-23-00 Applicant Signature Debbie Stowers

WARNING: FAILURE TO SECURE WORKER'S COMPENSATION COVERAGE IS UNLAWFUL AND SHALL SUBJECT AN EMPLOYER TO CRIMINAL PENALTIES AND CIVIL FINES UP TO ONE HUNDRED THOUSAND DOLLARS (\$100,000) IN ADDITION TO THE COST OF COMPENSATION, DAMAGES AS PROVIDED FOR IN SECTION 3706 OF THE LABOR CODE, INTEREST AND ATTORNEY'S FEE.

THIS PERMIT SHALL EXPIRE BY LIMITATION IF WORK IS NOT COMMENCED WITHIN 180 DAYS.

RESIDENTIAL BUILDING PERMIT APPLICATION

New Construction

Addition

Remodels

Other 12274

Project Address: 2080 Manstone Avenue

Assessor Parcel # 225-1410-049

LOT 49

OWNER INFORMATION:

Legal Property Owner: Center Homes Phone # 786-8693
Owner Address: 3700 Douglas Blvd #150 City Roseville State CA Zip 95661

CONTRACTOR INFORMATION:

Contractor: Center Homes Lic. # 734094 Phone # 786-8693 Fax# 786-6802

PROJECT INFORMATION:

Land Use Zone RIA Occupancy Group R3 Construction Type VN Fed Code 1A
No. of stories: 1 No. of rooms: _____ Street width: _____
1st Floor Area 1423 2nd Floor Area _____ Basement _____ Roof Material _____
AREA IN SQUARE FOOT OF:

	EXISTING	NEW
Dwelling/Living	_____	<u>1423</u>
Garage/Storage	_____	<u>401</u>
Decks/Balconies	_____	_____
Carports	_____	_____

SCOPE OF WORK: MP 1423 New SFR

FOR OFFICE USE ONLY

Information above complete AR Flood Waiver required Planning Approval
 Violation files checked Flood Elevation Certificate Required Design Review Approval
 Standard setbacks Water Development Infill Area Special Fee Districts Apply : _____
 County Sewer

NEW STRUCTURES & ADDITIONS

❖ THE FOLLOWING MUST BE PROVIDED IN ORDER TO SUBMIT FOR PLAN REVIEW

2 COMPLETE PLANS, LEGIBLE & DRAWN TO SCALE ❖ Plans to include: site plan, floor plan, elevations, roof/ceiling plan, foundation and structural framing details, and structural calculations for non-conforming structures.
 3 SETS IF PROJECT IS IN A DESIGN REVIEW AREA

 Title 24 Energy Compliance documentation 11" x 17" copy of floor plan for County Assessor
 Grading and Erosion Control Questionnaire Plan Review Fees

Date: _____

Received by: (staff) _____



CENTEX HOMES

3700 Douglas Blvd
Suite #150
Roseville, California, 95661

Phone: 916 786-6802
Fax: 916 786-6802

March 27, 2001

City of Sacramento
Building Department
1231 I Street, Suite 200
Sacramento, California 95814

Re: Northpointe / Northborough
Lot: 249
Address: 2080 Moonstone Ave

Dear Building Inspector:

This letter is to serve as a guarantee that Centex Homes will complete the front yard landscaping, on the above referenced lot. This shall be completed within 30 days from the close of escrow.

The delay is due to heavy rains last month, which has prevented us from completing the landscaping prior to the close of escrow.

We thank you for your cooperation in this matter.

Respectfully,

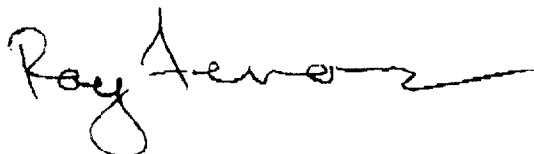

Ray Ferrarini
Area Construction Manager
Centex Homes, Sacramento Division

Cc: File

INSULATION CERTIFICATE

THIS IS TO CERTIFY THAT INSULATION HAS BEEN INSTALLED IN CONFORMANCE WITH THE CURRENT ENERGY REGULATIONS, CALIFORNIA ADMINISTRATION CODE, TITLE 24, STATE OF CALIFORNIA, IN THE BUILDING LOCATED AT:

SITE ADDRESS: LOT 249 NORTHPOINTE SACRAMENTO, CA
STREET CITY STATE

CEILING:

BLOW: MANUFACTURER GREENSTONE THICKNESS 10.3" R-VALUE 36
SQUARE FEET 1162 # BAGS/LBS PER BAGS 57

BATTS: MANUFACTURER JOHNS MANVILLE THICKNESS 13" R-VALUE 38
JOHNS MANVILLE

EXTERIOR WALLS:

MANUFACTURER JOHNS MANVILLE THICKNESS 3.5" R-VALUE 13
JOHNS MANVILLE

FLOOR INSULATION:

MANUFACTURER JOHNS MANVILLE THICKNESS N/A R-VALUE N/A

AIR INFILTRATION:

(TITLE 24)
YES NO

OTHER: _____

GENERAL CONTRACTOR: CENTEX HOMES LICENSE # _____

BY: _____ TITLE _____ DATE _____

INSULATION CONTRACTOR: WESTERN INSULATION, INC. LICENSE # 481278

BY: TAWNIA PERCE TITLE AUTH. AGENT DATE 4/21/01

Note to Buyer: This plot plan is provided as a general layout of the property. All information on this plan, including but not limited to tree locations and sizes, setback dimensions, driveway grades, and wall heights and locations, are approximate and may vary or change without prior notice.

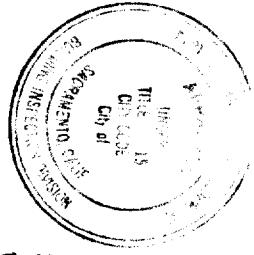
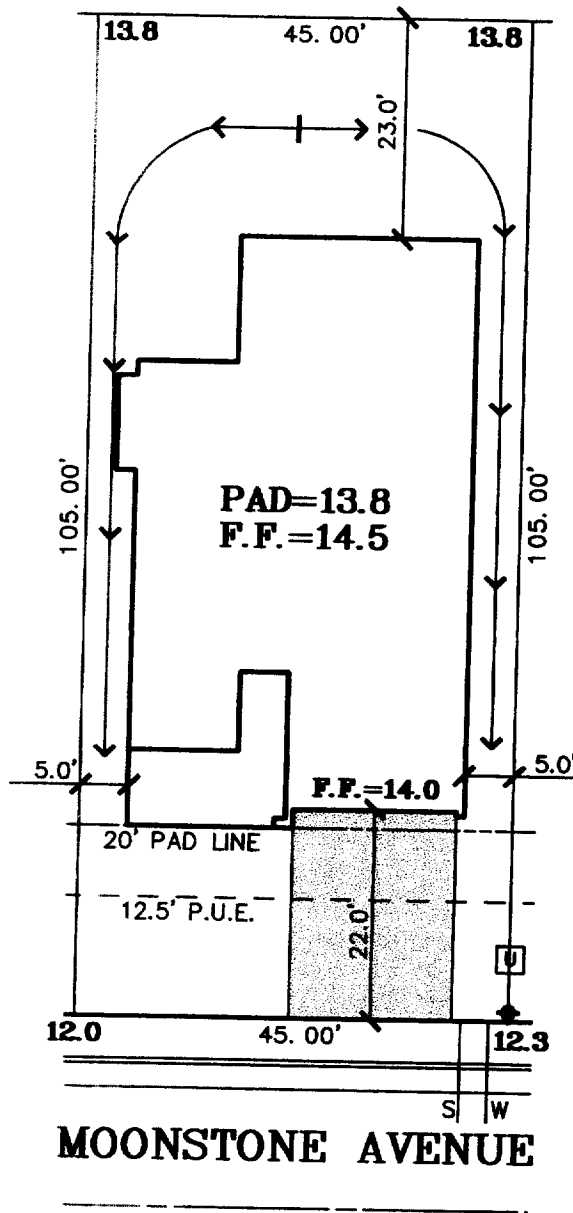

The approval of this plan and specification SHALL NOT be held to permit or approve the violation of any City Ordinance or State Law.

SCALE: 1" = 20'

LOT 49
PLAN 1423B RIGHT
A.P.N.:
ADDRESS: 2080 MOONSTONE AVENUE
LOT AREA: 4,725 SF
LOT COVERAGE: 43%

READ AND APPROVED
 Plan 1423 Land Development St 9/20
 Elevation B Const. Manager _____
 Orientation G-Rt Sales Appr. _____
 Color 5 Field Manager _____

The Splink Corporation
 2590 VENTURE OAKS WAY
 SACRAMENTO, CA 95833
 PH:(916)925-6660 FAX:(916)921-9274

CENTEX HOMES
 3700 Douglas Boulevard
 Suite 150
 Roseville, Ca. 95661
 office: (916) 786-8693
 fax: (916) 786-6802

NORTHPOINTE PARK
UNIT NO. 7 PHASE 2
 City of Sacramento, California

Scale: 1"=20' September 20, 2000