

**CITY OF SACRAMENTO**  
1231 I Street, Sacramento, CA 95814

**Permit No: 0105427**  
**Insp Area: 4**

**Site Address: 140 MENARD CR SAC**  
Parcel No: 225-1280-042 NORTHPT PK 13-2 LOT 31

**Sub-Type: NSFR**  
**Housing (Y/N): N**

CONTRACTOR  
WESTERN PACIFIC HOUSING  
210 CENTRAL BLVD  
BRENTWOOD CA 94513

OWNER

ARCHITECT

**Nature of Work: NSFR MP2999/OPT 2 STORY 11 RMS**

**CONSTRUCTION LENDING AGENCY:** I hereby affirm under penalty of perjury that there is a construction lending agency for the performance of the work for which this permit is issued (Sec. 3097, Civ. C.)

Lender's Name \_\_\_\_\_ Lender's Address \_\_\_\_\_

**LICENSED CONTRACTORS DECLARATION:** I hereby affirm under penalty of perjury that I am licensed under provisions of Chapter 9 (commencing with section 7000) of Division 3 of the Business and Professions Code and my license is in full force and effect.

License Class B License Number 67517 Date 5/9/01 Contractor Signature D. Collins

**OWNER-BUILDER DECLARATION:** I hereby affirm under penalty of perjury that I am exempt from the contractors License Law for the following reason (Sec. 7031.5, Business and Professions Code, any city or county which requires a permit to construct, alter, improve, demolish, or repair any structure, prior to its issuance, also requires the applicant for such permit to file a signed statement that he or she is licensed pursuant to the provisions of the Contractors License Law (Chapter 9 (commencing with Section 7000) of Division 8 of the Business and Professions Code) or that he or she is exempt therefrom and the basis for the alleged exemption. Any violation of Section 7031.5 by any applicant for a permit subjects the applicant to a civil penalty of not more than five hundred dollars (\$500.00).

I, as a owner of the property, or my employees with wages as their sole compensation, will do the work, and the structure is not intended or offered for sale (Sec. 7044, Business and Professional Code). The Contractors License Law does not apply to an owner of property who builds or improves thereon, and who does such work himself or herself or through his/her own employees, provided that such improvements are not intended or offered for sale. If, however, the building or improvement is sold within one year of completion, the owner-builder will have the burden of proving that he/she did not build or improve for the purpose of sale.

I, as owner of the property, am exclusively contracting with licensed contractor **PAID** to construct the project (Sec. 7044, Business and Professions Code). The Contractors License Law does not apply to an owner of property who builds or improves thereon, and who contracts for such projects with a contractor(s) licensed pursuant to the Contractors License Law.

I am exempt under Sec. \_\_\_\_\_ B & PC for this reason WAIVER 2001

Date \_\_\_\_\_ Owner Signature \_\_\_\_\_

**IN ISSUING THIS BUILDING PERMIT,** the applicant represents and the city relies on the representation of the applicant, that the applicant verified all measurements and locations shown on the application or accompanying drawings and that the improvement to be constructed does not violate any law or private agreement relating to permissible or prohibited locations for such improvements. This building permit does not authorize any illegal location of any improvement or the violation of any private agreement relating to location of improvements.

I certify that I have read this application and state that all information is correct. I agree to comply with all city and county ordinances and state laws relating to building construction and hereby authorize representative(s) of this city to enter upon the abovementioned property for inspection purposes.

Date 5/9/01 Applicant Agent Signature D. Collins

**WORKER'S COMPENSATION DECLARATION:** I hereby affirm under penalty of perjury one of the following declarations:

I have and will maintain a certificate of consent to self-insure for workers' compensation as provided for by Section 3700 of the Labor Code, for the performance of work for which the permit is issued.

I have and will maintain workers' compensation insurance, as required by Section 3700 of the Labor Code, for the performance of the work for which this permit is issued. My workers' compensation insurance carrier and policy number are:

Carrier EAGLE INS. CO. Policy Number 4S-0000273 Exp Date 03/19/2001

(This section need not be completed if the permit is for \$100 or less) I certify that in the performance of the work for which this permit is issued, I shall not employ any person in any manner so as to become subject to the workers' compensation laws of California and agree that if I should become subject to the workers' compensation provisions of Section 3700 of the Labor Code, I shall forthwith comply with those provisions.

Date 5/9/01 Applicant Signature D. Collins

**WARNING: FAILURE TO SECURE WORKER'S COMPENSATION COVERAGE IS UNLAWFUL AND SHALL SUBJECT AN EMPLOYER TO CRIMINAL PENALTIES AND CIVIL FINES UP TO ONE HUNDRED THOUSAND DOLLARS (\$100,000) IN ADDITION TO THE COST OF COMPENSATION, DAMAGES AS PROVIDED FOR IN SECTION 3706 OF THE LABOR CODE, INTEREST AND ATTORNEY'S FEE.**

**THIS PERMIT SHALL EXPIRE BY LIMITATION IF WORK IS NOT COMMENCED WITHIN 180 DAYS.**

ADDITIONAL SUBDIVISION BUILDING PERMIT APPLICATION

Project Address: 140 Menard Circle  
Lot Number: 31

Assessor Parcel # 225-1280-042  
Subdivision Northpointe Park Unit #13 Ph2

OWNER INFORMATION:

Legal Property Owner: Western Pacific Housing Phone# (925) 634-6023  
Owner Address: 1210 Central Boulevard, City Brentwood, State Ca. Zip 94513

CONTRACTOR INFORMATION:

Contractor: Western Pacific Lic# 675709/B Phone # (925) 634-6023 Fax 634-6166

PROJECT INFORMATION:

Land Use Zone RIA Occupancy Group R3 Construction Type VN Fed Code IA

No. of Stories: 2 No. of Rooms: \_\_\_\_\_ Street Width: \_\_\_\_\_

1<sup>st</sup> Floor Area \_\_\_\_\_ 2<sup>nd</sup> Floor Area \_\_\_\_\_ Basement \_\_\_\_\_ Roof Material \_\_\_\_\_

AREA IN SQUARE FOOT OF:

Dwelling/Living 3389

Garage/Storage 694

Decks/Balconies 136

Carports \_\_\_\_\_

SCOPE OF WORK: \_\_\_\_\_

- Information Above Complete
- Violation Files Checked
- Standard Setbacks
- County Sewer
- AR Flood Waiver Required
- Flood Elevation Certificate Required
- Water Development Infill Area
- Planning Approval
- Design Review Approval
- Special Fee Districts Apply:

THE FOLLOWING MUST BE PROVIDED IN ORDER TO SUBMIT FOR PERMIT

- 2 COMPLETE PLOT PLANS, LEGIBLE & DRAWN TO SCALE
- 11 X 17 COPY OF FLOOR PLAN WITH FOLLOWING INFORMATION
  - a) Assessor's Parcel Number
  - b) New Floor Area
  - c) Owners Name
  - d) Project Address

# KwikKote

No. 200-003391

## Stucco System Installation Card

Job Name: BELLAGIO  
Address: 140 MENARD CIR.  
SACRAMENTO, CA  
Lot #: 0003031

Stucco System Trade Name: KWIK KOTE  
Stucco System Manufacturer: KWIK KOTE CORP.

ICBO Evaluation Service, Inc.  
Report No. 3607  
Date of Job Completion:

Home Builder: WESTERN PACIFIC  
Address: 1210 CENTRAL BLVD. WEST #200  
BRENTWOOD, CA

Stucco Contractor: KENYON PLASTERING, INC.  
Address: PO BOX 2077  
North Highlands, CA

Telephone Number: 916/349-8191

Approved Contractor Number as  
issued by the Stucco Manufacturer: 1001

Card Print Date: 09/25/2001

This is to certify that the stucco system on the building exterior at the above address had been installed in accordance with the evaluation report specified above and the manufacturer's instructions.

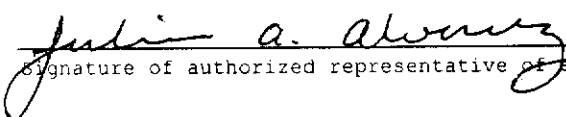
  
Signature of authorized representative of stucco contractor

10-1-01  
Date

# CERTIFICATION OF INSULATION

|   |  |
|---|--|
| ADDRESS OR TRACT<br><b>WESTERN PACIFIC</b> LOT # <b>3031</b><br><br><b>BELLAGIO</b> | SACRAMENTO INSULATION CONTRACTORS<br><input checked="" type="checkbox"/> P.O. BOX 864, WEST SACRAMENTO, CA 95661 LIC. #202026<br><input type="checkbox"/> 1309 MELODY ROAD, MARYSVILLE, CA 95901 LIC. #202026<br><input type="checkbox"/> P.O. BOX 9651, FRESNO, CA 93793-9651 LIC. #202026<br><input type="checkbox"/> P.O. BOX 1831, RENO, NV 89505 LIC. #10675<br><input type="checkbox"/> 3326 A PONDEROSA WAY, LAS VEGAS, NV 89119 LIC. #10675<br><br>DATE INSULATION COMPLETED<br><span style="font-size: 1.5em;">10-9-01</span> |
|---|--|

| WALLS                         |                   | CEILING                         |                         |                                       | FLOORS                        |                   |
|-------------------------------|-------------------|---------------------------------|-------------------------|---------------------------------------|-------------------------------|-------------------|
| SQUARE FEET)                  |                   | SQUARE FEET)                    |                         |                                       | SQUARE FEET)                  |                   |
| TYPE OF INSULATION            |                   | TYPE OF INSULATION              |                         |                                       | TYPE OF INSULATION            |                   |
| MATERIAL<br><b>FIBERGLASS</b> |                   | MATERIAL<br><b>FIBERGLASS</b>   |                         |                                       | MATERIAL<br><b>FIBERGLASS</b> |                   |
| FORM<br><b>BATTS</b>          |                   | FORM<br><b>BATTS &amp; BLOW</b> |                         |                                       | FORM<br><b>BATTS</b>          |                   |
| MANUFACTURER'S PRODUCT I.D.   |                   | MANUFACTURER'S PRODUCT I.D.     |                         |                                       | MANUFACTURER'S PRODUCT I.D.   |                   |
| MANUFACTURER                  |                   | MANUFACTURER                    |                         |                                       | MANUFACTURER                  |                   |
| <b>OCF</b>                    |                   | <b>OCF</b>                      |                         |                                       | <b>OCF</b>                    |                   |
|                               |                   | BAGS                            |                         |                                       |                               |                   |
| R-VALUE INSTALLED             | APPLIED THICKNESS | R-VALUE INSTALLED               | APPLIED THICKNESS       | MIN. INSTALLED WEIGHT PER SQUARE FOOT | R-VALUE INSTALLED             | APPLIED THICKNESS |
| <b>13</b>                     | <b>3 1/4"</b>     | <b>30</b><br><b>30</b>          | <b>9"</b><br><b>12"</b> |                                       |                               |                   |

KNEE WALLS IF R-VALUE IS OTHER THAN WALLS ABOVE

|                               |                      |                                  |                            |
|-------------------------------|----------------------|----------------------------------|----------------------------|
| MATERIAL<br><b>FIBERGLASS</b> | FORM<br><b>BATTS</b> | R-VALUE                          | MANUFACTURER<br><b>OCF</b> |
| AIR INFILTRATION SEALANT      |                      |                                  |                            |
| MATERIAL<br><b>FOAM</b>       |                      | MANUFACTURER<br><b>W R GRACE</b> |                            |

**THIS IS TO CERTIFY THAT INSULATION AND/OR SEALANT HAS BEEN INSTALLED IN CONFORMANCE WITH APPLICABLE CODES, MATERIAL STANDARDS AND REGULATIONS.**

|  |                         |                         |
|--|-------------------------|-------------------------|
| SIGNATURE - INSULATION CONTRACTOR<br><i>Jeff Cable</i> | TITLE<br><b>MANAGER</b> | DATE<br><b>11-15-01</b> |
| SIGNATURE - GENERAL CONTRACTOR                         | TITLE                   | DATE                    |

REMARKS



**JOB REPORT**

PROJECT NAME: Bellagio PAGE: 1  
 INSPECTOR: Marvin Pohl FILE NO. 5317  
 PERSONS CONTACTED: Kidney (B+B) DATE: 8-30-01  
 REFERENCE DOCUMENTS: ICBO Report #4945 PERMIT #: \_\_\_\_\_ WEATHER: Sunny  
 SERVICE PROVIDED: CONCRETE (INSP/SAMPLE ONLY/PU)  MASONRY  WELDING (SHOP/FIELD)  SOILS   
 OTHER  proof load Epoxy Anchors

Lot # 31 proof loaded two 5/8" Epoxy Anchors to 6015lbs per ICBO with NO movement

Lot # 52 proof loaded one 7/8" Epoxy Anchor to 12400 lbs per ICBO with no movement

Lot # 53 proof loaded one 5/8" Epoxy Anchor to 6015lbs per ICBO without movement

COMPLIANCE OF WORK: Acceptable

ATTACHMENTS: \_\_\_\_\_

EQUIPMENT/SUPPLIES USED: Hydraulic

NEXT VISIT: \_\_\_\_\_

REMARKS: \_\_\_\_\_

REVIEWED BY: \_\_\_\_\_ DATE: 8-30-01



CAPITOL ENGINEERING LABORATORIES, INC.

631 Commerce Drive, Suite #200 • Roseville, California 95678 • (916) 786-2488

JOB REPORT

PROJECT NAME: Bellagio PAGE: 1  
 INSPECTOR: Morgan Paul FILE NO. 5317  
 PERSONS CONTACTED: B & B DATE: 9-15-01  
 REFERENCE DOCUMENTS: ICBO Report # 4/9/5 PERMIT #: \_\_\_\_\_  
 WEATHER: Sunny  
 SERVICE PROVIDED: CONCRETE (INSP/SAMPLE ONLY/PU)  MASONRY  WELDING (SHOP/FIELD)  SOILS   
 OTHER  Proof load Epoxy Anchor

proof loaded All 7/8" Epoxy Anchors to 12400 lbs  
per ICBO without movement in lots # 31 4 - 7/8"  
# 34 1 - 7/8"

COMPLIANCE OF WORK: Acceptable

ATTACHMENTS: \_\_\_\_\_

EQUIPMENT/SUPPLIES USED: Hydraulics

NEXT VISIT: \_\_\_\_\_

REMARKS: \_\_\_\_\_  
 REVIEWED BY: [Signature] DATE: 9-12-01

LEGEND

→ SWALE  
□ MAILBOX

\* WOOD FENCE  
○ SIDEYARD GATE

SS SEWER SERVICE  
WS WATER SERVICE

□ UTILITY SERVICE  
F.F. FINISH FLOOR

LOT 31  
PLAN 290BR-C  
A.P.N.: 225-1280-042  
ADDRESS: 140 MENARD CIRCLE  
LOT AREA: 8,672 SF

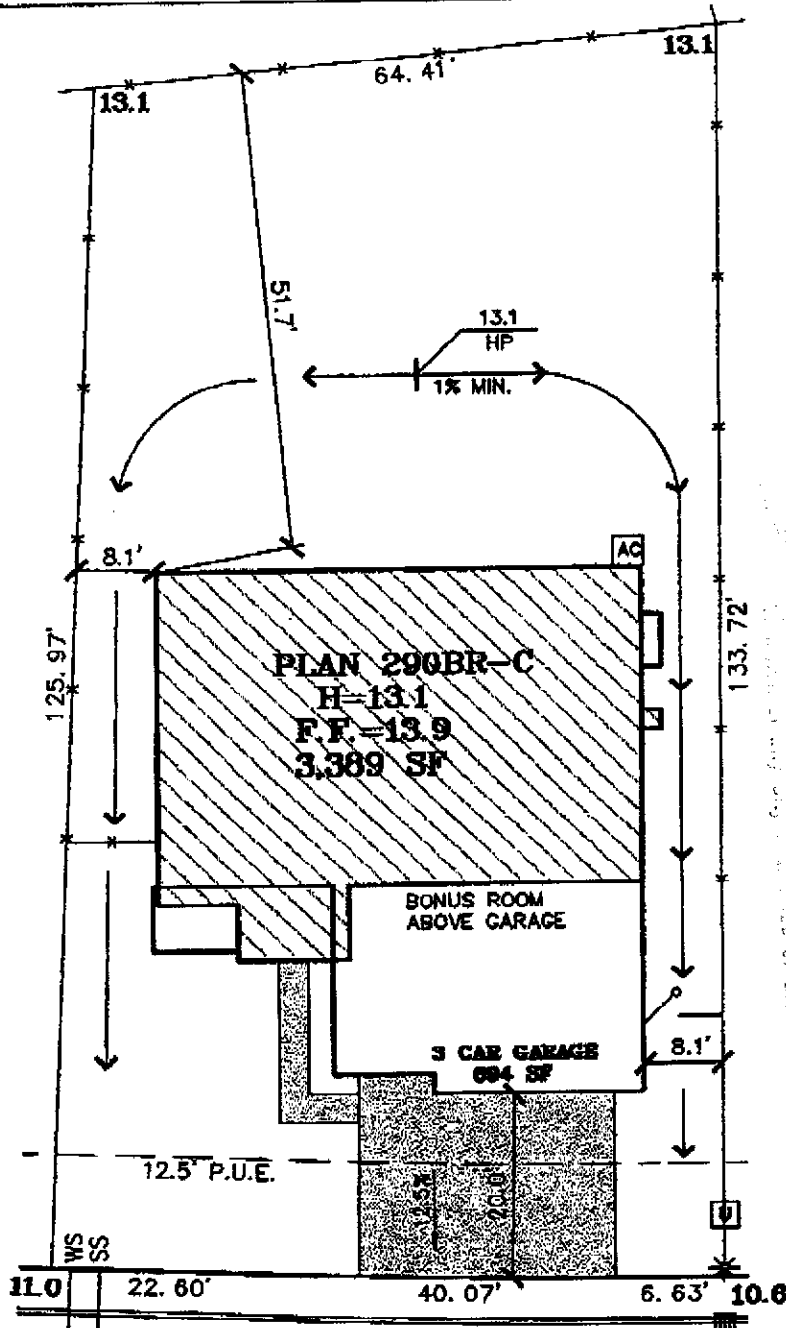

MENARD CIRCLE

BEFORE THE UNIQUE CONDITIONS OF THIS LOT, THE BUYER SHALL BE ADVISED AND APPROVED THE SITE. FINAL GRADING CONDITIONS MAY VARY. THE INFORMATION ON THIS PLOT PLAN IS PROVIDED FOR YOUR CONVENIENCE AS A GUIDE TO THE GENERAL LOCATION OF THE SUBJECT PROPERTY. THE ACCURACY OF THIS PLOT PLAN IS NOT GUARANTEED. IF IT IS A PART OF ANY POLICY, REPORT OR GUARANTEE TO WHICH IT MAY BE ATTACHED, ACTUAL DIMENSIONS MAY VARY OR CHANGE WITHOUT PRIOR NOTICE DUE TO UNUSUAL SITE CONDITIONS.

PLAN: 290br  
ELEVATION: C  
ORIENTATION: R  
COLOR: 120

SIGNED (BUYER) \_\_\_\_\_ DATE \_\_\_\_\_

**the Splink Corporation**

590 VENTURE OAKS WAY  
ACRAMENTO, CA 95833

TEL: (916) 925-6660 FAX: (916) 921-9274



Western Pacific Housing

1210 Central Boulevard  
Brentwood, CA 94513  
office: (925) 634-6023  
fax: (925) 634-6063

**BELLAGIO**  
NORTHPOINTE PARK VILLAGE 13 PHASE 2  
City of Sacramento, California

Scale: 1"=20'

February 27, 2001