

860 Arden
 0500255
 0501025

REVISED
 1/27/05

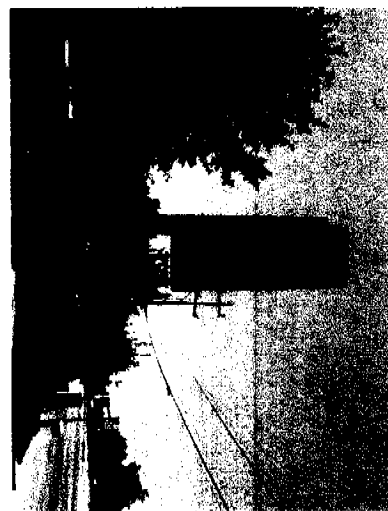

EXISTING D/F PRICE ID SIGN

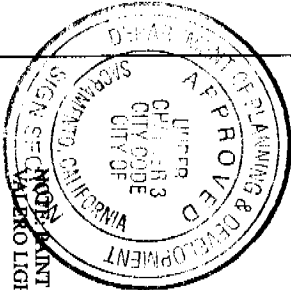

This set of plans and specifications must be kept on the job at all times and it is understood that any changes or alterations from the same without written permission from the City of Sacramento Sign Section.
 The approval of this plan and specification is given on the condition that the applicant shall maintain and preserve the VALERO LIGHT CRACK of any City Ordinance or State Law.

EQUIPMENT MUST BE USED AS DESIGN INTENDED

ALL SIGN INSTALLATIONS ARE SUBJECT TO FIELD INSPECTION. REPLACE EXISTING D/F PRICE ID SIGN - See Detail PID-1

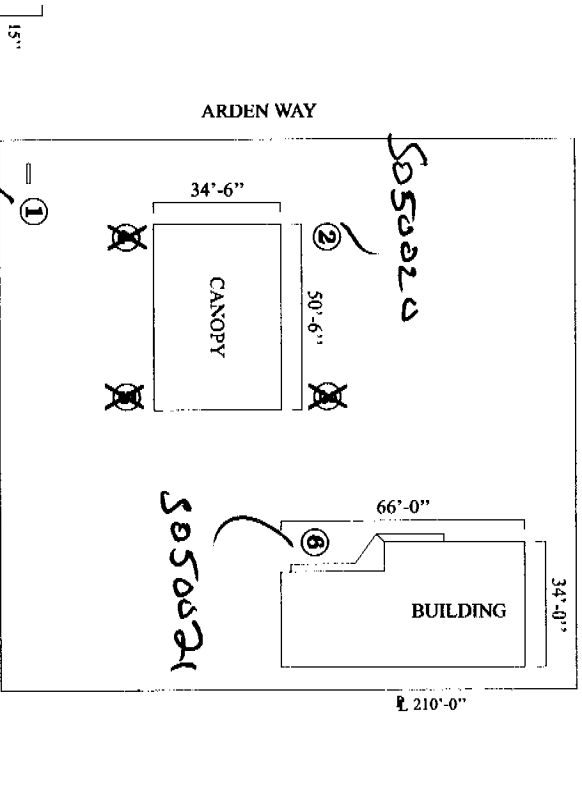
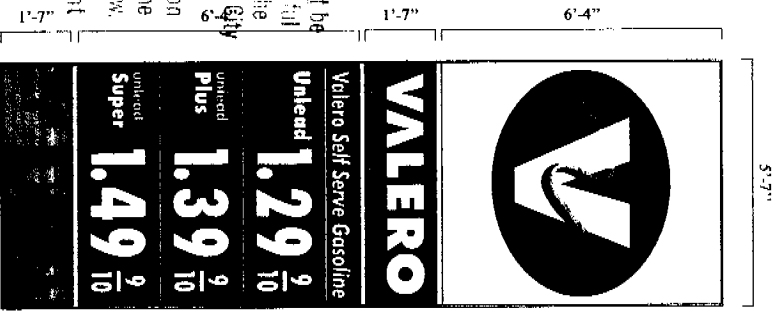

VALERO
 860 Arden Way
 Sacramento, CA

Sign Development Inc.
 860 Arden Way
 Sacramento, CA

Upland, CA 91786 (909) 920-5535
 No. 95090 Rev. 01.24.05SP
 Date: 08.05.04

CITY COPY

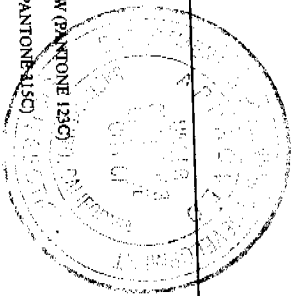

This set of plans and specifications must be
 kept in the file of all other plans for this
 project. The City of Sacramento, California
 to make any change in the plans, the City
 engineer will be notified by the City
 of Sacramento, California.
 The approval of the City Engineer
 shall not be held responsible for
 violation of any City Ordinance.

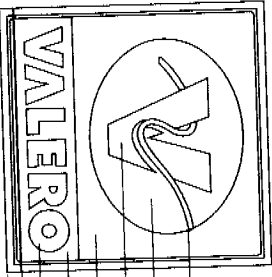

VALERO YELLOW (PANTONE 124C)
 VALERO TEAL (PANTONE 415C)
 WHITE #7328
 WHITE #7328
 VALERO TEAL (PANTONE 318C)
 WHITE #7328
 VALERO YELLOW (PANTONE 124C)

All colors must be U.L. listed and approved
 by the City of Sacramento, California
 Div. 2 of Sacramento City Code
 EQUIVALENT PARTS ARE PERMITTED

ALL SIGN INSTALLATIONS ARE SUBJECT TO

Valero Self Serve Gasoline	1.29 9/10
Unleaded	1.39 9/10
Plus	1.49 9/10
Super	1.49 9/10

CHANGEABLE NUMERALS:
 WHITE COPY
 VALERO TEAL BACKGROUND

NOTE:
 DIESEL PRICE PODS - VALERO
 YELLOW BACKGROUND AND
 CHANGEABLE VALERO TEAL
 NUMERALS

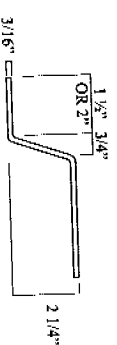
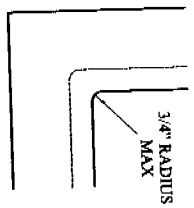

MOLDED FACE CORNER SECTION

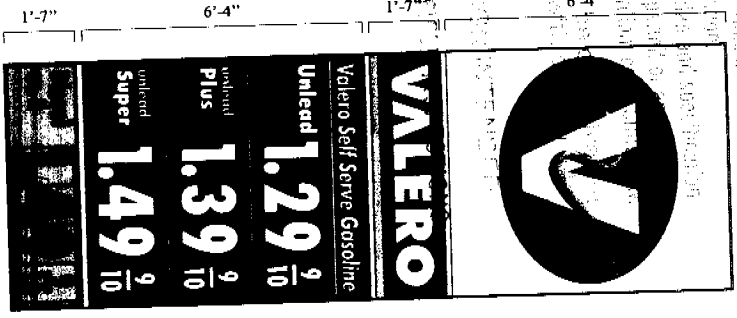

SCALE: 3/8" = 1'-0"

REFACE/REPAINT EXISTING CABINET:
 CABINET CONSTRUCTION: ALUMINUM
 ILLUMINATION/ELECTRICAL: STANDARD FLUORESCENT COOL WHITE HIGH OUTPUT
 INTERNAL ILLUMINATION, INTERNAL MAGNETEK BALLASTS (OR EQUAL), UL LABEL
 AND VISIBLE DISCONNECT SWITCH ALL ELECTRICAL COMPONENTS TO BE UL LISTED
 AND APPROVED
 FACE MATERIALS: MOLDED HIGH IMPACT CLEAR ACRYLIC FACES
 WITH TRANSLUCENT 3M VINYL SECOND SURFACE DECORATION
 FINISH SPECIFICATIONS: SHERWIN WILLIAMS PAINTED, RETAINERS,
 DIVIDER BARS, POLE AND BASE TO MATCH ICI # 1363 LIGHT GRAY
 GENERAL NOTE: ALL SIGNAGE TO BE MANUFACTURED AND INSTALLED ACCORDING TO
 LOCAL AND NATIONAL BUILDING AND ELECTRICAL CODES

PID-1

VALERO	
Price/ID Sign	
Sign Development Inc.	
Upland, CA 91786 (909) 920-5535	
No. _____	Rev: 11.22.02
Date: 08.07.02	02.05.03

REVISION
1/22/05



EXISTING EAST CANOPY ELEVATION

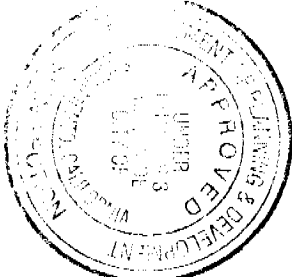

This set of plans and specifications must be kept on the job at all times and it is unlawful to make any changes or alterations from the same without written permission from the City of Sacramento Sign Section.
The approval of this plan and specification SHALL NOT be held to permit or approve the violation of any City Ordinance or State Law.

ALL SIGN INSTALLATIONS ARE SUBJECT TO FIELD INSPECTIONS
EQUIPMENT MUST BE USED AS DESIGN INTENDED

Sign Development Inc.

Upland, CA 91786 (909) 920-5535

3 OF 6

No. 95090 Rev: 01.24.05SP
Date: 08.05.04

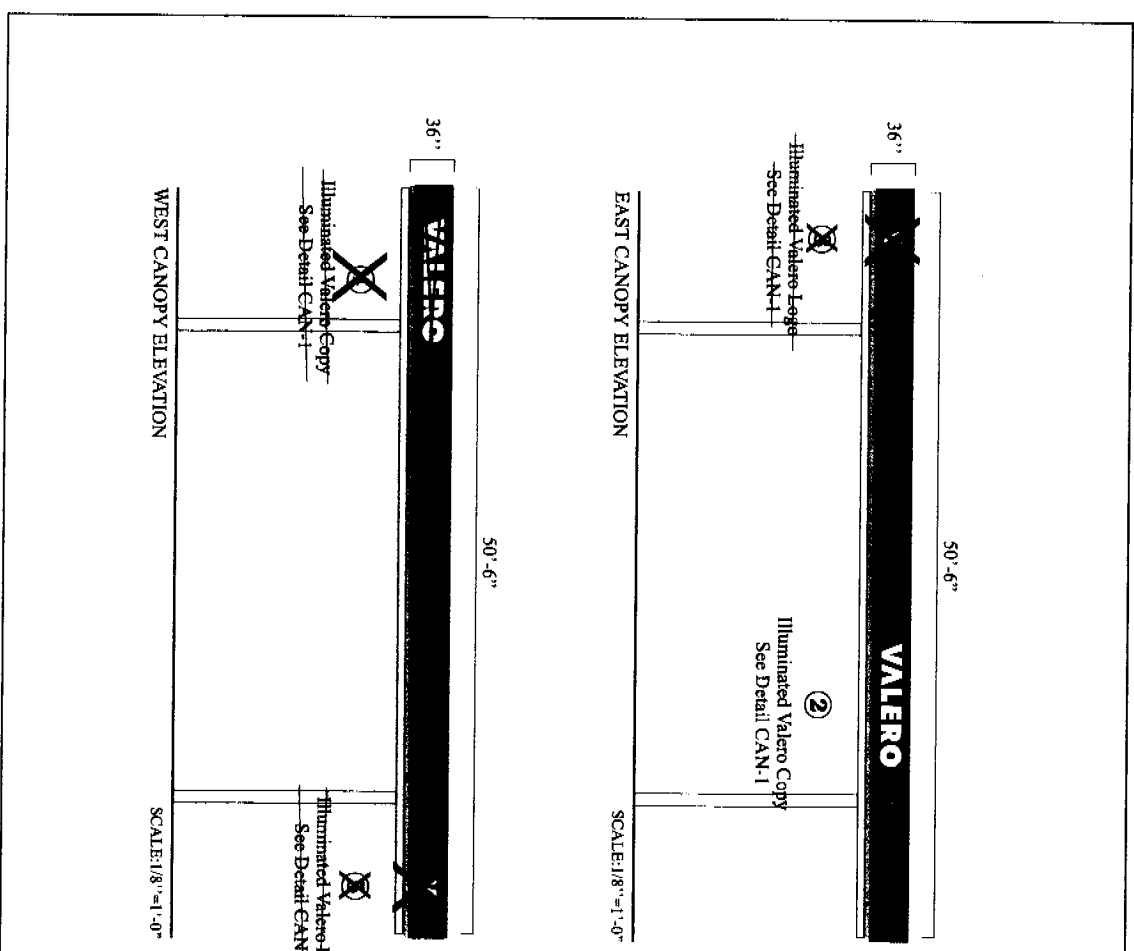

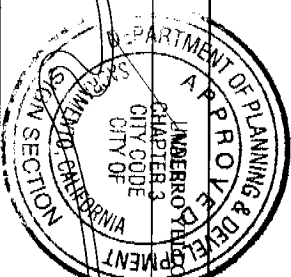

This set of plans and specifications must be prepared by the applicant and is unlawful to make any changes or alterations from the same without written permission from the City of Sacramento Sign Section. The approval of this plan and specifications SHALL NOT be held to permit or approve the violation of any City Ordinance or State Law.

WHITE
VALERO TEAL (PANTONE 315C)
VALERO

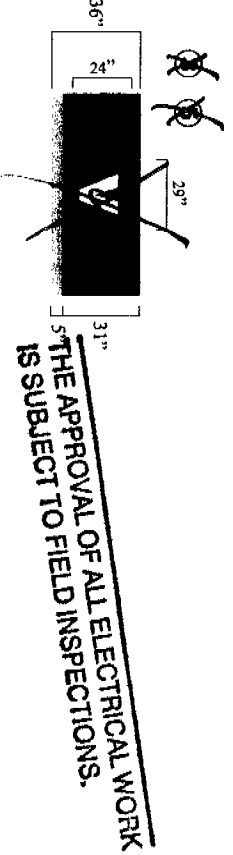
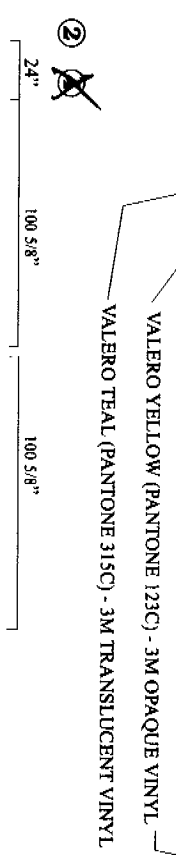
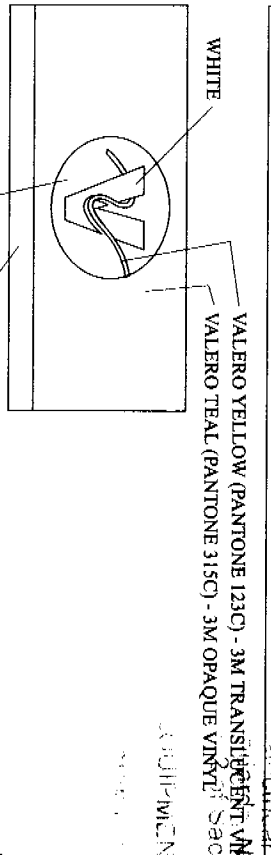

THE APPROVAL OF ALL ELECTRICAL WORK IS SUBJECT TO FIELD INSPECTIONS.

ALL DIMENSIONS MUST BE USED AS DESIGN INTENDED

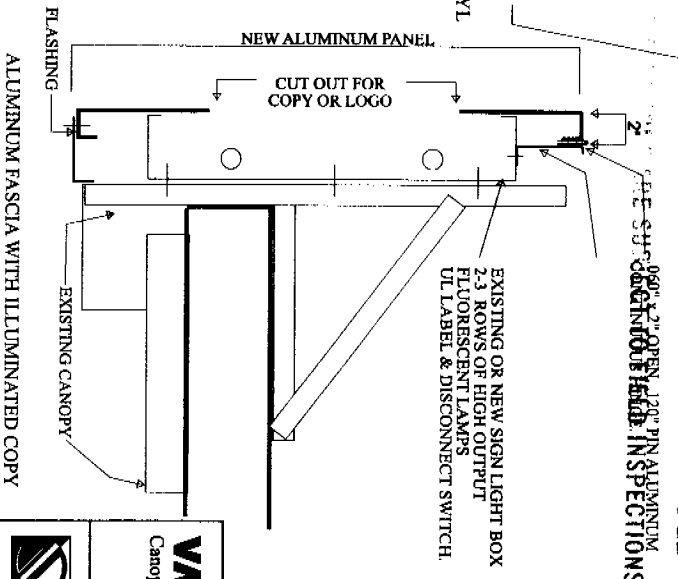

CAN-1

VALERO Canopy Signs	
 Sign Development Inc.	
Upland, CA 91786 (909) 920-5535	
No. _____	Rev. _____
Date: 08.07.02	

EQ. 15" EQ. 45" EQ.



PARTIAL RIGHT BUILDING FASCIA ELEVATION
 INSTALL ONE (1) SET OF 15" High "Food Shop" CHANNEL LETTERS
 See Details - BLDG-1
 SCALE: 1/4" = 1'-0"



SOUTHWEST BUILDING ELEVATION

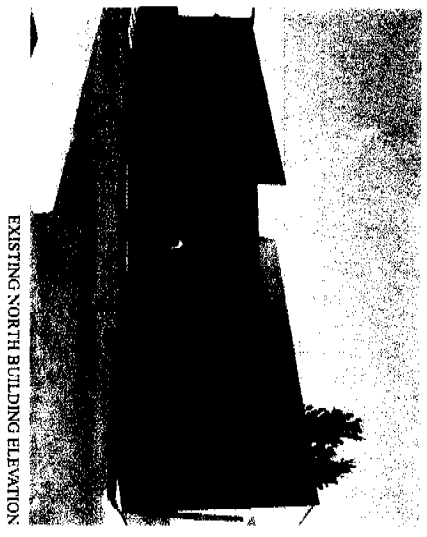

EXISTING NORTH BUILDING ELEVATION

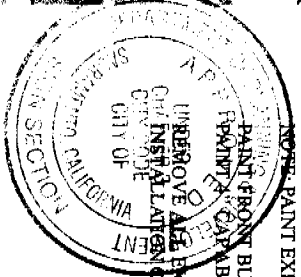

PAINT FRONT BUILDING FASCIA VALERO LIGHT GRAY

REMOVE ALL EXISTING REFRIGERATORS FROM THE SOUTH SIDE OF VALERO AND WRITE permission from the City of Sacramento Sign Section.
 The approval of this plan and specification SHALL NOT be held to permit or approve the violation of any City Law.
VALERO
 800 Arden Way
 Sacramento, CA 95834

ALL SIGN INSTALLATIONS ARE SUBJECT TO FIELD INSPECTIONS
 EQUIPMENT MUST BE USED AS DIRECTED
 SIGNED Development Inc.

No. 95090 Rev. 01.24.05SP
 Upland, CA 91786 (909) 920-5535
 Date: 08.05.04

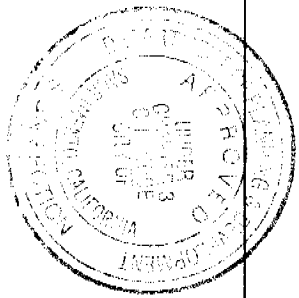

This set of plans and specifications must be kept on the job at all times and it is anticipated to make any changes or additions must be made without written permission from the City of Sacramento Sign Section.

The approval of this plan and specification SHALL NOT be held to grant or approve the violation of any City Ordinance or State Law.

All electrical work must be U.L. labeled or up of capacity and equipment must be used as design intended.

ALL SIGN INSTALLATIONS ARE SUBJECT TO FIELD INSPECTIONS

118"

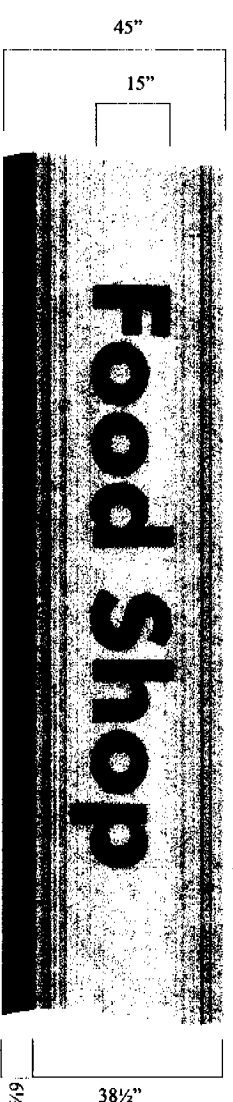

SCALE: 1/2" = 1'-0"

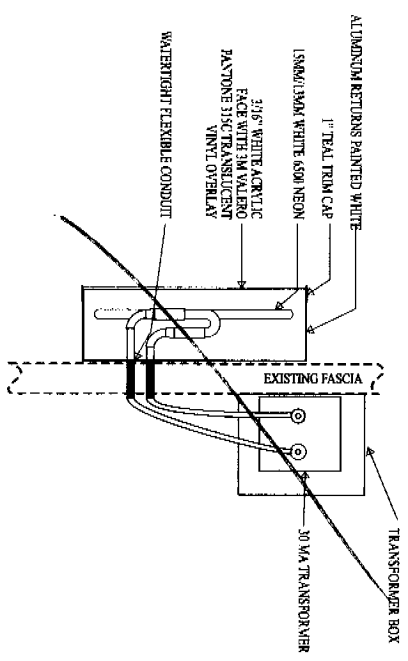

NEW ILLUMINATED CHANNEL LETTER
SOS
DL

NOTES:
New 15" Food/Snack Shop channel letters
Valero Pantone 123C yellow background
Valero Pantone Teal underscore

VALERO	
Building Sign	
 Sign Development Inc.	
Upland, CA 91786 (909) 920-5635	
No. _____	Rev: _____
BLDG-1	
Date: 09.23.02	

THE APPROVAL OF ALL ELECTRICAL WORK IS SUBJECT TO FIELD INSPECTIONS.

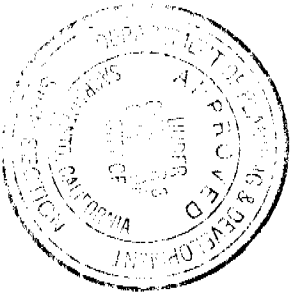

This set of plans and specifications shall be used as design intended. All electrical work must be in accordance with the California Electrical Code, Title 24, Part 9, and the City Code of Ordinances, Chapter 21.2, or Sacramento City Code.

ALL SIGN INSTALLATIONS ARE SUBJECT TO FIELD INSPECTIONS

BUILDING CHANNEL LETTER DETAILS

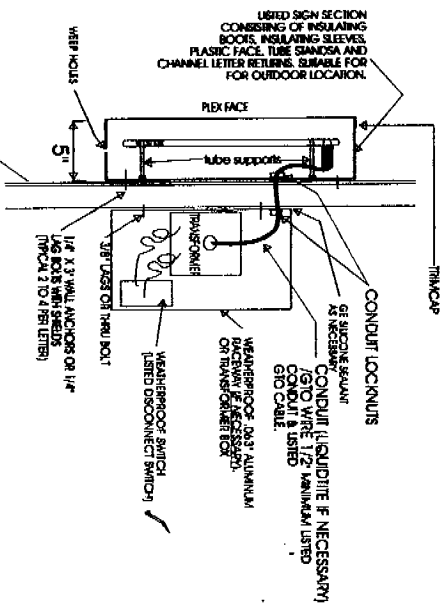

SUPPLEMENT

 <p>VALERO 860 Arden Way Sacramento, CA</p>	
<p>Upland, CA 91786 (909) 920-6635</p>	
No. 93090	Rev:
Date: 08.05.04	
<p>Sign Development Inc.</p>	

860 ARDEN WAY

VOID

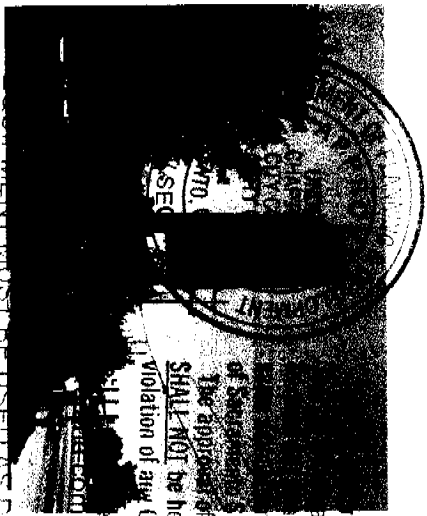

ALL SIGN INSTALLATIONS ARE SUBJECT TO FIELD INSPECTION

NOTE: PAINT EXISTING CABINET AND STRUCTURE VALERO LIGHT GRAY

VALERO
Valero Self Serve Gasoline
Unleaded 1.29 $\frac{9}{10}$
Plus 1.39 $\frac{9}{10}$
Super 1.49 $\frac{9}{10}$

REFACE EXISTING D/F PRICE ID SIGN - See Detail PID-1

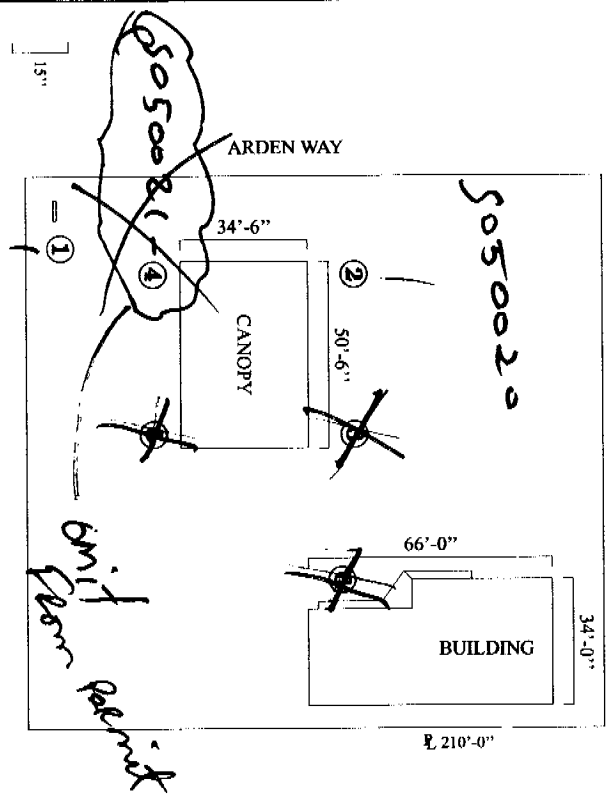

VALERO
860 Arden Way
Sacramento, CA

Sign Development Inc.
Upland, CA 91786 (909) 920-5535
No. 95090 Rev: _____
Date: 08.05.04

CITY COPY

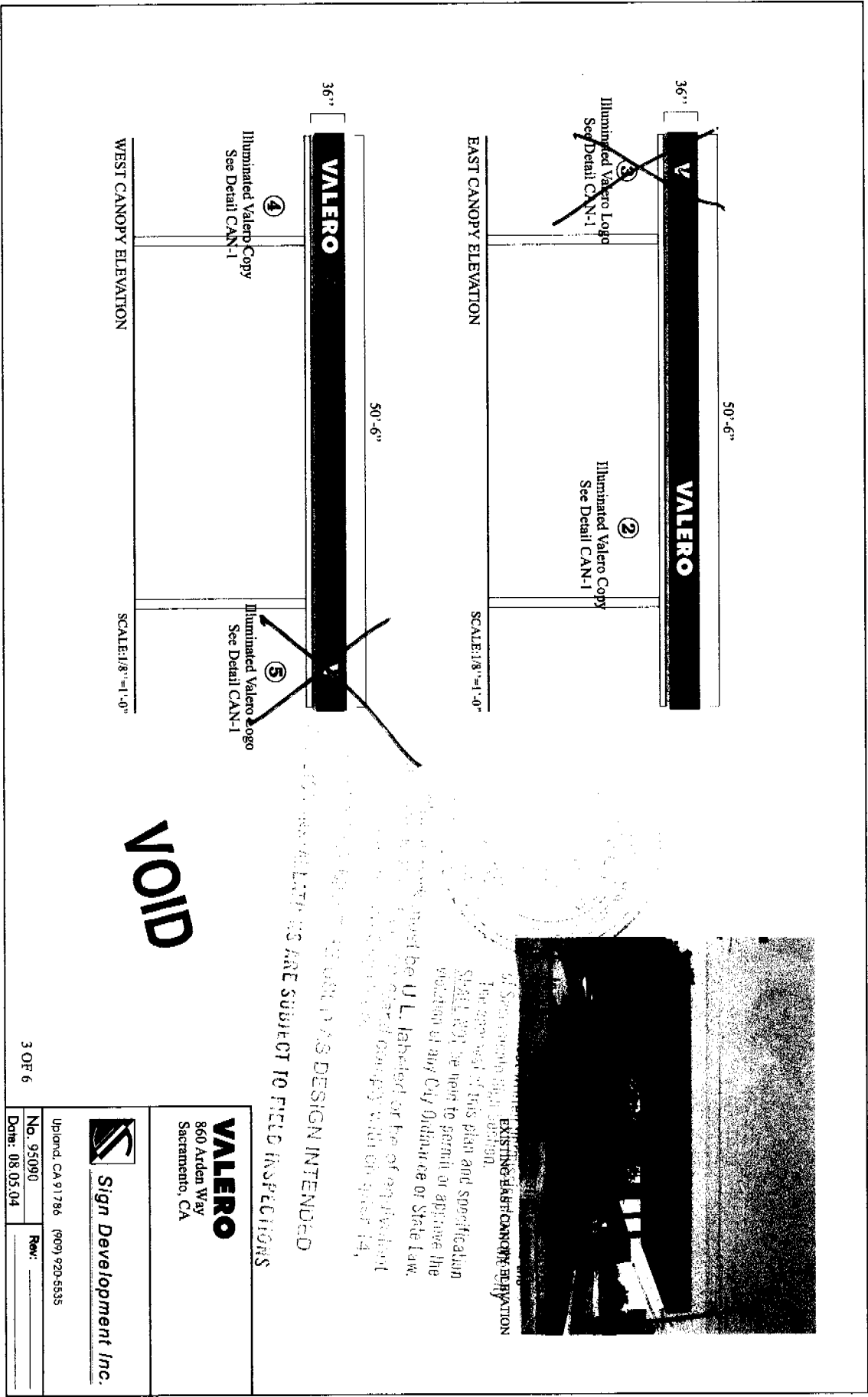

EXISTING EAST CANOPY ELEVATION

ALL MATERIALS AND SUBJECT TO FIELD INSPECTIONS
 DESIGN INTENDED
 ALL MATERIALS MUST BE U.L. LABELED OR PER OF APPROVED
 ALL MATERIALS MUST BE U.L. LABELED OR PER OF APPROVED
 ALL MATERIALS MUST BE U.L. LABELED OR PER OF APPROVED

VOID

 <p>VALERO 860 Arden Way Sacramento, CA</p>	<p>Sign Development Inc.</p>
	<p>Upland, CA 91786 (909) 920-5535 No. 95090 Rev. Date: 08.05.04</p>