

CITY OF SACRAMENTO

Permit No: 9811972

1231 I Street, Sacramento, CA 95814

Insp Area: 4

Site Address: 2400 WHEELHOUSE AV SAC

Sub-Type: NSFR

Parcel No: 2740480005

LOT 5/RIVERSGATE

Housing (Y/N): N

CONTRACTOR

WARMINGTON HOMES
8265 SIERRA COLLEGE BL #312
ROSEVILLE CA 95661

OWNER

WARMINGTON HOMES

ARCHITECT

HEZMALHLACH WILLIAM ARCH INC
17875 VON KARMAN AV #404
IRVINE CA 92614

Nature of Work: NEW HOME MP2559, 8 ROOMS

CONSTRUCTION LENDING AGENCY : I hereby affirm under penalty of perjury that there is a construction lending agency for the performance of the work for which this permit is issued (Sec. 3097, Civ. C).

Lender's Name _____

Lender's Address _____

LICENSED CONTRACTORS DECLARATION: I hereby affirm under penalty of perjury that I am licensed under provisions of Chapter 9 (commencing with section 7000) of Division 3 of the Business and Professions Code and my license is in full force and effect.

License Class B License Number 746231 Date 12-17-98 Contractor Signature _____

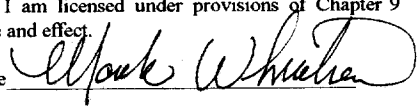

OWNER-BUILDER DECLARATION: I hereby affirm under penalty of perjury that I am exempt from the contractors License Law for the following reason (Sec. 7031.5, Business and Professions Code; any city or county which requires a permit to construct, alter, improve, demolish, or repair any structure, prior to its issuance, also requires the applicant for such permit to file a signed statement that he or she is licensed pursuant to the provisions of the Contractors License Law (Chapter 9 (commencing with Section 7000) of Division 8 of the Business and Professions Code) or that he or she is exempt therefrom and the basis for the alleged exemption. Any violation of Section 7031.5 by any applicant for a permit subjects the applicant to a civil penalty of not more than five hundred dollars (\$500.00);

____ I, as a owner of the property, or my employees with wages as their sole compensation, will do the work, and the structure is not intended or offered for sale (Sec. 7044, Business and Professional Code: The Contractors License Law does not apply to an owner of property who builds or improves thereon, and who does such work himself or herself or through his/her own employees, provided that such improvements are not intended or offered for sale. If, however, the building or improvement is sold within one year of completion, the owner-builder will have the burden of proving that he/she did not build or improve for the purpose of sale.)

____ I, as owner of the property, am exclusively contracting with licensed contractors to construct the project (Sec. 7044, Business and Professions Code: The Contractors License Law does not apply to an owner of property who builds or improves thereon, and who contracts for such projects with a contractor(s) licensed pursuant to the Contractors License Law).

____ I am exempt under Sec. _____ B & PC for this reason: _____

Date _____

Owner Signature _____

IN ISSUING THIS BUILDING PERMIT, the applicant represents, and the city relies on the representation of the applicant, that the applicant verified all measurements and locations shown on the application or accompanying drawings and that the improvement to be constructed does not violate any law or private agreement relating to permissible or prohibited locations for such improvements. This building permit does not authorize any illegal location of any improvement or the violation of any private agreement relating to location of improvements.

I certify that I have read this application and state that all information is correct. I agree to comply with all city and county ordinances and state laws relating to building construction and hereby authorize representative(s) of this city to enter upon the abovementioned property for inspection purposes.

Date 12-17-98

Applicant/Agent Signature _____

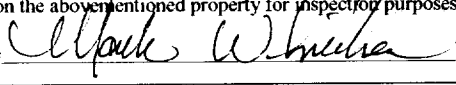

WORKER'S COMPENSATION DECLARATION: I hereby affirm under penalty of perjury one of the following declarations:

____ I have and will maintain a certificate of consent to self-insure for workers' compensation as provided for by Section 3700 of the Labor Code, for the performance of work for which the permit is issued.

____ I have and will maintain workers' compensation insurance, as required by Section 3700 of the Labor Code, for the performance of the work for which this permit is issued. My workers' compensation insurance carrier and policy number are:

Carrier REPUBLIC INDEM CO OF AMERICA Policy Number 00779320 Exp Date 07/01/1999

____ (This section need not be completed if the permit is for \$100 or less) I certify that in the performance of the work for which this permit is issued, I shall not employ any person in any manner so as to become subject to the workers' compensation laws of California and agree that if I should become subject to the workers' compensation provisions of Section 3700 of the Labor Code, I shall forthwith comply with those provisions.

Date 12-17-98

Applicant Signature _____

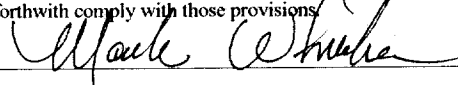

WARNING: FAILURE TO SECURE WORKER'S COMPENSATION COVERAGE IS UNLAWFUL AND SHALL SUBJECT AN EMPLOYER TO CRIMINAL PENALTIES AND CIVIL FINES UP TO ONE HUNDRED THOUSAND DOLLARS (\$100,000) IN ADDITION TO THE COST OF COMPENSATION, DAMAGES AS PROVIDED FOR IN SECTION 3706 OF THE LABOR CODE, INTEREST AND ATTORNEY'S FEE.

THIS PERMIT SHALL EXPIRE BY LIMITATION IF WORK IS NOT COMMENCED WITHIN 180 DAYS.

NATOMAS UNIFIED SCHOOL DISTRICT

1515 Sports Drive, #1 • Sacramento, CA 95834

Phone 916/641-3300 • Fax 916/928-1629

CERTIFICATION OF COMPLIANCE

SCHOOL DISTRICT DEVELOPMENT FEES

PART I: TO BE COMPLETED BY APPLICANT			
PROPERTY OWNER'S NAME	WARMINGTON		
OWNER'S ADDRESS	5500 DOUGLAS BLVD ROSEVILLE		
PROJECT ADDRESS	2400 Warehouse Av		
PARCEL NUMBER	274-0480-005		
SUBDIVISION NAME	RIVERBEND		
NUMBER OF UNITS			
PRINT APPLICANT'S NAME	MARK WHITEHEAD	APPLICANT'S SIGNATURE:	<i>Mark Whitehead</i>
TITLE OF APPLICANT	SUPERINTENDENT		
DATE	12-16-98	TELEPHONE NUMBER	416-5350
PART II: TO BE COMPLETED BY BUILDING DEPARTMENT			
PLAN IDENTIFICATION NUMBER	9811972		
BUILDING TYPE (CHECK ONE)	<input checked="" type="checkbox"/> RESIDENTIAL <input type="checkbox"/> APARTMENT/CONDOMINIUM <input type="checkbox"/> COMMERCIAL/INDUSTRIAL		
SQUARE FEET OF CHARGEABLE BUILDING AREA	2559		
SIGNATURE	<i>Margaret Mollen</i>		
TITLE	Bldg. Tech	DATE	12-16-98
PART III: TO BE COMPLETED BY NATOMAS UNIFIED SCHOOL DISTRICT			
DISTRICT CERTIFICATION NUMBER	99-101		
FEES COLLECTED			
RESIDENTIAL	5529	Sq. Ft. X \$ 1.92	= \$ 10615.68
APARTMENT/CONDOMINIUM		Sq. Ft. X \$	= \$
COMMERCIAL/INDUSTRIAL		Sq. Ft. X \$	= \$

This certification covers only the amount of square footage indicated above. Any additions or corrections to the square footage for this project will require an amendment to the Certificate of Compliance.

As the authorized school district official, I hereby certify that the requirements of Government Code Section 65995 have been complied with by the above signed applicant.

AUTHORIZED SCHOOL DISTRICT OFFICIAL:

SIGNATURE: *[Signature]*

TITLE: *[Title]* DATE: 12-16-98

THIS PLAN IS TO BE USED FOR THE PURPOSE OF A PERMIT TO CONSTRUCT ONLY. IT IS NOT TO BE USED FOR ANY OTHER PURPOSE.

SCALE: 1" = 20'

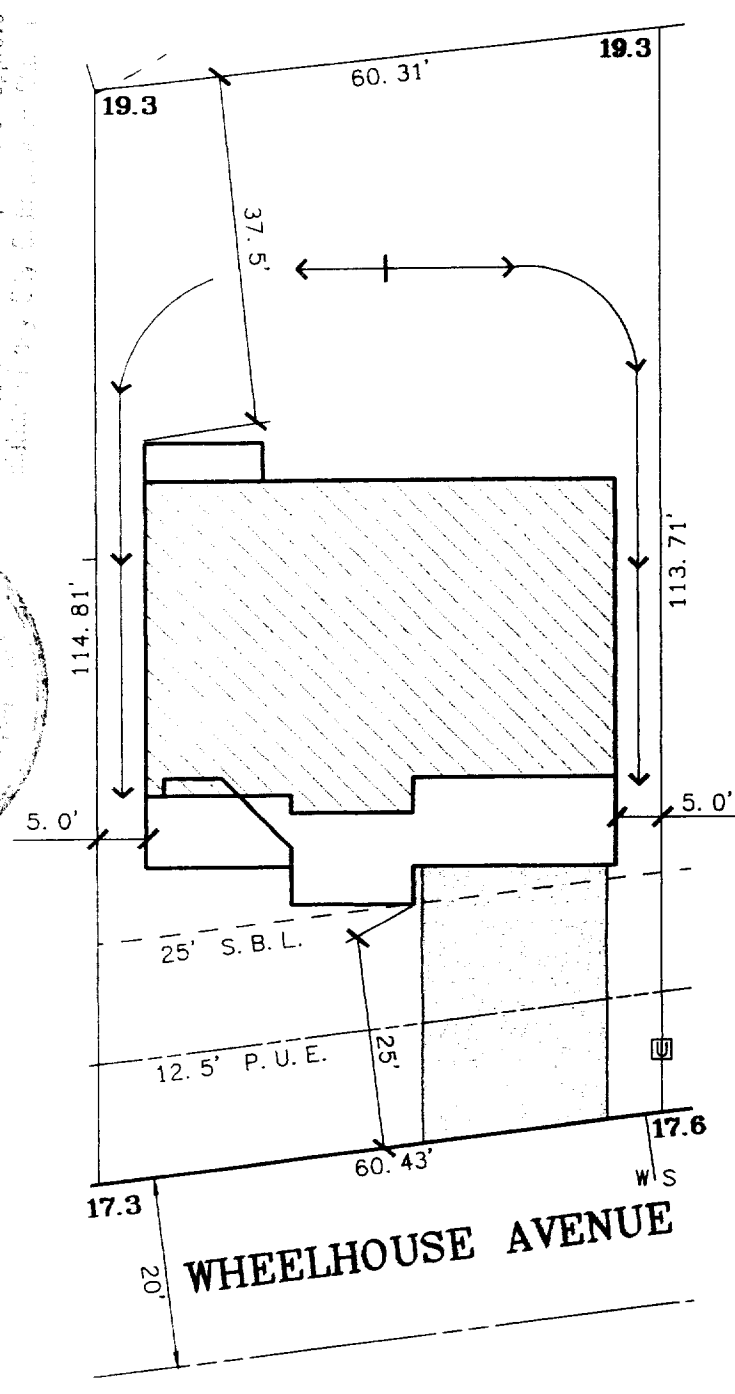

A. P. N. : 3400
 ADDRESS : ~~2400~~ WHEELHOUSE AVENUE

<p>The Spink Corporation 2590 VENTURE OAKS WAY SACRAMENTO, CA. 95833 PH:(916)925-5550 FAX:(916)921-9274</p>	<p>RIVERGATE LOT 5 PLAN 3</p>	<p>RIVERBEND CLASSICS CITY OF SACRAMENTO, CA. CLIENT: WARMINGTON HOMES JOB NO.: 9342-001</p>
---	--	--