

CITY OF SACRAMENTO
1231 I Street, Sacramento, CA 95814

Permit No: 0103177
Insp Area: 4

Site Address: 12 BELLADONNA CT SAC
Parcel No: 201-0430-061
N

NORTHBOROUGH VIL 5-2 LOT LOT 85

Sub-Type: NSFR
Housing (Y/N):

CONTRACTOR
CENTEX HOMES
3300 DOUGLAS BLVD
SFE. 210 95661

OWNER

ARCHITECT

Nature of Work: MP 2134 1 STORY 9 ROOM SFR

CONSTRUCTION LENDING AGENCY: I hereby affirm under penalty of perjury that there is a construction lending agency for the performance of the work for which this permit is issued (Sec. 3097, C.V.C.)

Lender's Name NA Lender's Address _____

LICENSED CONTRACTORS DECLARATION: I hereby affirm under penalty of perjury that I am licensed under provisions of Chapter 9 (commencing with section 7000) of Division 3 of the Business and Professions Code and my license is in full force and effect.

License Class B License Number 743594 Date 3/29/10 Contractor Signature Debra Stowers

OWNER-BUILDER DECLARATION: I hereby affirm under penalty of perjury that I am exempt from the contractors License Law for the following reason (Sec. 7031.5, Business and Professions Code: any city or county which requires a permit to construct, alter, improve, demolish, or repair any structure, prior to its issuance, also requires the applicant for such permit to file a signed statement that he or she is licensed pursuant to the provisions of the Contractors License Law (Chapter 9 (commencing with Section 7000) of Division 8 of the Business and Professions Code) or that he or she is exempt therefrom and the basis for the alleged exemption: Any violation of Section 7031.5 by any applicant for a permit subjects the applicant to a civil penalty of not more than five hundred dollars (\$500.00).

I, as a owner of the property, or my employees with wages as their sole compensation, will do the work, and the structure is not intended or offered for sale (Sec. 7044, Business and Professional Code: The Contractors License Law does not apply to an owner of property who builds or improves thereon, and who does such work himself or herself or through his/her own employees, provided that such improvements are not intended or offered for sale. If, however, the building or improvement is sold within one year of completion, the owner-builder will have the burden of proving that he/she did not build or improve for the purpose of sale.)

I, as owner of the property, am exclusively contracting with licensed contractors to construct the project (Sec. 7044, Business and Professions Code: The Contractors License Law does not apply to an owner of property who builds or improves thereon, and who contracts for such projects with a contractor(s) licensed pursuant to the Contractors License Law.)

I am exempt under Sec _____ B & PC for this reason: _____

Date _____ Owner Signature _____

IN ISSUING THIS BUILDING PERMIT, the applicant represents, and the city relies on the representation of the applicant, that the applicant verified all measurements and locations shown on the application or accompanying drawings and that the improvement to be constructed does not violate any law or private agreement relating to permissible or prohibited locations for such improvements. This building permit does not authorize any illegal location of any improvement or the violation of any private agreement relating to location of improvements.

I certify that I have read this application and state that all information is correct. I agree to comply with all city and county ordinances and state laws relating to building construction and hereby authorize representative(s) of this city to enter upon the abovementioned property for inspection purposes.

Date 3/29/10 Applicant/Agent Signature Debra Stowers

WORKER'S COMPENSATION DECLARATION: I hereby affirm under penalty of perjury one of the following declarations:

I have and will maintain a certificate of consent to self-insure for workers' compensation as provided for by Section 3700 of the Labor Code, for the performance of work for which the permit is issued

I have and will maintain workers' compensation insurance, as required by Section 3700 of the Labor Code, for the performance of the work for which this permit is issued. My workers' compensation insurance carrier and policy number are:

Carrier AMER. GUAR. & LIAB. INS. Policy Number WC8322096-02 Exp Date 10/01/2000

(This section need not be completed if the permit is for \$100 or less) I certify that in the performance of the work for which this permit is issued, I shall not employ any person in any manner so as to become subject to the workers' compensation laws of California and agree that if I should become subject to the workers' compensation provisions of Section 3700 of the Labor Code, I shall forthwith comply with those provisions.

Date 3/29/10 Applicant Signature Debra Stowers

WARNING: FAILURE TO SECURE WORKER'S COMPENSATION COVERAGE IS UNLAWFUL AND SHALL SUBJECT AN EMPLOYER TO CRIMINAL PENALTIES AND CIVIL FINES UP TO ONE HUNDRED THOUSAND DOLLARS (\$100,000) IN ADDITION TO THE COST OF COMPENSATION, DAMAGES AS PROVIDED FOR IN SECTION 3706 OF THE LABOR CODE, INTEREST AND ATTORNEY'S FEE.

THIS PERMIT SHALL EXPIRE BY LIMITATION IF WORK IS NOT COMMENCED WITHIN 180 DAYS.

INSULATION CERTIFICATE

THIS IS TO CERTIFY THAT INSULATION HAS BEEN INSTALLED IN CONFORMANCE WITH THE CURRENT ENERGY REGULATIONS, CALIFORNIA ADMINISTRATION CODE, TITLE 24, STATE OF CALIFORNIA, IN THE BUILDING LOCATED AT:

SITE ADDRESS: LOT 285 NORTHBOROUGH SACRAMENTO, CA
NUMBER STREET CITY STATE

CEILING:

BLOW: MANUFACTURER GREENSTONE THICKNESS 8.1" R/VALUE 30
 SQUARE FEET 2041 # BAGS/LBS PER BAGS 84

BATTS: MANUFACTURER JOHNS MANVILLE THICKNESS 10.25" R/VALUE 30
JOHNS MANVILLE

EXTERIOR WALLS:

MANUFACTURER JOHNS MANVILLE THICKNESS 3.5" R/VALUE 13
JOHNS MANVILLE

FLOOR INSULATION:

MANUFACTURER JOHNS MANVILLE THICKNESS N/A R/VALUE N/A

AIR INFILTRATION: (TITLE 24)

YES XX NO _____

OTHER: _____

GENERAL CONTRACTOR: CENTEX HOMES LICENSE# _____

BY: _____ TITLE: _____ DATE _____

INSULATION CONTRACTOR: WESTERN INSULATION L.P. LICENSE 794484

BY: TAWNYA PERCE TITLE: AUTH. AGENT DATE 8/13/01

RESIDENTIAL BUILDING PERMIT APPLICATION

- New Construction
- Addition
- Remodels
- Other

Project Address: 12 Belladonna Court Assessor Parcel # 201-0430-061
Lot 85

OWNER INFORMATION:

Legal Property Owner: Center Homes Phone # 786-8693
 Owner Address: 3700 Douglas Blvd #150 City Roseville State CA Zip 95661
0103177

CONTRACTOR INFORMATION:

Contractor: Center Homes Lic. # 734094 Phone # 786-8693 Fax# 786-6802

PROJECT INFORMATION:

Land Use Zone RIA Occupancy Group R3 Construction Type VN Fed Code 1A
 No. of stories: 1 No. of rooms: _____ Street width: _____
 1st Floor Area 2134 2nd Floor Area _____ Basement _____ Roof Material _____

AREA IN SQUARE FOOT OF:	EXISTING	NEW
Dwelling/Living	_____	<u>2134</u>
Garage/Storage	_____	<u>580</u>
Decks/Balconies	_____	_____
Carports	_____	_____

SCOPE OF WORK: MP 2134 New SFR

FOR OFFICE USE ONLY

- Information above complete
- AR Flood Waiver required
- Planning Approval
- Violation files checked
- Flood Elevation Certificate Required
- Design Review Approval
- Standard setbacks
- Water Development Infill Area
- Special Fee Districts Apply : _____
- County Sewer

NEW STRUCTURES & ADDITIONS

◆ THE FOLLOWING MUST BE PROVIDED IN ORDER TO SUBMIT FOR PLAN REVIEW

- 2 COMPLETE PLANS, LEGIBLE & DRAWN TO SCALE ◆ Plans to include: site plan, floor plan, elevations, roof/ceiling plan, foundation and structural framing details, and structural calculations for non-conforming structures.
- 3 SETS IF PROJECT IS IN A DESIGN REVIEW AREA
- Title 24 Energy Compliance documentation
- 11" x 17" copy of floor plan for County Assessor
- Grading and Erosion Control Questionnaire
- Plan Review Fees

Date: _____

Received by: (staff) _____

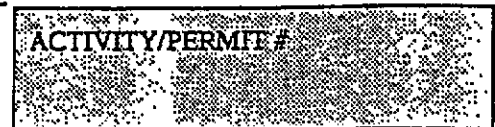

Lot Area = 8,433 sf
 Building Footprint = 2,858 sf
 Gross Coverage = 33.9%
 Porch Allowance = 144 sf
 Net Coverage = 32.2%

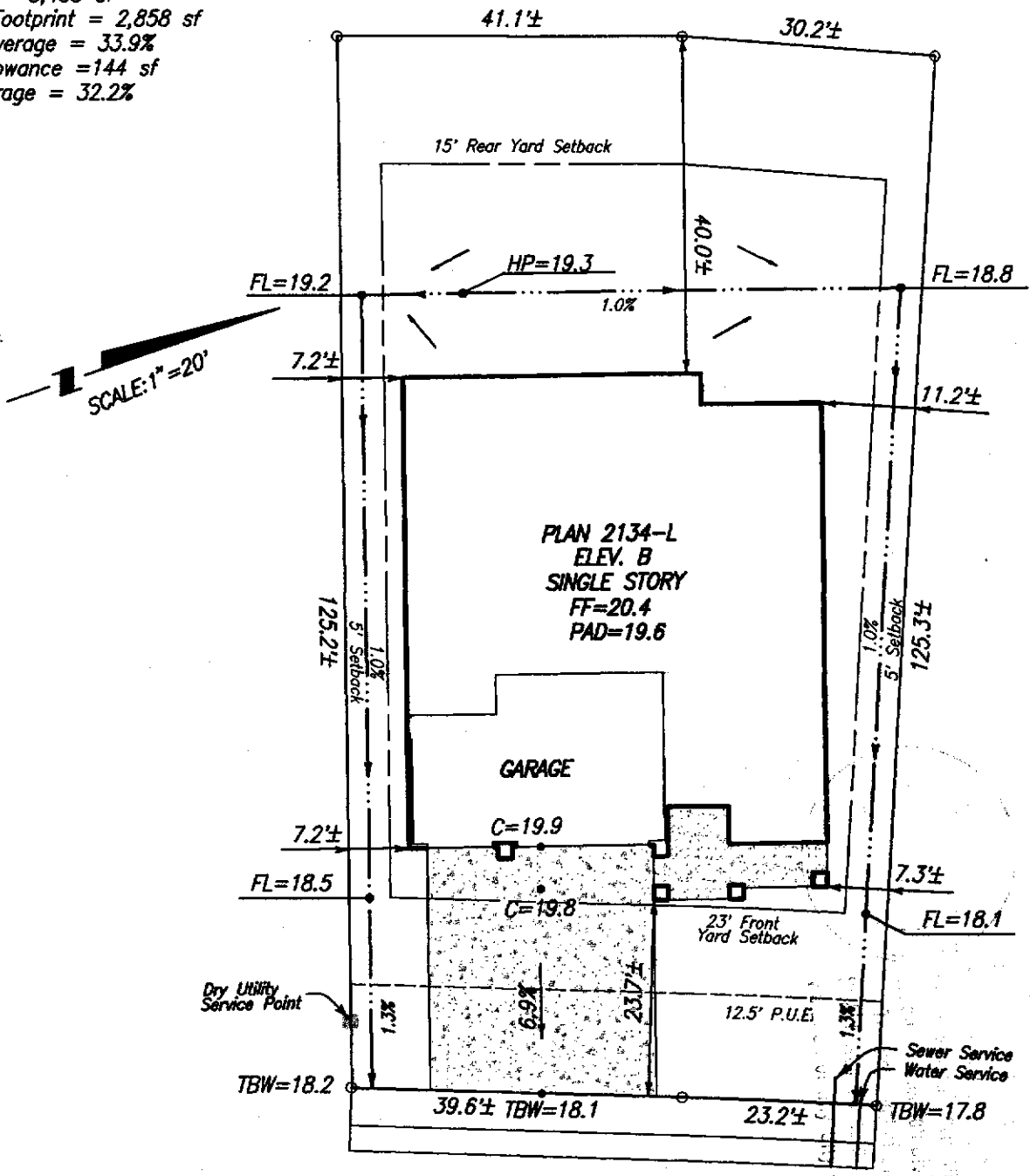

12 BELLADONNA COURT

Plot Plan for Lot 85
 Northborough Village 5-2
 City of Sacramento

Centex Homes
 3700 Douglas Blvd., Suite 150
 Roseville, CA 95661
 Ph.: (916) 786-8693

Plan 2134-Elev. B
 Centex Review & Approval:
 By: ST Date: 2/5/01

Note:
 This plot plan has been prepared for the purpose of showing the building foundation relationship to the property line, proposed drainage elevations and direction of flow to conform to local ordinances and for the purpose of building permit issuance. Information shown is approximate except for those setbacks which are minimums required by ordinance. This plot does not reflect as-built conditions which will likely vary from this plan.

Murray Smith & Associates Engineering, Inc.
 3110 Gold Canal Drive
 Rancho Cordova, CA 95670
 Ph.: (916) 635-1511
 January 29, 2001 PN: 99030