

CITY OF SACRAMENTO
1231 I Street, Sacramento, CA 95814

Permit No: 0111573

Insp Area: 4

Thos Bros:

Sub-Type: NSFR

Housing (Y/N): N

Site Address: 2100 NEW HAMPSHIRE WY SAC

Parcel No: 225-1130-056

PKWY PLZ 2 LOT 56

CONTRACTOR

LENNAR RENAISSANCE INC.
2240 DOUGLAS BL
ROSEVILLE CA. 95661

OWNER

ARCHITECT

Nature of Work: NSFR MP132 8 RMS

CONSTRUCTION LENDING AGENCY: I hereby affirm under penalty of perjury that there is a construction lending agency for the performance of the work for which this permit is issued (Sec. 3097, Civ. C).

Lender's Name _____ Lender's Address _____

LICENSED CONTRACTORS DECLARATION: I hereby affirm under penalty of perjury that I am licensed under provisions of Chapter 9 (commencing with section 7000) of Division 3 of the Business and Professions Code and my license is in full force and effect.

License Class B License Number 732248 Date 10/2/01 Contractor Signature Jennifer Price

OWNER-BUILDER DECLARATION: I hereby affirm under penalty of perjury that I am exempt from the contractors License Law for the following reason (Sec. 7031.5, Business and Professions Code; any city or county which requires a permit to construct, alter, improve, demolish, or repair any structure, prior to its issuance, also requires the applicant for such permit to file a signed statement that he or she is licensed pursuant to the provisions of the Contractors License Law (Chapter 9 (commencing with Section 7000) of Division 8 of the Business and Professions Code) or that he or she is exempt therefrom and the basis for the alleged exemption. Any violation of Section 7031.5 by any applicant for a permit subjects the applicant to a civil penalty of not more than five hundred dollars (\$500.00);

____ I, as a owner of the property, or my employees with wages as their sole compensation, will do the work, and the structure is not intended or offered for sale (Sec. 7044, Business and Professional Code: The Contractors License Law does not apply to an owner of property who builds or improves thereon, and who does such work himself or herself or through his/her own employees, provided that such improvements are not intended or offered for sale. If, however, the building or improvement is sold within one year of completion, the owner-builder will have the burden of proving that he/she did not build or improve for the purpose of sale.)

____ I, as owner of the property, am exclusively contracting with licensed contractors to construct the project (Sec. 7044, Business and Professions Code: The Contractors License Law does not apply to an owner of property who builds or improves thereon, and who contracts for such projects with a contractor(s) licensed pursuant to the Contractors License Law).

____ I am exempt under Sec. _____ B & PC for this reason: _____

Date _____ Owner Signature _____

IN ISSUING THIS BUILDING PERMIT, the applicant represents, and the city relies on the representation of the applicant, that the applicant verified all measurements and locations shown on the application or accompanying drawings and that the improvement to be constructed does not violate any law or private agreement relating to permissible or prohibited locations for such improvements. This building permit does not authorize any illegal location of any improvement or the violation of any private agreement relating to location of improvements.

I certify that I have read this application and state that all information is correct. I agree to comply with all city and county ordinances and state laws relating to building construction and hereby authorize representative(s) of this city to enter upon the abovementioned property for inspection purposes.

Date 10/2/01 Applicant/Agent Signature Jennifer Price

WORKER'S COMPENSATION DECLARATION: I hereby affirm under penalty of perjury one of the following declarations:

____ I have and will maintain a certificate of consent to self-insure for workers' compensation as provided for by Section 3700 of the Labor Code, for the performance of work for which the permit is issued.

JP I have and will maintain workers' compensation insurance, as required by Section 3700 of the Labor Code, for the performance of the work for which this permit is issued. My workers' compensation insurance carrier and policy number are:

Carrier CNA INSURANCE COMPANY

Policy Number: WC138201151

Exp Date 06/01/2002

____ (This section need not be completed if the permit is for \$100 or less) I certify that in the performance of the work for which this permit is issued, I shall not employ any person in any manner so as to become subject to the workers' compensation laws of California and agree that if I should become subject to the workers' compensation provisions of Section 3700 of the Labor Code, I shall forthwith comply with those provisions.

Date 10/2/01 Applicant Signature Jennifer Price

WARNING: FAILURE TO SECURE WORKER'S COMPENSATION COVERAGE IS UNLAWFUL AND SHALL SUBJECT AN EMPLOYER TO CRIMINAL PENALTIES AND CIVIL FINES UP TO ONE HUNDRED THOUSAND DOLLARS (\$100,000) IN ADDITION TO THE COST OF COMPENSATION, DAMAGES AS PROVIDED FOR IN SECTION 3706 OF THE LABOR CODE, INTEREST AND ATTORNEY'S FEE.

THIS PERMIT SHALL EXPIRE BY LIMITATION IF WORK IS NOT COMMENCED WITHIN 180 DAYS.

#56

OMEGA PRODUCTS CORP.

DIAMOND WALL INSULATING STUCCO SYSTEM

JOB ADDRESS:

ICBO Report 14004

RENAISSANCE SANDALWOOD

3/29/02

Date of Job Completion

PLASTERING CONTRACTOR:

Name: STUCCO WORKS INC.

Address: 5900 WAREHOUSE WAY SACRAMENTO, CALIFORNIA 95826

Telephone No: (916) 383-6699

Contractor Number of Diamond Wall System 2175

This is to certify that the exterior coating system on the building exterior at the above address has been installed in accordance with the evaluation report specified above and the manufacturer's instructions.

5/8/02

Date

[Signature]

Signature of authorized representative of
Plastering Contractor

This installation card must be presented to the building inspector after completion of work and before final inspection.

RESIDENTIAL BUILDING PERMIT APPLICATION

New Construction Addition Remodels Other

Project Address: 2100 New Hampshire Way Lot # 56 Assessor Parcel # 226-1130-050-00

OWNER INFORMATION: Northpointe #9

Legal Property Owner: Lennar Renaissance Inc. Phone # (916) 773-4083
Owner Address: 2240 Douglas Blvd. #250 City Roseville State CA Zip 95661

CONTRACTOR INFORMATION:

Contractor: Same Lic # 732348 B Phone # 773-4083 Fax# 773-4086

PROJECT INFORMATION:

Land Use Zone R/A Occupancy Group R3 Construction Type VN Fed Code 1A

No. of stories: 1 No. of rooms: 7 Street width: 40

1st Floor Area 1665 2nd Floor Area _____ Basement N/A Roof Material Tile

AREA IN SQUARE FOOT OF:

EXISTING

NEW

Dwelling/Living	_____	<u>1665</u>
Garage/Storage	_____	<u>403</u>
Decks/Balconies	_____	<u>122</u>
Carports	_____	_____

SCOPE OF WORK: MP 1665/ 132 - New Construction - SFD

FOR OFFICE USE ONLY

- | | | |
|---|---|--|
| <input type="checkbox"/> Information above complete | <input type="checkbox"/> AR Flood Waiver required | <input type="checkbox"/> Planning Approval |
| <input type="checkbox"/> Violation files checked | <input type="checkbox"/> Flood Elevation Certificate Required | <input type="checkbox"/> Design Review Approval |
| <input type="checkbox"/> Standard setbacks | <input type="checkbox"/> Water Development Infill Area | <input type="checkbox"/> Special Fee Districts Apply : _____ |
| <input type="checkbox"/> County Sewer | | |

NEW STRUCTURES & ADDITIONS

❖ THE FOLLOWING MUST BE PROVIDED IN ORDER TO SUBMIT FOR PLAN REVIEW

- | | |
|---|---|
| <input type="checkbox"/> 2 COMPLETE PLANS, LEGIBLE & DRAWN TO SCALE | ❖ Plans to include: site plan, floor plan, elevations, roof/ceiling plan, foundation and structural framing details, and structural calculations for non-conforming structures. |
| <input type="checkbox"/> 3 SETS IF PROJECT IS IN A DESIGN REVIEW AREA | |
| <input type="checkbox"/> Title 24 Energy Compliance documentation | <input type="checkbox"/> 11" x 17" copy of floor plan for County Assessor |
| <input type="checkbox"/> Grading and Erosion Control Questionnaire | <input type="checkbox"/> Plan Review Fees |

Date: _____

Received by: (staff) _____

ACTIVITY/PERMIT #

CERTIFICATION OF INSULATION

ADDRESS OR TRACT

SACRAMENTO INSULATION CONTRACTORS

RENAISSANCE

LOT # 56

- P.O. BOX 854, WEST SACRAMENTO, CA 95691 LIC. #202026
- 1309 MELODY ROAD, MARYSVILLE, CA 95901 LIC. #202026
- P.O. BOX 9651, FRESNO, CA 93793-9651 LIC. #202026
- P.O. BOX 1631, RENO, NV 89505 LIC. #10675
- 3326 A PONDEROSA WAY, LAS VEGAS, NV 89118 LIC. #10675

SANDALWOOD

DATE INSULATION COMPLETED

WALLS

CEILING

FLOORS

(SQUARE FEET)

(SQUARE FEET)

(SQUARE FEET)

TYPE OF INSULATION

TYPE OF INSULATION

TYPE OF INSULATION

MATERIAL

FIBERGLASS

MATERIAL

FIBERGLASS

MATERIAL

FIBERGLASS

FORM

BATTS

FORM

BATTS & BLOW

FORM

BATTS

MANUFACTURER'S PRODUCT I.D.

MANUFACTURER'S PRODUCT I.D.

MANUFACTURER'S PRODUCT I.D.

MANUFACTURER

OCF

MANUFACTURER

OCF

MANUFACTURER

OCF

BAGS

R-VALUE
INSTALLED

APPLIED
THICKNESS

R-VALUE
INSTALLED

APPLIED
THICKNESS

MIN. INSTALLED
WEIGHT PER
SQUARE FOOT

R-VALUE
INSTALLED

APPLIED
THICKNESS

13

3 5/8"

30
30

9"
12"

KNEE WALLS IF R-VALUE IS OTHER THAN WALLS ABOVE

MATERIAL

FIBERGLASS

FORM

BATTS

R VALUE

MANUFACTURER

OCF

AIR INFILTRATION SEALANT

MATERIAL

FOAM

MANUFACTURER

W R GRACE

THIS IS TO CERTIFY THAT INSULATION AND/OR SEALANT HAS BEEN INSTALLED IN CONFORMANCE WITH APPLICABLE CODES, MATERIAL STANDARDS AND REGULATIONS.

SIGNATURE - INSULATION CONTRACTOR

Jeff Cable

TITLE

MANAGER

DATE

3-20-02

SIGNATURE - GENERAL CONTRACTOR

TITLE

DATE

REMARKS:

PART I GENERAL

PART II AREAS INSULATED

PART III CERTIFICATION

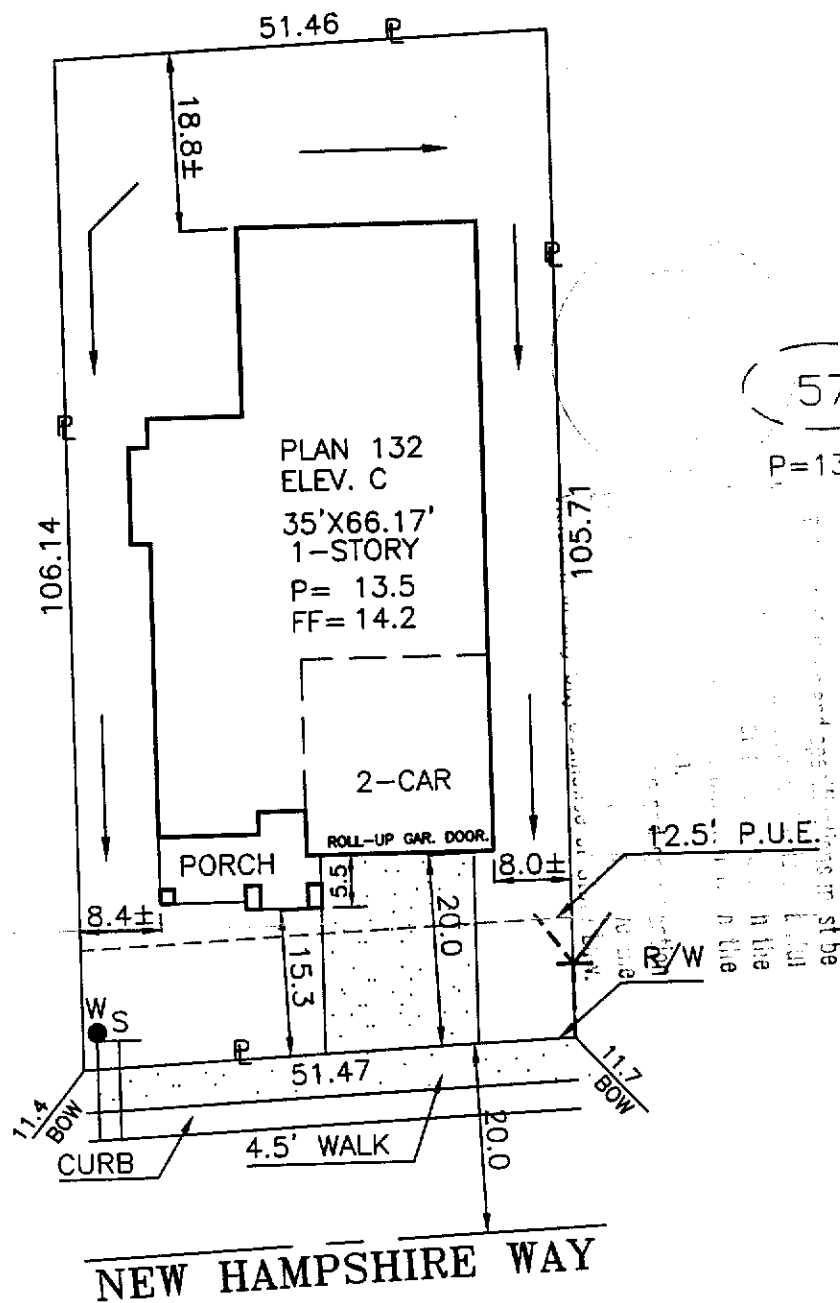

DIMENSIONS SHOWN ARE APPROXIMATE EXCEPT FOR MINIMUMS REQUIRED BY ORDINANCE.
THIS PLOT DOES NOT REFLECT AS BUILT CONDITIONS AND MAY VARY FROM THIS PLAN.

RENAISSANCE H O M E S

2240 DOUGLAS BLVD. SUITE 250 ROSEVILLE, CA. 95661
PHONE (916) 773-4083 FAX (916) 773-4086

SANDALWOOD

PLOT PLAN

PARKWAY PLAZA UNIT 2
CITY OF SACRAMENTO
SACTO. COUNTY, CALIFORNIA

NOTES:

ADDRESS: 2100 NEW HAMPSHIRE WAY

LOT COV: 38%

PLAN NO.: 132-C

LOT SQ. FT.: 5,447.6

APN: 225-113-056-000

DRAWN BY: R.P.

APPROVED BY: *[Signature]*

DATE: 8/8/01

SCALE: 1"=20'

LOT 56