

CITY OF SACRAMENTO
1231 I Street, Sacramento, CA 95814

Permit No: 0005585
Insp Area: 2

Site Address: 8547 TAMBOR WY SAC
Parcel No: 117-1310-064 LOT 64 JACINTO VIL.-2

Sub-Type: NSFR
Housing (Y/N): N

CONTRACTOR
T&I PROPERTIES
3434 MARCONI AV. STE. C
SACRAMENTO CA. 95821

OWNER

ARCHITECT

Nature of Work: MP 1579 1 STORY 8 ROOM SFR

CONSTRUCTION LENDING AGENCY: I hereby affirm under penalty of perjury that there is a construction lending agency for the performance of the work for which this permit is issued (Sec. 3097, Civ. C).

Lender's Name _____ Lender's Address _____

LICENSED CONTRACTORS DECLARATION: I hereby affirm under penalty of perjury that I am licensed under provisions of Chapter 9 (commencing with section 7000) of Division 3 of the Business and Professions Code and my license is in full force and effect.

License Class B License Number 6601302 Date 2/24/00 Contractor Signature [Signature]

OWNER-BUILDER DECLARATION: I hereby affirm under penalty of perjury that I am exempt from the contractors License Law for the following reason (Sec. 7031.5, Business and Professions Code; any city or county which requires a permit to construct, alter, improve, demolish, or repair any structure, prior to its issuance, also requires the applicant for such permit to file a signed statement that he or she is licensed pursuant to the provisions of the Contractors License Law (Chapter 9 (commencing with Section 7000) of Division 8 of the Business and Professions Code) or that he or she is exempt therefrom and the basis for the alleged exemption. Any violation of Section 7031.5 by any applicant for a permit subjects the applicant to a civil penalty of not more than five hundred dollars (\$500.00):

_____, I, as a owner of the property, or my employees with wages as their sole compensation, will do the work, and the structure is not intended or offered for sale (Sec. 7044, Business and Professional Code: The Contractors License Law does not apply to an owner of property who builds or improves thereon, and who does such work himself or herself or through his/her own employees, provided that such improvements are not intended or offered for sale. If, however, the building or improvement is sold within one year of completion, the owner-builder will have the burden of proving that he/she did not build or improve for the purpose of sale.)

_____, I, as owner of the property, am exclusively contracting with licensed contractors to construct the project (Sec. 7044, Business and Professions Code. The Contractors License Law does not apply to an owner of property who builds or improves thereon, and who contracts for such projects with a contractor(s) licensed pursuant to the Contractors License Law).

_____ I am exempt under Sec. _____ B & PC for this reason: _____

Date _____ Owner Signature _____

IN ISSUING THIS BUILDING PERMIT, the applicant represents, and the city relies on the representation of the applicant, that the applicant verified all measurements and locations shown on the application or accompanying drawings and that the improvement to be constructed does not violate any law or private agreement relating to permissible or prohibited locations for such improvements. This building permit does not authorize any illegal location of any improvement or the violation of any private agreement relating to location of improvements.

I certify that I have read this application and state that all information is correct. I agree to comply with all city and county ordinances and state laws relating to building construction and hereby authorize representative(s) of this city to enter upon the abovementioned property for inspection purposes.

Date 2/24/00 Applicant/Agent Signature [Signature]

WORKER'S COMPENSATION DECLARATION: I hereby affirm under penalty of perjury one of the following declarations:

_____, I have and will maintain a certificate of consent to self-insure for workers' compensation as provided for by Section 3700 of the Labor Code, for the performance of work for which the permit is issued.

6 I have and will maintain workers' compensation insurance, as required by Section 3700 of the Labor Code, for the performance of the work for which this permit is issued. My workers' compensation insurance carrier and policy number are:

Carrier RELIANCE INS CO NWA2047932-00 Exp Date 11/18/2000

_____, (This section need not be completed if the permit is for \$100 or less) I certify that in the performance of the work for which this permit is issued, I shall not employ any person in any manner so as to become subject to the workers' compensation laws of California and agree that if I should become subject to the workers' compensation provisions of Section 3700 of the Labor Code, I shall forthwith comply with those provisions.

Date 2/24/00 Applicant Signature [Signature]

WARNING: FAILURE TO SECURE WORKER'S COMPENSATION COVERAGE IS UNLAWFUL AND SHALL SUBJECT AN EMPLOYER TO CRIMINAL PENALTIES AND CIVIL FINES UP TO ONE HUNDRED THOUSAND DOLLARS (\$100,000) IN ADDITION TO THE COST OF COMPENSATION, DAMAGES AS PROVIDED FOR IN SECTION 3706 OF THE LABOR CODE, INTEREST AND ATTORNEY'S FEE.

THIS PERMIT SHALL EXPIRE BY LIMITATION IF WORK IS NOT COMMENCED WITHIN 180 DAYS.

RESIDENTIAL SUBDIVISION BUILDING PERMIT APPLICATION

Project Address: 8547 Tambo- WY Assessor Parcel # 117-131-64
Lot Number: 64 Subdivision Jacinto Village Unit: 2

OWNER INFORMATION:

Legal Property Owner: J&L Properties Phone# 916-487-3434
Owner Address: 3434 Marconi Ave City Sacto State CA Zip 95821

CONTRACTOR INFORMATION:

Contractor: J&L Properties Lic. # 660088 Phone # 487-3434 Fax 487-3815

PROJECT INFORMATION:

Land Use Zone R1A Occupancy Group R3 Construction Type VN Fed Code 1A
No. of Stories: 1 No. of Rooms: Street Width:
1st Floor Area 1579 2nd Floor Area Basement Roof Material
AREA IN SQUARE FOOT OF:
Dwelling/Living 1579
Garage/Storage 434
Decks/Balconies
Carports
SCOPE OF WORK: New SFD: PLAN 97-5

FOR OFFICE USE ONLY

- Information Above Complete AR Flood Waiver Required Planning Approval
Violation Files Checked Flood Elevation Certificate Required Design Review Approval
Standard Setbacks Water Development Infill Area Special Fee Districts Apply:
County Sewer
-THE FOLLOWING MUST BE PROVIDED IN ORDER TO SUBMIT FOR PERMIT-
2 COMPLETE PLOT PLANS, LEGIBLE & DRAWN TO SCALE
11 X 17 COPY OF FLOOR PLAN WITH FOLLOWING INFORMATION
a) Assessor's Parcel Number c) Owners Name
b) New Floor Area d) Project Address

Date: Received by: (staff) Permit #

INSULATION
CERTIFICATE

WES PAC INSULATION, INC.

THIS IS TO CERTIFY THAT INSULATION HAS BEEN INSTALLED IN CONFORMANCE WITH CURRENT ENERGY REGULATIONS, CALIFORNIA ADMINISTRATIVE CODE, TITLE 24, STATE OF CALIFORNIA, IN THE BUILDING LOCATED AT:

Plan 97J LOT # 64 TRACT # _____
STREET Laguna Point CITY Sac

EXTERIOR WALLS:
MANUFACTURER JM THICKNESS/TYPE 3 1/2 R-VALUE 13

CEILINGS:
RAIS:
MANUFACTURER JM THICKNESS/TYPE 10 R-VALUE 30

BLOWN IN:
MANUFACTURER Green Stone THICKNESS/TYPE 8.1 R-VALUE 30

SQUARE FOOTAGE COVERED 1000 NUMBER OF BAGS USED 34

FLOORS:
MANUFACTURER _____ THICKNESS/TYPE _____ R-VALUE _____

SLAB ON GRADE:
MANUFACTURER _____ THICKNESS/TYPE _____ R-VALUE _____

WIDTH OF INSULATION _____ INCHES

FOUNDATION WALLS:
MANUFACTURER _____ THICKNESS/TYPE _____ R-VALUE _____

GENERAL CONTRACTOR J&L Properties
CALIFORNIA CONTRACTORS LICENSE # 50 DATE 9/20/02

[Signature] SIGNATURE Supervisor TITLE

INSULATION CONTRACTOR WES PAC INSULATION, INC.
CALIFORNIA CONTRACTORS LICENSE # #487478 DATE _____

[Signature] SIGNATURE [Signature] TITLE

- 1 STORY HOUSE
- 2 - CAR GARAGE
- 4950 SQ. FT. OF LOT
- 8547 STREET ADDRESS

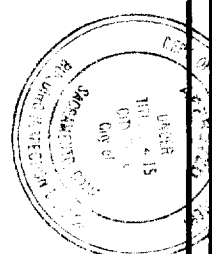
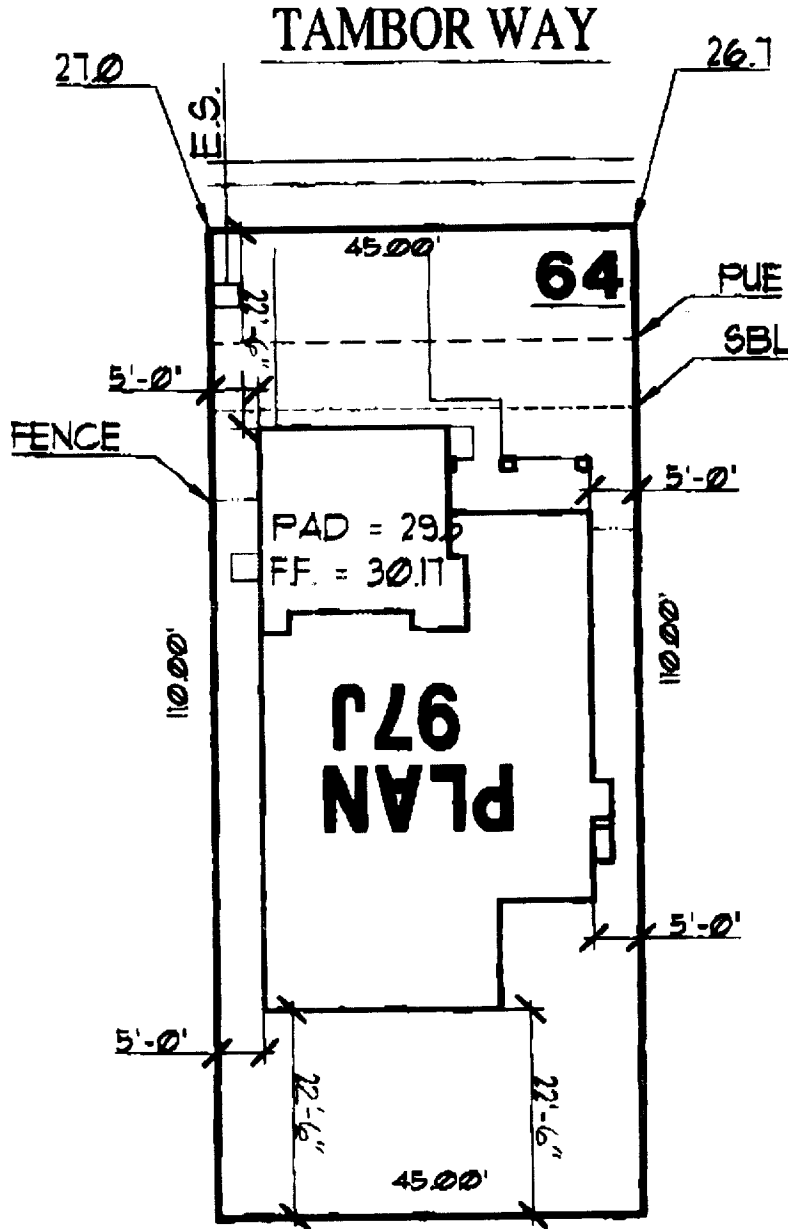

same without written consent of JTS Communities. Building inspection Division. The City Seal of this City shall not be held to prevent a violation of any City Ordinance or State Law.



Larry A. Sussman
Architect
J & L Properties
Professional Services

REVISION

ORIGINAL
APR 27 2000
Cindy Moreno

JTS Communities
3434 Marconi Avenue
Sacramento, CA 95821 (916) 487-3434
Suite A

PROPOSED SITE PLAN
JACINTO VILLAGE UNIT NO. 2
SUBDIVISION

LAGUNA
POINTE

Date: Apr 27, 2000
 Drawn: [Signature]
 Job:
 Scale: 1/8" = 1'-0"
 Sheet:
 of 3 sheets

APPROVED FOR RELEASE	DATE	APPROVED BY BUYER	DATE
----------------------	------	-------------------	------