

CITY OF SACRAMENTO
1231 I Street, Sacramento, CA 95814

Permit No: 0104434
Insp Area: 4

Site Address: 3235 MARSHSONG CT SAC
Parcel No: 225-1240-062 GATEWAY N 2 LOT 97

Sub-Type: NSFR
Housing (Y/N): N

CONTRACTOR
MARCHBROOK BUILDING CO
PO BOX 7576
STOCKTON CA 95267

OWNER
SUNDANCE LAKE LLC
P O BOX 7576
STOCKTON CA 95267

ARCHITECT

Nature of Work: NSFR MP2505 9 RMS 2 STORY

CONSTRUCTION LENDING AGENCY: I hereby affirm under penalty of perjury that there is a construction lending agency for the performance of the work for which this permit is issued (Sec. 3097, Civ. C.)

Lender's Name _____ Lender's Address _____

LICENSED CONTRACTORS DECLARATION: I hereby affirm under penalty of perjury that I am licensed under provisions of Chapter 9 (commencing with section 7000) of Division 3 of the Business and Professions Code and my license is in full force and effect.

License Class B License Number 740353 Date 5-4-01 Contractor Signature [Signature]

OWNER-BUILDER DECLARATION: I hereby affirm under penalty of perjury that I am exempt from the contractors License Law for the following reason (Sec. 7031.5, Business and Professions Code, any city or county which requires a permit to construct, alter, improve, demolish, or repair any structure, prior to its issuance, also requires the applicant for such permit to file a signed statement that he or she is licensed pursuant to the provisions of the Contractors License Law (Chapter 9, commencing with Section 7000) of Division 8 of the Business and Professions Code) or that he or she is exempt therefrom and the basis for the alleged exemption: Any violation of Section 7031.5 by any applicant for a permit subjects the applicant to a civil penalty of not more than five hundred dollars (\$500.00).

_____, I, as a owner of the property, or my employees with wages as their sole compensation, will do the work, and the structure is not intended or offered for sale (Sec. 7044, Business and Professional Code: The Contractors License Law does not apply to an owner of property who builds or improves thereon, and who does such work himself or herself or through his/her own employees, provided that such improvements are not intended or offered for sale. If, however, the building or improvement is sold within one year of completion, the owner-builder will have the burden of proving that he/she did not build or improve for the purpose of sale.)

_____, I, as owner of the property, am exclusively contracting with licensed contractors to construct the project (Sec. 7044, Business and Professions Code: The Contractors License Law does not apply to an owner of property who builds or improves thereon, and who contracts for such projects with a contractor(s) licensed pursuant to the Contractors License Law.)

I am exempt under Sec. _____ B & PC for this reason: _____

Date _____ Owner Signature _____

IN ISSUING THIS BUILDING PERMIT, the applicant represents, and the city relies on the representation of the applicant, that he/she has verified all measurements and locations shown on the application or accompanying drawings and that the improvement to be constructed does not violate any law or private agreement relating to permissible or prohibited locations for such improvements. This building permit does not authorize any illegal location of any improvement or the violation of any private agreement relating to location of improvements.

I certify that I have read this application and state that all information is correct. I agree to comply with all city and county ordinances and state laws relating to building construction and hereby authorize representative(s) of this city to enter upon the abovementioned property for inspection purposes.

Date 5-4-01 Applicant Agent Signature [Signature]

WORKER'S COMPENSATION DECLARATION: I hereby affirm under penalty of perjury one of the following declarations:

_____, I have and will maintain a certificate of consent to self-insure for workers' compensation as provided for by Section 3700 of the Labor Code, for the performance of work for which the permit is issued.

_____, I have and will maintain workers' compensation insurance, as required by Section 3700 of the Labor Code, for the performance of the work for which this permit is issued. My workers' compensation insurance carrier and policy number are:

Carrier SAFECO INSURANCE CO OF AMERICA Policy Number WC2342690D Exp Date 07/01/2001

_____, This section need not be completed if the permit is for \$100 or less. I certify that in the performance of the work for which this permit is issued, I shall not employ any person in any manner so as to become subject to the workers' compensation laws of California and agree that if I should become subject to the workers' compensation provisions of Section 3700 of the Labor Code, I shall forthwith comply with those provisions.

Date 5-4-01 Applicant Signature [Signature]

WARNING: FAILURE TO SECURE WORKER'S COMPENSATION COVERAGE IS UNLAWFUL AND SHALL SUBJECT AN EMPLOYER TO CRIMINAL PENALTIES AND CIVIL FINES UP TO ONE HUNDRED THOUSAND DOLLARS (\$100,000) IN ADDITION TO THE COST OF COMPENSATION, DAMAGES AS PROVIDED FOR IN SECTION 3706 OF THE LABOR CODE, INTEREST AND ATTORNEY'S FEE.

THIS PERMIT SHALL EXPIRE BY LIMITATION IF WORK IS NOT COMMENCED WITHIN 180 DAYS.



WesPac

Insulation
a MASCO Company

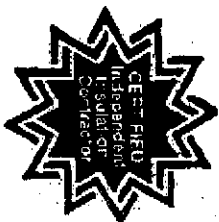

809 North Market Blvd, Ste. 11 • Sacramento, CA 95834
(916) 927-7149 • Fax (916) 927-4257
Lic. #487478

Installed Insulation Certificate

We certify that the building insulation listed herein is installed in conformance with current energy conservation regulations, California Administrative Code, Title 24, State of California

REACTION	AREA	TYPE	INCHES/RACS (BLOWN)
R38	ATTIC	FIBERGLASS BLOWN	14.75" / 30 BAGS
R38	CEILING	FIBERGLASS BATT	13"
R15	EXTERIOR WALLS	FIBERGLASS BATT	3.5"

MARCHBROOK BLDGS.

Certified by Tommy Jimenez
Title Secretary

SUNDANCE LAKE
11111 SUNDANCE LAKE #97
Address of Lot Number

Date Installed 10/02/91 Phase # _____



WALLACE • KUHL & ASSOCIATES INC.
 GEOTECHNICAL ENGINEERING • CONSTRUCTION TESTING

3050 Industrial Blvd.
 PO Box 1137
 West Sacramento
 California 95691
 916-372-1434

DATE 7-27-01		JOB NO. 3895.24		WEATHER		TEMP. ° at		AM	
PROJECT GATEWAY North		LOCATION Marchbrook hms.		Technician I <input type="checkbox"/>		Staff E/G <input type="checkbox"/>			
LOCATION Lots #1 97, 98		TYPE OF WORK Full Test		Technician II <input type="checkbox"/>		Project E/G <input type="checkbox"/>			
Inside 50 mi. radius <input checked="" type="checkbox"/>		Outside 50 mi. radius <input type="checkbox"/>		Technician III <input type="checkbox"/>		Senior E/G <input type="checkbox"/>			
PERSONNEL		REG. HRS	OT HRS	TOTAL HRS	TRAVEL	ON JOB	VEHICLE	MILES	
DS		1.5	0	2.0	5	7 AM	#	16	

OBSERVATIONS:
 ON SITE AS REQUESTED TO PERFORM FULL TEST ON 5" & 7/8" ALL-BREAD FOR HIT22'S & PHD8'S (see A pull value of 7500# AND A gage psi of 3300# USING JACK F WITH gage # SE @ THE FOLLOWING LOCATIONS.

LT #97 - HIT22'S IEA. S/wall GARAGE, IEA. N/END OF INER SHEAR WALL, IEA. S/wall DEN. PHD8'S # 3EA. E/wall family Rm. 1 N/A
 PASSED

LT #98 - HIT22'S IEA. N/wall KITCHEN, IEA. E/wall front bed rm. PHD8 IEA. S/wall GARAGE. PASSED

FEES
MAR 25 05

RESIDENTIAL BUILDING PERMIT APPLICATION

- New Construction
- Addition
- Remodels
- Other

Project Address: 3235 Marchbrook Court Assessor Parcel # 225-1240-062

OWNER INFORMATION: 1197-MP 0505

Legal Property Owner: Sundance Lake LLC, A Delaware Limited Liability Co. Phone # (209)473-6000
 Owner Address: P.O. Box 7576 City Stockton State CA Zip 95267

CONTRACTOR INFORMATION:

Contractor: Marchbrook Building Co Lic. # 740353 Phone # (209)473-6000 Fax # (209)473-6044

PROJECT INFORMATION:

Land Use Zone _____ Occupancy Group _____ Construction Type _____ Fed Code _____

No. of stories: 2 No. of rooms: 9 Street width: _____

1st Floor Area 1394 2nd Floor Area 1117 Basement _____ Roof Material _____

AREA IN SQUARE FOOT OF:

	EXISTING	NEW
Dwelling/Living	<u>2513</u>	_____
Garage/Storage	<u>467</u>	_____
Deck <u>1010</u> Balconies	<u>189</u>	_____
Carports	<u>10/1A</u>	_____

SCOPE OF WORK: SFD

FOR OFFICE USE ONLY

- Information above complete
- Violation files checked
- Standard setbacks
- County Sewer
- AR Flood Waiver required
- Flood Elevation Certificate Required
- Water Development Infill Area
- Planning Approval
- Design Review Approval
- Special Fee Districts Apply : _____

NEW STRUCTURES & ADDITIONS

❖ THE FOLLOWING MUST BE PROVIDED IN ORDER TO SUBMIT FOR PLAN REVIEW

- 2 COMPLETE PLANS, LEGIBLE & DRAWN TO SCALE
 - 3 SETS IF PROJECT IS IN A DESIGN REVIEW AREA
 - Title 24 Energy Compliance documentation
 - Grading and Erosion Control Questionnaire
 - 11" x 17" copy of floor plan for County Assessor
 - Plan Review Fees
- ❖ Plans to include: site plan, floor plan, elevations, roof/ceiling plan, foundation and structural framing details, and structural calculations for non-conforming structures.

Date: _____ Received by: (staff) _____

ACTIVITY/PERMIT # _____

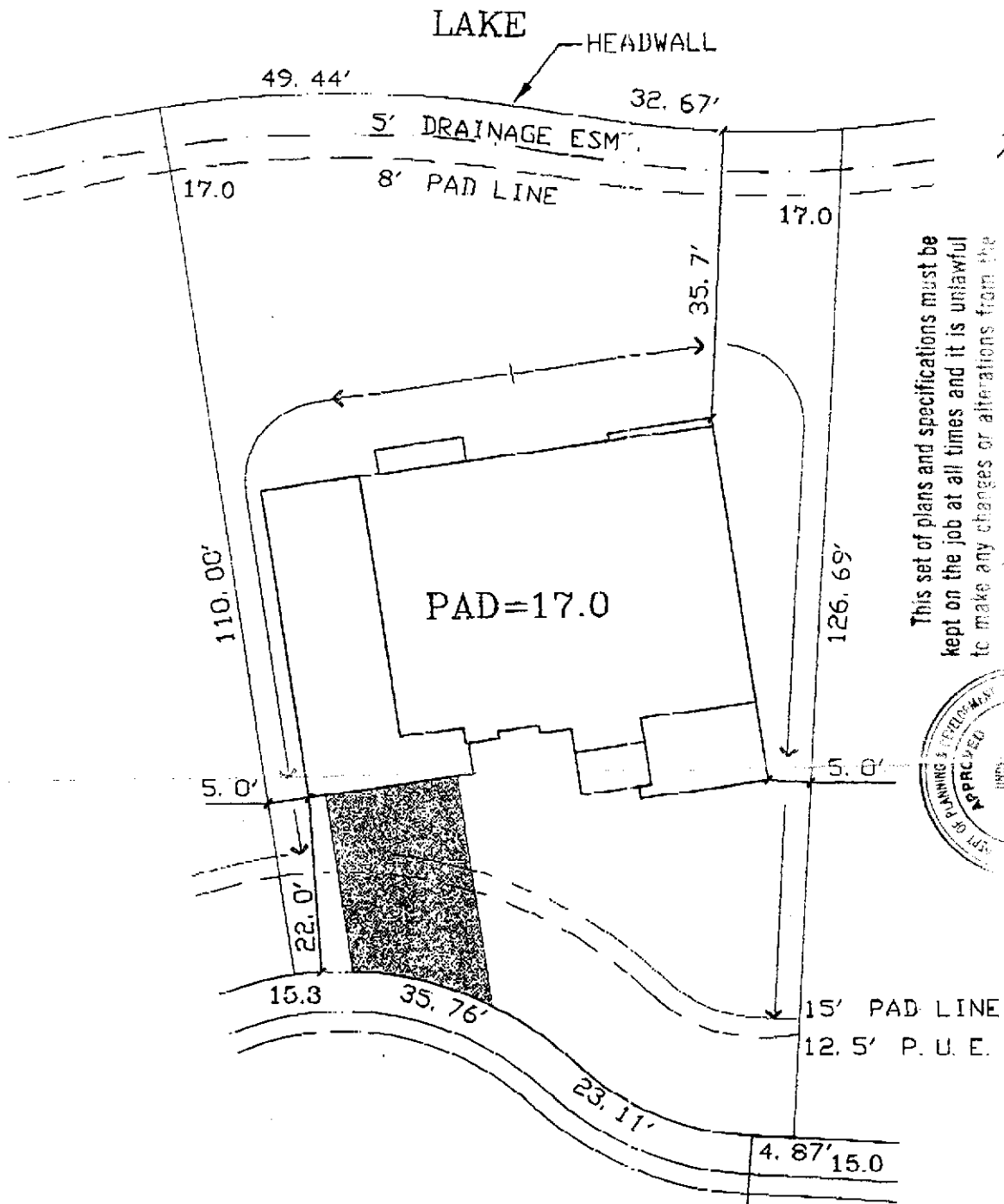

This set of plans and specifications must be kept on the job at all times and it is unlawful to make any changes or alterations from the plans without written permission from the City of Planning & Development.



MARSHSONG COURT W/S

LOT 97
 PLAN 3B LEFT
 A.P.N.:
 MARSHSONG COURT
 LOT AREA: 8,315 SF
 LOT COVERAGE: 27%

<p>The Spink Corporation 2590 VENTURE OAKS WAY SACRAMENTO, CA. 95833 PR:(916)925-6660 FAX:(916)921-9274</p>	<p>MARCHBROOK BUILDING COMPANY P.O. Box 7576 Stockton, Ca 95267 office: (209) 473-6053 fax: (209) 951-0684</p>	<p>GATEWAY NORTH VILLAGE 2 City of Sacramento, California Scale: 1"=20' March 30, 2001</p>
---	---	--