

CITY OF SACRAMENTO
1231 I Street, Sacramento, CA 95814

Permit No: 0011542
Insp Area: 4

Site Address: 2000 NORTH BEND DR SAC
Parcel No: 225-1370-082 NORTHPT PK 8 LOT 62

Sub-Type: NSFR
Housing (Y/N): N

CONTRACTOR
MOURIER JOHN CONSTRUCTION INC.
1830 VERNON ST
SUITE 9 95687

OWNER

ARCHITECT

Nature of Work: NSFR MP2447 2 STORY 11 RMS

CONSTRUCTION LENDING AGENCY : I hereby affirm under penalty of perjury that there is a construction lending agency for the performance of the work for which this permit is issued (Sec. 3097, Civ. C).

Lender's Name _____ Lender's Address _____

LICENSED CONTRACTORS DECLARATION: I hereby affirm under penalty of perjury that I am licensed under provisions of Chapter 9 (commencing with section 7000) of Division 3 of the Business and Professions Code and my license is in full force and effect.

License Class D License Number 613004 Date 10/3/00 Contractor Signature N. Collins

OWNER-BUILDER DECLARATION: I hereby affirm under penalty of perjury that I am exempt from the contractors License Law for the following reason (Sec. 7031.5, Business and Professions Code; any city or county which requires a permit to construct, alter, improve, demolish, or repair any structure, prior to its issuance, also requires the applicant for such permit to file a signed statement that he or she is licensed pursuant to the provisions of the Contractors License Law (Chapter 9 (commencing with Section 7000) of Division 8 of the Business and Professions Code) or that he or she is exempt therefrom and the basis for the alleged exemption. Any violation of Section 7031.5 by any applicant for a permit subjects the applicant to a civil penalty of not more than five hundred dollars (\$500.00).

____ I, as a owner of the property, or my employees with wages as their sole compensation, will do the work, and the structure is not intended or offered for sale (Sec. 7044, Business and Professional Code: The Contractors License Law does not apply to an owner of property who builds or improves thereon, and who does such work himself or herself or through his/her own employees, provided that such improvements are not intended or offered for sale. If, however, the building or improvement is sold within one year of completion, the owner-builder will have the burden of proving that he/she did not build or improve for the purpose of sale.)

____ I, as owner of the property, am exclusively contracting with licensed contractors to construct the project (Sec. 7044, Business and Professions Code: The Contractors License Law does not apply to an owner of property who builds or improves thereon, and who contracts for such projects with a contractor(s) licensed pursuant to the Contractors License Law).

____ I am exempt under Sec. _____ B & PC for this reason: _____

Date _____ Owner Signature _____

IN ISSUING THIS BUILDING PERMIT, the applicant represents, and the city relies on the representation of the applicant, that the applicant verified all measurements and locations shown on the application or accompanying drawings and that the improvement to be constructed does not violate any law or private agreement relating to permissible or prohibited locations for such improvements. This building permit does not authorize any illegal location of any improvement or the violation of any private agreement relating to location of improvements.

I certify that I have read this application and state that all information is correct. I agree to comply with all city and county ordinances and state laws relating to building construction and hereby authorize representative(s) of this city to enter upon the abovementioned property for inspection purposes.

Date 10/3/00 Applicant/Agent Signature N. Collins

WORKER'S COMPENSATION DECLARATION: I hereby affirm under penalty of perjury one of the following declarations:

____ I have and will maintain a certificate of consent to self-insure for workers' compensation as provided for by Section 3700 of the Labor Code, for the performance of work for which the permit is issued.

I have and will maintain workers' compensation insurance, as required by Section 3700 of the Labor Code, for the performance of the work for which this permit is issued. My workers' compensation insurance carrier and policy number are:

Carrier FINANCIAL PACIFIC INS. CO. Policy Number 920137C Exp Date 10/1/2000

____ (This section need not be completed if the permit is for \$100 or less.) I certify that for the performance of the work for which this permit is issued, I shall not employ any person in any manner so as to become subject to the workers' compensation laws of California and agree that if I should become subject to the workers' compensation provisions of Section 3700 of the Labor Code, I shall forthwith comply with those provisions.

Date 10/3/00 Applicant Signature N. Collins

WARNING: FAILURE TO SECURE WORKER'S COMPENSATION COVERAGE IS UNLAWFUL AND SHALL SUBJECT AN EMPLOYER TO CRIMINAL PENALTIES AND CIVIL FINES UP TO ONE HUNDRED THOUSAND DOLLARS (\$100,000) IN ADDITION TO THE COST OF COMPENSATION, DAMAGES AS PROVIDED FOR IN SECTION 3706 OF THE LABOR CODE, INTEREST AND ATTORNEY'S FEE.

THIS PERMIT SHALL EXPIRE BY LIMITATION IF WORK IS NOT COMMENCED WITHIN 180 DAYS.

RESIDENTIAL BUILDING PERMIT APPLICATION

- New Construction
- Addition
- Remodels
- Other

Project Address: 2000 North Bend Drive Assessor Parcel # 225-1370-082

OWNER INFORMATION:

Lot # 62

Legal Property Owner: John MOURIER Construction Phone # (916) 969-2842
 Owner Address: 1830 VERNON STREET #9 City ROSEVILLE State Ca. Zip 95678

CONTRACTOR INFORMATION:

Northgate Park Unit #8 Village #1 B

Contractor: J.M.C. Lic. # 613004 Phone # 969-2842 Fax# 782-8903

PROJECT INFORMATION:

Land Use Zone R14 Occupancy Group R3 Construction Type VN Fed Code 14
 No. of stories: 2 No. of rooms: 11 Street width: _____
 1st Floor Area 1244 2nd Floor Area 1203 Basement _____ Roof Material _____

AREA IN SQUARE FOOT OF:

	EXISTING	NEW
Dwelling/Living	_____	<u>2447</u>
Garage/Storage	_____	<u>565</u>
Decks/Balconies	_____	<u>127</u>
Carports	_____	_____

SCOPE OF WORK:

FOR OFFICE USE ONLY

- Information above complete
- Violation files checked
- Standard setbacks
- County Sewer
- AR Flood Waiver required
- Flood Elevation Certificate Required
- Water Development Infill Area
- Planning Approval
- Design Review Approval
- Special Fee Districts Apply: _____

NEW STRUCTURES & ADDITIONS

◆ THE FOLLOWING MUST BE PROVIDED IN ORDER TO SUBMIT FOR PLAN REVIEW

- 2 COMPLETE PLANS, LEGIBLE & DRAWN TO SCALE
 - 3 SETS IF PROJECT IS IN A DESIGN REVIEW AREA
 - Title 24 Energy Compliance documentation
 - Grading and Erosion Control Questionnaire
 - 11" x 17" copy of floor plan for County Assessor
 - Plan Review Fees
- ◆ Plans to include: site plan, floor plan, elevations, roof/ceiling plan, foundation and structural framing details, and structural calculations for non-conforming structures.

Date: _____

Received by: (staff) _____

ACTIVITY/PERMIT # _____



**INSULATION CONTRACTORS
ASSOCIATION
OF AMERICA**

**INSULATION
CERTIFICATE**

64025

1321 DUKE STREET SUITE 303 • ALEXANDRIA, VA 22314 • (703) 739-0356

THIS IS TO CERTIFY THAT INSULATION HAS BEEN INSTALLED IN CONFORMANCE WITH CURRENT ENERGY REGULATIONS, CALIFORNIA ADMINISTRATIVE CODE, TITLE 24, STATE OF CALIFORNIA, IN THE BUILDING LOCATED AT:

John Mueller LOT # *62* TRACT #

STREET *2000 NORTH BEND Dr* CITY *Serraneno B*

EXTERIOR WALLS

MANUFACTURER _____ THICKNESS/TYPE _____ R-VALUE _____

CEILING

BATTS

MANUFACTURER _____ THICKNESS/TYPE _____ R-VALUE _____

BLOWER TESTED *CT MSW/ IH* MINIMUM THICKNESS *12"* R-VALUE *30*

MANUFACTURER _____ THICKNESS/TYPE _____ R-VALUE _____

FOOTING INSULATION *6/13* NUMBER OF BASS/SEES *11*

SLAB ON GRADE _____ R-VALUE _____

STAIRS _____ R-VALUE _____

_____ R-VALUE _____

_____ R-VALUE _____

_____ R-VALUE _____

_____ R-VALUE _____

_____ R-VALUE _____

_____ R-VALUE _____

DATE: _____

DATE: _____

SIGNATURE

DATE

ARCADIE INSULATION

INSULATION CONTRACTOR CALIFORNIA CONTRACTORS LICENSE #263784

DATE *6-20-01*

John Mueller

John Mueller

Natomas Unified School District

Sports Drive, #1 • Sacramento, CA 95834-1905

Phone 916/641-3300 • Fax 916/928-1629

CERTIFICATION OF COMPLIANCE

SCHOOL DISTRICT DEVELOPMENT FEES

PART I: TO BE COMPLETED BY APPLICANT

Property Owner's Name	J.M.C. Homes	(916) 969-2842
Owner's Address	1830 Veron street, Suite #9, Roseville, Ca. 95678	
Project Address	2000 North Bend Drive	
Parcel Number	225-1370-082	Lot 62
Subdivision Name	Northpointe Park unit #8 Village #1-B	
Number of Units	1	
Print Applicant's Name	Deanna Collins	Applicant's Signature <i>D Collins</i>
Title of Applicant	Operations	
Date	9/29/2000	Telephone Number 991-1200

PART II: TO BE COMPLETED BY BUILDING DEPARTMENT

Plan Identification Number	2447		
Building Type (Check One)	<input checked="" type="checkbox"/> Residential <input type="checkbox"/> Apartment/Condominium <input type="checkbox"/> Commercial/Industrial		
Square Feet of Chargeable Building Area	2447		
Signature	<i>[Signature]</i>		
Title	Asst Insp	Date	10/2/00

PART III: TO BE COMPLETED BY NATOMAS UNIFIED SCHOOL DISTRICT

District Certification Number	01-582		
Fees Collected:			
Residential:	2447	Sq. Ft. X \$ 3.25	= \$ 7,952.75
Apartment/Condominium:		Sq. Ft. X \$	= \$
Commercial/Industrial:		Sq. Ft. X \$	= \$

NOTICE TO APPLICANT: Pursuant to government code section 66020 (d), this will serve to notify you that the 90-day approval period in which you may protest the fees, or other payment identified above, will begin to run on the date in which the building or installation permit for this project is issued, or on which they are paid to the District, or to another public entity authorized to collect them on behalf of the District, whichever is earlier.

Applicant Signature: *D Collins* Date: **9/29/00**

This certification covers only the amount of square footage indicated above. Any additions or corrections to the square footage for this project will require an amendment to the Certificate of Compliance.

As the authorize Natomas Unified School District official, I hereby certify that the requirements of Government Code Section 95995 have been complied with by the above signed applicant.

SIGNATURE: *Alvin Burgess* DATE: **10/2/00**
 TITLE: *Asst Tech*

NORTHPOINTE 8-1

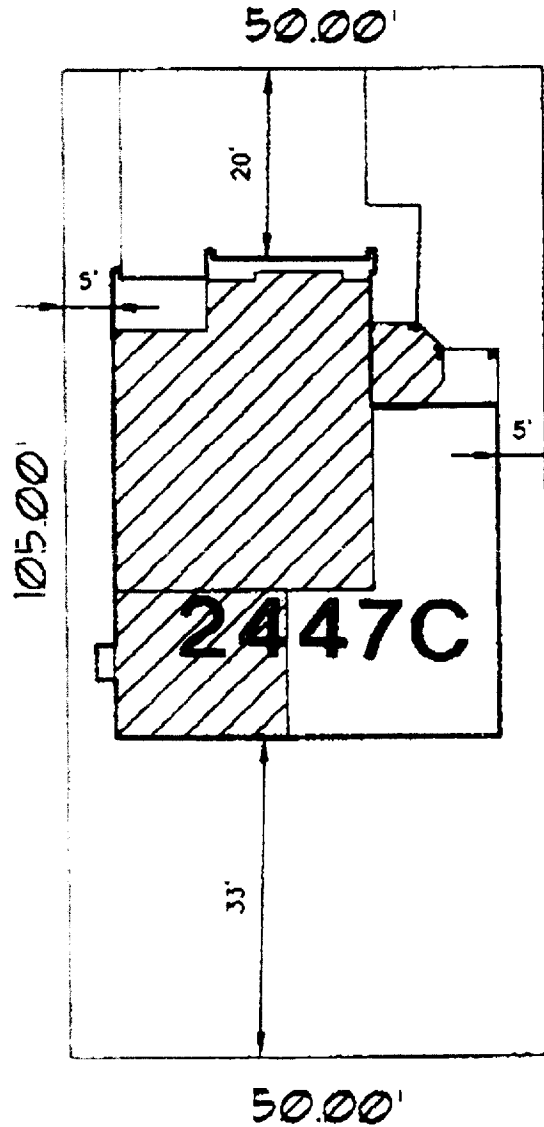

105.00'

50.00'

20'

5'

5'

33'

50.00'

2447C

LOT: 62 SITE ADDRESS: 2000 NORTH BEND DR.

WHEN USED FOR SALES OR CONTRACT PURPOSES THIS DOCUMENT DOES NOT GUARANTEE ANY DIMENSIONS, DISTANCES, BEARINGS OR SETBACKS. JMC RESERVES THE RIGHT TO MAKE CHANGES AT ANY TIME WITHOUT PRIOR NOTICE AND IS NOT RESPONSIBLE FOR IRREGULARITIES OR DIFFERENCES IN ACTUAL OR "AS-BUILT" LOT CHARACTERISTICS.

SCALE: 1"=20'	APN:
LOT SIZE: 5250 v.	1030 VERNON ST. No. 0
	ROOSEVELL, CA 95078
	916-782-8979
	CA 145-4578
NP81-P-62 JM 091400	

