

CITY OF SACRAMENTO

1231 I Street, Sacramento, CA 95814

Permit No: 0417519

Insp Area: 2

Thos Bros: 337-H3

Site Address: 7483 SUN CASTLE LN SAC

Parcel No: SUN MEADOWS LOT #44 Housing (Y/N):

Sub-Type: NSFR

N

CONTRACTOR

NEW FAZE DEVELOPMENT
3187 DEL PASO BLVD.
SACRAMENTO CA. 95815

OWNER

ARCHITECT

Nature of Work: MP 1505 2 STORY 7 ROOM SFR

CONSTRUCTION LENDING AGENCY: I hereby affirm under penalty of perjury that there is a construction lending agency for the performance of the work for which this permit is issued (Sec. 3097, Civ. C).

Lender's Name _____ Lender's Address _____

LICENSED CONTRACTORS DECLARATION: I hereby affirm under penalty of perjury that I am licensed under provisions of Chapter 9 (commencing with section 7000) of Division 3 of the Business and Professions Code and my license is in full force and effect.

License Class B License Number 714601 Date 5/25/05 Contractor Signature [Signature]

OWNER-BUILDER DECLARATION: I hereby affirm under penalty of perjury that I am exempt from the contractors License Law for the following reason (Sec. 7031.5, Business and Professions Code; any city or county which requires a permit to construct, alter, improve, demolish, or repair any structure, prior to its issuance, also requires the applicant for such permit to file a signed statement that he or she is licensed pursuant to the provisions of the Contractors License Law (Chapter 9 (commencing with Section 7000) of Division 8 of the Business and Professions Code) or that he or she is exempt therefrom and the basis for the alleged exemption. Any violation of Section 7031.5 by any applicant for a permit subjects the applicant to a civil penalty of not more than five hundred dollars (\$500.00);

I, as a owner of the property, or my employees with wages as their sole compensation, will do the work, and the structure is not intended or offered for sale (Sec. 7044, Business and Professional Code: The Contractors License Law does not apply to an owner of property who builds or improves thereon, and who does such work himself or herself or through his/her own employees, provided that such improvements are not intended or offered for sale. If, however, the building or improvement is sold within one year of completion, the owner-builder will have the burden of proving that he/she did not build or improve for the purpose of sale.)

I, as owner of the property, am exclusively contracting with licensed contractors to construct the project (Sec. 7044, Business and Professions Code: The Contractors License Law does not apply to an owner of property who builds or improves thereon, and who contracts for such projects with a contractor(s) licensed pursuant to the Contractors License Law).

I am exempt under Sec. _____ B & PC for this reason: _____

Date _____ Owner Signature _____

PAID
CITY OF SACRAMENTO
MAY 25 2005

IN ISSUING THIS BUILDING PERMIT, the applicant represents, and the city relies on the representation of the applicant, that the applicant verified all measurements and locations shown on the application or accompanying drawings and that the improvement to be constructed does not violate any law or private agreement relating to permissible or prohibited locations for such improvements. This building permit does not authorize any illegal location of any improvement or the violation of any private agreement relating to location of improvements.

I certify that I have read this application and state that all information is correct. I agree to comply with all city and county ordinances and state laws relating to building construction and hereby authorize representative(s) of this city to enter upon the abovementioned property for inspection purposes.

Date 5/25/05 Applicant/Agent Signature [Signature]

WORKER'S COMPENSATION DECLARATION: I hereby affirm under penalty of perjury one of the following declarations:

I have and will maintain a certificate of consent to self-insure for workers' compensation as provided for by Section 3700 of the Labor Code, for the performance of work for which the permit is issued.

I have and will maintain workers' compensation insurance, as required by Section 3700 of the Labor Code, for the performance of the work for which this permit is issued. My workers' compensation insurance carrier and policy number are:

Carrier STATE FUND Policy Number 1536963-03 Exp Date 11/01/2004

(This section need not be completed if the permit is for \$100 or less) I certify that in the performance of the work for which this permit is issued, I shall not employ any person in any manner so as to become subject to the workers' compensation laws of California and agree that if I should become subject to the workers' compensation provisions of Section 3700 of the Labor Code, I shall forthwith comply with those provisions.

Date 5/25/05 Applicant Signature [Signature]

WARNING: FAILURE TO SECURE WORKER'S COMPENSATION COVERAGE IS UNLAWFUL AND SHALL SUBJECT AN EMPLOYER TO CRIMINAL PENALTIES AND CIVIL FINES UP TO ONE HUNDRED THOUSAND DOLLARS (\$100,000) IN ADDITION TO THE COST OF COMPENSATION, DAMAGES AS PROVIDED FOR IN SECTION 3706 OF THE LABOR CODE, INTEREST AND ATTORNEY'S FEE.

THIS PERMIT SHALL EXPIRE BY LIMITATION IF WORK IS NOT COMMENCED WITHIN 180 DAYS.



Planning and Building Department
Building Division

CITY OF SACRAMENTO
CALIFORNIA

Downtown Permits Center
1231 I Street, #200
Sacramento, CA 95814-2998
North Permits Center
2101 Arena Blvd., Suite 200
Sacramento, CA 95834

ADDRESS 7483 Sun Castle Ln PERMIT NO. 0417519

INSPECTION COMMENTS	PERMIT DOCUMENTS
10-11-40-42-43-AP-TM-5-26-05	check footings at porch
6-15-05 P12 CN	DK To Pour. Provide Approved Letter for Deletion of Ex-terio Footings by Sheen Inspector
7-6-05 C/N 867	AMS
7-11-05 AP-867-TM	
7-13-05 - P17-AP-TM	HDS at garage wall OK to cover
8-1-05 - P76-AP-TM	
8-16-05 AP/CN	
8-18-05 B 14, 18, 81 AP	JWH
10-04-05 P-47 AP	
12-8-05 F-101 CN	

at slab note 1.2 SHE 54-1

to cover

FINAL APPROVALS	
BUILDING	12-09-05 JWH
ELECTRICAL	
PLUMBING	
MECHANICAL	
FIRE	
SITE	



INSULATION CONTRACTORS ASSOCIATION OF AMERICA

INSULATION CERTIFICATE
45680

1321 DUKE STREET, SUITE 303 • ALEXANDRIA, VA 22314 • (703) 739-0356

THIS IS TO CERTIFY THAT INSULATION HAS BEEN INSTALLED IN CONFORMANCE WITH CURRENT ENERGY REGULATIONS, CALIFORNIA ADMINISTRATIVE CODE, TITLE 24, STATE OF CALIFORNIA, IN THE BUILDING LOCATED AT:

NEW FAZE DEVEZ. LOT # 44 TRACT # SUN MEADOW

STREET 7483 Sun Castle Ln CITY SACRAMENTO

EXTERIOR WALLS:
MANUFACTURER FG THICKNESS/TYPE _____ R-VALUE 13

CEILINGS:
BATTES:
MANUFACTURER FG THICKNESS/TYPE _____ R-VALUE 34

BLOWN IN:
MANUFACTURER CT THICKNESS 1 1/4 R-VALUE 38

SQUARE FOOTAGE COVERED 256 NUMBER OF BAGS USED 18

FLOORS:
MANUFACTURER _____ THICKNESS/TYPE _____ R-VALUE _____

SLAB ON GRADE:
MANUFACTURER _____ THICKNESS/TYPE _____ R-VALUE _____

WIDTH OF INSULATION _____ INCHES

FOUNDATION WALLS:
MANUFACTURER _____ THICKNESS/TYPE _____ R-VALUE _____

GENERAL CONTRACTOR _____
CALIFORNIA CONTRACTORS LICENSE # _____ DATE _____

SIGNATURE TITLE

INSULATION CONTRACTOR **ARCADE INSULATION**
CALIFORNIA CONTRACTORS LICENSE #815286
NEVADA CONTRACTORS LICENSE #55201 DATE 9-23-05

A. Gordon SIGNATURE Installer TITLE

INSTALLATION CARD

WESTERN I-KOTE
Sacramento Shuco Company, Inc.

ICBO Evaluation Service, Inc.
Evaluation Report ER-3699

Date of Job Completion 9/19/05

Job Address

7493 SUN CASTLE LN
SACRAMENTO CA

Plastering Contractor

Name: Rick H. High Plastering, Inc.
PO Box 1391 North Highlands, CA 95660

Address: PO Box 1391 North Highlands, CA 95660
334-3591

Telephone Number: (916) 334-3591 243

Approved contractor number as issued by coating manufacturer: 243

This is to certify that the exterior coating system on the building exterior at the above address has been installed in accordance with the evaluation report specified above and the manufacturer's instructions.

Signature of authorized representative or
Mastering Contractor [Signature] Date 11/15/05

This installation card must be presented to the building inspector after completion of work and before final inspection.

Site Address: **NEW FAZE DEVELOPMENT INC.** Permit Number: **0417519**
7483 SUN CASTLE LN
FENESTRATION/GLAZING: SUN MEADOWS RETIREMENT PLAN 8 S
ALSIDE-ALPINE SACRAMENTO, CA
7000 SERIES WINDOWS

Manufacturer/Brand Name (GROUP LIKE PRODUCTS)	Product U-Factor ¹ (s) CF-1R value ²	Product SHGC ¹ (s) CF-1R value ²	# of Panes	Total Quantity of Like Product (Optional)	Square Feet	Exterior Shading Device or Overhang	Comments/Location/ Special Features
1. _____							LOW-E GLASS
2. SLIDERS	.35	.32	2		103		
3. _____							
4. SINGLE HUNG	.35	.32	2		56		
5. _____							
6. PICTURE WINDOWS	.34	.35	2		8		
7. _____							
8. PATIO DOORS	.35	.34	2		6		
9. _____							
10. _____							
11. _____							
12. _____							
13. _____							
14. _____							
15. _____							

- 1. Manufactured fenestration products use the values from the product label. Field fabricated fenestration products use the default values from Section 116 of the Energy Efficiency Standards.
- 2. Installed U-Factor must be less than or equal to values from CF-1R. Installed SHGC must be less than or equal to values from CF-1R, or a shading device (exterior or overhang) is installed as specified on the CF-1R. Alternatively, installed weighted average U-Factors for the total fenestration area are less than or equal to values from CF-1R.

I, the undersigned, verify that the fenestration/glazing listed above my signature: 1) is the actual fenestration product installed; 2) is equivalent to or has a lower U-Factor and lower SHGC than that specified in the certificate of compliance (Form CF-1R) submitted for compliance with the Energy Efficiency Standards for residential buildings; and 3) the product meets or exceeds the appropriate requirements for manufactured devices (from Part 6), where applicable.

2, 4, 6, 8 10-20-05 Y.T. GLAZING WINDOWS INC.
 Item #s Signature, Date Installing Subcontractor (Co. Name) OR
 (if applicable) General Contractor (Co. Name) OR Owner
 OR Window Distributor

 Item #s Signature, Date Installing Subcontractor (Co. Name) OR
 (if applicable) General Contractor (Co. Name) OR Owner
 OR Window Distributor

 Item #s Signature, Date Installing Subcontractor (Co. Name) OR
 (if applicable) General Contractor (Co. Name) OR Owner
 OR Window Distributor

COPY TO: Building Department
 HERS Provider (if applicable)
 Building Owner at Occupancy

INSTALLATION CERTIFICATE

(page 1 of 4)

CF-6R

New Faze Sun Meadows

All Plans

Site Address
7483 SUN CASTLE LN

Permit Number 0417519

An installation certificate is required to be posted at the building site or made available for all appropriate inspections. (The information provided on this form is required; however, use of this form to provide the information is optional.) After completion of final inspection, a copy must be provided to the building department (upon request) and the building owner at occupancy, per Section 10-103(b).

HVAC SYSTEMS:

ATTN: Christian

Heating Equipment

Equip. Type (pkg. heat pump)	CEC Certified Mfr Name and Model Number	# of Identical Systems	Efficiency (AFUE, etc.) ¹ (≥CF-1R value)	Duct Location (attic, etc.)	Duct or Piping R-value	Heating Load (Btu/hr)	Heating Capacity (Btu/hr)

Cooling Equipment

Equip. Type (pkg. heat pump)	CEC Certified Compressor Unit Mfr Name and Model Number	# of Identical Systems	Efficiency (SEER, etc.) ¹ (≥CF-1R value)	Duct Location (attic, etc.)	Duct R-value	Cooling Load (Btu/hr)	Cooling Capacity (Btu/hr)

1. ≥ reads greater than or equal to.
I, the undersigned, verify that equipment listed above is: 1) is the actual equipment installed, 2) equivalent to or more efficient than that specified in the certificate of compliance (Form CF-1R) submitted for compliance with the Energy Efficiency Standards for residential buildings, and 3) equipment that meets or exceeds the appropriate requirements for manufactured devices (from the Appliance Efficiency Regulations or Part 6), where applicable.

Signature, Date

Installing Subcontractor (Co. Name)
OR General Contractor (Co. Name) OR Owner

WATER HEATING SYSTEMS:

Heater Type	CEC Certified Mfr Name & Model Number	Distribution Type (Std. Point-of-Use)	If Recirculation Central Type	# of Identical Systems	Rated ² Input (kW or Btu/hr)	Tank Volume (gallons)	Eff. ciency ² (EF, RE)	Standby ¹ Loss (%)	External Insulation R-value
Gas	Rheem 42VR40-40F STD	N/A	N/A	1	40,000	40	.62		R-20

1 For small gas storage (rated input of less than or equal to 75,000 Btu/hr), electric resistance and heat pump water heaters, list Energy Factor. For large gas storage water heaters (rated input of greater than 75,000 Btu/hr), list Recovery Efficiency, Standby Loss and Rated Input. For instantaneous gas water heaters, list Recovery Efficiency and Rated Input.

Faucets & Shower Heads:

All faucets and showerheads installed are certified to the Commission, pursuant to Title 24, Part 6, Subchapter 2, Section 111.

I, the undersigned, verify that equipment listed above my signature: 1) is the actual equipment installed, 2) is equivalent to or more efficient than that specified in the certificate of compliance (Form CF-1R) submitted for compliance with the Energy Efficiency Standards for residential buildings; and 3) the equipment meets or exceeds the appropriate requirements for manufactured devices (from the Appliance Efficiency Regulations or Part 6), where applicable.

Signature, Date

J.R. Pierce Plumbing Co.
Installing Subcontractor (Co. Name) OR
General Contractor (Co. Name) OR Owner

COPY TO: Building Department
Building Owner at Occupancy

New Faze: Sun Meadows

Site Address

7483 SUN CASTLE LN

Permit Number

0417519

An installation certificate is required to be posted at the building site or made available for all appropriate inspections. (The information provided on this form is required; however, use of this form to provide the information is optional.) After completion of final inspection a copy must be provided to the building department (upon request) and the building owner at occupancy, per Section 10-103(b).

HVAC SYSTEMS:

Heating Equipment

Equip. Type (pkg. Heat pump)	CEC Certified Mfr name and Model #	# of Identical Systems	(1) Efficiency (AFUE, etc.) > CF-1R value	Duct Location (attic, etc.)	Duct or Piping R-value	Heating Load (Btu/hr)	Heating Capacity (Btu/hr)	
Furnace	York #P4HUA12L04801	1	0.80	Attic	R-4.2	27,994	60,000	Plan 6
Furnace	York #P4HUA12L04801	1	0.80	Attic	R-4.2	20,175	60,000	Plan 7
Furnace	York #P4HUA12L04801	1	0.80	Attic	R-4.2	20,496	60,000	Plan 8

Cooling Equipment

Equip. Type (pkg. Heat pump)	CEC Certified Compressor Unit Mfr Name and Model #	# of Identical Systems	(1) Efficiency (SEER, etc.) > CF-1R value	Duct Location (attic, etc.)	Duct R-value	Cooling Load (Btu/hr)	Cooling Capacity (Btu/hr)	
Condenser	York #H*RA030	1	10.0	Attic	R-4.2	20,166	24,500	Plan 6
Condenser	York #H*RA030	1	10.0	Attic	R-4.2	19,763	24,500	Plan 7
Condenser	York #H*RA030	1	10.0	Attic	R-4.2	18,617	24,500	Plan 8

* = TXV valve installed w/coil

(1) > reads greater than or equal to

I, the undersigned, verify that equipment listed above is: 1) the actual equipment installed; 2) equivalent to or more efficient than that specified in the certificate of compliance (Form CF-1R) submitted for compliance with the Energy Efficiency Standards for residential buildings; and 3) equipment that meets or exceeds the appropriate requirements for manufactured devices (from the Appliance Efficiency Regulations or Part 6), where applicable.

Mark Sadler 0-24-04
Signature, Date

Beutler Corporation

Installing Subcontractor (Co. Name)
OR General Contractor (Co. Name) OR Owner

WATER HEATING SYSTEMS:

Heater Type	CEC Certified Mfr Name & Model #	Distribution Type (Std. point of use)	If Recirculation Control Type	# of Identical Systems	(2) Rated Input (kW or Btu/hr)	Tank Volume (gallons)	(2) Efficiency (EF, RE)	(2) Standby Loss (%)	External Insulation R-value

(2) For small gas storage (rated input of less than or equal to 75,000 Btu/hr), electric resistance and heat pump water heaters, list Energy Factor. For large gas storage water heaters (rated input of greater than 75,000 Btu/hr), list Recovery Efficiency, Standby Loss and Rated Input. For instantaneous gas water heaters, list Recovery efficiency and Rated Input.

(3) R-12 external insulation is mandatory for storage water heaters with an energy factor of less than 0.58.

Facets & Shower Heads:

All facets and showerheads installed are certified to the Commission, pursuant to Title 24, Part 6, Section 111.

I, the undersigned, verify that equipment listed above my signature is: 1) the actual equipment installed; 2) equivalent to or more efficient than that specified in the certificate of compliance (Form CF-1R) submitted for compliance with the Energy Efficiency Standards for residential buildings; and 3) equipment that meets or exceeds the appropriate requirements for manufactured devices (from the Appliance Efficiency Regulations or Part 6), where applicable.

Signature, Date

Installing Subcontractor (Co. Name)
OR General Contractor (Co. Name) OR Owner

COPY TO: Building Department
HERS Provider (if applicable)

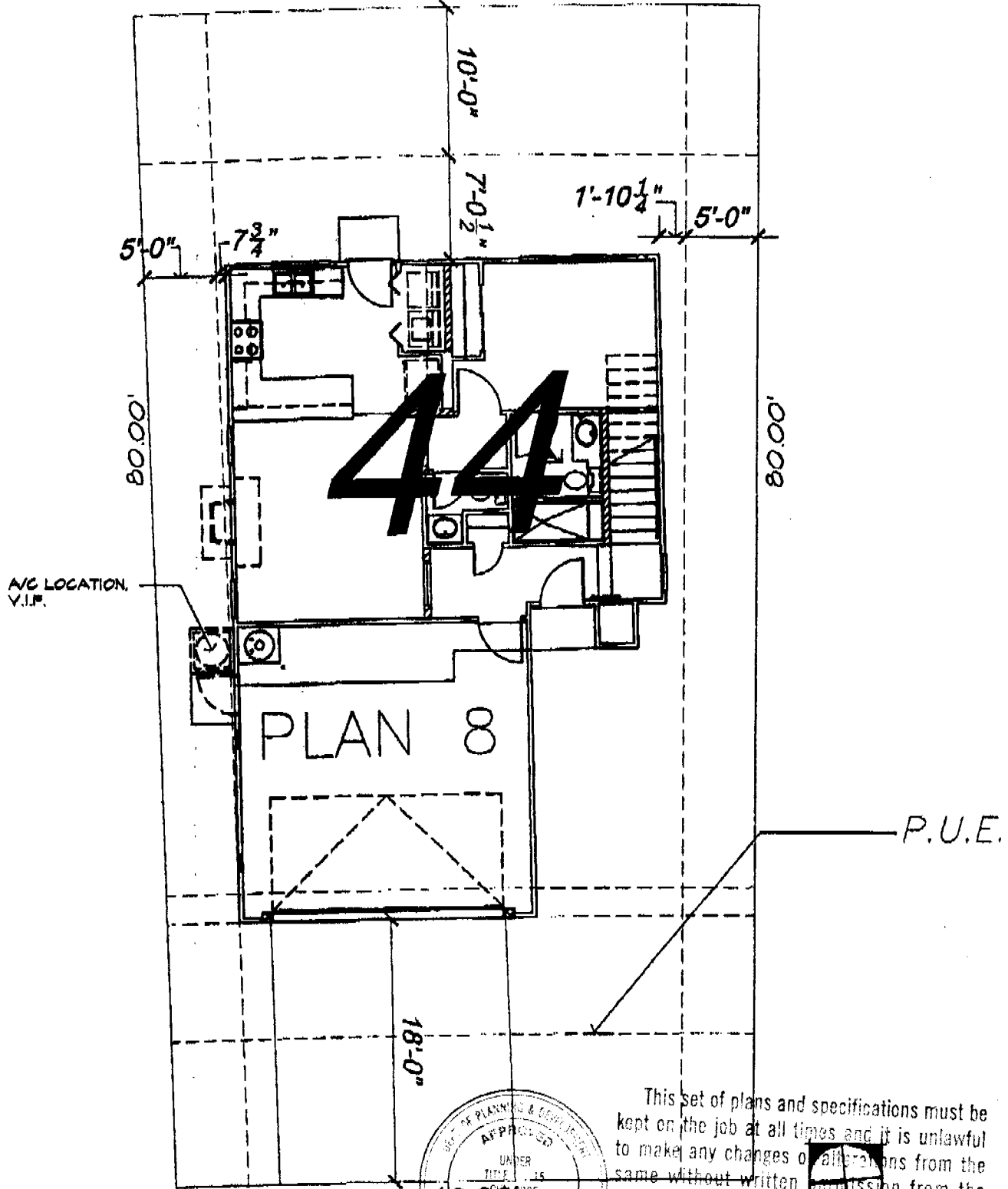

NOTE: THIS DRAWING IS INTENDED TO PROVIDE BUILDING LOCATION ONLY. ALL PROPERTY LINE METS AND BOUNDARIES PROVIDED BY NOLTE BEYOND ENGINEERING

This set of plans and specifications must be kept on the job at all times and it is unlawful to make any changes or alterations from the same without written permission from the Building Inspection Division. The approval of this plan and specification shall not be held to constitute approval of the violation of any City Ordinance or State Law.

HUNT HALE JONES ARCHITECTS 66 FORTY STREET SAN FRANCISCO, CA 94107 PHONE: 415-518-2888 FAX: 415-560-0288 WWW.HUNTHALEJONES.COM	DRAWING DESCRIPTION:				PROJECT DESCRIPTION:
	LOT 44- PLAN 8(L)				
SCALE:	DATE:	SHEET	OF	JOB NO.:	
N.T.S.	10-6-04	17	21	407006	

© 1999 HUNT HALE JONES ARCHITECTS

Z:\407006_Sun_Meadows\Drawings\Project_Drawings\Site_Plans\407006_SP_PLOT PLANS_22-27_34-48.dwg, 10/11/2004 12:32:57 PM, 1