

CITY OF SACRAMENTO  
1231 I Street, Sacramento, CA 95814

Permit No: 0214065  
Insp Area: 4  
Thos Bros:  
Sub-Type: NSFR  
Housing (Y/N):

Site Address: 2686 KALAMER WY SAC  
Parcel No: 201-0530-035  
N

NORTHBOROUGH II VILLAGE 7 LOT 35

**CONTRACTOR**  
KIMBALL HILL HOMES  
10535 EAST STOCKTON BL. STE. K  
ELK GROVE CA. 95624

**OWNER**

**ARCHITECT**

Nature of Work: MP2156 2 STORY 9 ROOM SFR

**CONSTRUCTION LENDING AGENCY :** I hereby affirm under penalty of perjury that there is a construction lending agency for the performance of the work for which this permit is issued (Sec. 3097, Civ. C).

Lender's Name \_\_\_\_\_ Lender's Address \_\_\_\_\_

**LICENSED CONTRACTORS DECLARATION:** I hereby affirm under penalty of perjury that I am licensed under provisions of Chapter 9 (commencing with section 7000) of Division 3 of the Business and Professions Code and my license is in full force and effect.

License Class B License Number 701803 Date 11/25/02 Contractor Signature N. Collins

**OWNER-BUILDER DECLARATION:** I hereby affirm under penalty of perjury that I am exempt from the contractors License Law for the following reason (Sec. 7031.5, Business and Professions Code; any city or county which requires a permit to construct, alter, improve, demolish, or repair any structure, prior to its issuance, also requires the applicant for such permit to file a signed statement that he or she is licensed pursuant to the provisions of the Contractors License Law (Chapter 9 (commencing with Section 7000) of Division 8 of the Business and Professions Code) or that he or she is exempt therefrom and the basis for the alleged exemption. Any violation of Section 7031.5 by any applicant for a permit subjects the applicant to a civil penalty of not more than five hundred dollars (\$500.00);

\_\_\_\_ I, as a owner of the property, or my employees with wages as their sole compensation, will do the work, and the structure is not intended or offered for sale (Sec. 7044, Business and Professional Code: The Contractors License Law does not apply to an owner of property who builds or improves thereon, and who does such work himself or herself or through his/her own employees, provided that such improvements are not intended or offered for sale. If, however, the building or improvement is sold within one year of completion, the owner-builder will have the burden of proving that he/she did not build or improve for the purpose of sale.)

\_\_\_\_ I, as owner of the property, am exclusively contracting with licensed contractors to construct the project (Sec. 7044, Business and Professions Code: The Contractors License Law does not apply to an owner of property who builds or improves thereon, and who contracts for such projects with a contractor(s) licensed pursuant to the Contractors License Law).

\_\_\_\_ I am exempt under Sec. \_\_\_\_\_ B & PC for this reason: \_\_\_\_\_

Date \_\_\_\_\_ Owner Signature \_\_\_\_\_

PAID  
CITY OF SACRAMENTO  
NOV 25 2002

**IN ISSUING THIS BUILDING PERMIT,** the applicant represents, and the city relies on the representation of the applicant that the applicant verified all measurements and locations shown on the application or accompanying drawings and that the improvement to be constructed does not violate any law or private agreement relating to permissible or prohibited locations for such improvements. This building permit does not authorize any illegal location of any improvement or the violation of any private agreement relating to location of improvements.

I certify that I have read this application and state that all information is correct. I agree to comply with all city and county ordinances and state laws relating to building construction and hereby authorize representative(s) of this city to enter upon the abovementioned property for inspection purposes.

Date 11/25/02 Applicant/Agent Signature N. Collins

**WORKER'S COMPENSATION DECLARATION:** I hereby affirm under penalty of perjury one of the following declarations:

\_\_\_\_ I have and will maintain a certificate of consent to self-insure for workers' compensation as provided for by Section 3700 of the Labor Code, for the performance of work for which the permit is issued.

I have and will maintain workers' compensation insurance, as required by Section 3700 of the Labor Code, for the performance of the work for which this permit is issued. My workers' compensation insurance carrier and policy number are:

Carrier AMERICAN SAFETY RRG, INC Policy Number WC347274800 Exp Date 10/01/2002

\_\_\_\_ (This section need not be completed if the permit is for \$100 or less) I certify that in the performance of the work for which this permit is issued, I shall not employ any person in any manner so as to become subject to the workers' compensation laws of California and agree that if I should become subject to the workers' compensation provisions of Section 3700 of the Labor Code, I shall forthwith comply with those provisions.

Date 11/25/02 Applicant Signature N. Collins

WARNING: FAILURE TO SECURE WORKER'S COMPENSATION COVERAGE IS UNLAWFUL AND SHALL SUBJECT AN EMPLOYER TO CRIMINAL PENALTIES AND CIVIL FINES UP TO ONE HUNDRED THOUSAND DOLLARS (\$100,000) IN ADDITION TO THE COST OF COMPENSATION, DAMAGES AS PROVIDED FOR IN SECTION 3706 OF THE LABOR CODE, INTEREST AND ATTORNEY'S FEE.

THIS PERMIT SHALL EXPIRE BY LIMITATION IF WORK IS NOT COMMENCED WITHIN 180 DAYS.

### RESIDENTIAL SUBDIVISION BUILDING PERMIT APPLICATION

Project Address: 2686 Kalamazoo Way Assessor Parcel # 201-0530-035  
Lot Number: 35 Subdivision Northborough II Village 7 Unit #1

#### OWNER INFORMATION:

0214065

Legal Property Owner: Kimball Hill Homes Phone# (916) 714-1153  
Owner Address: 10535 E. Stockton Blvd. #B City EMERYVILLE State Ca. Zip 94624

#### CONTRACTOR INFORMATION:

Contractor: Kimball Hill Homes Lic. # 701803 Phone# 714-1153 Fax 714-1407

#### PROJECT INFORMATION:

Land Use Zone RIA Occupancy Group R3 Construction Type VN Fed Code 1A

No. of Stories: 2 No. of Rooms: 9 Street Width: \_\_\_\_\_

1<sup>st</sup> Floor Area 1086 2<sup>nd</sup> Floor Area 1070 Basement \_\_\_\_\_ Roof Material \_\_\_\_\_

#### AREA IN SQUARE FOOT OF:

Dwelling/Living 2156  
Garage/Storage 418  
Decks/Balconies 135  
Carports \_\_\_\_\_

SCOPE OF WORK: \_\_\_\_\_

- |   |   |   |
|---|---|---|
| <input type="checkbox"/> Information Above Complete | <input type="checkbox"/> AR Flood Waiver Required             | <input type="checkbox"/> Planning Approval            |
| <input type="checkbox"/> Violation Files Checked    | <input type="checkbox"/> Flood Elevation Certificate Required | <input type="checkbox"/> Design Review Approval       |
| <input type="checkbox"/> Standard Setbacks          | <input type="checkbox"/> Water Development Infill Area        | <input type="checkbox"/> Special Fee Districts Apply: |
| <input type="checkbox"/> County Sewer               |   |   |

~THE FOLLOWING MUST BE PROVIDED IN ORDER TO SUBMIT FOR PERMIT~

- 2 COMPLETE PLOT PLANS, LEGIBLE & DRAWN TO SCALE
- 11 X 17 COPY OF FLOOR PLAN WITH FOLLOWING INFORMATION
  - a) Assessor's Parcel Number
  - b) New Floor Area
  - c) Owners Name
  - d) Project Address

FOR OFFICE USE ONLY



**INSULATION CONTRACTORS  
ASSOCIATION  
OF AMERICA**

INSULATION  
CERTIFICATE  
**65998**

1321 DUKE STREET, SUITE 303 • ALEXANDRIA, VA 22314 • (703) 739-0356

THIS IS TO CERTIFY THAT INSULATION HAS BEEN INSTALLED IN CONFORMANCE WITH  
CURRENT ENERGY REGULATIONS, CALIFORNIA ADMINISTRATIVE CODE, TITLE 24, STATE OF  
CALIFORNIA, IN THE BUILDING LOCATED AT

Lot # 36 TRACT # Northwood

STREET 2686 Kelames CITY San Ramon, CA

**EXTERIOR WALLS:**

MANUFACTURER FG THICKNESS/TYPE 5/8" R-VALUE 13

**CEILING:**

BATTS: MANUFACTURER FG THICKNESS/TYPE 1/2" R-VALUE 30

BLOWN IN: MANUFACTURER Insulation MINIMUM THICKNESS 12" R-VALUE 30

SQUARE FOOTAGE COVERED 1336 NUMBER OF BAGS USED 26

FLOORS: MANUFACTURER \_\_\_\_\_ THICKNESS/TYPE \_\_\_\_\_ R-VALUE \_\_\_\_\_

SLAB ON GRADE: MANUFACTURER \_\_\_\_\_ THICKNESS/TYPE \_\_\_\_\_ R-VALUE \_\_\_\_\_

WIDTH OF INSULATION \_\_\_\_\_ INCHES

FOUNDATION WALLS: MANUFACTURER \_\_\_\_\_ THICKNESS/TYPE \_\_\_\_\_ R-VALUE \_\_\_\_\_

GENERAL CONTRACTOR \_\_\_\_\_ DATE \_\_\_\_\_

CALIFORNIA CONTRACTORS LICENSE # \_\_\_\_\_

SIGNATURE \_\_\_\_\_ TITLE \_\_\_\_\_

INSULATION CONTRACTOR **ARCADE INSULATION**

CALIFORNIA CONTRACTORS LICENSE #263784 DATE 5/12/03

SIGNATURE \_\_\_\_\_ TITLE \_\_\_\_\_

# CERTIFICATION OF INSULATION

PART I GENERAL

PART II AREAS INSULATED

PART III CERTIFICATION

ADDRESS OR TRACT <div style="font-size: 1.5em; font-family: cursive;">JTS</div> <div style="font-size: 1.5em; font-family: cursive;">Veranda II</div> <div style="font-size: 1.5em; font-family: cursive;">2468 Krameria</div>	SACRAMENTO BUILDING PRODUCTS <input checked="" type="checkbox"/> P.O. BOX 854, WEST SACRAMENTO, CA 95691 LIC. #202026 <input type="checkbox"/> 1309 MELODY ROAD, MARYSVILLE, CA 95901 LIC. #202026 <input type="checkbox"/> P.O. BOX 9651, FRESNO, CA 93793-9651 LIC. #202026 <input type="checkbox"/> P.O. BOX 1631, RENO, NV 89505 LIC. #10675 <input type="checkbox"/> 3326 A PONDEROSA WAY, LAS VEGAS, NV 89118 LIC. #10675 DATE INSULATION COMPLETED
---	---

WALLS			CEILING			FLOORS		
SQUARE FEET			SQUARE FEET			SQUARE FEET		
TYPE OF INSULATION			TYPE OF INSULATION			TYPE OF INSULATION		
MATERIAL <b>FIBERGLASS</b>			MATERIAL <b>FIBERGLASS</b>			MATERIAL <b>FIBERGLASS</b>		
FORM <b>BATTS</b>			FORM <b>BATTS &amp; BLOW</b>			FORM <b>BATTS</b>		
MANUFACTURER'S PRODUCT I.D.			MANUFACTURER'S PRODUCT I.D.			MANUFACTURER'S PRODUCT I.D.		
MANUFACTURER			MANUFACTURER			MANUFACTURER		
CT	OC	JM	CT	OC	JM	CT	OC	JM
R - VALUE INSTALLED			R - VALUE INSTALLED			R - VALUE INSTALLED		
APPLIED THICKNESS			APPLIED THICKNESS			APPLIED THICKNESS		
MIN. INSTALLED WEIGHT PER SQUARE FOOT			MIN. INSTALLED WEIGHT PER SQUARE FOOT			MIN. INSTALLED WEIGHT PER SQUARE FOOT		
13 / 19			38					
3 1/2 / 5 1/2			12 / 14 3/4					
KNEE WALLS IF R-VALUE IS OTHER THAN WALLS ABOVE								
MATERIAL <b>FIBERGLASS</b>			FORM <b>BATTS</b>			R VALUE		
						MANUFACTURER		
						CT OC JM		
AIR INFILTRATION SEALANT								
MATERIAL <b>Foam</b>						MANUFACTURER		
						<b>HILTI</b>		
						<b>HANDY FOAM</b>		

**THIS IS TO CERTIFY THAT INSULATION AND/OR SEALANT HAS BEEN INSTALLED IN CONFORMANCE WITH APPLICABLE CODES, MATERIAL STANDARDS AND REGULATIONS.**

SIGNATURE — INSULATION CONTRACTOR	TITLE <b>MANAGER</b>	DATE
SIGNATURE — GENERAL CONTRACTOR <div style="font-size: 1.5em; font-family: cursive; text-align: center;">JC</div>	TITLE	DATE <div style="font-size: 1.5em; font-family: cursive; text-align: center;">4/14</div>
REMARKS		

04 # 90

INSTALLATION CARD  
Diamond Wall One Coat System  
Omega Products International, Inc.

Project Address

ICBO Evaluation Service, Inc.  
Report ER-4004

2400 Kramell

Date Completed

Plastering Contractor

I. T. S. White Road Dis.

Name:

11285 White Road

Address:

Telephone No. (916) 635-2800

Approved contractor number assigned by Omega Products Intl, Inc. P.N. # 2227

This is to certify that the exterior coating system on the building exterior at the above address has been installed in accordance with the evaluation report and the manufacturer's instructions.

Ray Beck  
Signature of authorized representative of  
plastering contractor

12-12-01  
Date

This installation card must be presented to the building Inspector after completion of work and

INSTALLATION CARD

OMEGA DIAMOND WALL INSULATING ONE COAT SYSTEM  
OMEGA PRODUCTS INTERNATIONAL, INC.

Job Address:

KIMBALL HILL HOMES  
LOT 735 - 2686 KALAMER  
SACRAMENTO, CA.

ICBO Evaluation Service, Inc.  
Report 4004

4/23/03  
Date of Job Completion

Plastering Contractor:

Name: Mid Valley Plastering, Inc.  
Address: 4807 S. Airport Way, Unit # D  
Stockton, CA 95206-4924  
Telephone: (209) 234-2671

Approved Contractor Number as Issued by the Coating Manufacturer Omega Diamond Wall No. 2315

This is to certify that the exterior system on the building exterior at the above address has been installed in accordance with the evaluation report specified above and the manufacturer's instructions

Jeff Lane  
Signature of Plastering Contractor

4/29/03  
Date

This installation card must be presented to the building inspector after completion of work and before final inspection

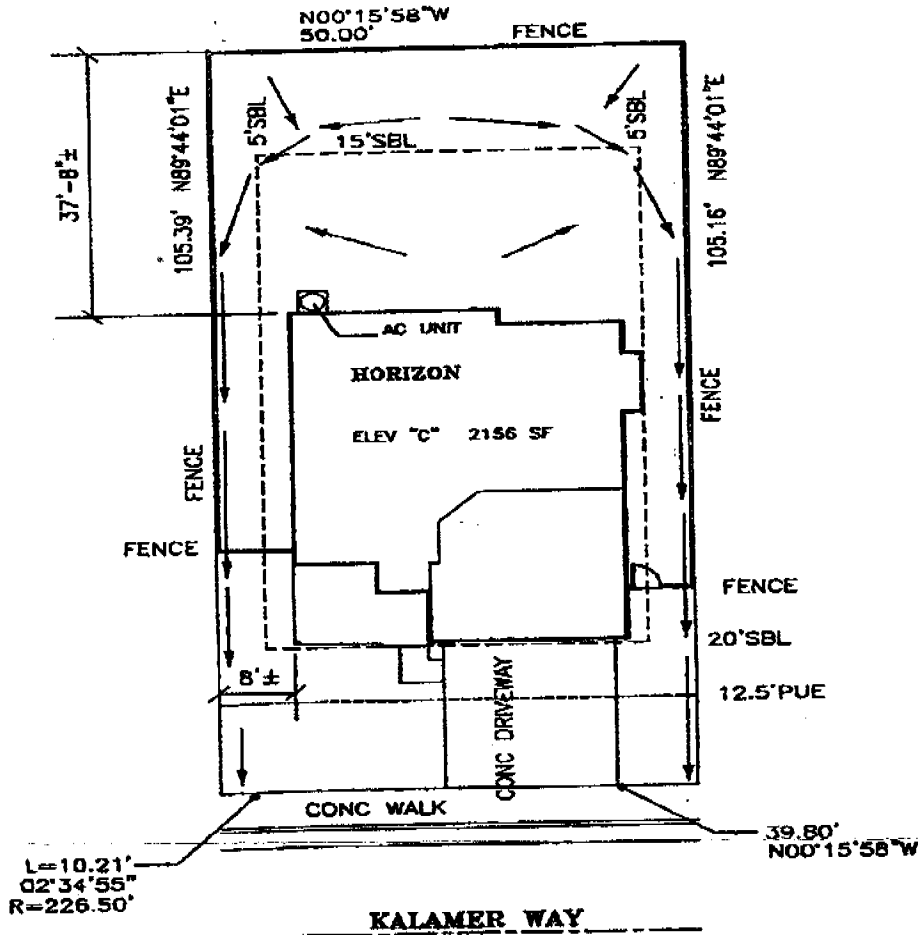

**BLOOM**  
**Architectural**  
**Developments**  
**Incorporated**  
 4437 Kenneth Avenue  
 Fair Oaks, CA 95628  
 (916)961-1553  
 (916)967-3011 Fax

www.bloomarchitect.com

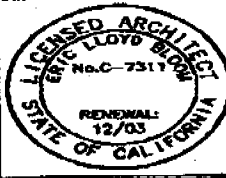

**Plot Plan Disclosure** This plot plan approximates a general representation of lot dimensions, easements, fence and home placement, etc. This illustration is not a condition of Kimball Hill Homes sales agreement. The actual placement and measurements demonstrated on this diagram are subject to change without notice.

Signature \_\_\_\_\_  
**KHH California, Inc.** (916)714-1153  
 10535 E. Stockton Blvd. Ste. K, Elk Grove, CA 95756



**Job#** 2767 35 **Plan#** 2156  
**Date** Aug 01 02 **Draft** 1  
**Plan** HORIZON **Elev** C  
**Project** Northborough Village  
**Lot** 35 **Unit** 7  
**Address** 2686 Kalamer St  
**City** Sacramento County CA  
**APN** -----0000

**PLOT PLAN**  
 Scale 1"=20'

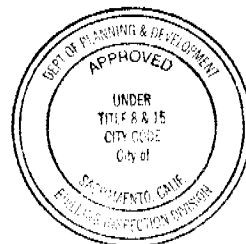

This set of plans and specifications must be kept on the job at all times and it is unlawful to make any changes or alterations from the same without written permission from the Building Inspection Division.

The approval of this plan and specification SHALL NOT be held to permit or approve the violation of any City Ordinance or State Law.