

CITY OF SACRAMENTO

1231 J Street, Sacramento, CA 95814

Permit No: 0013190

Insp Area: 4

Site Address: 34 SAGE GROUSE CT SAC

Parcel No: 225-1240-044

GATEWAY N 2 LOT 79

Sub-Type: NSFR

Housing (Y/N): N

CONTRACTOR

MARCHBROOK BUILDING CO
PO BOX 7576
STOCKTON CA 95267

OWNER

ARCHITECT

Nature of Work: MP 3446 2 STORY 11 ROOM SFR

CONSTRUCTION LENDING AGENCY: I hereby affirm under penalty of perjury that there is a construction lending agency for the performance of the work for which this permit is issued (Sec. 3097, Civ. C).

Lender's Name _____ Lender's Address _____

LICENSED CONTRACTORS DECLARATION: I hereby affirm under penalty of perjury that I am licensed under provisions of Chapter 9 (commencing with section 7000) of Division 3 of the Business and Professions Code and my license is in full force and effect.

License Class B License Number 740353 Date 11/13/00 Contractor Signature Paul DeL...

OWNER-BUILDER DECLARATION: I hereby affirm under penalty of perjury that I am exempt from the contractors License Law for the following reason (Sec. 7031.5, Business and Professions Code; any city or county which requires a permit to construct, alter, improve, demolish, or repair any structure, prior to its issuance, also requires the applicant for such permit to file a signed statement that he or she is licensed pursuant to the provisions of the Contractors License Law (Chapter 9 (commencing with Section 7000) of Division 8 of the Business and Professions Code) or that he or she is exempt therefrom and the basis for the alleged exemption. Any violation of Section 7031.5 by any applicant for a permit subjects the applicant to a civil penalty of not more than five hundred dollars (\$500.00);

I, as a owner of the property, or my employees with wages as their sole compensation, will do the work, and the structure is not intended or offered for sale (Sec. 7044, Business and Professional Code: The Contractors License Law does not apply to an owner of property who builds or improves thereon, and who does such work himself or herself or through his/her own employees, provided that such improvements are not intended or offered for sale. If, however, the building or improvement is sold within one year of completion, the owner-builder will have the burden of proving that he/she did not build or improve for the purpose of sale.)

I, as owner of the property, am exclusively contracting with licensed contractors to construct the project (Sec. 7044, Business and Professions Code: The Contractors License Law does not apply to an owner of property who builds or improves thereon, and who contracts for such projects with a contractor(s) licensed pursuant to the Contractors License Law).

I am exempt under Sec. _____ B & PC for this reason: _____
Date _____ Owner Signature _____

IN ISSUING THIS BUILDING PERMIT, the applicant represents, and the city relies on the representation of the applicant, that the applicant verified all measurements and locations shown on the application or accompanying drawings and that the improvement to be constructed does not violate any law or private agreement relating to permissible or prohibited locations for such improvements. This building permit does not authorize any illegal location of any improvement or the violation of any private agreement relating to location of improvements.

I certify that I have read this application and state that all information is correct. I agree to comply with all city and county ordinances and state laws relating to building construction and hereby authorize representative(s) of this city to enter upon the abovementioned property for inspection purposes.

Date 11/13/00 Applicant/Agent Signature Paul DeL...

WORKER'S COMPENSATION DECLARATION: I hereby affirm under penalty of perjury one of the following declarations:
I have and will maintain a certificate of consent to self-insure for workers' compensation as provided for by Section 3700 of the Labor Code, for the performance of work for which the permit is issued.

I have and will maintain workers' compensation insurance, as required by Section 3700 of the Labor Code, for the performance of the work for which this permit is issued. My workers' compensation insurance carrier and policy number are:

Carrier: SAFECO INSURANCE CO OF AMERICA Policy Number WC2342690D Exp Date 7/1/2001

(This section need not be completed if the permit is for \$100 or less) I certify that in the performance of the work for which this permit is issued, I shall not employ any person in any manner so as to become subject to the workers' compensation laws of California and agree that if I should become subject to the workers' compensation provisions of Section 3700 of the Labor Code, I shall forthwith comply with those provisions.

Date 11/13/00 Applicant Signature Paul DeL...

WARNING: FAILURE TO SECURE WORKER'S COMPENSATION COVERAGE IS UNLAWFUL AND SHALL SUBJECT AN EMPLOYER TO CRIMINAL PENALTIES AND CIVIL FINES UP TO ONE HUNDRED THOUSAND DOLLARS (\$100,000) IN ADDITION TO THE COST OF COMPENSATION, DAMAGES AS PROVIDED FOR IN SECTION 3706 OF THE LABOR CODE, INTEREST AND ATTORNEY'S FEE.

THIS PERMIT SHALL EXPIRE BY LIMITATION IF WORK IS NOT COMMENCED WITHIN 180 DAYS.

RESIDENTIAL BUILDING PERMIT APPLICATION

New Construction Addition Remodels Other

Project Address: 34 Sage Grouse Court Assessor Parcel # 225-1240-044

OWNER INFORMATION: 10179 - MP 3444

Legal Property Owner: Sundance Lake LLC, A Delaware Limited Liability Co. Phone # (209)473-6000
 Owner Address: P.O. Box 7576 City Stockton State CA Zip 95267

CONTRACTOR INFORMATION:

Contractor: Marchbrook Building Co Lic. # 740353 Phone # (209)473-6000 Fax # (209)473-6044

PROJECT INFORMATION:

Land Use Zone _____ Occupancy Group _____ Construction Type _____ Fed Code _____

No. of stories: 2 No. of rooms: 11 Street width: _____

1st Floor Area 1593 2nd Floor Area 1853 Basement _____ Roof Material _____

AREA IN SQUARE FOOT OF:	<u>EXISTING</u>	<u>NEW</u>
Dwelling/Living	<u>3444</u>	_____
Garage/Storage	<u>632</u>	_____
Decks/Balconies	<u>144</u>	_____
Carports	<u>N/A</u>	_____

SCOPE OF WORK: SFD

FOR OFFICE USE ONLY

<input type="checkbox"/> Information above complete	<input type="checkbox"/> AR Flood Waiver required	<input type="checkbox"/> Planning Approval
<input type="checkbox"/> Violation files checked	<input type="checkbox"/> Flood Elevation Certificate Required	<input type="checkbox"/> Design Review Approval
<input type="checkbox"/> Standard setbacks	<input type="checkbox"/> Water Development Infill Area	<input type="checkbox"/> Special Fee Districts Apply : _____
<input type="checkbox"/> County Sewer		

NEW STRUCTURES & ADDITIONS

❖ THE FOLLOWING MUST BE PROVIDED IN ORDER TO SUBMIT FOR PLAN REVIEW

<input type="checkbox"/> 2 COMPLETE PLANS, LEGIBLE & DRAWN TO SCALE	❖ Plans to include: site plan, floor plan, elevations, roof/ceiling plan, foundation and structural framing details, and structural calculations for non-conforming structures.
<input type="checkbox"/> 3 SETS IF PROJECT IS IN A DESIGN REVIEW AREA	

<input type="checkbox"/> Title 24 Energy Compliance documentation	<input type="checkbox"/> 11" x 17" copy of floor plan for County Assessor
<input type="checkbox"/> Grading and Erosion Control Questionnaire	<input type="checkbox"/> Plan Review Fees

Date: _____ Received by: (staff) _____

ACTIVITY/PERMIT #



WesPac

insulation
a MASCO Company

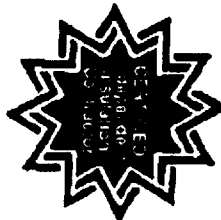

809 North Market Blvd., Ste. 11 • Sacramento, CA 95834
 (916) 927-7149 • Fax (916) 927-4257
 Lic. #487478

Installed Insulation Certificate

We certify that the building insulation listed herein is installed in conformance with current energy conservation regulations, California Administrative Code, Title 24, State of California

R FACTOR	AREA	TYPE	INCHES/BAGS (BLOWN)
R38	CEILING	FIBERGLASS BLOWN	15 1/2 / 59 BAGS
R38	CEILING	FIBERGLASS BATT	13"
R13	EXTERIOR WALLS	FIBERGLASS BATT	2 1/2"

MARKETPLACE BLDG.

Certified by *Shelby Williams*

SUNDANCE LARK

MARCO SUNDANCE LARK
 Address of Lot Number

Title Secretary

Date Installed 05/03/01

Phase #

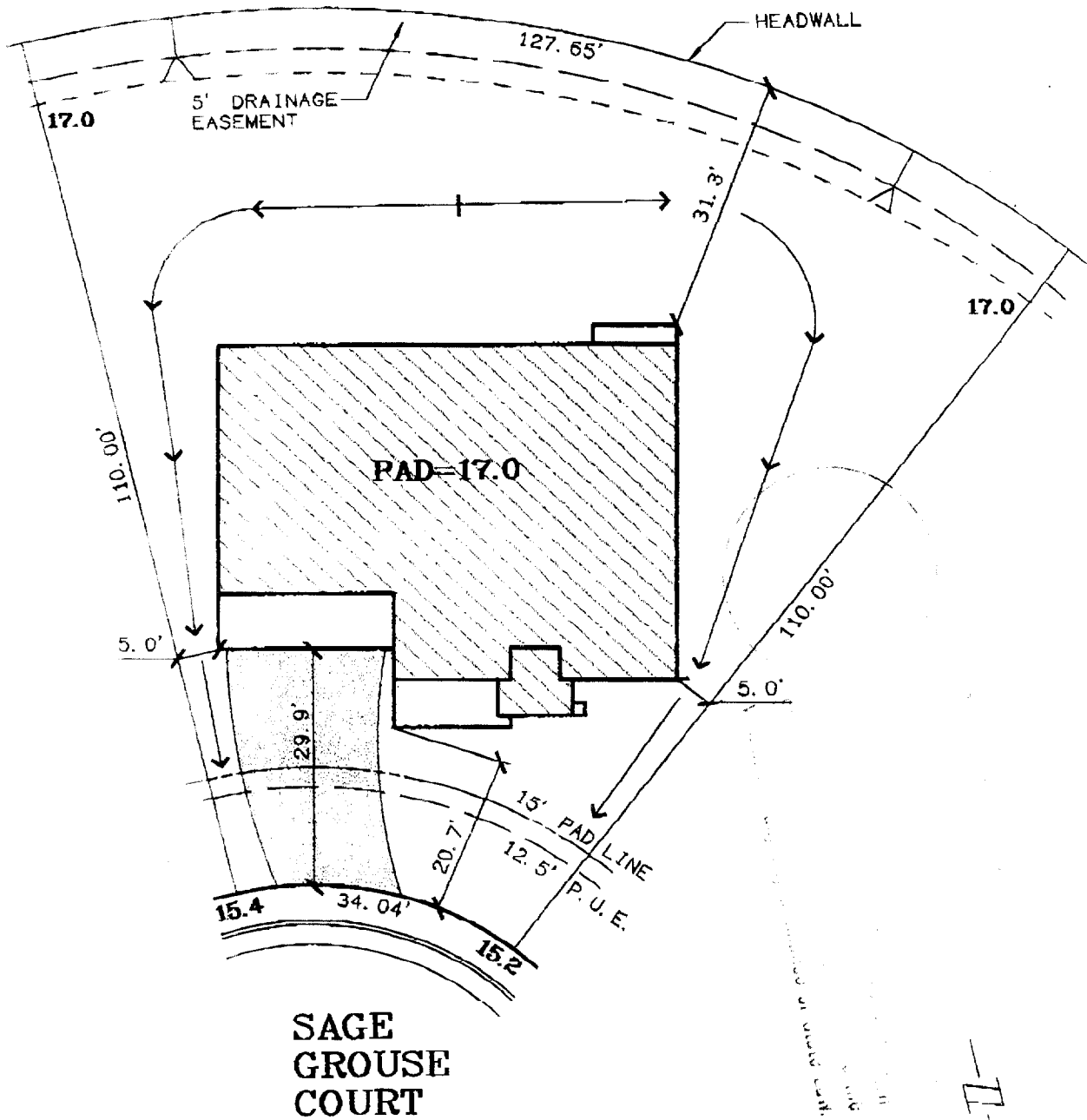

SCALE 1" = 20'

LOT 79
 PLAN 4A LEFT
 A.P.N.:
 ADDRESS: SAGE GROUSE COURT
 LOT AREA: 9,186 SF
 LOT COVERAGE: 26%

<p>The Splink Corporation 2590 VENTURE OAKS WAY SACRAMENTO, CA 95893 PH:(916)925-5550 FAX:(916)921-9274</p>	<p>MARCHBROOK BUILDING COMPANY P.O. Box 7576 Stockton, Ca 95267 office: (209) 473-6053 fax: (209) 951-0884</p>	<p>GATEWAY NORTH VILLAGE 2 City of Sacramento, California Scale: 1"=20' October 23, 2000</p>
---	---	--