

CITY OF SACRAMENTO
1231 I Street, Sacramento, CA 95814

Permit No: 0317629
Insp Area: 4
Thos Bros: 276-H1

Site Address: 301 ALDEBURGH CR SAC Sub-Type: NSFR
Parcel No: 225-1840-026 CAMBAY WEST VIL. 1 LOT 42 Housing (Y/N): N

CONTRACTOR
GRIFFIN INDUSTRIES
24005 VENTURA BL.
CALABASAS CA. 91302

OWNER

ARCHITECT

Nature of Work: MP 3336 2 STORY 11 ROOM SFR

CONSTRUCTION LENDING AGENCY : I hereby affirm under penalty of perjury that there is a construction lending agency for the performance of the work for which this permit is issued (Sec. 3097, Civ. C).

Lender's Name _____ Lender's Address _____

LICENSED CONTRACTORS DECLARATION: I hereby affirm under penalty of perjury that I am licensed under provisions of Chapter 9 (commencing with section 7000) of Division 3 of the Business and Professions Code and my license is in full force and effect.

License Class _____ License Number 684448 Date 11/18/03 Contractor Signature *Jerry Peterson*

OWNER-BUILDER DECLARATION: I hereby affirm under penalty of perjury that I am exempt from the contractor's License Law for the following reason (Sec. 7031.5, Business and Professions Code; any city or county which requires a permit to construct, alter, improve, demolish, or repair any structure, prior to its issuance, also requires the applicant for such permit to file a signed statement that he or she is licensed pursuant to the provisions of the Contractors License Law (Chapter 9 (commencing with Section 7000) of Division 8 of the Business and Professions Code) or that he or she is exempt therefrom and the basis for the alleged exemption. Any violation of Section 7031.5 by any applicant for a permit subjects the applicant to a civil penalty of not more than five hundred dollars (\$500.00);

_____, I, as a owner of the property, or my employees with wages as their sole compensation, will do the work, and the structure is not intended or offered for sale (Sec. 7044, Business and Professional Code: The Contractors License Law does not apply to an owner of property who builds or improves thereon, and who does such work himself or herself or through his/her own employees, provided that such improvements are not intended or offered for sale. If, however, the building or improvement is sold within one year of completion, the owner-builder will have the burden of proving that he/she did not build or improve for the purpose of sale.)

_____, I, as owner of the property, am exclusively contracting with licensed contractors to construct the project (Sec. 7044, Business and Professions Code: The Contractors License Law does not apply to an owner of property who builds or improves thereon, and who contracts for such projects with a contractor(s) licensed pursuant to the Contractors License Law).

_____, I am exempt under Sec. _____ B & PC for this reason: _____

Date _____ Owner Signature _____

IN ISSUING THIS BUILDING PERMIT, the applicant represents, and the city relies on the representation of the applicant, that the applicant verified all measurements and locations shown on the application or accompanying drawings and that the improvement to be constructed does not violate any law or private agreement relating to permissible or prohibited locations for such improvements. This building permit does not authorize any illegal location of any improvement or the violation of any private agreement relating to location of improvements.

I certify that I have read this application and state that all information is correct. I agree to comply with all city and county ordinances and state laws relating to building construction and hereby authorize representative(s) of this city to enter upon the abovementioned property for inspection purposes.

Date 11/18/03 Applicant/Agent Signature *Jerry Peterson*

WORKER'S COMPENSATION DECLARATION: I hereby affirm under penalty of perjury one of the following declarations:

_____, I have and will maintain a certificate of consent to self-insure for workers' compensation as provided for by Section 3700 of the Labor Code, for the performance of work for which the permit is issued.

_____, I have and will maintain workers' compensation insurance, as required by Section 3700 of the Labor Code, for the performance of the work for which this permit is issued. My workers' compensation insurance carrier and policy number are:

Carrier STATE COMP. INS. FUND Policy Number WC 1673452-2003 Exp Date 01/01/2004

_____, (This section need not be completed if the permit is for \$100 or less) I certify that in the performance of the work for which this permit is issued, I shall not employ any person in any manner so as to become subject to the workers' compensation laws of California and agree that if I should become subject to the workers' compensation provisions of Section 3700 of the Labor Code, I shall forthwith comply with those provisions.

Date 11/18/03 Applicant Signature *Jerry Peterson*

WARNING: FAILURE TO SECURE WORKER'S COMPENSATION COVERAGE IS UNLAWFUL AND SHALL SUBJECT AN EMPLOYER TO CRIMINAL PENALTIES AND CIVIL FINES UP TO ONE HUNDRED THOUSAND DOLLARS (\$100,000) IN ADDITION TO THE COST OF COMPENSATION, DAMAGES AS PROVIDED FOR IN SECTION 3706 OF THE LABOR CODE, INTEREST AND ATTORNEY'S FEE.

THIS PERMIT SHALL EXPIRE BY LIMITATION IF WORK IS NOT COMMENCED WITHIN 180 DAYS.

PAID
CITY OF SACRAMENTO
NOV 18 2003
CITY OF SACRAMENTO
PERMIT CENTER

RESIDENTIAL SUBDIVISION BUILDING PERMIT APPLICATION

Project Address: 301 Aldeburgh Circle
Lot Number: 42

Assessor Parcel # 225-0080-049
Subdivision Cambay West/WestParke

OWNER INFORMATION:

Legal Property Owner: Natomas Heritage-1, LLC Phone# (916) 515-0171
Owner Address: 24005 Ventura Blvd. City Calabasas State CA Zip 91302

CONTRACTOR INFORMATION:

Contractor: Griffin Industries, Inc. Lic. # 684448 Phone # (916) 515-0171 Fax (916) 515-0171

PROJECT INFORMATION:

Land Use Zone R1A Occupancy Group R3 Construction Type VN Fed Code 1A
No. of Stories: 2 No. of Rooms: 11 Street Width: 31' not incl. sidewalks
1st Floor Area 1478 2nd Floor Area 1858 Basement N/A Roof Material Tile

AREA IN SQUARE FOOT OF:

Dwelling/Living	<u>3336</u>
Garage/Storage	<u>586</u>
Decks/Balconies	<u>154</u>
Carports	<u>N/A</u>

SCOPE OF WORK: MP 3336, Plan 5C

- | | | |
|---|---|---|
| <input type="checkbox"/> Information Above Complete | <input type="checkbox"/> AR Flood Waiver Required | <input type="checkbox"/> Planning Approval |
| <input type="checkbox"/> Violation Files Checked | <input type="checkbox"/> Flood Elevation Certificate Required | <input type="checkbox"/> Design Review Approval |
| <input type="checkbox"/> Standard Setbacks | <input type="checkbox"/> Water Development Infill Area | <input type="checkbox"/> Special Fee Districts Apply: |
| <input type="checkbox"/> County Sewer | | |

THE FOLLOWING MUST BE PROVIDED IN ORDER TO SUBMIT FOR PERMIT

- 2 COMPLETE PLOT PLANS, LEGIBLE & DRAWN TO SCALE
 11 X 17 COPY OF FLOOR PLAN WITH FOLLOWING INFORMATION
- | | |
|-----------------------------|--------------------|
| a) Assessor's Parcel Number | c) Owners Name |
| b) New Floor Area | d) Project Address |

Insulation Certificate

This is to certify that insulation has been installed in conformance with the current energy regulations, California Administration code. Title 24, State of California, in the building located at:

Site Address: Lot 42 Willow Grove Sacramento CA
Number Street City State

Ceilings:

Blow: Manufacturer Johns Manville Thickness 12" R / Value 30
Square Feet 1743 # Bags / Lbs. Per Bag 32

Batts: Manufacturer Johns Manville Thickness 10.25" R / Value 30
Batts: Manufacturer Johns Manville Thickness R / Value

Exterior Walls:

Manufacturer Johns Manville Thickness 3.5" R / Value 13
Manufacturer Johns Manville Thickness R / Value

Floor Insulation:

Manufacturer Johns Manville Thickness 6.5" R / Value 19

Air Infiltration: (Title 24)

Yes No

Other: _____

General Contractor: Griffin Industries Lic. # _____

By: _____ Title: _____ Date: _____

Insulation Contractor: Gold Star Insulation, Inc. Lic. # 797510

By: Jamie Housley Title: Office Manager Date: 8/11/04

THIS PLOT PLAN IS PROVIDED AS A GENERAL LAYOUT OF THE PROPERTY. ALL INFORMATION ON THIS PLAN INCLUDING: SETBACK DIMENSIONS, DRIVEWAY GRADES, SLOPE AND WALL HEIGHTS AND LOCATIONS, ARE APPROXIMATE AND MAY VARY OR CHANGE WITHOUT PRIOR NOTICE.

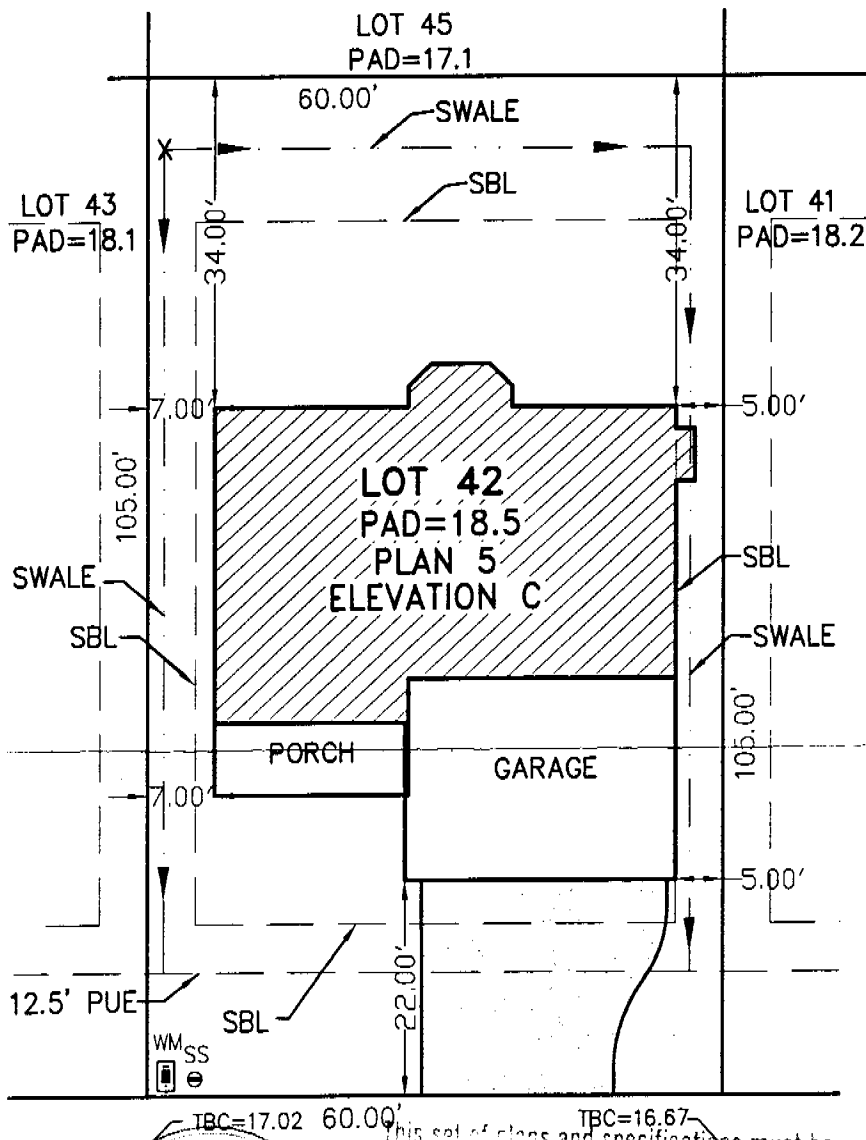

LEGEND

- SBL - SET BACK LINE
- PUE - PUBLIC UTILITY ESMT.
- TBC - TOP BACK OF CURB
- WM - WATER METER
- SS - SANITARY SEWER

ALDEBURGH CIRCLE

This set of plans and specifications must be read in conjunction with the local laws and it is understood that the contractor shall be responsible for obtaining all necessary permits from the appropriate authorities.

<p>GRIFFIN INDUSTRIES 4200 DUCKHORN DR. SACRAMENTO, CA 95834 (916) 515-0171</p>	<p>LOT SIZE = 6300 SF BLDG. FOOTPRINT = 2085 SF FRONT SETBACK = 17.5' LEFT SETBACK = 5' RIGHT SETBACK = 5' REAR SETBACK = 15'</p>	<p>CAMBAY WEST VILLAGE 1 LOT #42 SACRAMENTO CALIFORNIA</p> <p>Carter Burgess Carter & Burgess Inc.</p>
--	---	---

DRAWN BY: JEB	CHECKED BY: RJT	W.O. NO.: 333172	DWG.: 39-44	SCALE: 1"=20'	DATE: 10-31-03
---------------	-----------------	------------------	-------------	---------------	----------------

P:\Projects\333172\10X\zDrawings\LD\Plot Plans\Phases\Phase 3B\V1-Lots 39-44; 12-22.dwg 11-03-03 02:52:11 PM toporrj

INSTALLATION CERTIFICATE

(Part 1 of 13)

CF-6R

SITE ADDRESS Lot # ~~W12301~~ Aldeburgh Circle Sacramento, Ca 95834

PERMIT NUMBER

An installation certificate is required to be posted at the building site or made available for all appropriate inspections. (The information provided on this form is required; however, use of this form to provide the information is optional.) After completion of final inspection, a copy must be provided to the building department (upon request) and the building owner at occupancy, per Section 10-103(b).

HVAC SYSTEMS:

Heating Equipment

Equip. Type (pkg. heat pump)	CEC Certified Mfr Name and Model Number	# of Identical Systems	Efficiency (AFUE, etc.) ¹ [≥CF-1R value]	Duct Location (attic, etc.)	Duct or Piping R-value	Heating Load (Bru/hr)	Heating Capacity (Btu/hr)
SPLIT	G-40UH-48A-90X (UP)		80% Lennox	ATTIC	R-6	23,959	72,100
SPLIT	G-40UH-48A-90X (DN)		80% Lennox	ATTIC	R-6	31,500	72,100

Cooling Equipment

Equip. Type (pkg. heat pump)	CEC Certified Mfr Name and Model Number	# of Identical Systems	Efficiency (AFUE, etc.) ¹ [≥CF-1R value]	Duct Location (attic, etc.)	Duct R-value	Cooling Load (Bru/hr)	Cooling Capacity (Btu/hr)
SPLIT	13ACC042		12 SEER	ATTIC	R-6	27,257	48,000
SPLIT	13ACC042		12 SEER	ATTIC	R-6	26,944	48,000

1. ≥ reads greater than or equal to.

I, the undersigned verify that equipment listed above is: 1) the actual equipment installed, 2) equivalent to or more efficient than that specified in the certificate of compliance (Form CF-1R) submitted for compliance with the Energy Efficiency Standards for residential building, and 3) equipment that meets or exceeds the appropriate requirements for manufactured devices (from the Appliance Efficiency Regulations or Part 6), where applicable.

Signature, Date

Sac Valley Sheet Metal, Inc.

Installing Subcontractor (Co. Name)
OR General Contractor (Co. Name) OR Owner

WATER HEATING SYSTEMS:

Heater Type	CEC Certified Mfr Name & Model Number	Distribution Type (Std, Point-of-Use)	If Recirculation, Control Type	# of Identical Systems	Rated ² Input (kW or Btu/hr)	Tank Volume (gallons)	Efficiency ² (EF, RE)	Standby ² Loss (%)	External Insulation R-value ³

2 For small gas storage (rated input of less than or equal to 75,000 Btu/hr), electric resistance and heat pump water heaters, list Energy Factor. For large gas storage water heaters (rated input of greater than 75,000 Btu/hr), list Recovery Efficiency, Standby Loss and Rated Input. For instantaneous gas water heaters, list Recovery Efficiency and Rated Input.

3 R-12 external insulation is mandatory for storage water heaters with an energy factor of less than 0.58.

Faucets & Shower Heads:

All faucets and showerheads installed are certified to the Commission, pursuant to Title 24, Part 6, Section 111.

I, the undersigned, verify that equipment listed above my signature is: 1) the actual equipment installed; 2) equivalent to or more efficient than that specified in the certificate of compliance (Form CF-1R) submitted for compliance with the Energy Efficiency Standards for residential buildings; and 3) equipment that meets or exceeds the appropriate requirements for manufactured devices (from the Appliance Efficiency Regulations or Part 6), where applicable.

Signature, Date

Installing Subcontractor (Co. Name)
OR General Contractor (Co. Name) OR Owner

COPY TO: Building Department
HERS Provider (if applicable)
Building Owner at Occupancy