

5



CITY OF SACRAMENTO

CITY PLANNING DEPARTMENT

915 J STREET
CITY HALL ROOM 317

SACRAMENTO CALIF 95814
TELEPHONE (916) 449-5674

Marty Van Duyn
Planning Director

March 28, 1980

City Council
Sacramento, California

Honorable Members in Session:

SUBJECT: Ordinance Amending the Districts Established by the Comprehensive Zoning Ordinance No. 2550, Fourth Series, as Amended, by Removing Property Located at the Westerly Terminus of John Still Drive from the R-1 Single Family Residential Zone and Placing Same in the R-1A Townhouse Zone (P-8927) (APN: 052-010-33, 34)

SUMMARY

This item is presented at this time for Council's approval of its publication for legal advertisement purposes. A location map is attached for the Council's information.

BACKGROUND INFORMATION

Prior to publication of an item in a local paper to meet legal advertising requirements, the City Council must first pass the item for publication. The City Clerk then transmits the title of the item to the paper for publication and for advertising the meeting date.

RECOMMENDATION

It is recommended the item be passed for publication.

Respectfully submitted,

Marty Van Duyn
Planning Director

FOR TRANSMITTAL TO CITY COUNCIL:

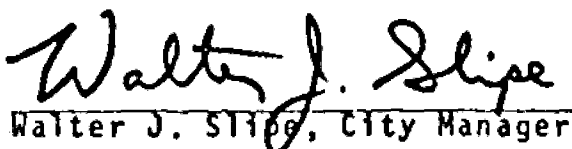

Walter J. Slize, City Manager

APPROVED
BY THE CITY COUNCIL
PPP COM. TO 4-8-80
APR 1 1980

OFFICE OF THE
CITY CLERK

April 1, 1980
District No. 8

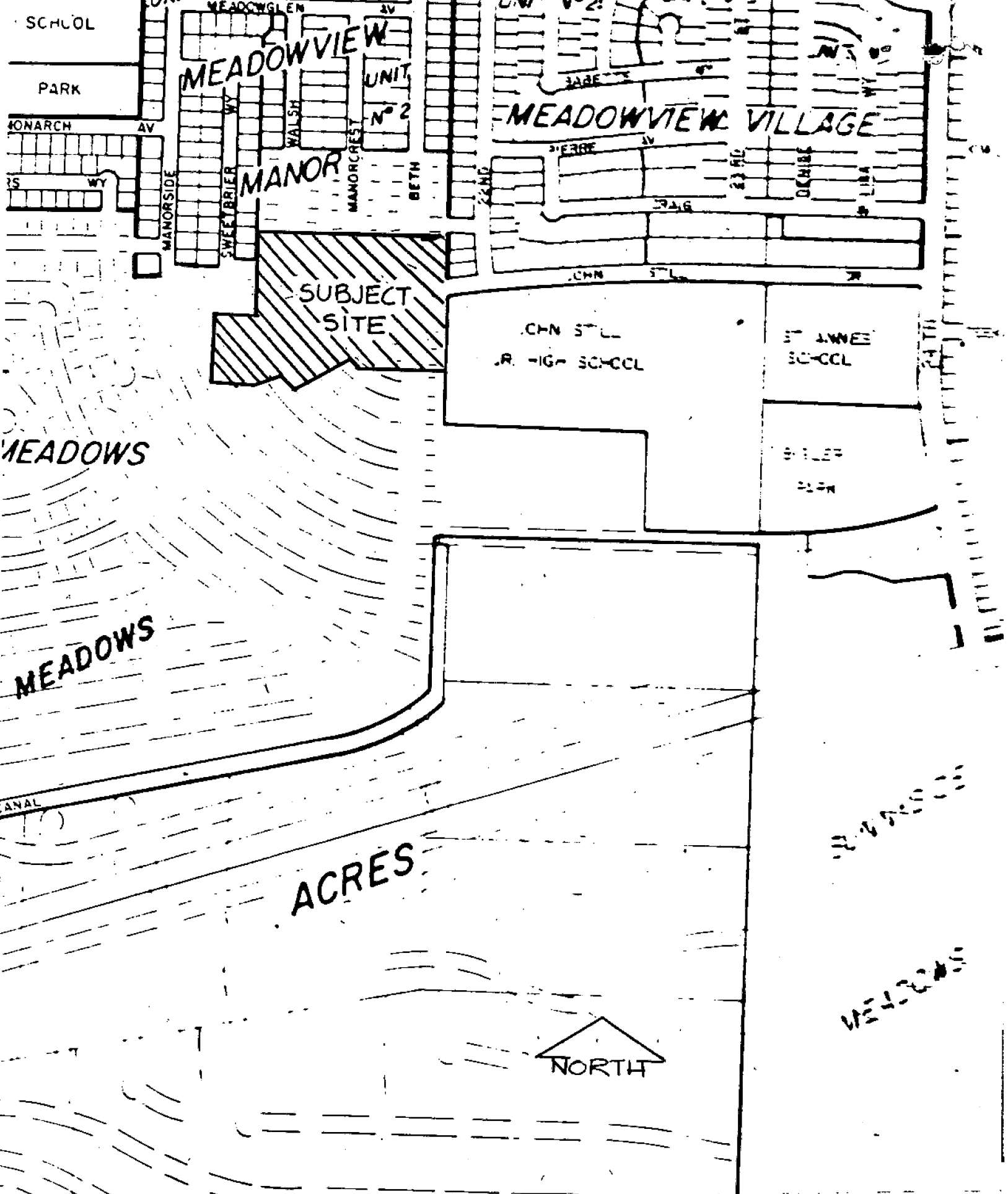
jm
Attachments
P-8927



SCHOOL

PARK

MONARCH AV

MEADOWVIEW UNIT N° 2

MEADOWVIEW VILLAGE

MANOR

SUBJECT SITE

CHN STLL
R. HIGH SCHOOL

ST ANNE'S
SCHOOL

MEADOWS

MEADOWS

ACRES

NORTH

8927

MARCH 13 1980

ITEM NO. 1

1. ORDINANCE NO. , FOURTH SERIES

ORDINANCE AMENDING THE DISTRICTS ESTABLISHED BY THE COMPREHENSIVE ZONING ORDINANCE NO. 2550, FOURTH SERIES, AS AMENDED, BY REMOVING PROPERTY LOCATED AT THE WESTERLY TERMINUS OF JOHN STILL DRIVE FROM THE R-1 SINGLE FAMILY RESIDENTIAL ZONE AND PLACING SAME IN THE R-1A TOWNHOUSE ZONE (File No. P-8927) (APN: 052-010-33, 34)

BE IT ENACTED BY THE COUNCIL OF THE CITY OF SACRAMENTO:

SECTION 1.

The territory described in the attached exhibit(s) which is in the R-1 Single Family Residential zone(s), established by Ordinance No. 2550, Fourth Series, as amended, is hereby removed from said zone(s) and placed in the R-1A Townhouse zone(s).

SECTION 2.

The City Clerk of the City of Sacramento is hereby directed to amend the maps which are a part of said Ordinance No. 2550, Fourth Series, to conform to the provisions of this ordinance.

SECTION 3.

Rezoning of the property described in the attached exhibit(s) by the adoption of this ordinance shall be deemed to be in compliance with the procedures for the rezoning of property prescribed in Ordinance No. 2550, Fourth Series, as said procedures have been affected by recent court decisions.

PASSED FOR PUBLICATION:

PASSED:

EFFECTIVE:

MAYOR

ATTEST:

CITY CLERK