

CITY OF SACRAMENTO
1231 I Street, Sacramento, CA 95814

Permit No: 9907168
Insp Area: 4

Site Address: 1846 ITASCA AV SAC
Parcel No: 225-1070-051

NORTHPOINT PK #2 LOT 51

Sub-Type: NSFR
Housing (Y/N): N

CONTRACTOR
JOHN LAING HOMES
2150 PROFESSIONAL DR. #120
ROSVILLE CA 95661

OWNER

ARCHITECT

Nature of Work: MP 1967 2 STORY 9 ROOM SFR

CONSTRUCTION LENDING AGENCY: I hereby affirm under penalty of perjury that there is a construction lending agency for the performance of the work for which this permit is issued (Sec. 3097, Civ. C).

Lender's Name _____ Lender's Address _____

LICENSED CONTRACTORS DECLARATION: I hereby affirm under penalty of perjury that I am licensed under provisions of Chapter 9 (commencing with section 7000) of Division 3 of the Business and Professions Code and my license is in full force and effect.

License class _____ License Number 22500 Date 7-2-99 Contractor Signature [Signature]

OWNER-BUILDER DECLARATION: I hereby affirm under penalty of perjury that I am exempt from the contractors License Law for the following reason (Sec. 7031.5, Business and Professions Code; any city or county which requires a permit to construct, alter, improve, demolish, or repair any structure, prior to its issuance, also requires the applicant for such permit to file a signed statement that he or she is licensed pursuant to the provisions of the Contractors License Law (Chapter 9 (commencing with Section 7000) of Division 8 of the Business and Professions Code) or that he or she is exempt therefrom and the basis for the alleged exemption. Any violation of Section 7031.5 by any applicant for a permit subjects the applicant to a civil penalty of not more than five hundred dollars (\$500.00):

I, as a owner of the property, or my employees with wages as their sole compensation, will do the work, and the structure is not intended or offered for sale (Sec. 7044, Business and Professions Code). The Contractors License Law does not apply to an owner of property who builds or improves thereon, and who does such work himself or herself or through his/her own employees, provided that such improvements are not intended or offered for sale. If, however, the building or improvement is sold within one year of completion, the owner-builder will have the burden of proving that he/she did not build or improve for the purpose of sale.)

I, as owner of the property, am exclusively contracting with licensed contractors to construct the project (Sec. 7044, Business and Professions Code). The Contractors License Law does not apply to an owner of property who builds or improves thereon, and who contracts for such projects with a contractor(s) licensed pursuant to the Contractors License Law).

I am exempt under Sec. _____ B & PC for this reason: _____

Date _____ Owner Signature _____

IN ISSUING THIS BUILDING PERMIT, the applicant represents, and the city relies on the representation of the applicant, that the applicant verified all measurements and locations shown on the application or accompanying drawings and that the improvement to be constructed does not violate any law or private agreement relating to permissible or prohibited locations for such improvements. This building permit does not authorize any illegal location of any improvement or the violation of any private agreement relating to location of improvements.

I certify that I have read this application and state that all information is correct. I agree to comply with all city and county ordinances and state laws relating to building construction and hereby authorize representative(s) of this city to enter upon the above-mentioned property for inspection purposes.

Date 7-2-99 Applicant/Agent Signature [Signature]

WORKER'S COMPENSATION DECLARATION: I hereby affirm under penalty of perjury one of the following declarations:

I have and will maintain a certificate of consent to self-insure for workers' compensation as provided for by Section 3700 of the Labor Code, for the performance of work for which the permit is issued.

I have and will maintain workers' compensation insurance, as required by Section 3700 of the Labor Code, for the performance of the work for which this permit is issued. My workers' compensation insurance carrier and policy number are:

Carrier RELIANCE NAT INS CO Policy Number QN8631239 Exp Date 12/31/1999

(This section need not be completed if the permit is for \$100 or less) I certify that in the performance of the work for which this permit is issued, I shall not employ any person in any manner so as to become subject to the workers' compensation laws of California and agree that if I should become subject to the workers' compensation provisions of Section 3700 of the Labor Code, I shall forthwith comply with those provisions.

Date _____ Applicant Signature [Signature]

WARNING: FAILURE TO SECURE WORKER'S COMPENSATION COVERAGE IS UNLAWFUL AND SHALL SUBJECT AN EMPLOYER TO CRIMINAL PENALTIES AND CIVIL FINES UP TO ONE HUNDRED THOUSAND DOLLARS (\$100,000) IN ADDITION TO THE COST OF COMPENSATION, DAMAGES AS PROVIDED FOR IN SECTION 3706 OF THE LABOR CODE, INTEREST AND ATTORNEY'S FEE.

THIS PERMIT SHALL EXPIRE BY LIMITATION IF WORK IS NOT COMMENCED WITHIN 180 DAYS.

RESIDENTIAL BUILDING PERMIT APPLICATION

New Construction
 Addition
 Remodels
 Other

Project Address: 1846 ITASCA AVENUE Assessor Parcel # 225-107-051

OWNER INFORMATION:

Legal Property Owner: JOHN LAING HOMES Phone # 916-780-1222
 Owner Address: 2150 PROFESSIONAL DR#120 City ROSEVILLE State CA Zip 95661

CONTRACTOR INFORMATION:

Contractor: JOHN LAING HOMES Lic. # 687596 Phone # 780-1222 Fax# 780-1333

PROJECT INFORMATION:

Land Use Zone _____ Occupancy Group _____ Construction Type _____ Fed Code _____
 No. of stories: 2 No. of rooms: 4 Street width: _____
 1st Floor Area 438 2nd Floor Area 1629 Basement _____ Roof Material Tile

AREA IN SQUARE FOOT OF:	EXISTING	NEW
Dwelling/Living	_____	<u>1947</u>
Garage/Storage	_____	<u>624</u>
Decks/Balconies	_____	_____
Carpports	_____	_____

SCOPE OF WORK: NEW SINGLE FAMILY DWELLING

FOR OFFICE USE ONLY:

- | | | |
|---|---|--|
| <input type="checkbox"/> Information above complete | <input type="checkbox"/> AR Flood Waiver required | <input type="checkbox"/> Planning Approval |
| <input type="checkbox"/> Violation files checked | <input type="checkbox"/> Flood Elevation Certificate Required | <input type="checkbox"/> Design Review Approval |
| <input type="checkbox"/> Standard setbacks | <input type="checkbox"/> Water Development Infill Area | <input type="checkbox"/> Special Fee Districts Apply : _____ |
| <input type="checkbox"/> County Sewer | _____ | |

NEW STRUCTURES & ADDITIONS

❖ THE FOLLOWING MUST BE PROVIDED IN ORDER TO SUBMIT FOR PLAN REVIEW

- | | |
|--|--|
| <input type="checkbox"/> 2 COMPLETE PLANS, LEGIBLE & DRAWN TO SCALE
<input type="checkbox"/> 3 SETS IF PROJECT IS IN A DESIGN REVIEW AREA | ❖ <i>Plans to include: site plan, floor plan, elevations, roof/ceiling plan, foundation and structural framing details, and structural calculations for non-conforming structures.</i> |
| <input type="checkbox"/> Title 24 Energy Compliance documentation
<input type="checkbox"/> Grading and Erosion Control Questionnaire | <input type="checkbox"/> 11" x 17" copy of floor plan for County Assessor
<input type="checkbox"/> Plan Review Fees |

Date: _____ Received by: (staff) _____

ACTIVITY/PERMIT #

COUNTY SANITATION DISTRICT NO. 1
 SACRAMENTO REGIONAL COUNTY SANITATION DISTRICT
SEWER IMPACT FEE *gmt*
 PERMIT AND CALCULATION SHEET

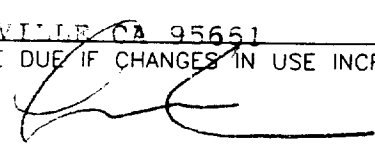
APPLICATION NO:		BLDG PERMIT NO: <i>City</i>	
GENERAL INFORMATION		THIS PERMIT GOOD ONLY WHEN - DEPT 26 VALIDATED BY <i>THE CASHIER</i> - <i>TR</i> TRAN 393446 07/15/99 - RECEIPT 709399 C#2 \$2,554.00 <i>252778</i> <i>7/15/99</i> THIS PERMIT TO CONNECT EXPIRES ONE YEAR FROM DATE OF ISSUANCE	
FEE CALCULATION		BUILDING USE	
INSPECTION	<i>0</i>	RESIDENTIAL SF <input type="checkbox"/>	MF <input type="checkbox"/>
CSD-1	<i>169</i>	COMMERCIAL USE	UNITS
SRCSD	<i>2385</i>		
CONSTRUCTION			
IN-LIEU			
TOTAL FEE	<i>2554</i>		
APN: 225-107-051			
DESCRIPTION/ SUBDIVISION NORTHPOINTE PARK UNIT#2 LOT: 51			
PROPERTY ADDRESS 1845 ITASCA AVENUE			
OWNER JOHN LAING HOMES			
MAILING ADDRESS 2150 PROFESSIONAL DR #120			
CITY-STATE-ZIP ROSEVILLE CA 95661 PHONE 916-780-1222			
ADDITIONAL FEES MAY BE DUE IF CHANGES IN USE INCREASE SEWER IMPACT.			
 APPLICANT SIGNATURE			
CONSOLIDATED UTILITY BILLING USE ONLY			
ACCT _____ INPUT _____ START _____			
INSPECTOR'S COPY			

2 SUB DIAPHRAGM @ FRONT OF HOUSE

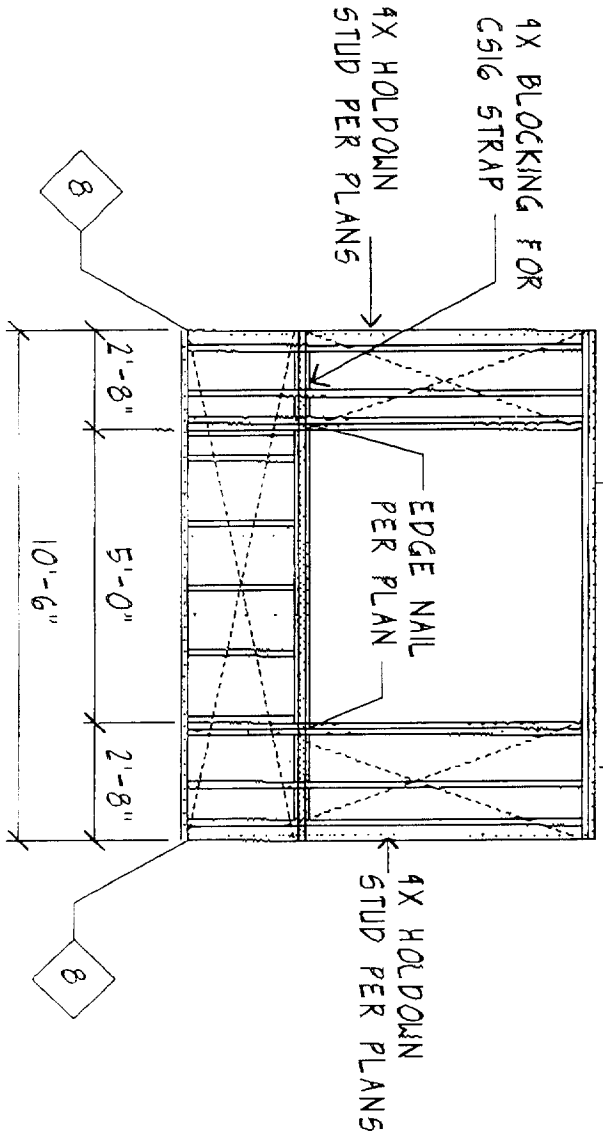

NAIL MIN. (29)16d IN LAP WHERE OCCURS.
SEE SHEAR WALL TABLE TYP. 2

STRUCTURAL DRAG TRUSS



P 5
WALL L

PLAN 4 " "
99135
10/4/99

This set of plans and specifications must be kept on the job at all times and it shall be the responsibility of the contractor to make any changes or additions to the same without written permission from the Building Inspection Division.
 The approval of this plan and specification SHALL NOT be held to permit or approve the violation of any City Ordinance or State Law.

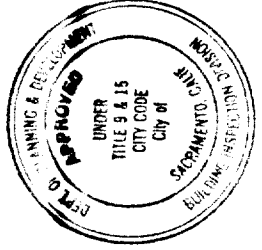

50
 P=13.7

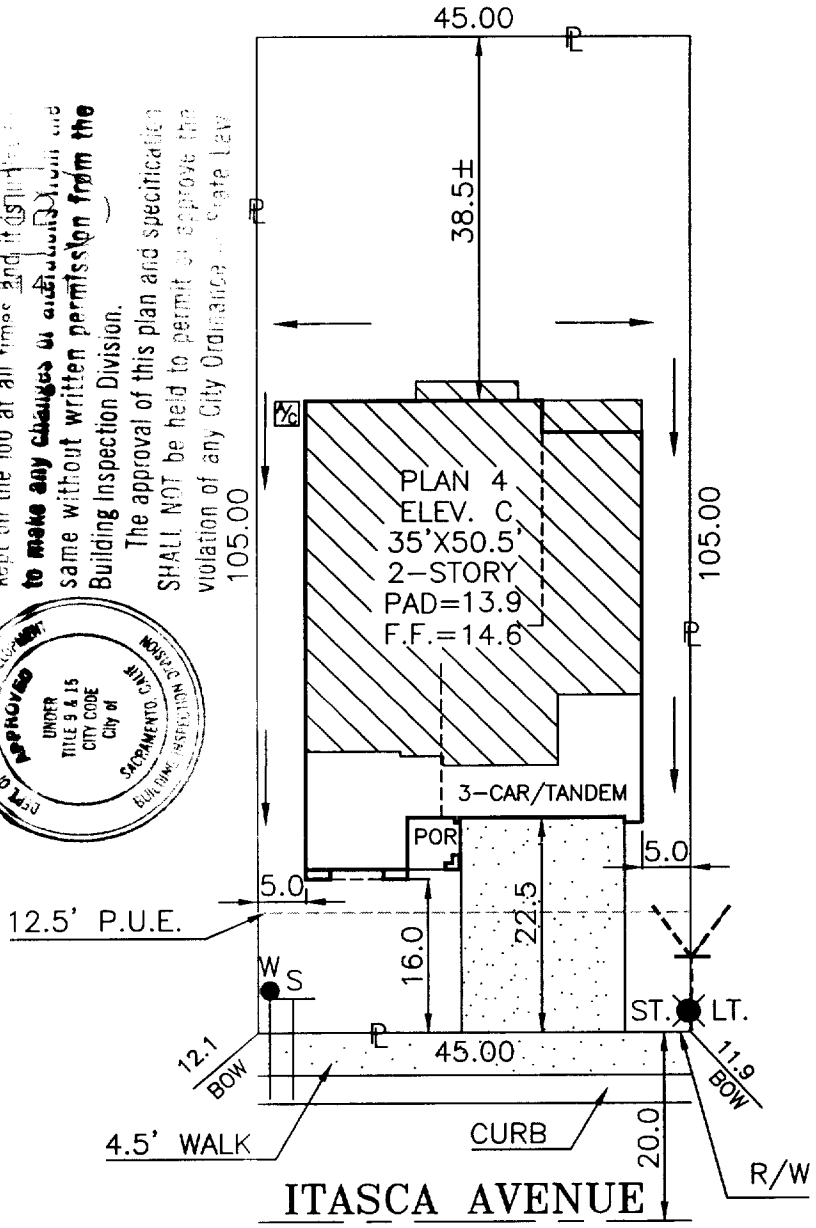

ISSUED

JUL 13 1999

CITY OF SACRAMENTO
 DEVELOPMENT SERVICES DIV.

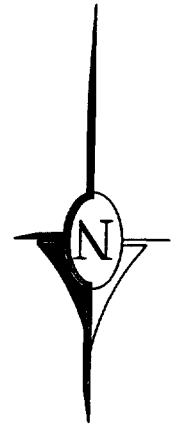

DIMENSIONS SHOWN ARE APPROXIMATE EXCEPT FOR MINIMUMS REQUIRED BY ORDINANCE. THIS PLOT DOES NOT REFLECT AS BUILT CONDITIONS AND MAY VARY FROM THIS PLAN.

John Laing Homes 2150 PROFESSIONAL DRIVE SUITE 120 ROSEVILLE, CALIFORNIA 95661 (TEL.) 916-780-1222 (FAX.) 916-780-1333		INSPIRATION		PLOT PLAN
		NORTHPOINTE PARK UNIT 2 CITY OF SACRAMENTO CALIFORNIA		
ADDRESS: 1846 ITASCA AVENUE		LOT COV: 33.7 %	APN: 225-107-051	LOT 51
PLAN NO.: 4-C	LOT SQ. FT.: 4,725	REAR YARD COVERAGE: %		
DRAWN BY: R.P.	APPROVED BY:	DATE:	SCALE: 1"=20'	