

CITY OF SACRAMENTO
1231 I Street, Sacramento, CA 95814

Permit No: 0101238
Insp Area: 4

Site Address: 1971 KANE AV SAC
Parcel No: 225-1490-055
N

NORTHPOINTE PARK VIL. 10 LOT 55

Sub-Type: NSFR
Housing (Y/N):

CONTRACTOR
WILLIAM LYON HOMES
9216 KIEFER BL.
SAC CA 95827

OWNER

ARCHITECT

Nature of Work: MP 2811 2 STORY 10 ROOM SFR

CONSTRUCTION LENDING AGENCY: I hereby affirm under penalty of perjury that there is a construction lending agency for the performance of the work for which this permit is issued (Sec. 3097, Civ. C).

Lender's Name _____ Lender's Address _____

LICENSED CONTRACTORS DECLARATION: I hereby affirm under penalty of perjury that I am licensed under provisions of Chapter 9 commencing with section 7000) of Division 3 of the Business and Professions Code and my license is in full force and effect.

License Class B License Number 527293 Date 2-13-01 Contractor Signature [Signature]

OWNER-BUILDER DECLARATION: I hereby affirm under penalty of perjury that I am exempt from the contractors License Law for the following reason (Sec. 7031.5, Business and Professions Code, any city or county which requires a permit to construct, alter, improve, demolish, or repair any structure, prior to its issuance, also requires the applicant for such permit to file a signed statement that he or she is licensed pursuant to the provisions of the Contractors License Law (Chapter 9 (commencing with Section 7000) of Division 8 of the Business and Professions Code) or that he or she is exempt therefrom and the basis for the alleged exemption. Any violation of Section 7031.5 by any applicant for a permit subjects the applicant to a civil penalty of not more than five hundred dollars (\$500.00).

I, as a owner of the property, or my employees with wages as their sole compensation, will do the work, and the structure is not intended or offered for sale (Sec. 7044, Business and Professional Code. The Contractors License Law does not apply to an owner of property who builds or improves thereon, and who does such work himself or herself or through his/her own employees, provided that such improvements are not intended or offered for sale. If, however, the building or improvement is sold within one year of completion, the owner-builder will have the burden of proving that he/she did not build or improve for the purpose of sale.)

I, as owner of the property, am exclusively contracting with licensed contractors to construct the project (Sec. 7044, Business and Professions Code. The Contractors License Law does not apply to an owner of property who builds or improves thereon, and who contracts for such projects with a contractor(s) licensed pursuant to the Contractors License Law)

I am exempt under Sec. _____ B & PC for this reason: _____

Date _____ Owner Signature _____

IN ISSUING THIS BUILDING PERMIT, the applicant represents, and the city relies on the representation of the applicant, that the applicant verified all measurements and locations shown on the application or accompanying drawings and that the improvement to be constructed does not violate any law or private agreement relating to permissible or prohibited locations for such improvements. This building permit does not authorize any illegal location of any improvement or the violation of any private agreement relating to location of improvements.

I certify that I have read this application and state that all information is correct. I agree to comply with all city and county ordinances and state laws relating to building construction and hereby authorize representative(s) of this city to enter upon the abovementioned property for inspection purposes.

Date 2-13-01 Applicant/Agent Signature [Signature]

WORKER'S COMPENSATION DECLARATION: I hereby affirm under penalty of perjury one of the following declarations:

I have and will maintain a certificate of consent to self-insure for workers' compensation as provided for by Section 3700 of the Labor Code, for the performance of work for which the permit is issued

I have and will maintain workers' compensation insurance, as required by Section 3700 of the Labor Code, for the performance of the work for which this permit is issued. My workers' compensation insurance carrier and policy number are:

Carrier EAGLE PACIFIC Policy Number 4S0000285 Exp Date 07/01/2001

(This section need not be completed if the permit is for \$100 or less) I certify that in the performance of the work for which this permit is issued, I shall not employ any person in any manner so as to become subject to the workers' compensation laws of California and agree that if I should become subject to the workers' compensation provisions of Section 3700 of the Labor Code, I shall forthwith comply with those provisions.

Date 2-13-01 Applicant Signature [Signature]

WARNING: FAILURE TO SECURE WORKER'S COMPENSATION COVERAGE IS UNLAWFUL AND SHALL SUBJECT AN EMPLOYER TO CRIMINAL PENALTIES AND CIVIL FINES UP TO ONE HUNDRED THOUSAND DOLLARS (\$100,000) IN ADDITION TO THE COST OF COMPENSATION, DAMAGES AS PROVIDED FOR IN SECTION 3706 OF THE LABOR CODE, INTEREST AND ATTORNEY'S FEE.

THIS PERMIT SHALL EXPIRE BY LIMITATION IF WORK IS NOT COMMENCED WITHIN 180 DAYS.

CERTIFICATION OF INSULATION

WM LYONS

LOT # 55

- P.O. BOX 954, WEST SACRAMENTO, CA 95691 LIC. #202026
- 1309 MELODY ROAD, MARYSVILLE, CA 95901 LIC. #202026
- P.O. BOX 9651, FRESNO, CA 93793-9651 LIC. #202026
- P.O. BOX 1631, RENO, NV 89505 LIC. #10675
- 3326 A PONDEROSA WAY, LAS VEGAS, NV 89118 LIC. #10675

PALAZZO

DATE INSULATION COMPLETED
5/16/01

(SQUARE FEET)	(SQUARE FEET)	(SQUARE FEET)
MATERIAL FIBERGLASS	MATERIAL FIBERGLASS	MATERIAL FIBERGLASS
FORM BATTS	FORM BATTS & BLOW	FORM BATTS
MANUFACTURER'S PRODUCT I.D.	MANUFACTURER'S PRODUCT I.D.	MANUFACTURER'S PRODUCT I.D.
MANUFACTURER OCF	BAGS OCF	OCF

13	3 5/8"	30 30	9" 12"			
----	--------	----------	-----------	--	--	--

MATERIAL FIBERGLASS	FORM BATTS	R VALUE	MANUFACTURER OCF
-------------------------------	----------------------	---------	----------------------------

MATERIAL FOAM	MANUFACTURER W R GRACE
-------------------------	----------------------------------

SIGNATURE—INSULATION CONTRACTOR <i>[Signature]</i>	TITLE MANAGER	DATE 7-25-01
SIGNATURE—GENERAL CONTRACTOR	TITLE	DATE

REMARKS

RESIDENTIAL SUBDIVISION BUILDING PERMIT APPLICATION

Project Address: 1971 Kane Avenue Assessor Parcel # 225-1490-055-0000
Lot Number: 55 Subdivision Lyon Palazzo

0101238

OWNER INFORMATION:

Legal Property Owner: William Lyon Homes, Inc. Phone# (925) 543-5500
Owner Address: 2603 Camino Ramon #150 City San Ramon State CA Zip 94583

CONTRACTOR INFORMATION:

Contractor: William Lyon Homes Inc Lic. # 661158 Phone # (925) 543-5500 Fax 543-5501

PROJECT INFORMATION:

Land Use Zone R1A Occupancy Group R3 Construction Type VN Fed Code 1A
No. of Stories: 2 No. of Rooms: 13 Street Width: 40'
1st Floor Area 1,450 2nd Floor Area 1,361 Basement 0 Roof Material Conc. Tile

AREA IN SQUARE FOOT OF:

Dwelling/Living	<u>2,811</u>
Garage/Storage	<u>659</u>
Decks/Balconies	<u>0</u>
Carports	<u>0</u>

SCOPE OF WORK: Construction of a Single Family Dwelling

FOR OFFICE USE ONLY

- Information Above Complete
- Violation Files Checked
- Standard Setbacks
- County Sewer
- AR Flood Waiver Required
- Flood Elevation Certificate Required
- Water Development Infill Area
- Planning Approval
- Design Review Approval
- Special Fee Districts Apply:

THE FOLLOWING MUST BE PROVIDED IN ORDER TO SUBMIT FOR PERMIT

- 2 COMPLETE PLOT PLANS, LEGIBLE & DRAWN TO SCALE
- 11 X 17 COPY OF FLOOR PLAN WITH FOLLOWING INFORMATION
 - a) Assessor's Parcel Number
 - b) New Floor Area
 - c) Owners Name
 - d) Project Address

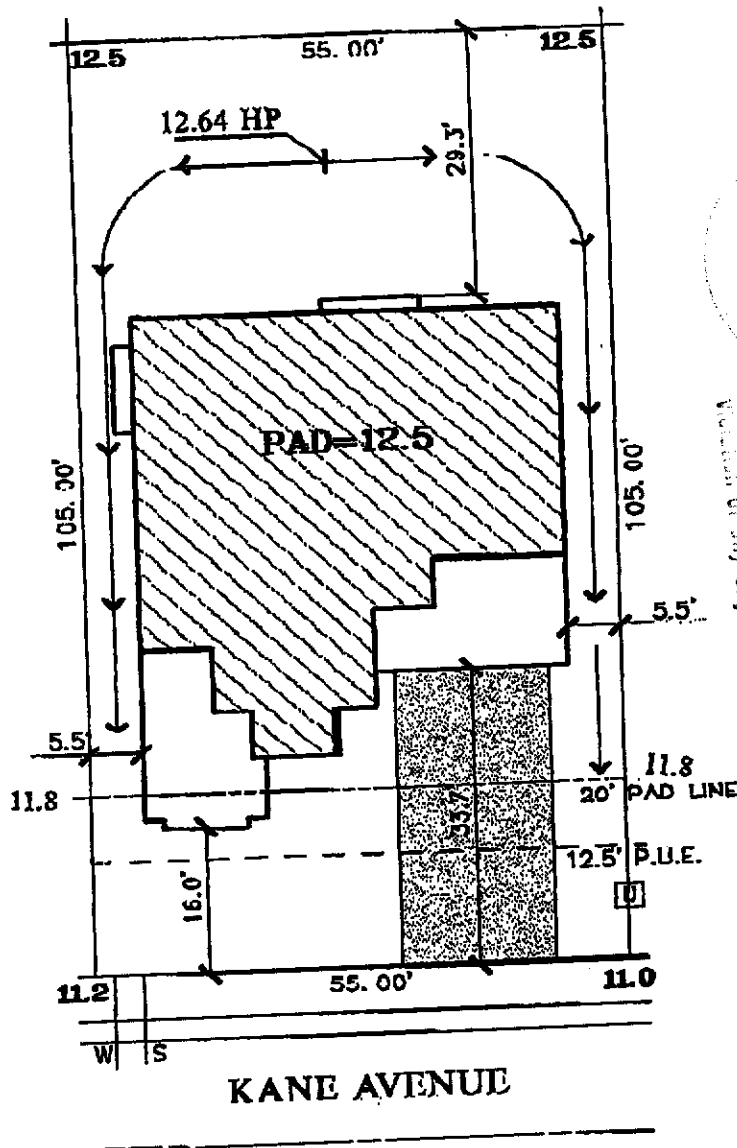

Approval of this plan and specification
 shall not be held to permit or approve the
 violation of any City Ordinance or State Law.

LOT 55
PLAN 4B RIGHT
 A.P.N.: 225-1490-055-0000
 ADDRESS: 1971 KANE AVENUE
 LOT AREA: 5,775 SF
 LOT COVERAGE: 96%

The Spink Corporation
 2590 VENTURE OAKS WAY
 SACRAMENTO, CA 95833
 TEL: (916) 925-5550 FAX: (916) 921-9274

WILLIAM LYON HOMES
 2803 Camino Ramon
 Suite 150
 San Ramon, Ca. 94500
 office: (925) 543-5500
 fax: (925) 543-5601

NORTHPOINTE PARK
UNIT NO. 10
 City of Sacramento, California
 Scale: 1"=20'
 JANUARY 18, 2001